



Manual Spray Mode Kit

Multi-Pro® 5800 Turf Sprayer

Model No. 41616

Installation Instructions

Installation

Loose Parts

Use the chart below to verify that all parts have been shipped.

Description	Qty.	Use
Balancing valve	1	Install the kit.
90-degree elbow	1	
O-ring	1	
Fly nut	1	
Hosebarb tee fitting	1	
Straight barbed fitting	2	
Ball valve	1	
Hose clamp	6	
Agitation bypass hose	1	
No parts required	—	Calibrate the balancing valve assembly.

Installing the Kit

1. Park the machine on a level surface, set the parking brake, shut off the engine, and remove the key.
2. Remove the 3 quick pins that hold the 3 plugs on the boom manifold valves in place (Figure 1).

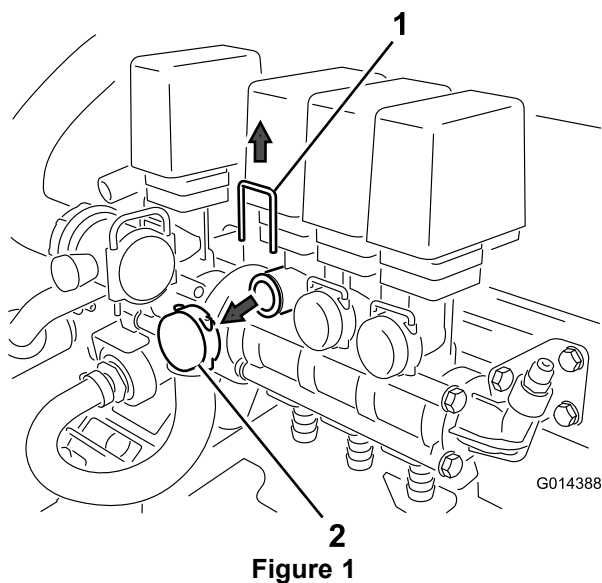

1. Quick pin (3)

2. Plug (3)

3. Install the balancing valve assembly as shown in Figure 2, and secure it with the 3 quick pins that you removed in step 2.

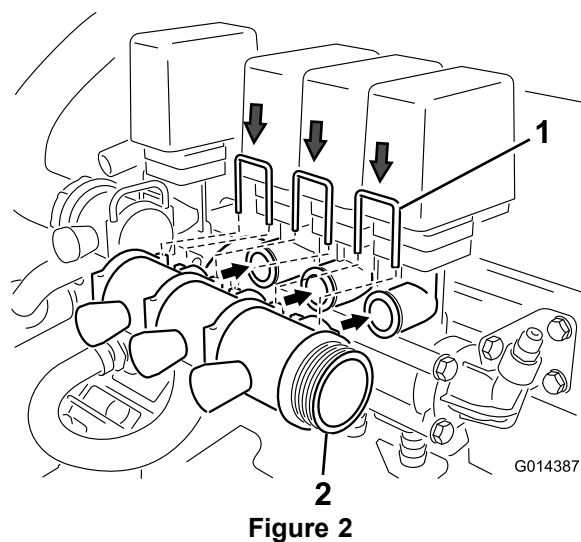

Figure 2

1. Quick pins

2. Balancing valve

4. Install the O-ring on the flanged end of the 90-degree elbow, and insert the elbow into the right-hand side of the balancing valve assembly (Figure 3).

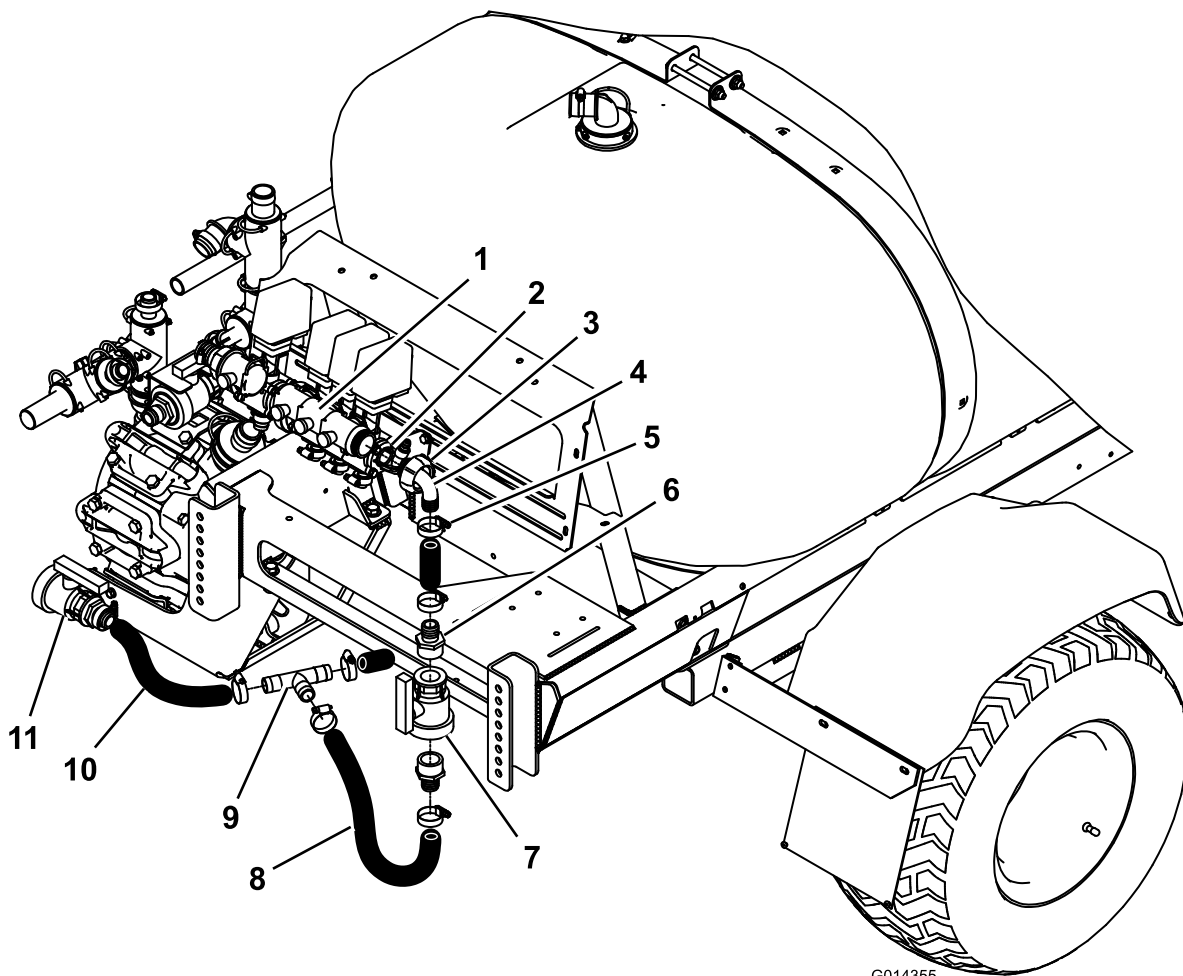

Figure 3

- | | |
|---|---|
| <ol style="list-style-type: none"> 1. Balancing valve assembly 2. O-ring 3. Fly nut 4. 90-degree elbow 5. Hose clamp (6) 6. Straight barbed fitting (2) | <ol style="list-style-type: none"> 7. Ball valve 8. Agitation bypass hose 9. Hosebarb tee fitting 10. Drain hose 11. Drain valve |
|---|---|

5. Slip a fly nut over the 90-degree elbow and secure the elbow by screwing on the fly nut over the elbow until it is hand tight.
6. Locate the drain hose under the machine and cut the hose about 24 inches from the drain valve (Figure 3).
7. Slip a hose clamp over each hose end, and install a hosebarb tee fitting between hose ends (Figure 3).
8. Secure the tee fitting by tightening the hose clamps on either side of the fitting.
9. Cut the agitation bypass hose (Figure 3) 2 or 3 inches from the elbow fitting.
10. Install the agitation bypass hose from the tee to the elbow (Figure 3).
11. Secure the hose ends to the tee fitting and elbow with hose clamps.

12. Insert the ball valve and 2 straight barbed fittings and 2 hose clamps as shown in Figure 3.
13. Secure the ball valve and 2 straight hose fittings with the 2 hose clamps (Figure 3).

Note: Use pipe tape on the pipe.

Calibrating the Balancing Valve Assembly

The balancing valve assembly redirects the fluid flow back to the tank when you turn off a boom section. Each boom bypass valve on the assembly is located in front of its corresponding valve section. You can adjust these valves to ensure that the boom pressure remains constant no matter how many booms are on.

Note: Before using the sprayer for the first time or if the nozzles are changed, adjust the balancing valve assembly so that the pressure and application rate remains the same for all booms when you turn one or more booms off.

1. Select an open flat area to perform this procedure.
2. Fill the spray tank with clean water.
3. Put the extension booms down, if they are installed.
4. Set the parking brake and start the engine.
5. Move the throttle lever to the Spray position.
6. Set the pump switch to the On position to start the pump.
7. Set all three boom switches and the master boom switch to the On position.
8. Use the application rate switch to adjust the pressure as read on the pressure gauge until it is in the range for the nozzles you installed on the booms (typically 40 psi).
9. Record the reading on the pressure gauge.
10. Turn off one of the booms using the appropriate boom switch.
11. Adjust the boom bypass valve (Figure 4) on the balancing valve assembly that corresponds to the boom that you turned off until the pressure reading on the gauge is the same as it was in step 8.

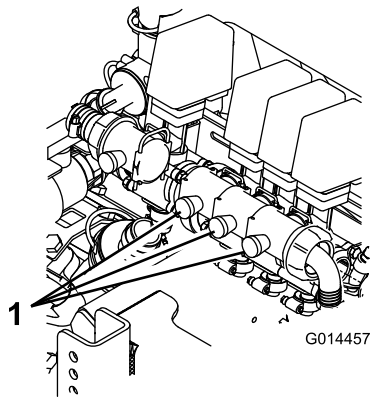

Figure 4

1. Boom bypass valves on the balancing valve assembly



Count on it.