



Roller Extension Kit

Greensmaster® Flex™ Series Mowers

Model No. 115-7361

Installation Instructions

1. Place the cutting unit onto a smooth work surface. Make sure all debris is removed from the threaded hole in each end of the cutting unit roller.

Note: On cutting units with serial numbers prior to 240001000, some of the roller shafts may not have the tapped holes in the ends of the roller shaft. If required, drill and tap a 3/8-24 UNF, 7/8 inch deep hole in each end of the roller shaft.

2. Thread the top deform jam nut all the way onto the longer threaded end of the offset shaft (Figure 1). The deformed end of the jam nut goes on last. Do not tighten.

Note: The top deform side of the nut is to be threaded on first.

3. Apply Blue Loctite onto the threads of the longer threaded end of the offset shaft (Figure 1).
4. Loosely thread the same end of the offset shaft into the end of the roller shaft. Do not tighten.

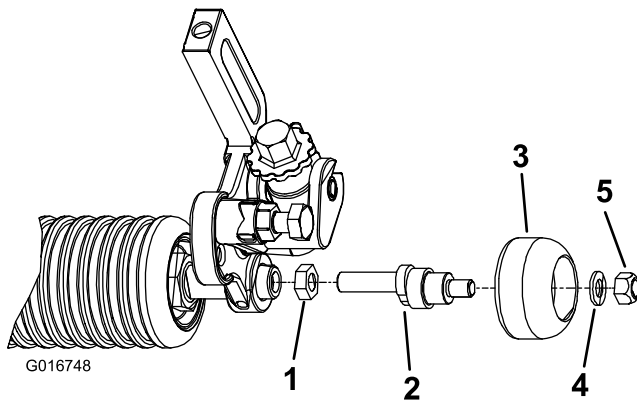

Figure 1

- | | |
|------------------------------|-------------|
| 1. Jam nut | 4. Washer |
| 2. Offset shaft | 5. Lock nut |
| 3. Auxiliary roller assembly | |

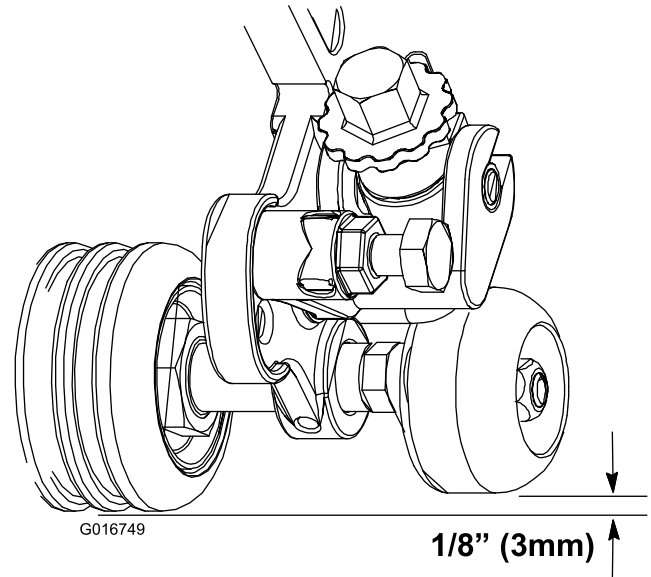

Figure 2

7. Tighten the jam nut against the end of the roller shaft to lock the adjustment.
8. Repeat the procedure on the opposite end of the roller.

5. Insert the auxiliary roller assembly onto the other end of the offset shaft and secure with a washer and a lock nut (Figure 1).
6. Rotate the roller downward until it is 1/8 inch (3 mm) higher than the front roller (Figure 2).