

Installationsanweisungen

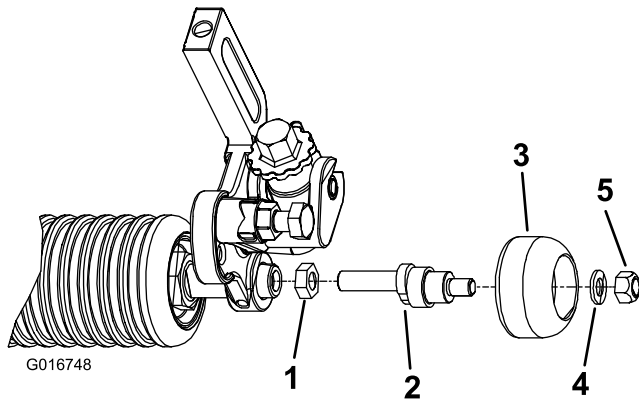

-
- Technical drawing of a mechanical assembly, likely a pump or motor component. The drawing shows a side view of the assembly, which includes a large, ribbed cylindrical component on the left, a central shaft or armature, and a smaller cylindrical component on the right. A dimension line with arrows at both ends indicates a vertical distance of 1/8" (3mm) from a horizontal reference line to the top of the central component. The drawing is labeled G016749.