



Engine Replacement

2006 and Before Sand Pro/Infield Pro 5020 Traction Units

Model No. 117-2732

Model No. 119-2465

Installation Instructions

Refer to your *Toro Operator's Manual*, the *Toro Service Manual*, and the *Briggs and Stratton Service Manual* for information on engine and component replacement and adjustment.

Note: Remove the blower housing, flywheel, governor springs and the air cleaner support bracket from the old engine and install them on the new engine (Figure 1).

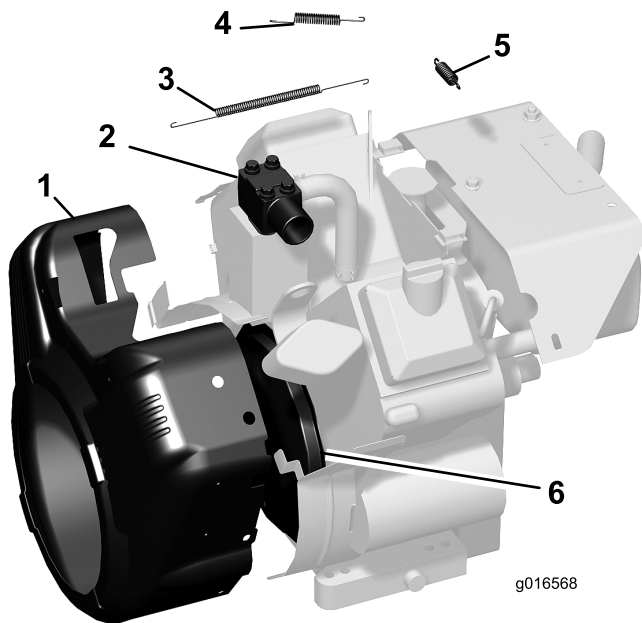

Figure 1

- | | |
|--------------------------------|--------------------|
| 1. Blower housing | 4. Governor spring |
| 2. Air cleaner support bracket | 5. Governor spring |
| 3. Governor spring | 6. Flywheel |