



# Engine Replacement

## 2006 and Before Sand Pro/Infield Pro 5020 Traction Units

Model No. 117-2732

Model No. 119-2465

### Installation Instructions

Refer to your *Toro Operator's Manual*, the *Toro Service Manual*, and the *Briggs and Stratton Service Manual* for information on engine and component replacement and adjustment.

**Note:** Remove the blower housing, flywheel, governor springs and the air cleaner support bracket from the old engine and install them on the new engine (Figure 1).

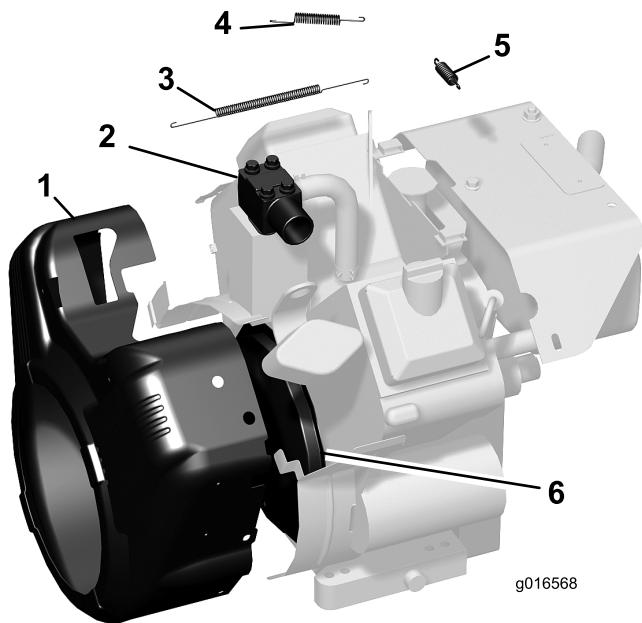

**Figure 1**

- |                                |                    |
|--------------------------------|--------------------|
| 1. Blower housing              | 4. Governor spring |
| 2. Air cleaner support bracket | 5. Governor spring |
| 3. Governor spring             | 6. Flywheel        |