



Deck Gearbox Contacts Brake Components

Product: Groundsmaster 3280D

August 23, 2011

Affected Units:

Model:

Serial Numbers:

Groundsmaster 72" SD Deck

30368

310000101 & up

Subject:

On specific tractors, the 72" Side Discharge Deck with black lift arms (30368) can experience gearbox contacting with the brake cable or brake cable bracket when the deck is raised to the transport position.

This contact only occurs when black lift arms are installed (which were implemented starting in 72" Side Discharge Deck with serial numbers 310000101 & up). The machine may unexpectedly steer to one side when the deck is raised to the transport position. This is due to contact occurring between the 72" Side Discharge Deck gearbox and the brake cable(s) or brake cable brackets located on the underside of the operator platform floor.

To correct this issue, install 72" SDD Gearbox Rework Kit (120-6599).

Tractors that **will require** this kit when fitted with a new 72" SD replacement deck that use black lift arms:

Model Number	Serial Number Range
Groundsmaster 3320 (30307)	250000101-250000999
Groundsmaster 3280D (30308)	250000101-250000999
Groundsmaster 3280D 4WD (30309)	250000101-250000999
Groundsmaster 3320 (30343)	260000101-290000999
Groundsmaster 3280D (30344)	260000101-311000157
Groundsmaster 3280D 4WD (30345)	260000101-311000218

Tractors that **will not require** this kit when fitted with a new 72" SD replacement deck with black lift arms:

Groundsmaster 3280D (30344)	311000158 & up
Groundsmaster 3280D 4WD (30345)	311000219 & up

Note:

72" Side Discharge Deck (30368) installations using red lift arms **require no modification** used in with any Groundsmaster 3280D or 3320 tractor.

Contact your local Toro Commercial Products Distributor to obtain this gearbox relocation kit and for more information on this issue. Please reference Service Bulletin Rotaries 14-42 when making your inquiry.



Cutting Unit Alignment Kit

Model 30368 72in Side Discharge Mower

Model No. 120-6599

Installation Instructions

Installation

1. Position the machine on a level, hard surface, lower the mowing deck to the ground, set the parking brake and remove the key from the ignition switch.
2. Remove the deck belt covers and relieve the deck belt tension by removing the belt from the idler pulleys.
3. Loosen the (4) screws that secure the gear box to the support brackets (Figure 1).
4. Remove and discard the (2) screws that secure the right side (discharge chute side) of the gearbox to the support bracket (Figure 1). Retain the lock washers.

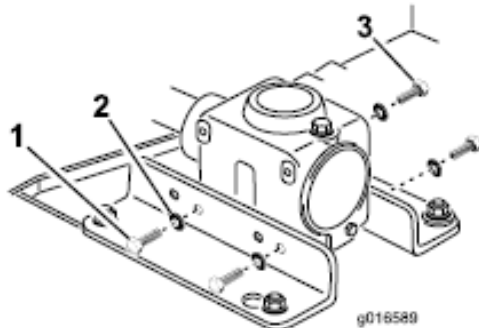

Figure 1

- | | |
|------------------------|----------------------|
| 1. Screw, 2 (discard) | 3. Screw, 2 (retain) |
| 2. Lockwasher (retain) | |

5. Remove and retain the (2) screws and lockwashers that secure the left side (opposite the discharge chute side) of the gearbox to the support bracket (Figure 1). Retain the screws and lock washers.
6. Remove and retain the (2) flange nuts and washers that secure the left gearbox bracket to the mower deck (Figure 2). This is the side of the gearbox that is opposite the discharge chute. Retain the nuts and washers but discard the bracket.

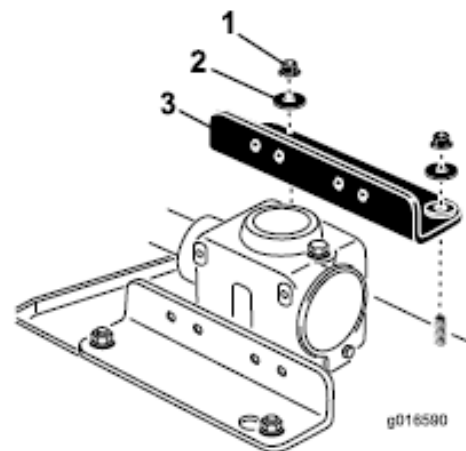

Figure 2

- | | |
|---------------|-------------------------|
| 1. Flange nut | 3. Left gearbox bracket |
| 2. Washers | |

7. Loosely install the (2) new screws, previously removed washers and (2) new spacers (included in the kit) to the right support bracket as shown in Figure 3. The screws must be left loose to allow the alignment of the screws on the other side of the gearbox.

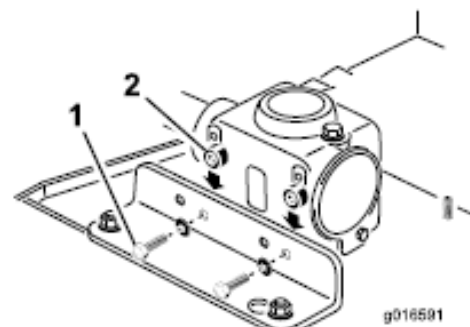

Figure 3

- | | |
|----------|-----------|
| 1. Screw | 2. Spacer |
|----------|-----------|

8. Install the (2) rubber mounts into the holes in the bottom of the new gearbox bracket (Figure 4).

Note: Water or liquid soap can be used to assist in seating the mounts in gearbox bracket.

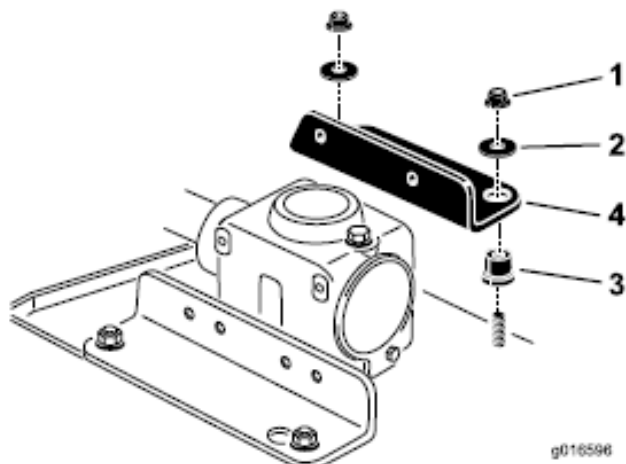

Figure 4

- | | |
|---------------|------------------------|
| 1. Flange nut | 3. Rubber mount |
| 2. Washer | 4. New gearbox bracket |
-
9. Position the new gearbox bracket onto the mower deck threaded studs (Figure 4). Loosely install the previously removed washers and flange nuts.
 10. Loosely install the (2) previously removed screws and lockwashers to secure the left side of the gearbox to the support bracket.
 11. Torque all the mounting screws and nuts to 30 ft-lbs. (41 N-m).
 12. Affix the lube decal to the new gearbox bracket.
 13. Re-install the deck drive belt.
 14. Lift the deck and verify adequate clearance with nearby brake cable components.
 15. Re-install the deck covers.