

TORO®

MODEL NO. 80733

**DEALER
INSTRUCTIONS****WHEEL HORSE®**
Dual Rear Wheel Adaptor Kit**8-SPEED TRANSMISSION CONVERSION**

This kit can only be installed on tractors that have 8-pinion differentials and 1 1/8 inch axles. Since you must disassemble and assemble the transmission, refer to the Wheel Horse transmission repair manual (part no. A-1392)

This kit includes dual wheel adaptors, attaching hardware, and transmission parts. Dual wheel tires and rims must be ordered separately and are not included in this kit. Always make sure you match the dual wheel tire and rim size to the tires and rims on the tractor.

The carton should contain the following parts (Fig. 1).

Ref.	Part Description	Qty
For mounting the wheels		
1	Adaptor	2
2	Carriage Bolt 1/2" x 12" lg.	8
3	Nut 1/2"	8
4	Washer 1/2"	8
For converting transmission		
5	Gasket - RH to LH Case	1
6	Axle Seal 1 1/8" I.D.	4
7	Input Shaft Seal 5/8" I.D.	1
	Brake Shaft Seal 3/4" I.D.	1
8	Axle	2
9	Key	2

INSTALL AXLES AND TRANSMISSION PARTS

Use the transmission repair manual and install new axles, keys, seals and gaskets.

INSTALL DUAL REAR WHEEL ADAPTORS

Refer to the instructions on the opposite side of this page.

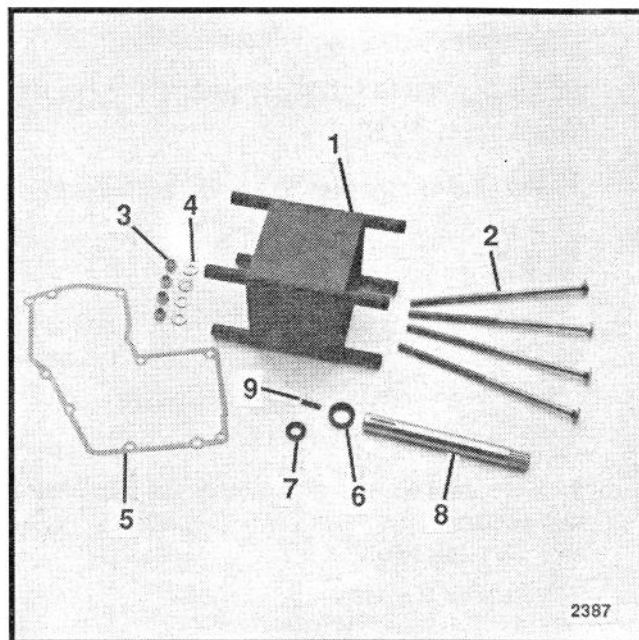

FIG. 1 Dual Rear Wheel Adaptor Kit Parts

TORO®

MODEL NO. 80733

**CUSTOMER
INSTRUCTIONS****WHEEL HORSE®**
Dual Rear Wheel Adaptor Kit**OPERATION**

Dual rear wheels increase the traction of the tractor.

For even more traction, your Toro dealer can fill the front tires with fluid (calcium chloride). **NEVER FILL THE REAR TIRES WITH FLUID.**

Periodically check the rear wheels:

Tire Pressure 12 psi (.85 kg/cm²)

Wheel Rim to Hub Bolts .. 45 ft. lbs. (61.2 Nm)

Dual Wheel Rim Carriage Bolts/Nuts - 50 ft. lbs. (68 Nm)

INSTALL DUAL REAR WHEEL ADAPTORS AND WHEELS

1. Fill all four rear tires to 12 psi (.85 kg/cm²).
2. Tighten tractor wheel rim to hub bolts to 45 ft. lbs. (61.2 Nm).
3. Insert four carriage bolts through square holes in each tractor wheel rim (Fig. 1). Bolts go from inside to the outside of the rim.
4. Slide adaptors onto the carriage bolts (Fig. 1).
5. Slide dual wheels and washers onto carriage bolts and secure in place with nuts (Fig. 2). Tighten nuts to 50 ft. lbs. (68 Nm).

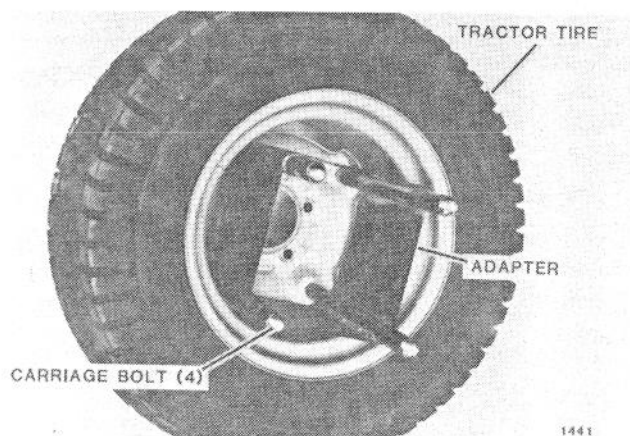
**FIG. 1 Adaptor Position****REMOVING DUAL REAR WHEELS**

1. Remove nuts and washers from dual rear wheels (Fig. 2).
2. Slide dual wheels and adaptors off carriage bolts.
3. Remove carriage bolts from inside rear wheel rim.
4. Store all parts in a memorable location.

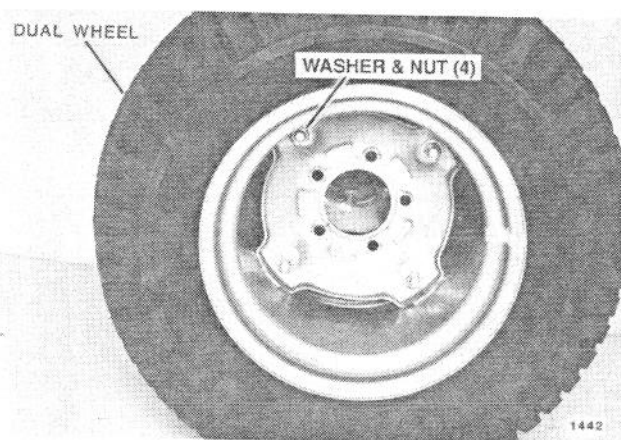
**FIG. 2 Dual Rear Wheel Installed**