



Backup Alarm Kit

Workman® MD, MDX, MDX-D Utility Vehicle
Model No. 115-7824

Form No. 3370-848 Rev A

Installation Instructions

Loose Parts

Use the chart below to verify that all parts have been shipped.

| Procedure | Description | Qty. | Use |
|-----------|--|--------|-----------------------------|
| 1 | No parts required | — | Prepare the machine. |
| 2 | Alarm | 1 | Install the audible alarm. |
| 3 | Reverse switch Plastic tie (for Workman MDX only) | 1 2 | Install the reverse switch. |
| 4 | No parts required | — | Test the alarm. |

1

Preparing the Machine

No Parts Required

Procedure

⚠ CAUTION

If you leave the key in the ignition switch, someone could accidentally start the engine and seriously injure you or other bystanders.

Remove the key from the ignition switch before you do any maintenance.

⚠ CAUTION

A raised box could fall and injure persons that are working beneath it.

- Always use the prop rod to hold the box up before working under the box.
 - Remove any load material from the box before raising it.
1. Position the machine on a level surface. Set the parking brake, turn the ignition off, and remove the key.
 2. Raise the bed. Rotate the latch rod upward and raise the box with the other hand.

3. Raise the box to its full height; then lower it slightly to engage the prop rod (Figure 1).

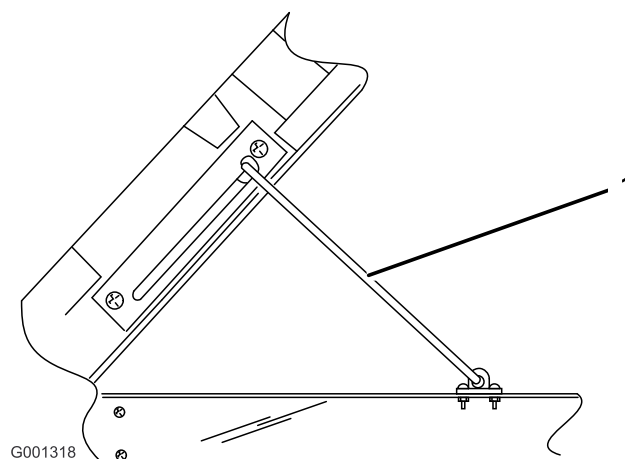

Figure 1

1. Prop rod

4. Disconnect the battery cables from the battery.

2

Installing the Audible Alarm

Parts needed for this procedure:

| | |
|---|-------|
| 1 | Alarm |
|---|-------|

Workman MD, MDX

1. Locate the control cover on the right rear frame of the engine compartment (Figure 2).

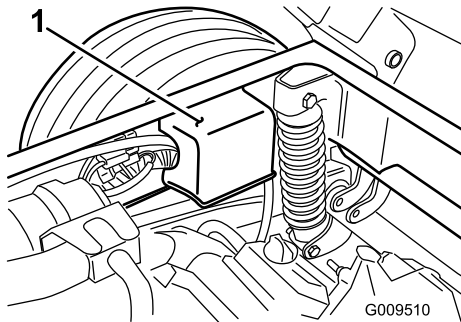

Figure 2

1. Control cover

2. Press in on the cover to release the tabs in the mount plate. Lift the cover upwards carefully and remove the cover (Figure 3). Do not discard.

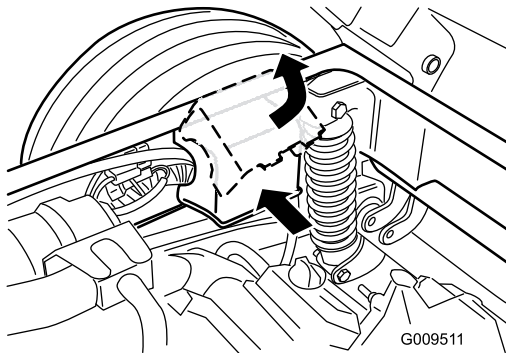

Figure 3

3. Locate the round hole in the control mount plate and the main vehicle harness (Figure 4).
4. Install the alarm into the hole as shown in Figure 4. If necessary, move the harness to allow the installation of the alarm.

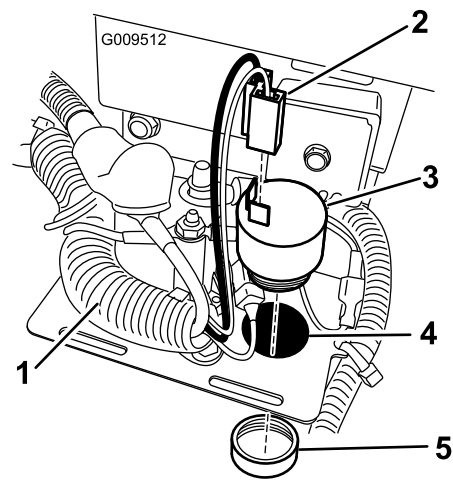

Figure 4

1. Main wiring harness
2. Right angle plug
3. Alarm
4. Hole in control mount plate
5. Retaining ring

5. Use the retaining ring to secure the alarm to the control mount plate (Figure 4).
6. On the main wiring harness, locate the terminating end that has a right angle plug orientation. This connector should be secured to the main harness with a plastic tie (Figure 4). Remove the tie on the connector to reach the alarm.
- Note:** It is recommended to apply dielectric grease to the connector before installing.
7. Connect the alarm to the vehicle's main wiring harness (Figure 4).
8. Install the cover. Make sure that the tabs mate to the slots in the mount plate so that the cover is seated properly.

Important: If the control cover is removed, or loose, debris can build up and interfere with the normal operation of the electronic controls of the machine.

Workman MDX-D

1. Locate the radiator overflow tank on the right rear frame of the engine compartment (Figure 5).

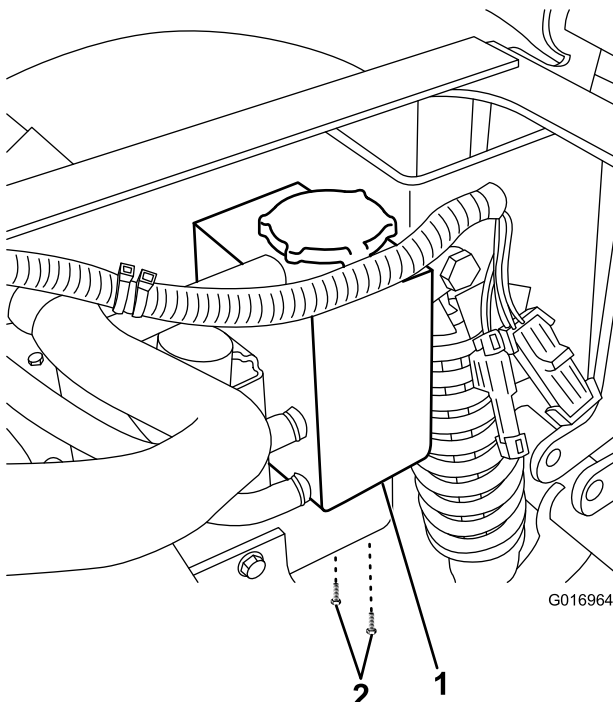

Figure 5

1. Radiator overflow tank
2. Bolts

2. Remove the 2 bolts underneath the tank that attach it to the frame (Figure 5).
3. Move the radiator overflow tank to locate the round hole in the mount plate (Figure 6).

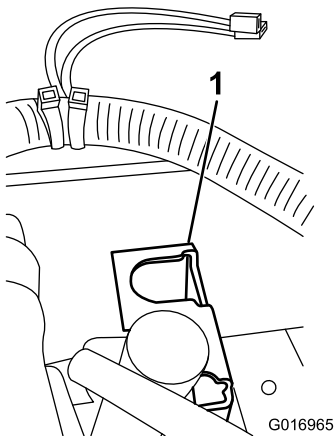

Figure 6

1. Hole in mount plate

4. Loosely screw the retaining ring on to the alarm (Figure 7), and slide it in to the hole in the mount plate (Figure 8).

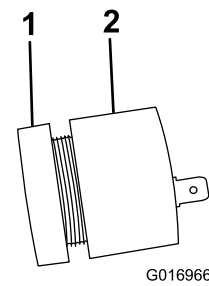

Figure 7

1. Retaining ring
2. Alarm

5. Tighten the retaining ring to secure the alarm to the plate.

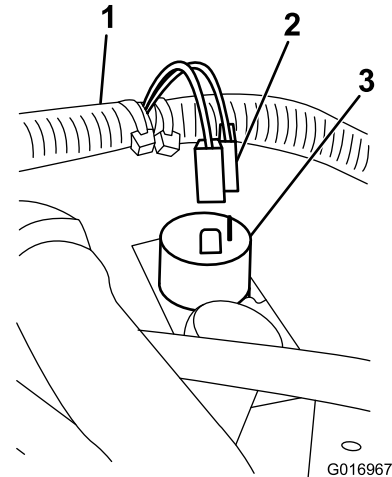

Figure 8

1. Main wiring harness
2. Right angle plug
3. Alarm

6. On the main wiring harness locate the right angle plug and connect it to the alarm (Figure 8).

Note: It is recommended to apply dielectric grease to the connector before installing.

7. Install the radiator overflow tank with the 2 bolts previously removed.

3

Installing the Reverse Switch

Parts needed for this procedure:

| | |
|---|------------------------------------|
| 1 | Reverse switch |
| 2 | Plastic tie (for Workman MDX only) |

For the Workman MDX only

Locate the wire tie(s) securing the shift selector to the vehicle frame in the engine compartment and remove them. Note the position and configuration so that new ties can be installed afterward (Figure 9).

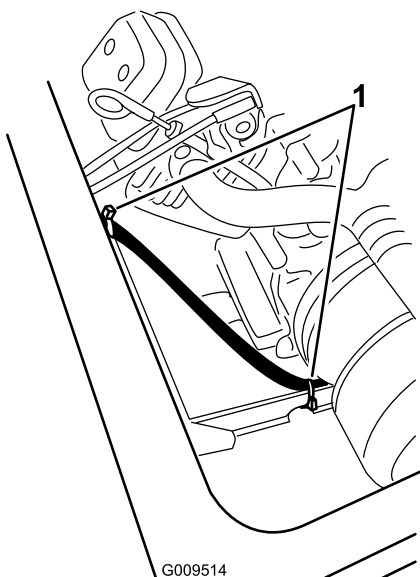

Figure 9

1. Plastic tie

All Models

1. Locate the shift selector assembly below the seats (Figure 10).

Note: Installation of the switch is easier with the shift selector in the “F” or forward position.

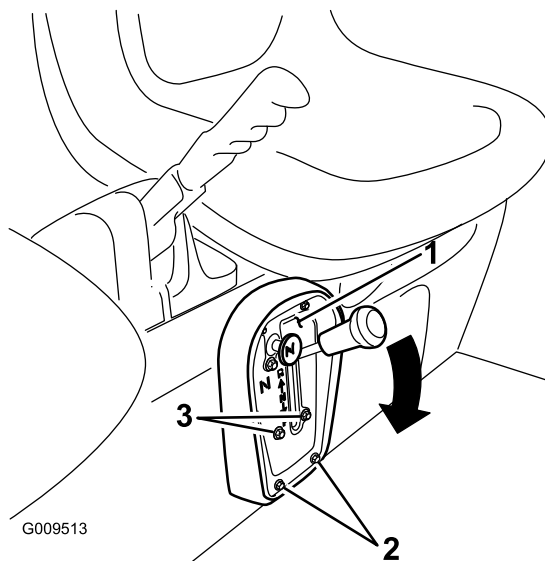

Figure 10

1. Shift selector assembly
 2. Bolts (1/4 x 3/4 inch), Shift selector assembly
 3. Bolts (1/4 x 1/2 inch), Shift plate
-
2. Remove the 4 bolts (1/4 x 3/4 inch) securing the shift selector to the seat box frame (Figure 10). Do not discard.
 3. Pull the shift selector forward far enough to see the choke cable from the top. Remove the 4 bolts (1/4 x 1/2 inch) securing the shift plate to the shift selector body (Figure 10). Do not discard.
 4. With the shift plate loose, remove the choke cable from the shift selector body. Gently pull the remainder of the shift selector assembly forward far enough to install the switch (Figure 11).

Note: The wiring harness may be secured to the selector assembly keeping it from moving forward. If necessary, find the wire tie securing the harness to the selector assembly and remove it to allow full access.

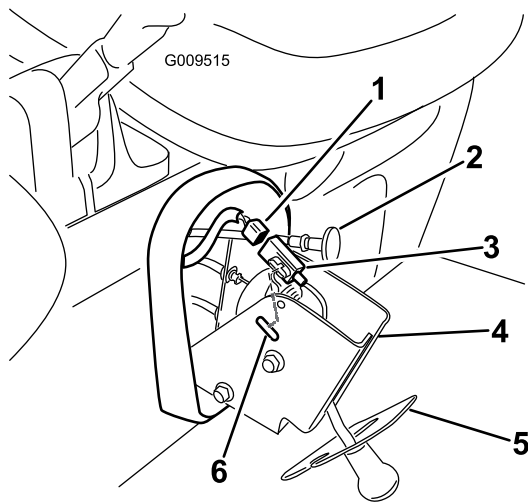

Figure 11

- | | |
|------------------------------|-----------------------------|
| 1. Reverse switch connector, | 4. Shift selector assembly |
| 2. Choke cable | 5. Shift plate |
| 3. Reverse switch | 6. Oval cutout, for reverse |
| | switch |

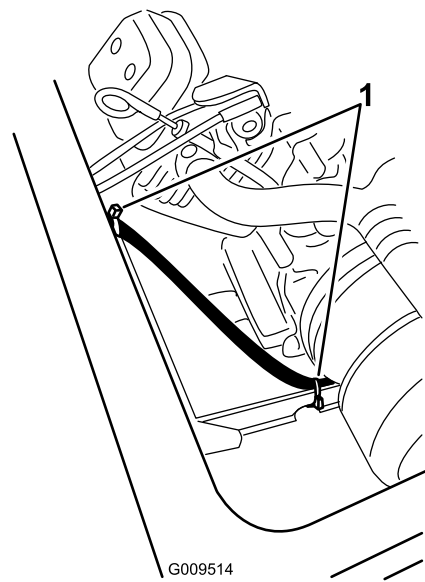

Figure 12

1. Plastic tie

5. Locate the wiring harness and box connector on the harness labeled Reverse Switch (Figure 11).
6. Install the reverse switch to the labeled box connector then move the switch into position as shown in Figure 11.
7. Snap the connector into place at the existing oval slot in the selector assembly with the switch button facing forward (Figure 11).
8. Move the selector back into the seat box frame only enough to replace the choke cable. Install the choke cable into the shift selector assembly.

Note: Ensure that the wiring harness is not pinched as the selector assembly is moved into position.

9. Install the shift plate to the selector assembly to secure the choke cable in place. Use the fasteners removed previously to secure the shift plate in place.
10. Move the assembly shift selector into place in the seat box frame. Secure it to the frame using the fasteners removed previously.

For Workman MDX vehicles only

Use the plastic ties included to secure the shift cables into position (Figure 12).

4

Testing the Alarm

No Parts Required

Procedure

1. Install the battery cable removed previously.
2. Turn the ignition key to the On position to energize the machine.
3. Place the shift selector into reverse to test the audible alarm.

Notes:

Notes:



Count on it.