

TORO®**INSTALLATION
INSTRUCTIONS
ADDENDUM****RECYCLER® KIT SPACER INSTALLATION**

FOR TORO® 32" WIDE AREA MOWER MODEL 30133 ONLY

Before installing the new Recycler® blade on a 32" wide area mower deck, (2) spacers need to be added between the drive spindle housing and the deck. The spacers will lower the blade assembly. Please place these instructions with your Recycler® Kit Model 59167 Installation Instructions for future reference.

INSTALLING SPACERS (Fig. 1)

After removing the old blade assembly from mower deck as explained in the Installation Instructions for Recycler® Kit Model 59167, follow this procedure to install (2) spacers.

1. Remove lock nut and washer securing drive pulley on spindle.
2. Remove drive pulley from spindle.
3. Slide spindle out of spindle housing.
4. Remove (8) hex head cap screws and lock nuts securing spindle housing to deck.
5. Align holes in (2) spacers with holes in spindle housing.
6. Secure spacers and spindle housing to deck with (8) hex head cap screws and lock nuts.
7. Reinstall spindle and drive pulley assembly.
8. Install new blade as explained in Instruction Sheet provided with Recycler® Kit.

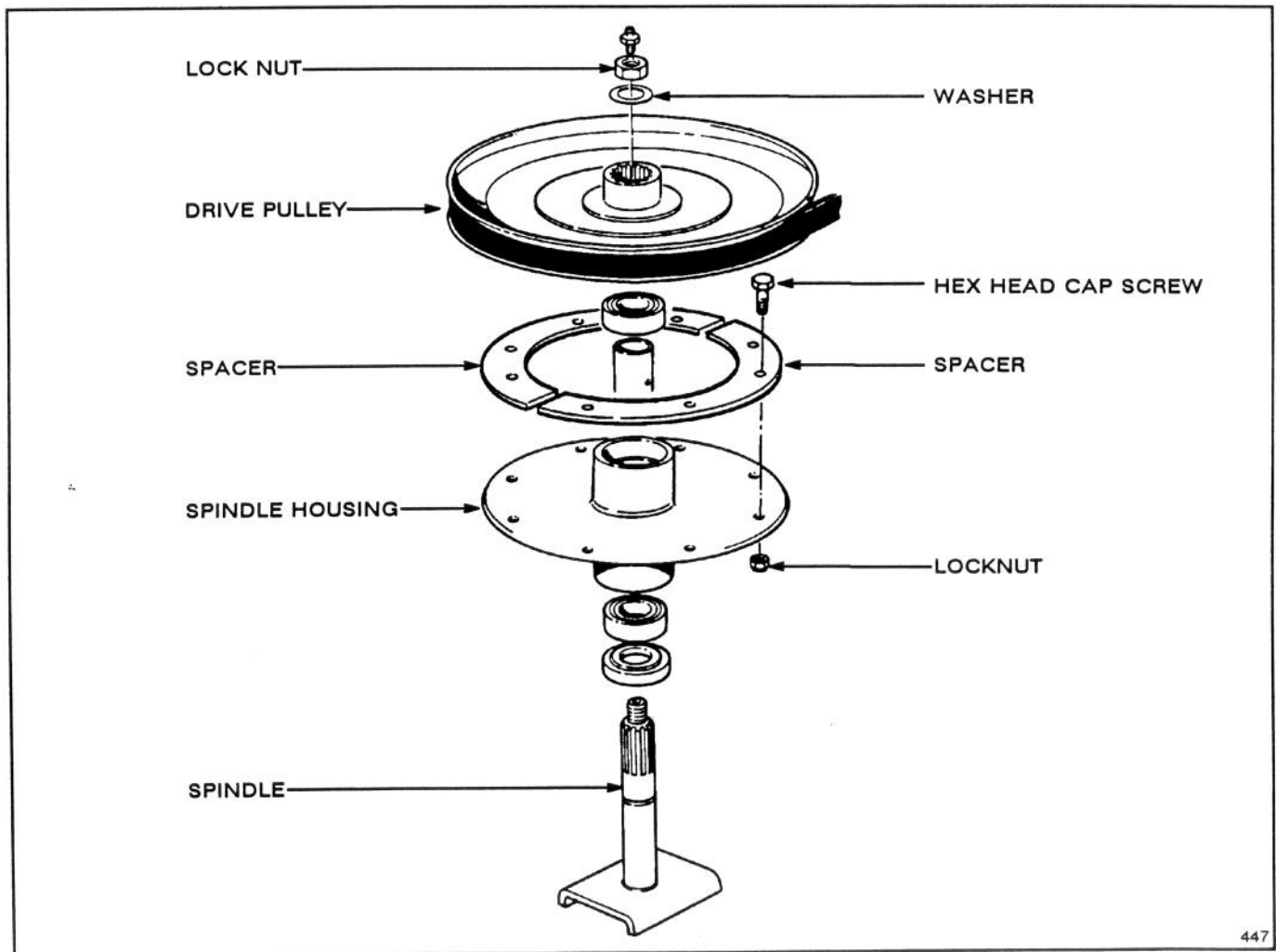

Figure 1