



Part No. 67-9540

## INSTALLATION INSTRUCTIONS

### LARGE PULLEY KIT Reelmaster 216 - 5 Blade Cutting Unit

**NOTE:** Right and left hand sides are determined from the operator's seat position.

1. Release cutting unit belt tension.
2. Remove nut securing belt tensioner and spacers to tensioner bracket on cutting unit (Fig. 1).
3. Remove capscrew and flatwasher securing cutting unit drive pulley to cutting unit (Fig. 1). Remove belt from pulley.
4. Repeat procedure on other two cutting units.
5. Remove the (2) capscrews and locknuts securing right hand jackshaft bearing mount to the frame (Fig. 2). Center and right hand cutting unit belts can be slipped off jackshaft drive pulleys and then off jackshaft. Left hand cutting unit drive belt may be slipped off jackshaft drive pulley and end of jackshaft. Replace belts with new belts supplied in kit.

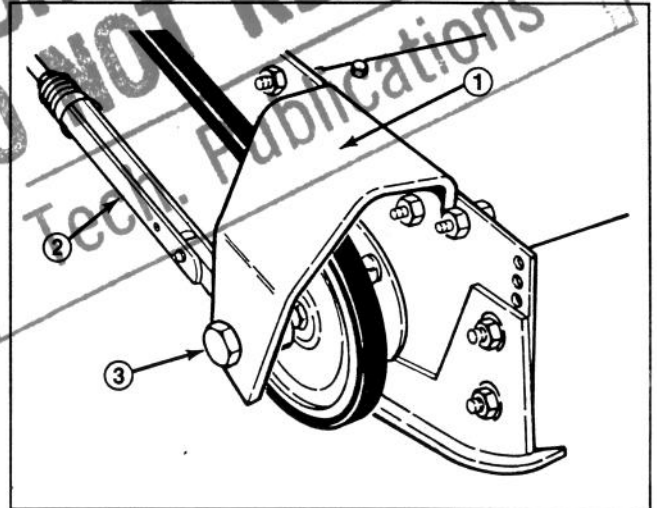

**Figure 1**

1. Tension Bracket
2. Belt Tensioner
3. Capscrew and Nut

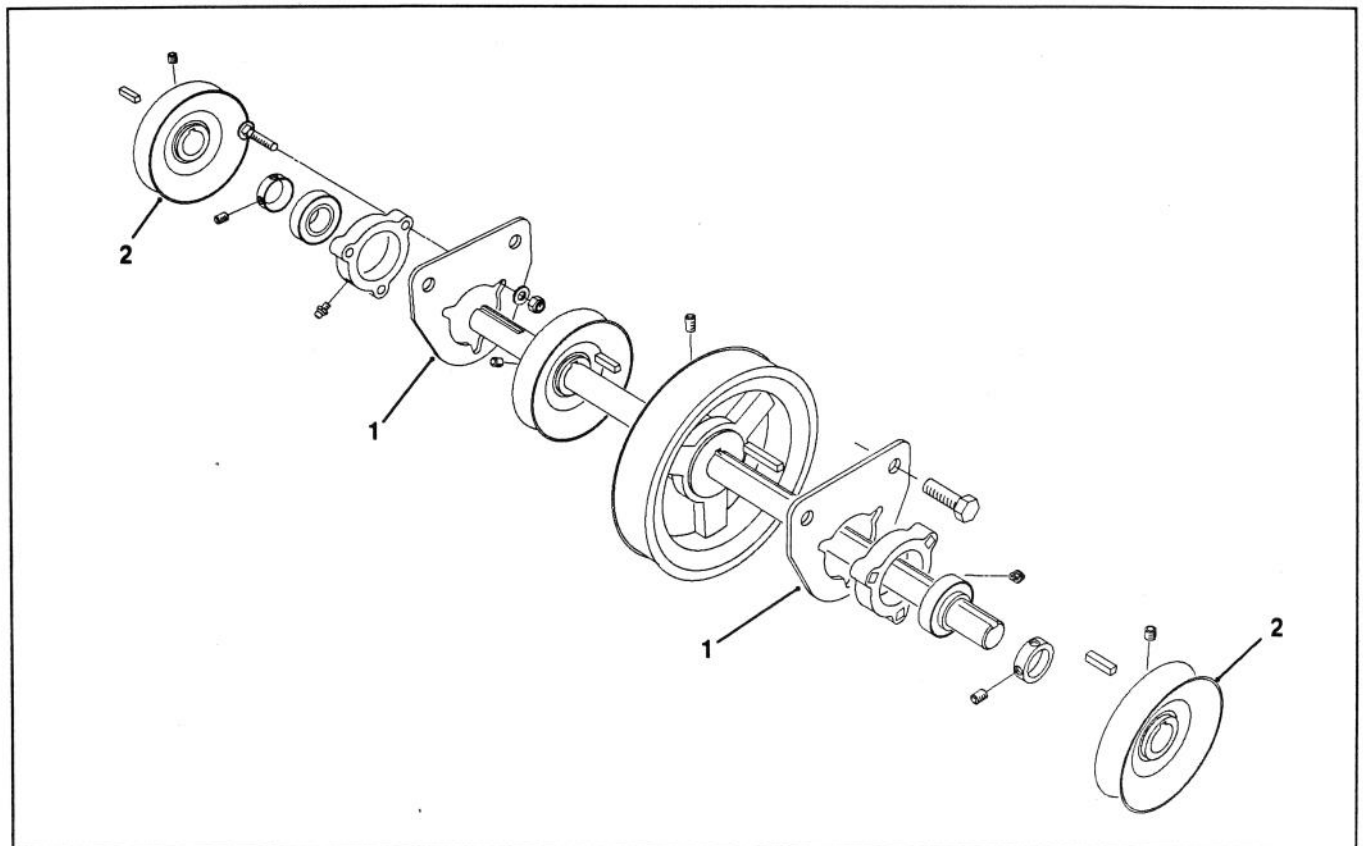

**Figure 2**

1. Jackshaft Bearing Mounts
2. Jackshaft Drive Pulleys

6. Resecure right hand jackshaft to frame with capscrews and locknuts previously removed.

7. Install new cutting unit drive pulleys to reel shafts and secure with capscrews and flatwashers previously removed (Fig.3). Tighten socket head set screw and jam nut on each pulley.

8. Reinstall belts to cutting unit drive pulleys and tension rods to tension brackets. Adjust belt tension; refer to Operator's Manual for proper belt tension adjustments.

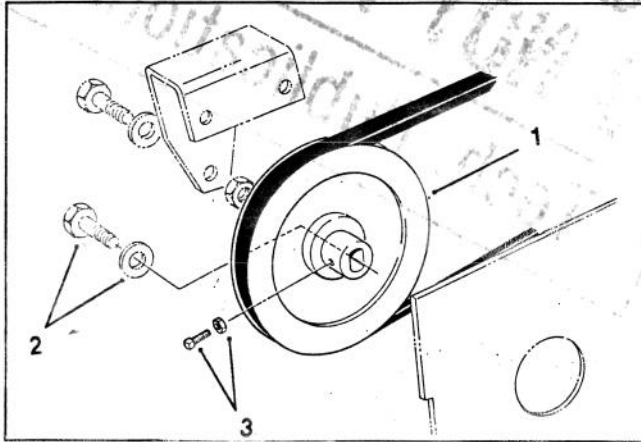

**Figure 3**

1. Pulley
2. Capscrew & Flatwasher
3. Socket Head Set Screw & Jam nut

9. If cutting units are equipped with pulley cleaners or pulley cleaners are to be installed proceed as follows:

A. Loosely mount a pulley debris cleaner bracket to the underside of a pulley debris cleaner support with a carriage bolt and flange locknut as shown in figure 4. Position bracket so that bend in bracket faces downward.

B. Remove locknut from capscrew securing bottom of skid to left side of cutting unit.

C. Loosely secure pulley debris cleaner support onto skid mounting capscrew with external tooth lockwasher and locknut as shown in figure 4.

D. Adjust cleaner bracket so it is centered in groove of pulley and tighten carriage bolt and locknut.

E. Adjust cleaner bracket so there is approximately .030 - .060" clearance between bracket and pulley, then tighten capscrew and locknut.

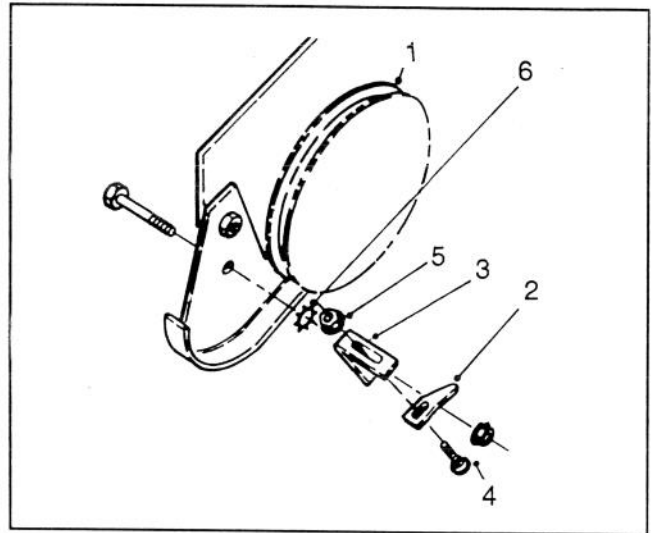

**Figure 4**

1. Pulley
2. Pulley Debris Cleaner Bracket
3. Pulley Debris Cleaner Support
4. Carriage Bolt
5. Flange Locknut
6. External Lockwasher