



MODEL NO. 44-9870

INSTALLATION INSTRUCTIONS

ACCESSORY KIT

USED ON TC400, TC600, TC1000 AND TC2000 GAS TRIMMERS

Since this instruction sheet covers only a minimal amount of information necessary to maintain and operate your Trimmer, we suggest that you keep this material with your Operator's Manual so that both may be referred to for instructions concerning safe operation and proper maintenance procedures.

BEFORE OPERATING

1. Operate the machine only after reading and understanding the contents of this manual. A replacement manual is available by sending complete model and serial number to: The Toro Company, 8111 Lyndale Avenue South, Minneapolis, Minnesota 55420.

2. Never allow children to operate the Trimmer. It is not a toy. Never allow adults to operate unit without first reading the Operator's Manual.

3. Become familiar with the controls and know how to stop the engine quickly.

4. The following articles of apparel are strongly recommended and are required by some local safety and insurance regulations:

- A. Safety goggles
- B. Safety shoes
- C. Long pants
- D. A long sleeved shirt
- E. A helmet
- F. Ear plugs

Dress properly — Do not wear loose clothing or jewelry. They can be caught in moving parts.

5. Keep the area of operation clear of all persons, particularly small children and pets.

6. For proper balance and ease of operation, ALWAYS USE THE SHOULDER HARNESS. Do not attempt to start engine while wearing harness with Trimmer attached. Disconnect Trimmer before starting engine.

7. Never operate Trimmer when you are fatigued.

8. Keep all shields, safety devices and decals in place. If a shield, safety device or decal is defective or damaged, repair or replace it before operating the machine.

9. Gasoline is highly flammable; handle it carefully. Fill fuel tank with mixture of gasoline and oil before trying to start engine.

- A. Use an approved fuel container for storing the gasoline/oil mixture.
- B. Do not fill tank when engine is hot or running.
- C. Do not smoke while handling gasoline.
- D. Fill fuel tank outdoors and up about one-half inch (13 mm) from the top of the tank, not the filler neck.
- E. Wipe up any spilled gasoline before starting the engine.

10. Read and follow important safety instructions provided.

11. Use only Toro approved cutter blades.

12. Be sure cutter blade is correctly installed to Trimmer according to instructions below.

13. Never use damaged or warped cutter blades.

14. Be alert for kickback motion of blade when cutting tension is released or when striking the ground or other hard object.

15. Inspect blade prior to each use for cracks or nicks. Do not use if cracked or nicked.

WHILE OPERATING

16. Do not run the engine in a confined area without adequate ventilation. Exhaust fumes are hazardous and could be deadly.

17. Always be sure of your footing; keep a firm hold of the handle with both hands, and walk, never run, during operation. Shut the engine off before proceeding to the next area of operation.

18. The Trimmer is intended to be used as a means of trimming grassy, weedy and brushy areas only. DO NOT use the Trimmer for such things as tree pruning or hedge trimming.

19. Do not put hands or feet near or under rotating parts. Keep clear at all times.

20. If the Trimmer should start to vibrate abnormally, stop the engine and check immediately for the cause. Vibration is generally a warning of trouble.

21. Avoid using Trimmer near rocks, gravel, stones, or other debris which could be picked up and thrown or personal injury could result.

22. If shield becomes clogged, stop engine before cleaning it out.

23. Use Trimmer only in daylight or good artificial light.

24. Shut off engine, be certain all moving parts have completely stopped rotating and Trimmer has been removed from harness before performing any adjustment or maintenance procedures.

25. Never operate Trimmer without head shield in place.

INSTALL FLEX BLADE



CAUTION

Shut off engine and be certain cutter head has completely stopped rotating before inverting it. Disconnect high tension wire from spark plug to avoid accidental starting.

TC400, TC1000 AND TC2000

1. Remove spool hub, driver, spool core, washer, and spring from cutter head assembly (Note: R.H. thread). Refer to your Operators Manual for information on removal.

Note: Use only mounting hardware specified in installation instructions for mounting flex blade to TC400, TC1000 or TC2000 trimmer.

2. Place smaller inside diameter end of blade adapter over power shaft and drum boss (Fig. 1).

3. Center the flex blade over the drum and power shaft.

4. Slide washer onto adapter nut (Fig. 1).

5. Install adapter nut through hole in flex blade and thread onto power shaft (Note: R.H. thread). Tighten adapter nut firmly with wrench (Note: 7/8" hex) while holding drum with hand (Fig. 1).

6. To remove flex blade, hold drum firmly with hand and loosen adapter nut with wrench (Note: R.H. thread, 7/8" hex). Remove adapter nut, flex blade, and flex blade adapter.

TC600

1. Remove cutting head assembly installed on Trimmer. Refer to your Operator's Manual for information on removal.

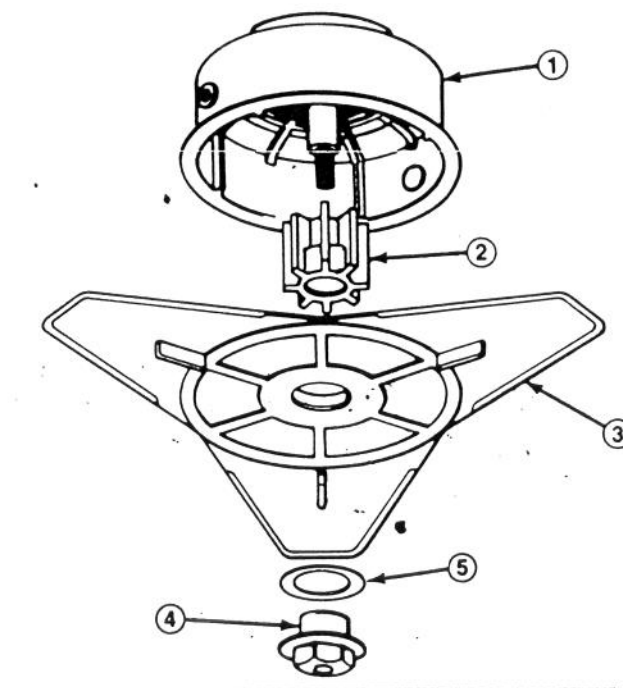

Figure 1

- | | |
|-----------------------|----------------|
| 1. Drum | 4. Adapter nut |
| 2. Flex blade adapter | 5. Washer |
| 3. Flex blade | |

Note: Use only mounting hardware specified in installation instructions for mounting flex blade to TC600 trimmer.

Note: Use flat washer mounting plate to install flex blade. Mounting plate with cup shaped recess on top, is used to mount metal blade to TC600 trimmer. Retain for future use.

2. Install blade, mounting plate, and nut onto shaft (Fig. 2). Insert a locking tool (metal rod) into hole in blade fixing plate, rotate shaft until tool can be inserted through a hole in the gear case casting (Fig. 2).

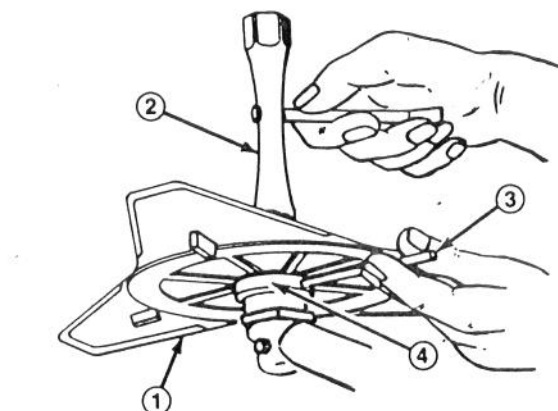

Figure 2

- | | |
|---------------|-----------------------|
| 1. Flex blade | 3. Locking tool |
| 2. Wrench | 4. Blade fixing plate |

3. Keep shaft from rotating with locking tool and tighten nut with wrench (Fig. 2). (Left hand thread).

4. Insert cotter pin through hole in shaft and wrap ends around shaft (Fig. 3).

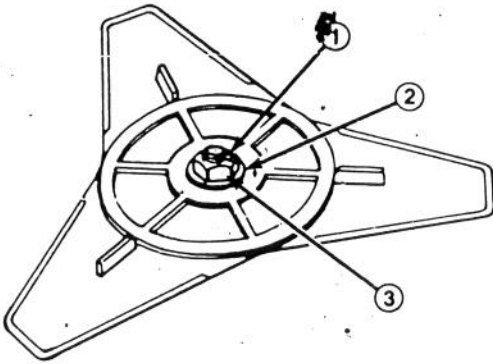

Figure 3

1. Cotter pin
2. Flat washer
3. Nut

INSTALL HARNESS CLAMP AND RING

1. Insert ring into loop of clamp and install clamp over drive shaft tube between R.H. and L.H. handgrips. Bend both ends of clamp together (Fig. 4).

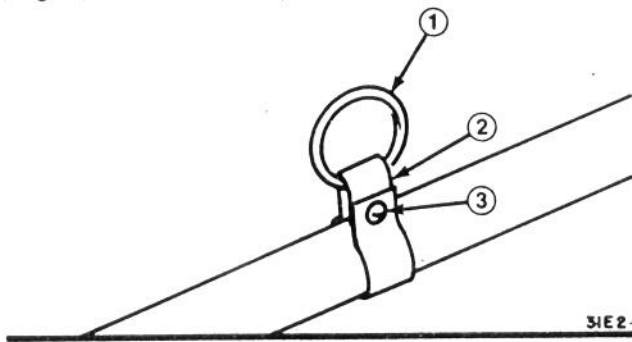

Figure 4

1. Ring
2. Loop of clamp
3. Screw & nut

2. Insert screw through both ends of clamp, keeping ring between screw and top of loop.

3. Thread nut onto screw and position clamp so that ring is on top of tube. Tighten nut and screw.

ATTACH HARNESS

1. Stand on left side of unit, hang belt over left shoulder with harness hook located by right hip. Shoulder harness should lie diagonally across chest with harness hook at right hip.

2. Connect harness hook to ring.

3. Check balance of trimmer and reposition the clamp on the tube if necessary to achieve proper balance.

4. Adjust harness to comfortable position for holding trimmer.

TO RELEASE HARNESS:

1. Unstrap harness hook from ring.

The Toro Promise

TORO GAS TRIMMER/WEEDER A ONE YEAR LIMITED WARRANTY

The Toro Company promises to repair your TORO Product if defective in materials or workmanship. The following time periods from the date of purchase apply:

Residential Product 1 Year
Residential Products Used Commercially 45 Days

The costs of parts and labor are included, but the customer pays the transportation costs. Just return any residential product to an Authorized TORO Service Dealer or TORO Distributor.

Should you feel your TORO Product is defective and wish to rely on The Toro Promise, the following procedure is recommended:

1. Contact any Authorized TORO Service Dealer, TORO Master Service Dealer, or TORO Distributor (the Yellow Pages of your telephone directory is a good reference source).
2. He will either instruct you to return the product to him or recommend another Authorized TORO Service outlet which might be more convenient.
3. Bring the product along with your original sales slip, or other evidence of purchase date, to the service dealer.
4. The servicing dealer will inspect the unit, advise you whether the product is defective and, if so, make all repairs necessary to correct the defect without extra charge to you.

If for any reason you are dissatisfied with the dealer's analysis of the defect or the service performed, you may contact us.

Write:

TORO Customer Service Department
8111 Lyndale Avenue South
Minneapolis, Minnesota 55420

The above remedy of product defects through repair by an Authorized TORO Service Dealer is the purchaser's sole remedy for any defect.

THERE IS NO OTHER EXPRESS WARRANTY. ALL IMPLIED WARRANTIES OF MERCHANTABILITY AND FITNESS FOR USE ARE LIMITED TO THE DURATION OF THE EXPRESS WARRANTY.

Some states do not allow limitations on how long an implied warranty lasts, so the above limitation may not apply to you.

This warranty applies only to parts or components which are defective and does not cover repairs necessary due to normal wear, misuse, accidents, or lack of proper maintenance. Regular, routine maintenance of the unit to keep it in proper operating condition is the responsibility of the owner.

All warranty repairs reimbursable under The Toro Promise must be performed by an Authorized TORO Service Dealer using Toro approved replacement parts.

Repairs or attempted repairs by anyone other than an Authorized TORO Service Account are not reimbursable under The Toro Promise. In addition, these unauthorized repair attempts may result in additional malfunctions, the correction of which is not covered by warranty.

THE TORO COMPANY IS NOT LIABLE FOR INDIRECT, INCIDENTAL OR CONSEQUENTIAL DAMAGES IN CONNECTION WITH THE USE OF THE PRODUCT INCLUDING ANY COST OR EXPENSE OF PROVIDING SUBSTITUTE EQUIPMENT OR SERVICE DURING PERIODS OF MALFUNCTION OR NON-USE.

Some states do not allow the exclusion or limitation of incidental or consequential damages, so the above limitation or exclusion may not apply to you.

This warranty gives you specific legal rights, and you may also have other rights which vary from state to state.

COUNTRIES OTHER THAN THE UNITED STATES OR CANADA

Customers who have purchased TORO products exported from the United States or Canada should contact their TORO Distributor (Dealer) to obtain guarantee policies for your country, province or state. If for any reason

you are dissatisfied with your Distributor's service or have difficulty obtaining guarantee information, contact the TORO importer. If all other remedies fail, you may contact us at The Toro Company.