

TORO®

MODEL NO. 59125

**INSTALLATION
INSTRUCTIONS****EDGER**

FOR USE ON 21" SIDE DISCHARGE MOWERS WITH FRONT WHEEL DRIVE

Since this instruction sheet covers only a minimal amount of information necessary to maintain and operate your machine, we suggest that you keep this material with your Operator's Manual so that both may be referred to for instructions concerning safe operation and proper maintenance procedures.

SAFETY INSTRUCTIONS

1. Operate the mower and edger only after reading this manual. A replacement manual is available by sending complete model and serial number to: The Toro Company, 8111 Lyndale Avenue South, Minneapolis, Minnesota 55420; Attn: Publications.
2. Never allow children to operate the mower edger or adults to operate it without proper instructions.
3. Become familiar with the controls and know how to stop the engine quickly.
4. Keep everyone, especially children and pets, away from the area of operation. Remove sticks, stones, wire and any other debris that might be picked up and thrown by the blade.
5. Wear long pants and substantial shoes. Do not operate mower while wearing sandals, tennis shoes, sneakers or shorts. Do not wear loose fitting clothing that could get caught in moving parts. Wear safety glasses while operating.
6. Keep face, hands and feet away from the mower housing and cutter blade when the engine is running. Stay behind the handle until the engine stops.
7. If a solid object is hit by the blade or if mower vibrates abnormally, shut engine off immediately and wait for all moving parts to stop. Check mower for possible damage, bent blade, an obstruction, or loose part(s). Make all repairs before using the mower.
8. Stop the engine before adjusting the edger or height-of-cut.
9. If a gravel driveway, road or side walk must be crossed, stop the blade so loose sand and rocks are not thrown.
10. Before leaving the operator's position — behind the handle — stop the engine and wait for all moving parts to stop. Disconnect high tension wire from spark plug if mower will be unattended.

11. Before the mower or edger is serviced or adjusted, stop the engine and disconnect high tension wire from spark plug. Keep the wire away from the plug to prevent the possibility of accidental starting.

INSTALL EDGER

1. Assure engine is not running and high tension wire is removed from spark plug.
2. Place a block of wood under front of mower housing to raise front wheels.
3. Move left front spring arm to "E" height-of-cut setting.
4. Remove left front wheel bolt and nut securing wheel and wheel cover to pivot arm.
5. Mount washer (.375 I.D. x .875 O.D.) ②, wheel bolt sleeve ③, new wheel ④, washer (.515 I.D. x .88 O.D.) ⑤, edger blade ⑥, washer (.374 I.D. x .680 O.D.) ⑦ and cover ⑧ onto wheel bolt ① supplied in kit, as shown in illustration.
6. Secure to pivot arm with nut while positioning pinion gear thru hole in cover and aligning it with gear on blade.

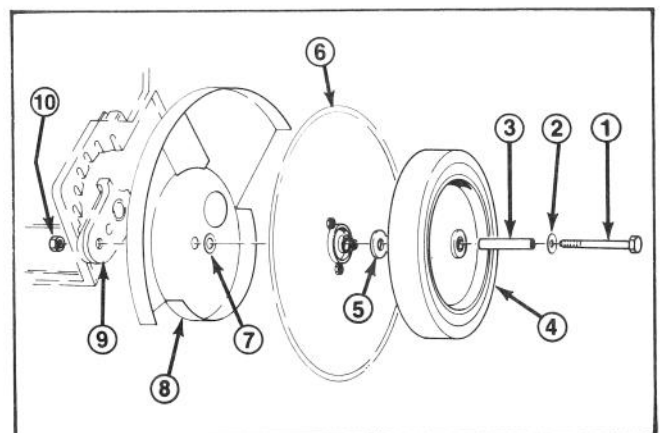

- | | |
|----------------------|----------------|
| 1. Wheel bolt | 6. Edger blade |
| 2. Washer | 7. Washer |
| 3. Wheel bolt sleeve | 8. Cover |
| 4. Wheel | 9. Pivot arm |
| 5. Washer | 10. Nut |

OPERATION

1. Position right front wheel into "A" height-of-cut position and all other wheels into "B", "C", "D" or "E" position to eliminate right front wheel from scuffing ground.

2. Assure high tension wire is pushed onto spark plug.

3. Move wheel drive control into DISENGAGE

detent, throttle control to FAST position, and start engine.

4. Push down on upper handle to raise edger off ground.

5. ENGAGE wheel drive control and lower edger into ground.

6. To stop edger, move wheel drive control to DISENGAGE position.