



Electric Bed Lift Kit

2011 and After Workman® MD/MDX/MDX-D Utility Vehicle

Model No. 07381—Serial No. 312000001 and Up

Installation Instructions

Safety

Safety and Instructional Decals



Safety decals and instructions are easily visible to the operator and are located near any area of potential danger. Replace any decal that is damaged or lost.

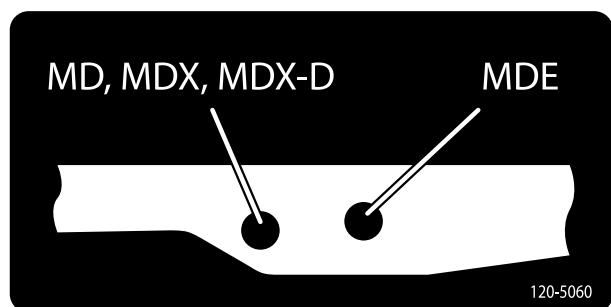

120-5060

Installation

Loose Parts

Use the chart below to verify that all parts have been shipped.

Procedure	Description	Qty.	Use
1	No parts required	—	Prepare the Machine
2	Lift bracket, upper Pan-head, Phillips screw (3/8 x 2-1/2 inches) Flange locknut (Whiz lock) (3/8 inch) Lift actuator Clevis pin Hair pin cotter	1 4 4 1 1 1	Install the bed lift.
3	Switch Thermal fuse, 15 amp Clevis pin (3-1/2 inch) Hair pin cotter	1 1 1 1	Install the switch

Note: Determine the left and right sides of the machine from the normal operating position.

1

Preparing the Machine

No Parts Required

Procedure

1. Position the machine on a level surface. Set the parking brake, turn the ignition off, and remove the key.

⚠ WARNING

If you leave the key in the ignition switch, someone could accidentally start the machine and seriously injure you or other bystanders.

Remove the key from the ignition switch before you do any maintenance.

2. Lift the lever on either side of the box and lift the box up (Figure 1).

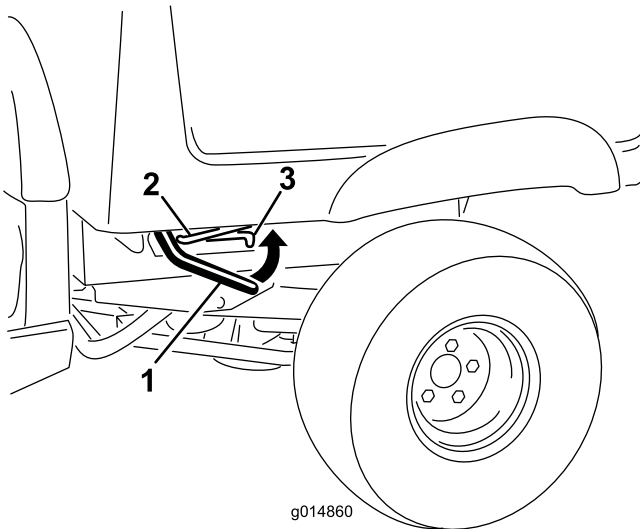

Figure 1

1. Lever
2. Prop rod
3. Detent slot

⚠ WARNING

A raised box could fall and injure persons that are working beneath it.

- Always use the prop rod to hold the box up before working under the box.
- Remove any load material from the box before raising it.

4. Remove the 4 flange nuts securing the latch rod brackets to the underside of the box (Figure 2). Remove and save the rod and latches. Leave the carriage bolts in the holes and secure them to the bed with the flange nuts.

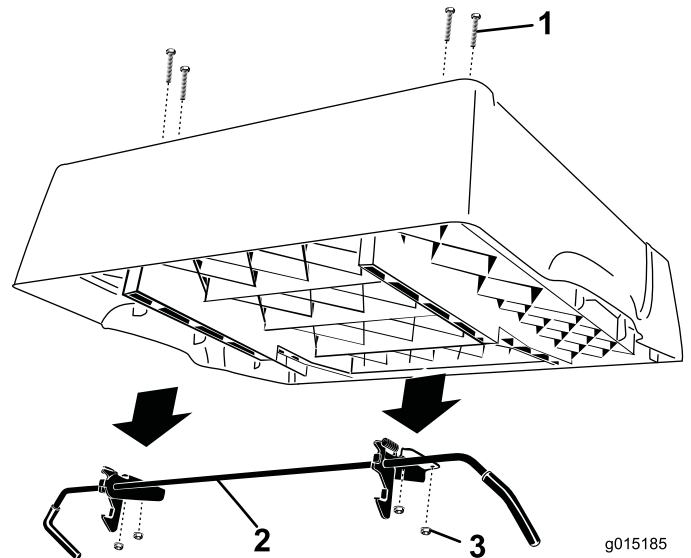

Figure 2

1. Carriage bolts—leave in the bed
2. Latch rod
3. Flange nut

3. Pull the prop rod into the detent slot, securing the box (Figure 1).

2

Installing the Bed Lift

Parts needed for this procedure:

1	Lift bracket, upper
4	Pan-head, Phillips screw (3/8 x 2-1/2 inches)
4	Flange locknut (Whiz lock) (3/8 inch)
1	Lift actuator
1	Clevis pin
1	Hair pin cotter

Procedure

1. Locate the 4 bosses on the underside of the box on the right side (Figure 3). Using a drill with a 3/8 inch (9.5 mm) bit, carefully drill up through the bosses to make four holes through the floor of the bed.

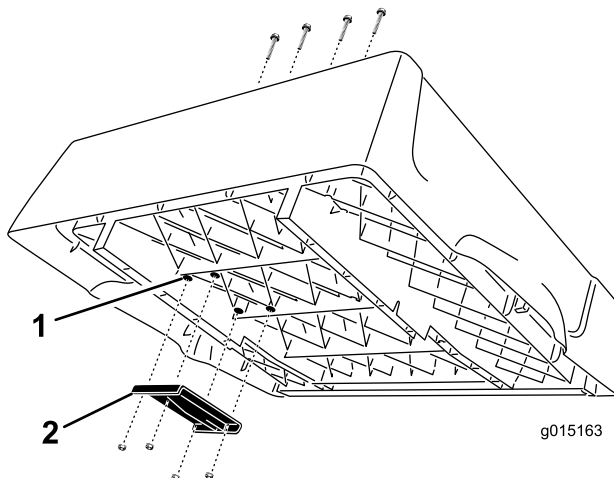

Figure 3

1. Bosses
2. Upper lift bracket

2. Mount the upper lift bracket to the underside of the box with 4 pan-head, Phillips screws (3/8 x 2-1/2 inches) and flange locknuts (Whiz lock) (3/8 inch). Position the bracket as shown in Figure 3.
3. Torque the nuts to 200 in-lb (22.6 N-m).
4. Locate the mounting arm on the vehicle frame. Mount the lift actuator to mounting arm. Use a clevis

pin (2-1/4 inch) and hair pin cotter to secure the lift cylinder to the arm as shown in Figure 4.

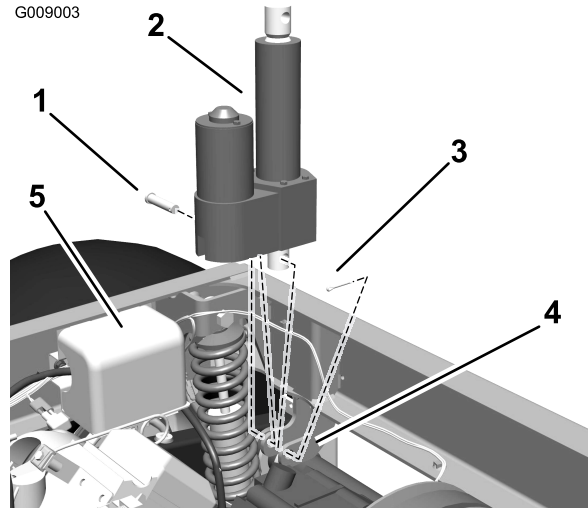

Figure 4

1. Actuator
2. Lift cylinder support
3. Clevis pin
4. Hair pin cotter

3

Installing the Switch

Parts needed for this procedure:

1	Switch
1	Thermal fuse, 15 amp
1	Clevis pin (3-1/2 inch)
1	Hair pin cotter

Procedure

1. Remove the plug from the hole in the right side of the dash (Figure 5).

Note: If the hole in the dash is in use, measure over 1/2 inch (13 mm) and cut another 0.835 inch x 1.46 inch (21 mm x 35 mm) rectangular hole in the dash. Make sure not to damage any existing components behind the dash when cutting the hole.

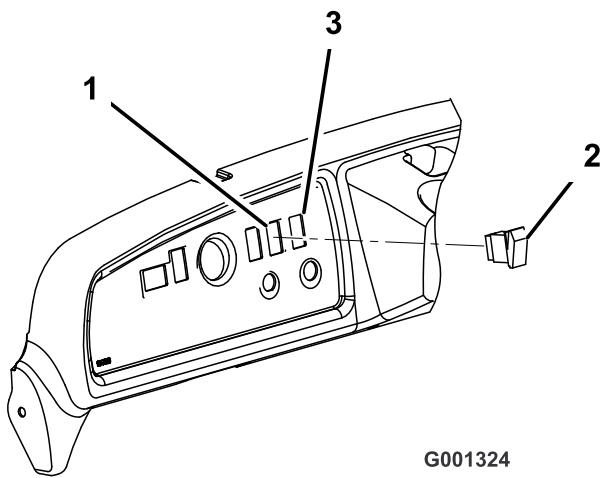

Figure 5

1. Plugged hole
2. Switch
3. Cut new hole (if required).

on the carriage bolts to secure them in the bed and cover the holes.

10. Slide the prop rod forward to remove it from the bracket on the frame. Retain the prop rod components for future use.

Note: If the electric box lift is ever removed, reinstall the prop rod and latch rod using the existing fasteners and the prop rod bracket.

2. Plug the switch into the harness connector in the dash. Insert the switch into the hole in the dash (Figure 5).
3. Install a new thermal fuse (15 amp) into the open slot in the fuse block.
4. Plug the actuator harness into the vehicle harness connector, located near the electrical control cover located inside the right, rear of the vehicle frame.
5. Install the battery and connect the cables.
6. Press the switch upward to extend the actuator rod until it is aligned with the mounting holes in the upper lift bracket.
7. Locate the two sets of holes in the upper lift bracket (Figure 6). Select the set of holes in the bracket for the gasoline and diesel vehicles.

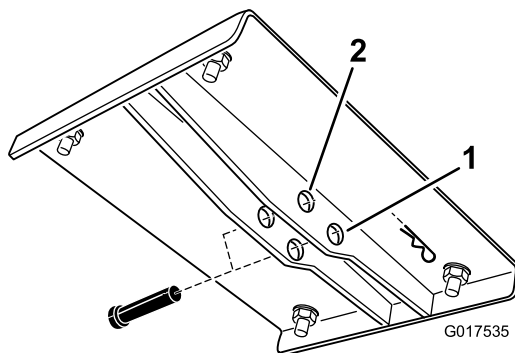

Figure 6

1. Hole for gasoline and diesel powered vehicles
2. Hole for electric vehicles

8. Secure the rod to the bracket with the clevis pin (3-1/2 inch) and hair pin cotter.
9. Remove the nuts and bracket securing the prop rod to the underside of the bed. Install the nuts back

Operation

Important: When a ratcheting noise is heard, the box lift is completely extended or retracted. Do not continue pressing the switch.

Raising the Bed

⚠ WARNING

Driving the vehicle with the cargo box raised may cause the vehicle to tip or roll easier. The box structure may become damaged if the box is raised for an extended period of time while operating the vehicle.

- Only operate the vehicle when the cargo box is down.
- After a load has been dumped, lower the cargo box.

1. Turn the ignition key to the On position.
2. Push the top of the switch to raise the box.

Lowering the Bed

⚠ CAUTION

The weight of the box may be heavy. Hands or other body parts could be crushed.

Keep hands and other body parts clear when lowering the box.

Push the bottom of the switch to lower the box.

Important: When a ratcheting noise is heard, the box lift is completely extended or retracted. Do not continue pressing the switch.

Note: The actuator may cause slight deformation to the bed after it is fully lowered and before the actuator clutch engages. Release the switch when a ratcheting noise is heard.

Servicing the Air Cleaner on the Workman MDX-D

To remove the air cleaner filter element from the air cleaner, as follows:

- Remove the hair pin cotter and clevis pin securing the actuator rod to the upper lift bracket.
- Tip the box all the way up.
- Rotate the actuator forward.

- Remove the air cleaner and service as required.
- Install the air cleaner.

⚠ WARNING

The weight of the box may be heavy. Hands or other body parts could be crushed.

Keep hands and other body parts clear when lowering the box.

Notes:

Notes:



Count on it.