



Z Master® Riding Mower

Models 74936, 74938, 74960CP and 74961CP

Form No. 3372-274 Rev A

Addendum

Installing the Air Filter Assembly

Important: To prevent engine damage, always operate the engine with both air filters and cover installed.

1. Make sure the air filter assembly is installed in the brackets.
2. Position the air cleaner cover so that the breather valve does not interfere with the throttle mechanism (Figure 1).

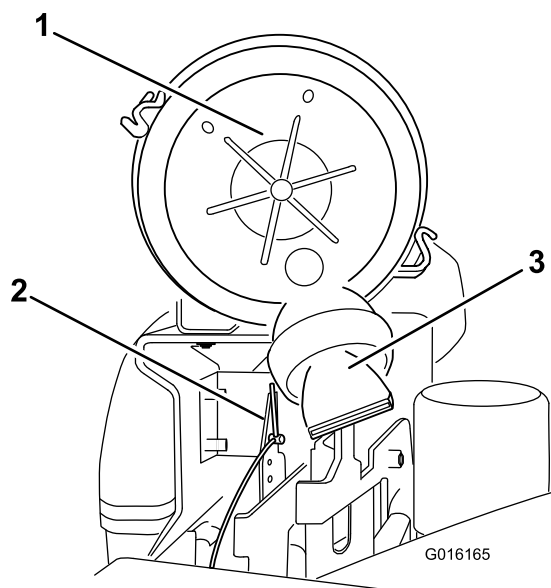

Figure 1

- | | |
|-----------------------|-------------------|
| 1. Air cleaner cover | 3. Breather valve |
| 2. Throttle mechanism | |

3. Secure the cover with the latches.