



# Weight Kit

## Greensmaster® 3300/3400 Series Traction Unit

Model No. 121-6665

### Installation Instructions

## Loose Parts

Use the chart below to verify that all parts have been shipped.

Description	Qty.	Use
Weight plate	3	Install the kit.
Locknut	2	
Hex-head bolt	2	

## Installing the Weight Kit

1. Park the machine on a level surface.
2. Stop the engine, wait for all moving parts to stop, set the parking brake, and remove the key.
3. Raise the machine with a jack at the jack point (Figure 1).

7. Mount 3 weight plates from the kit to the right-hand side of the castor fork with 2 hex-head bolts (1/2 x 5-1/2 inch) and 2 locknuts from the kit (Figure 1).

**Note:** Torque the locknuts to 65 to 85 ft-lb (88 to 115 N-m).

8. Install the tire with the 4 lug nuts previously removed.
9. Torque the lug nuts to 65 to 85 ft-lb (88 to 115 N-m).
10. Lower the machine.

**Important:** Torque the lug nuts, weight adapters, and locknuts to 65 to 85 ft-lb (88 to 115 N-m) every 200 operating hours.

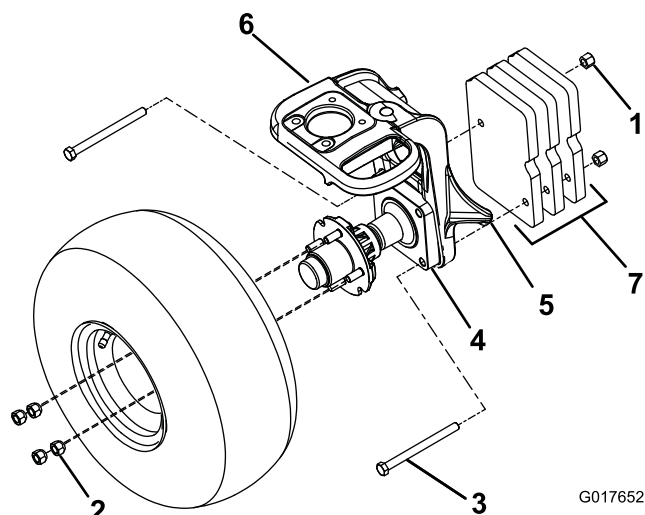

Figure 1

- |                      |                |                      |
|----------------------|----------------|----------------------|
| 1. Locknut (2)       | 4. Spindle     | 7. Weight plates (3) |
| 2. Lug nut (4)       | 5. Jack point  |                      |
| 3. Hex head bolt (2) | 6. Castor fork |                      |

4. Remove the 4 lug nuts on the wheel in pairs positioned diagonally from each other (Figure 1).
5. Remove the tire and set it aside to be installed later.
6. Remove the 2 retaining bolts that secure the spindle to the castor fork (Figure 1).