



XLS 380 and XLS 420T Lawn Tractors

Model No. 71254—Serial No. 311000001 and Up

Model No. 71255—Serial No. 311000001 and Up

Form No. 3367-140 Rev C

Setup Instructions

Loose Parts

Use the chart below to verify that all parts have been shipped.

Procedure	Description	Qty.	Use
1	No parts required	—	Connect the battery.
2	Front wheel Shim washer (as needed) Flat washer Cotter pin Hub cap	2 2 2 2 2	Install the front wheels.
3	No parts required	—	Check the tire pressure.
4	Steering wheel Spirol pin	1 1	Install the steering wheel.
5	Seat Knob Flat washer	1 2 2	Install the seat.
6	No parts required	—	Check the engine oil level.
7	Mowing deck	1	Install and adjust the mower.
8	No parts required	—	Lubricate the tractor.
9	No parts required	—	Check the safety interlock system.
10	No parts required	—	Test drive the tractor.
11	No parts required	—	Remove the EPA decal.

1

No Parts Required

Procedure

1. Locate the battery and negative battery cable.

2. Remove the plastic cap from the negative battery post.
3. Remove the fasteners on the negative battery cable and use them to secure the negative battery cable to the negative battery post (Figure 1).

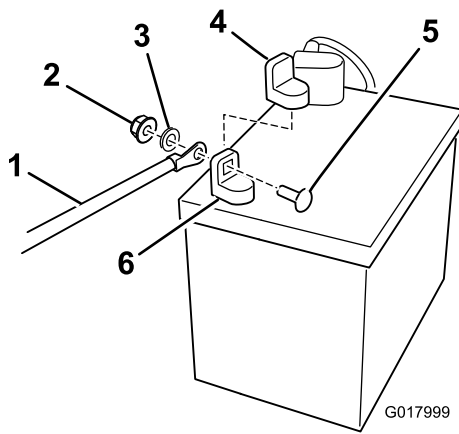

Figure 1

- | | |
|---------------------------|------------------------------|
| 1. Negative battery cable | 4. Negative battery post cap |
| 2. Locknut | 5. Carriage bolt |
| 3. Washer | 6. Negative battery post |

2

Installing the Front Wheels

Parts needed for this procedure:

2	Front wheel
2	Shim washer (as needed)
2	Flat washer
2	Cotter pin
2	Hub cap

Procedure

If the wheels are already installed, refer to Checking the Tire Pressure below.

1. Install the shim washers onto the axle.
2. Install the wheel onto the axle with the valve stem facing outward.
3. Slide the flat washer onto the axle.
4. Insert the cotter pin through the axle and bend the ends of the pin apart (Figure 2).

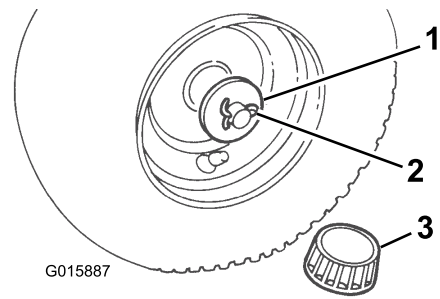

Figure 2

- | | |
|----------------|------------|
| 1. Flat washer | 3. Hub cap |
| 2. Cotter pin | |

Note: If the cotter pin does not fit, remove the shim washer(s) as needed.

5. Push the hub cap (Figure 2) onto the end of the axle.
6. Repeat steps 1 through 5 on the opposite side of the tractor.
7. Grease the wheel bearings until the grease comes out of the bearing seal area.

3

Checking the Tire Pressure

No Parts Required

Procedure

Check the tires to ensure that they are inflated to the recommended pressure. Refer to Checking the Tire Pressure section in the *Operator's Manual*.

4

Installing the Steering Wheel

Parts needed for this procedure:

1	Steering wheel
1	Spirol pin

Procedure

1. Move the front wheels so that they face straight ahead.
2. Slide the steering wheel over the steering shaft and line up the hole in the steering wheel with the hole in the shaft (Figure 3).

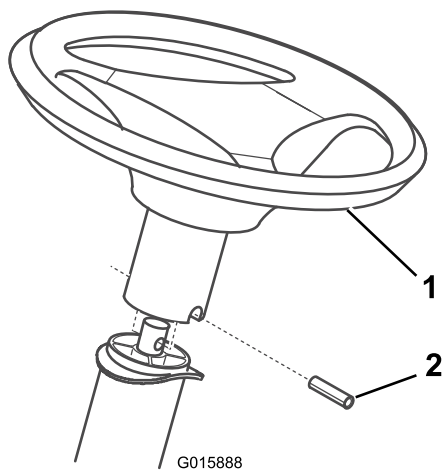

Figure 3

1. Steering wheel 2. Spirol pin

Note: From the seat you should be able to easily read the brand logo on the steering wheel.

3. Align the holes by inserting a punch or a long nail partially through the holes in the steering wheel and shaft.
4. Insert the spirol pin into the hole on the opposite side.
5. Using a hammer, drive the spirol pin in until it is flush with the outside of the steering wheel (Figure 3).

5

Installing the Seat

Parts needed for this procedure:

1	Seat
2	Knob
2	Flat washer

Procedure

1. Position the seat onto the seat base by inserting 2 shoulder bolts through the key hole openings at the end of both slots (Fig. 3).

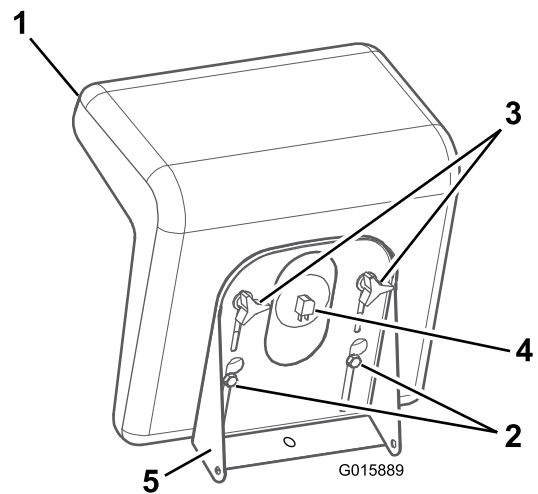

Figure 4

1. Seat 4. Seat switch
2. Shoulder bolts 5. Seat base
3. Knobs and flat washers

2. Thread the knobs and flat washers through the slots and into the rear center holes in the seat (Figure 4).
3. Adjust the seat and tighten the knobs.
4. Connect the seat switch to the wire harness connector (Figure 4).

Note: Ensure that the wiring is not pinched in the seat brackets.

6

Checking the Engine Oil Level

No Parts Required

Procedure

The tractor comes from the factory with oil in the engine crankcase; however, you may be need to add oil. Refer to Servicing the Engine Oil in the *Operator's Manual* for oil type, viscosity, and crankcase capacity. Add only enough oil to raise the level to the Full mark on the dipstick.

7

Installing and Adjusting the Mower

Parts needed for this procedure:

1	Mowing deck
---	-------------

Procedure

Install the mowing deck and adjust both the side-to-side level and the front-to-rear blade slope. See the chapter on Blade Maintenance in the *Operator's Manual* for the procedures: Installing the Mower, Leveling the Mower from Side-to-Side, and to Adjusting the Front-to-Rear Blade Slope.

8

Lubricating the Tractor

No Parts Required

Procedure

Ensure that all of the necessary points on the tractor are lubricated; refer to Greasing and Lubricating the Tractor in the *Operator's Manual*.

9

Checking the Safety Interlock System

No Parts Required

Procedure

Refer to Testing the Safety Interlock System in the *Operator's Manual*.

10

Test Driving the Tractor

No Parts Required

Procedure

To ensure that all electrical and mechanical systems are operating properly, see the *Operator's Manual*.

11

Removing the EPA Decal

No Parts Required

Procedure

The decal shown in Figure 5 may be removed at points of sale outside of the United States of America. This decal is located as shown in Figure 6.

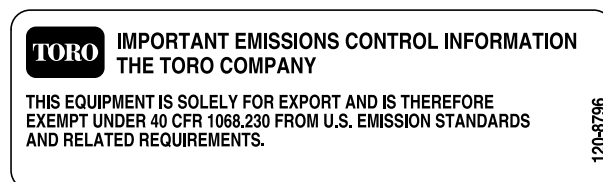

Figure 5

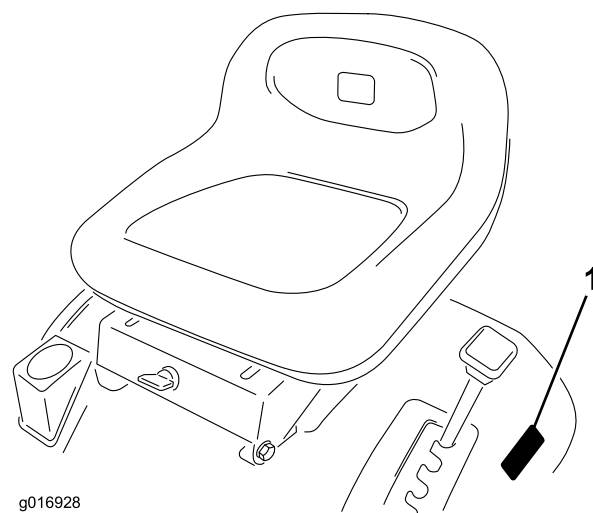

Figure 6