



Mechanical Seat Suspension Kit

Groundmaster® Traction Units

Model No. 30312

Form No. 3373-182 Rev A

Installation Instructions

Installation

Groundmaster 3320 and 3280 traction units

1. Secure the lower seat brackets to the seat suspension with the (4) bolts included with the kit (Figure 1).
2. Remove the (4) bolts and nuts securing the seat mounting plate to the traction unit frame (Figure 1). Do not remove the seat plate.

Note: To accomplish the following step, each side of the seat mounting plate must be propped up, one side at a time, to mount the components and retaining the seat switch wire harness connector, in position, on top of the plate.

3. Secure the lower seat brackets and the seat suspension to the seat plate with the (4) bolts and nuts included with the kit (Figure 1).
- Note:** When assembling the seat components, use the back mounting holes.
4. Secure the L.H. and R.H. seat mounts to the seat with (4) bolts (Figure 1). The seat mounts are to be positioned so the high ends are to the front of the seat.
 5. Loosely install the seat adjusters to the seat mounts with the (4) bolts, flatwashers and nuts included with the kit (Figure 1). Do not tighten. The seat adjuster with the adjustment lever is to be mounted to the left seat mount.
 6. Plug the seat switch harness into the seat switch connector.
 7. Mount the upper seat adjusters to the seat suspension with the (4) nuts included with the kit (Figure 1). Insert the vinyl caps onto the seat studs. Tighten the fasteners securing the seat adjusters.

Note: When assembling the seat components, use the front mounting holes.

8. Lower and secure the seat plate w/seat assembly to the traction unit frame with the (4) bolts and nuts previously removed.
9. Plug the wire harness into the seat switch harness.
10. Slide the seat completely forward and backward to ensure proper operation and that the seat switch

wires and connectors are not pinched or do not contact any moving parts.

Groundmaster 4500 and 4700 traction units

1. Unlatch and raise the seat base.
2. Secure the lower seat brackets to the seat suspension with the (4) bolts included with the kit (Figure 1).
3. Secure the lower seat brackets and the seat suspension to the seat plate with the (4) bolts and nuts included with the kit (Figure 1). Use the rear set of mounting holes in the seat plate and the forward set of mounting holes in the lower seat brackets.
4. Mount the upper seat brackets to the seat with the (4) bolts, flatwashers and nuts included with the kit (Figure 1). Use the front set of mounting holes in the seat. The seat bracket with the adjustment lever is to be mounted to the left side of the seat.
5. Mount the upper seat brackets to the seat suspension with the (4) washers and nuts included with the kit (Figure 1). Use the rear set of mounting holes in the seat suspension. The washers are to be positioned between the seat brackets and the seat suspension. Insert the vinyl caps onto the seat studs.
6. Lower and latch the seat base w/seat assembly.
7. Plug the seat switch connector into the wire harness connector.
8. Slide the seat completely forward and backward to ensure proper operation and that the seat switch wires and connectors are not pinched or do not contact any moving parts.

Operation

- Adjusting Lever—Fore and aft seat adjustment (Figure 2).
- Weight Adjusting Knob—Adjust for operator weight (Figure 2).
- Weight gauge—Indicates when seat is adjusted to the weight of the operator (Figure 2).
- Height Adjusting Knob—Adjust for operator height (Figure 2).

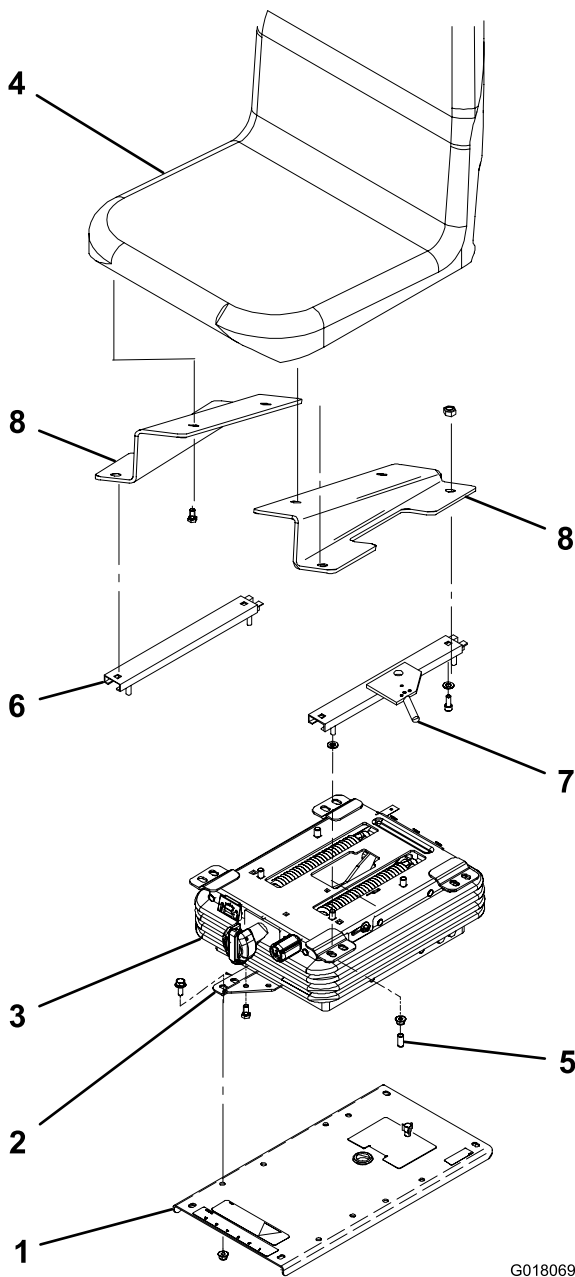

Figure 1

- | | |
|------------------------|---|
| 1. Seat plate | 5. Vinyl cap |
| 2. Lower seat brackets | 6. Seat adjuster |
| 3. Seat suspension | 7. Seat adjuster with lever |
| 4. Seat | 8. Seat mount (L.H. & R.H.)
(Groundsmaster 3320 & 3280 only) |

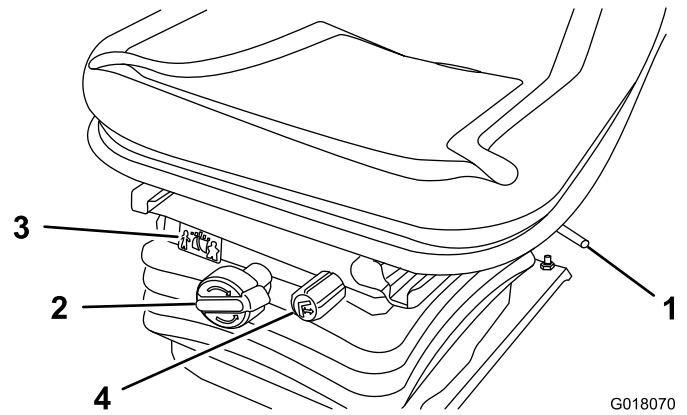

Figure 2

- | | |
|-----------------------------------|--------------------------|
| 1. Adjusting lever (fore and aft) | 3. Weight gauge |
| 2. Weight adjusting knob | 4. Height adjusting knob |