



Belt Guard Kit
DH 200 Series Lawn Tractor
Model No. 111-6032

Form No. 3373-761 Rev A

Installation Instructions

Do not supply these instructions to the customer.

These instructions are for a dealer to install additional belt guards mandated by the French government.

Safety

Important: Refer to the *Operator's Manual* if you are unfamiliar with operating this machine before proceeding. The manual contains important information about safely operating the machine. If you do not know this information, you could seriously injure yourself or others.

Important: You will need to drill holes in the machine to install this kit. Always wear eye protection when you drill.

Safety and Instructional Decals



Safety decals and instructions are easily visible to the operator and are located near any area of potential danger. Replace any decal that is damaged or lost.



120-1119

1. Fire hazard—read the *Operator's Manual*.

Installation

1

Preparing for Installation

No Parts Required

Procedure

1. Park the machine on a level, smooth surface with sufficient space to access both sides of the mowing deck.
2. Lower the mowing deck to the shortest cutting height.
3. Stop the engine, wait for all moving parts to stop, set the parking brake, remove the ignition key from the ignition switch, and disconnect the spark-plug wire.

CAUTION

If you leave the key in the ignition switch, someone could accidentally start the engine and seriously injure you or other bystanders.

Remove the key from the ignition switch and disconnect the wire from the spark plug before you install the kit. Set the wire aside so that it does not accidentally contact the spark plug.

4. Raise the rear of the machine off the ground, support both ends of the rear axle with jack stands, and remove both rear wheels.

2

Installing the Deck Guard

Parts needed for this procedure:

1	Deck-belt-cover guard
2	Bolt (M5 x 12)
2	Washer (M5.3)
2	Locknut (M5)

Procedure

1. Place the deck-belt-cover guard onto the deck-belt cover where it is to be installed, and mark its position; refer to Figure 1.

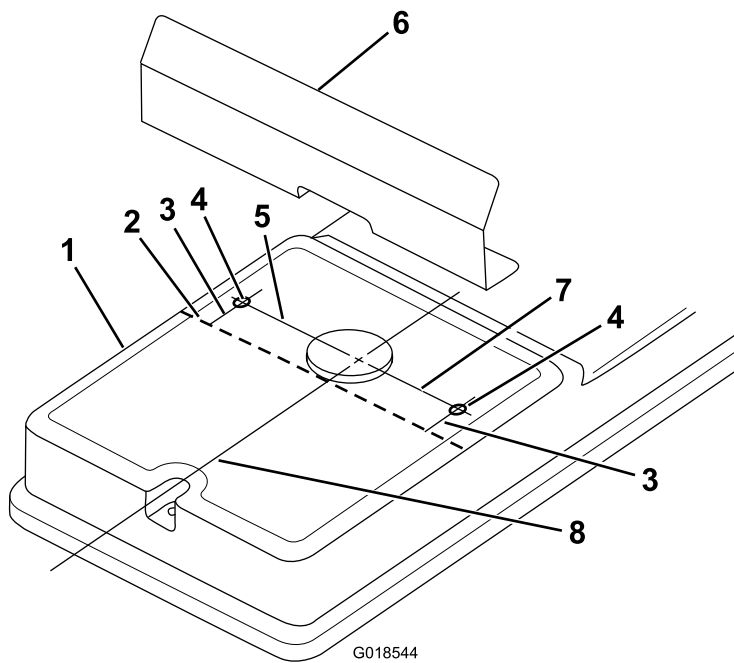

Figure 1

Drawing not to scale

- | | |
|---|--------------------------|
| 1. Deck-belt cover | 5. Approximately 9.5 cm |
| 2. Mark the position of the deck-belt-cover guard here. | 6. Deck-belt-cover guard |
| 3. Approximately 2.0 cm | 7. Approximately 9.0 cm |
| 4. Drill a hole (6.0 mm) here. | 8. Centerline |

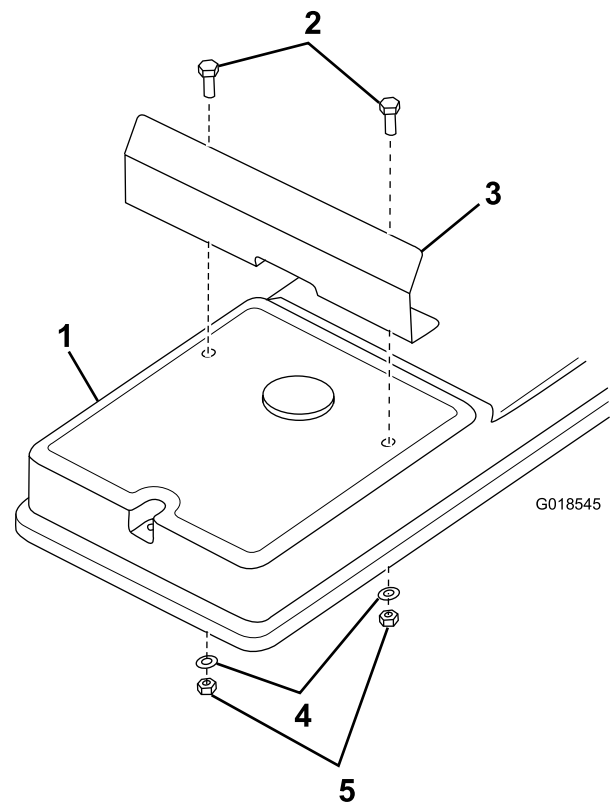

Figure 2

- | | |
|--------------------------|------------|
| 1. Deck-belt cover | 4. Washers |
| 2. Bolts | 5. Nuts |
| 3. Deck-belt-cover guard | |

4. Raise the deck to the highest cutting height to verify that the deck-belt-cover guard clears all wires, switches, and belts, and that it will not interfere when you operate the machine or the cutting deck.

2. Drill 2 holes (6 mm diameter) in the top of the deck-belt cover in the locations shown in Figure 1.
3. Secure the deck-belt-cover guard to the deck-belt cover with 2 bolts, 2 washers, and 2 nuts as shown in Figure 2.

3

Installing the Left-Belt Guard

Parts needed for this procedure:

1	Left-belt guard
8	Self-tapping screw

Procedure

1. Lower the mowing deck to the shortest cutting height.
2. Use a mounting bracket as a template and drill 2 holes (3.6 mm diameter) in the frame on the left-hand side of the machine in the locations shown in Figure 3.

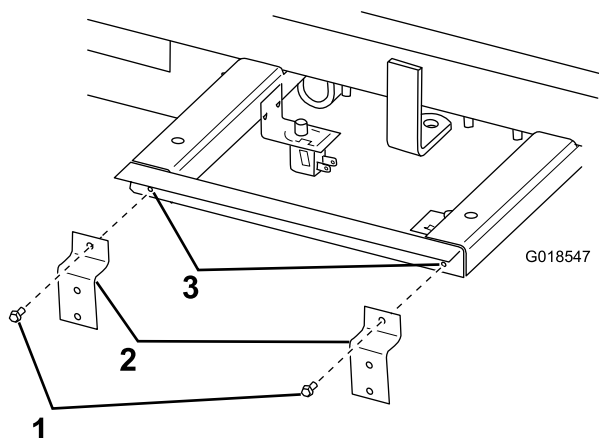

Figure 3

1. Self-tapping screws
2. Mounting brackets
3. Drill holes (3.6 mm diameter) here.

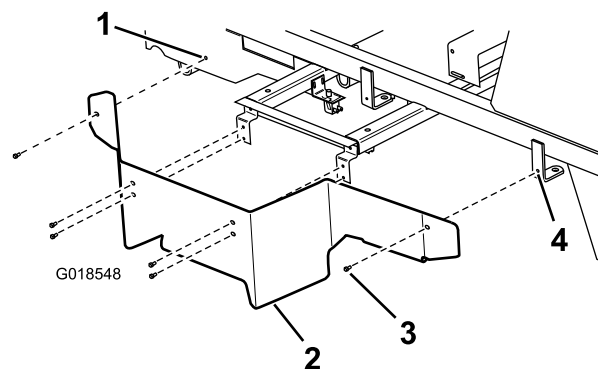

Figure 4

1. Drill a hole (3.4 mm diameter) in the frame here.
2. Left-belt guard
3. Self-tapping screw (6)
4. Drill a hole (3.6 mm diameter) in the support bracket here.
5. Drill a hole (3.6 mm diameter) at the location you marked on the support bracket.
6. Secure the left-belt guard to the left-hand side of the machine using self-tapping screws in the existing holes in the machine as shown in Figure 4.
7. Drill a hole (3.4 mm diameter) in the left-hand side of the frame using the remaining hole in the left-belt guard as a template; refer to Figure 4.
8. Insert a self-tapping screw in the hole and finish securing the left-belt guard to the frame; refer to Figure 4.
9. Raise the deck to the highest cutting height to verify that the left-belt guard clears all wires, switches, and belts, and that it will not interfere when you operate the machine or the cutting deck.

3. Install the mounting brackets (Figure 3).
4. Place the left-belt guard onto the left-hand side of the machine (where it is to be installed), line up the holes, and mark the location on the support bracket where you need to drill a hole; refer to Figure 4.

4

Installing the Right-Belt Guard

Parts needed for this procedure:

1	Right-belt guard
1	Self-tapping screw

Procedure

1. Lower the mowing deck to the shortest cutting height.
2. Place the right-belt guard onto the right-hand side of the machine (where it is to be installed), line up the holes, and mark the location on the support bracket where you need to drill a hole; refer to Figure 5.

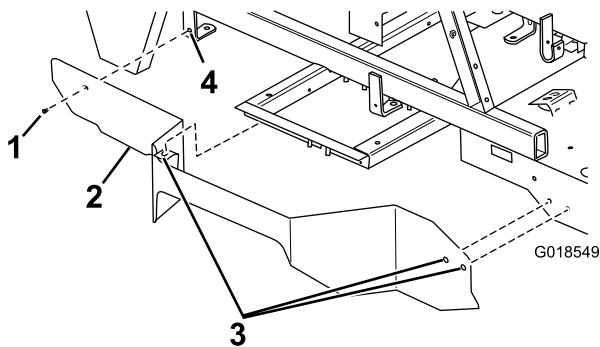

Figure 5

1. Self-tapping screw
2. Right-belt guard
3. Drill a hole (3.6 mm diameter) at the location you marked on the support bracket.
3. Use existing fasteners on the machine to secure the guard at these places here.
4. Drill a hole (3.6 mm diameter) here.
4. Secure the right-belt guard to the right-hand side of the machine using a self-tapping screw and the existing fasteners on the machine as shown in Figure 5.
5. Raise the deck to the highest cutting height to verify that the right-belt guard clears all wires, switches, and belts, and that it will not interfere when you operate the machine or the cutting deck.