



PART NO. 93-3900

# INSTALLATION INSTRUCTIONS

## WIRE HARNESS KIT WORKMAN 3000 SERIES

*Helping you put quality into play.™*

1. Raise bed and install safety support on fully extended lift cylinder rod (if so equipped).
2. Stop engine, set parking brake and remove key from ignition switch.
3. Remove positive (+) battery cable from battery.
4. Remove head light bulbs from both headlights.

**Note:** Do not touch bulbs with fingers as oil from hands may lead to early bulb failure.

5. Remove (15) screws and washers securing front hood to vehicle frame and remove hood.

**NOTE:** If Signal Light Kit, Part No. 93-3901, is going to be installed on vehicle proceed to step 6, otherwise proceed to step 7.

6. At approximate location shown in figure 1, locate, mark and drill (3) .219 dia. holes thru underside of dash channel. Holes should be approximately 9.00" apart. Holes may be present in some machines. These holes will be used to mount components of the Signal Light Kit.

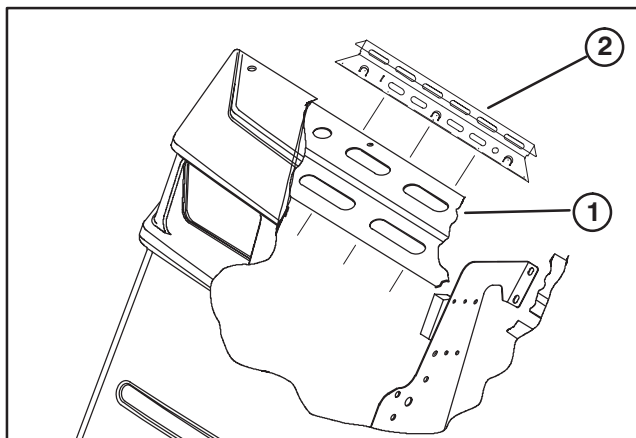

**Figure 1**

1. Dash channel
2. Top View Of Dash Channel
3. Hole Locations

7. Mount switch bracket to dash panel with (4) 1/4-20 x 5/8" lg. capscrews and locknuts (Fig. 2). There are (3) sets of mounting holes in vehicle dash panel. Use available set, depending on what other optional equipment has been installed.

**NOTE:** Switch bracket installation is not required if a bracket is already mounted on vehicle and enough switch mounting holes are available to install desired light kit(s).

Signal Light Kit, part no. 93-3901 requires (1) switch  
Work Light Kit, part no. 93-3903 requires (2) switches

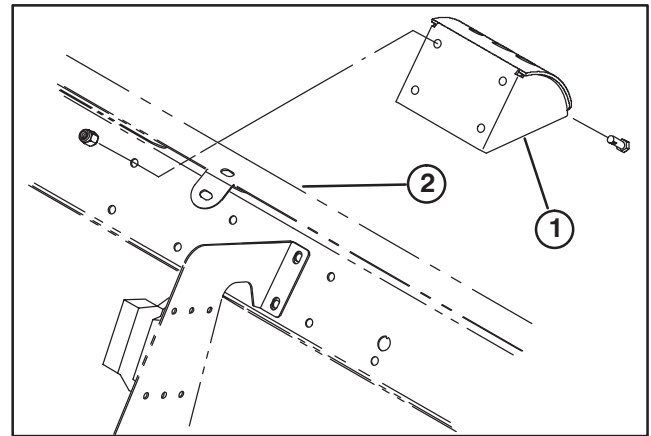

**Figure 2**

1. Switch bracket
2. Dash panel

**NOTE:** When installing switch bracket on diesel machines and using left set of mounting holes, glow plug switch must be removed from dash panel and reinstalled in upper left hole in switch bracket.

8. Upon completion of light kit installation, insert snap-in plugs into all unused holes in switch bracket.

9. Slide new fuse block assembly onto side of existing vehicle fuse block (Fig. 3).

10. Mount new fuse block to vehicle frame with (2) #10-24 screws, washers and locknuts (Fig. 3).

**NOTE:** Fuse block installation is not required if existing vehicle fuse block has enough open fuse locations to install desired light kit(s).

Signal Light Kit, part no. 93-3901 requires (2) fuses  
Work Light Kit, part no. 93-3903 requires (1) fuse

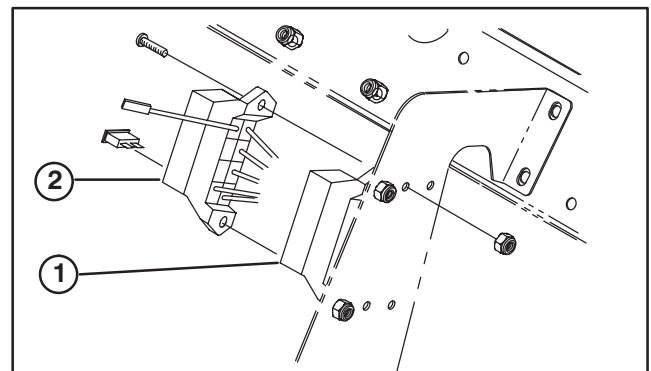

**Figure 3**

1. Vehicle fuse block
2. New fuse block

11. Insert end of main wire harness, with connector body w/(2) male terminals on it, up through opening in

vehicle floor board, toward dash panel, following vehicle wire harness. Secure harness to vehicle wire harness with (2) cable ties.

**12.** Remove fasteners securing wire harness cover to under side of vehicle floor and remove cover.

**13.** Route wire harness rearward, to left post of ROPS (Fig. 4). Harness must not interfere with operation of brake pedal return spring or any moving parts. Large connectors from harness should be positioned at left base of ROPS.

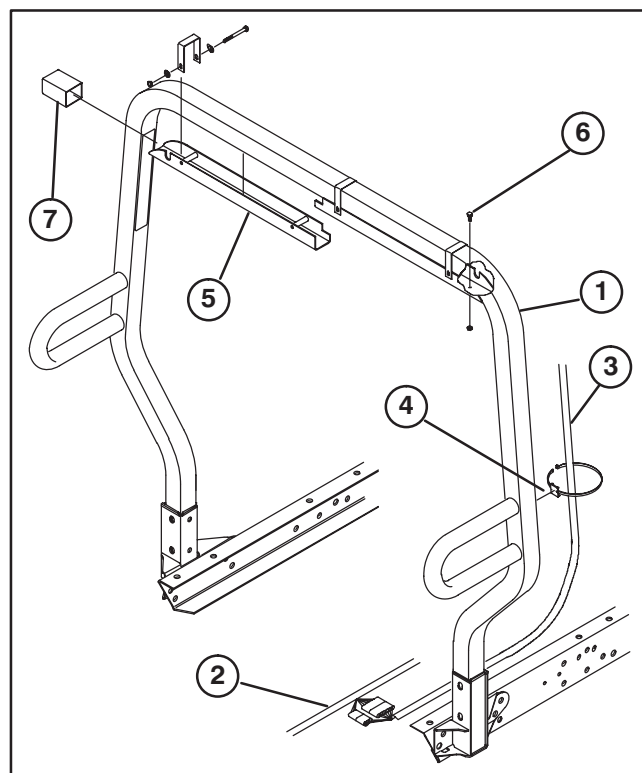

**Figure 4**

- |                      |                  |
|----------------------|------------------|
| 1. ROPS              | 5. Light Channel |
| 2. Main Wire Harness | 6. Ground Screw  |
| 3. ROPS Wire Harness | 7. Channel Cap   |
| 4. Cable Tie Mount   |                  |

**14.** Reinstall wire harness cover over harness' and secure to under side of vehicle with fasteners previously removed.

**15.** Affix (4) cable tie mounts to back side of left ROPS post (Fig. 4). Mounts to be equally spaced on post. **Do Not Drill Any Holes In ROPS.**

**16.** Assemble appropriate light kit components to each light channel (Fig. 4). Refer to installation instructions for specific light kit for mounting instructions.

**17.** Plug ROPS harness into appropriate light kit connections in channels. Curved ends of channels to fit outward under ROPS.

**18.** Secure ring terminal wire (ground wire) from ROPS harness to left light channel with a 1/4–20 x 5/8" lg. capscrew and locknut (Fig. 4).

**19.** Mount each light channel to underside of ROPS with (2) channel mount brackets, (2) 1/4–20 x 2–3/4" lg. capscrews, (4) flat washers and (2) locknuts (Fig. 4). ROPS harness to be routed thru slot in each channel.

**NOTE:** If vehicle is equipped with a cab, mount light channels to top of ROPS and install a channel cap on curved end of each channel.

**20.** Route harness down left side of ROPS and connect to main harness (Fig. 4).

**21.** Secure harness to cable tie mounts on ROPS post with (4) cable ties (Fig. 4).

**22.** If vehicle is operated on a public road, a SMV (slow moving vehicle) emblem (Fig. 5) must be affixed as near to rear and center of vehicle or rear mounted attachment. Mount SMV emblem as follows:

**A.** Using SMV socket as a template, locate, mark and drill (2) .344" dia. holes in a suitable location on rear of vehicle or attachment.

**B.** Mount SMV socket to vehicle or attachment with (2) 5/16–18 x 1" lg. carriage bolts and locknuts (Fig. 5).

**C.** Mount SMV mount spade to SMV emblem with (2) 1/4–20 x 1/2" lg. capscrews and locknuts (Fig. 5).

**D.** Insert SMV mount spade into SMV socket to display SMV emblem.

**Note:** SMV mount spade may be mounted directly to vehicle or attachment, if desired.

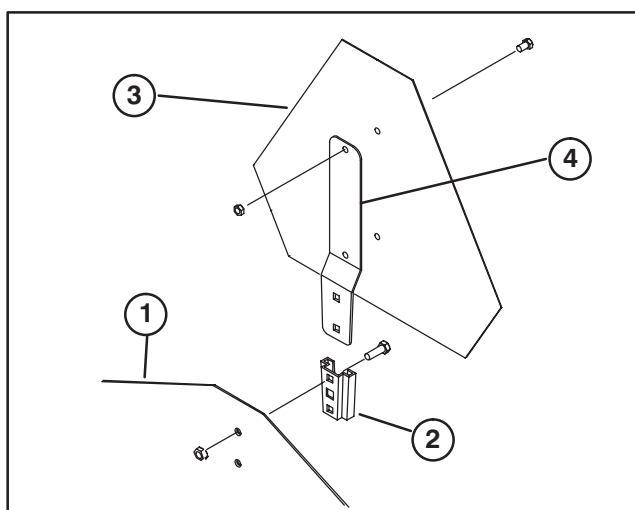

**Figure 5**

- |                      |                    |
|----------------------|--------------------|
| 1. Vehicle or Option | 3. SMV Emblem      |
| 2. SMV Socket        | 4. SMV Mount spade |

**23.** Route harness rear ward and proceed with installation of other light kits per instructions supplied with specific kit or coil up excess harness and secure it to frame with a cable tie. Make sure harness does not interfere with any moving parts.

**24.** Reinstall hood to frame with fasteners previously removed. Reinstall light bulbs in head lights.

**25.** Connect positive (+) battery cable to battery.