



MODEL NO. 07416

# INSTALLATION INSTRUCTIONS

## HAND THROTTLE KIT For Workman 3000 Series

1. Stop engine and remove key from ignition.
2. Mount slotted throttle rod ends to throttle levers with shoulder bolts and locknuts, as shown in figure 1. Make sure rod ends are mounted to sides of levers and bolt shoulders are positioned in rod end slots.

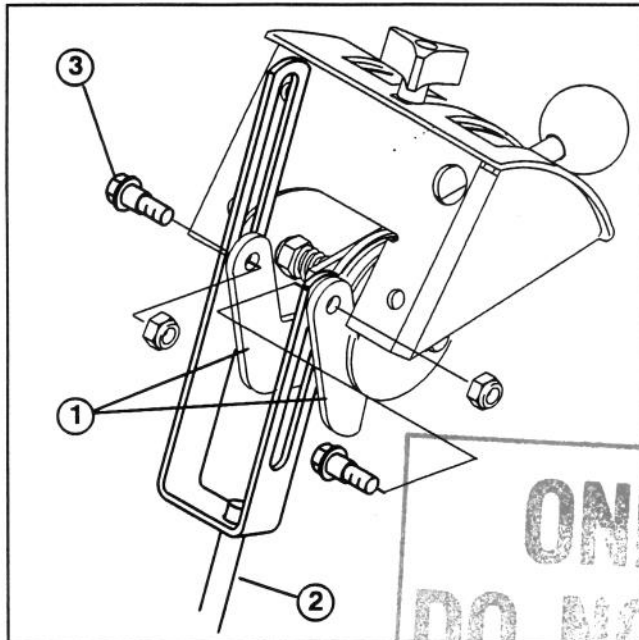
**Figure 1**

1. Throttle levers
2. Throttle rod
3. Shoulder bolt

3. Locate (2) 1/4-20 x 5/8" lg. button head capscrews and nuts securing dash panel to R.H. pedal support (Right of horn button) (Fig. 2).

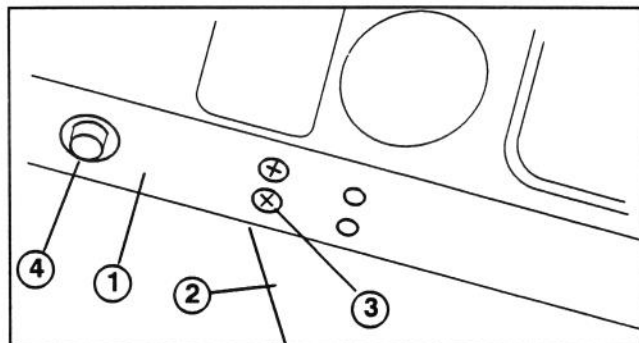
**Figure 2**

1. Dash panel
2. Pedal support
3. Button head capscrew
4. Horn button

4. Remove lower button head capscrew and nut and discard. Do not remove top capscrew and nut.

5. Align mounting holes in back of hand throttle assembly with (3) holes in dash. Large hole in back of assembly fits over remaining screw head in dash panel.

6. Mount hand throttle assembly to dash and pedal support with (3) 1/4-20 x 3/4" lg. capscrews and flange locknuts supplied in kit (Fig. 3).

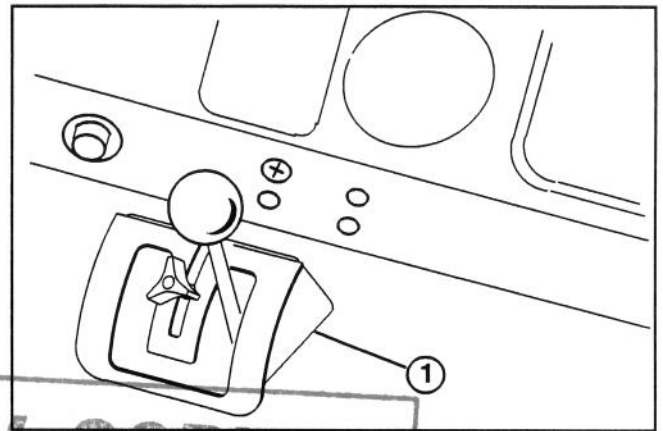
**Figure 3**

1. Hand throttle assembly

7. Move speed control lever to "hand throttle" side (left slot) and push lever all the way upward (full speed).
8. Push accelerator pedal all the way to the floor and hold or brace it there.

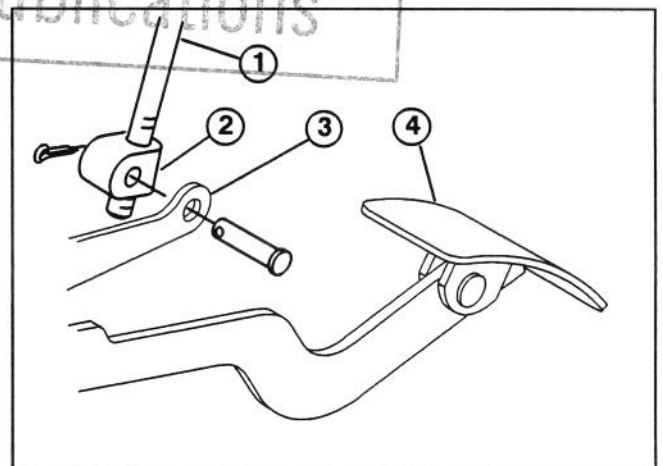
**Figure 4**

1. Throttle rod
2. Plastic fitting
3. Accelerator arm
4. Accelerator pedal

9. While holding up hand throttle rod, rotate plastic rod fitting, on rod, up or down until holes in fitting align with hole in accelerator arm (Fig. 4). Secure fitting to accelerator arm with clevis pin and cotter pin.

10. Release accelerator pedal and move speed control lever to the "speed limiter" side (right slot) and fully upward to the "OFF" position.

**Note:** Adjust tension nut, under cover, on left side of assembly if accelerator pedal will not stay at floor when speed control lever is in the FAST position on the "hand throttle" side.

11. Using dimensions shown in figure 5, locate and apply warning decal to left side of center hood mounting bolt.

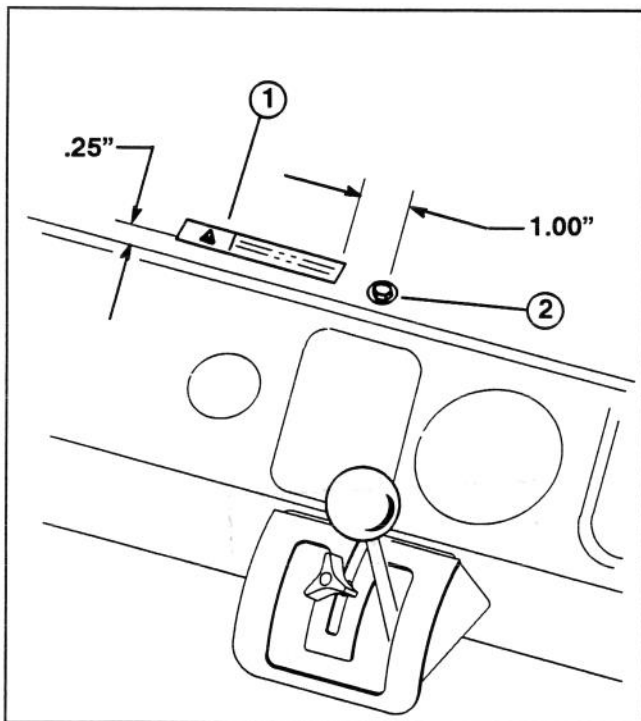

**Figure 5**

1. Warning decal
2. Center hood mounting bolt

12. Start engine and check hand throttle operation to assure maximum and minimum RPM settings can be achieved. Readjust as required.

**NOTE:** If hand throttle will be used with attachments such as pumps, compressors, generators, etc., it is recommended that an optional tachometer be installed to accurately regulate engine speed.

## OPERATION

The speed limiter sets the maximum engine speed (within the preset limits). This allows the engine speed to be varied from idle to the operator set maximum speed. It is very useful to set the desired PTO speed for attachments like sprayers.

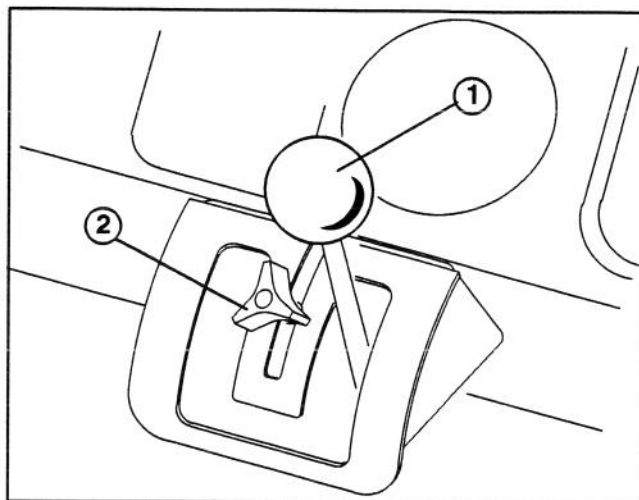

**Figure 6**

1. Speed limiter and hand throttle
2. Stop knob

- With speed control lever in OFF position, loosen stop knob and move it fully upward.
- Slide speed control lever around stop and downward to SLOW position.
- Depress the accelerator pedal to desired maximum RPM.
- Move stop knob downward until it contacts control lever. Tighten knob.
- Release accelerator pedal, then depress again. Check to assure proper RPM is attained.

To disengage speed limiter, move speed control lever fully up.

The hand throttle (left) slot is used for manually setting engine speed. This is used for stationary attachments, like the generator, to set a constant engine or PTO RPM.



## WARNING

**Loss of vehicle control could result from driving vehicle with hand throttle used to control ground speed. The hand throttle also controls the foot throttle, so foot throttle pedal cannot be used to reduce engine and vehicle speed.**

- With speed control lever in OFF position, loosen stop knob and move it fully downward.
- Move speed control lever to left slot and position above stop to achieve desired RPM.
- Move stop knob upward until it contacts control lever. Tighten knob.
- Check to assure proper RPM is attained.

To disengage, move control lever to OFF position.