



UNIVERSAL MOUNT SUNSHADE

Model No. 30359

This Sunshade is intended to be used on the following Toro products and not to be used on any other units.

Groundsmaster 328-D
Groundsmaster 3280D
Groundsmaster 3320
Groundsmaster 360
Groundsmaster 4000-D & 4100D
Groundsmaster 4500-D & 4700D
Groundsmaster 580-D & 5900
Groundsmaster 7200 & 7210
Reelmaster 5200-D, 5400-D & 5500-D
Reelmaster 5210, 5410, 5510 & 5610
Reelmaster 6500-D & 6700-D
Reelmaster 7000-D

Mounting Instructions



www.toro.com

©2005 by The Toro Company
8111 Lyndale Avenue South
Bloomington, MN 55420-1196

⚠ CAUTION: Read and follow all safety statements and assembly instruction, before attempting to mount or operate vehicle with sunshade installed.

⚠ CAUTION: The resulting noise levels when using this product will exceed OSHA standards for an 8 hour work day and hearing protection with a Noise Reduction Rating (NRR) of 22 or higher is required.

⚠ CAUTION: This unit is heavy, and should be mounted with a minimum of two personnel and a hoist.

⚠ INSTALLER: Leave these instructions with end user. If Manual is lost or damaged, please contact your Toro dealer/distributor for replacement.

⚠ END USER: Keep this manual for future reference.

TABLE OF CONTENTS

INTRODUCTION - TO THE PURCHASER	3
TRANSPORTATION CAUTION /HEARING PROTECTION	4
LOOSE PARTS PHOTOS	5
LOOSE PARTS LIST	6
FOR GM3280-D OR GM3320 ONLY	7
PRE-ASSEMBLY	7
INSTALLATION NARROW ROPS	8
INSTALLATION WIDE ROPS	9
BOLT REFERENCE DIAGRAMS	
TORO Groundsmaster 328D	10
TORO Groundsmaster 3280D and 3320	11
TORO Groundsmaster 580	12
TORO Groundsmaster 5900	13
TORO Groundsmaster 4000D, 4100D	14
TORO Groundsmaster 4500D, 4700D, Reelmaster 6500D, 6700D, 7000D	15
TORO Groundsmaster 7200, 7210D	16
TORO Reelmaster 5500D, 5200D, 5400D	17
TORO Reelmaster 5210, 5410, 5510, 5610	18
TORO Groundsmaster 360	19

TO THE PURCHASER

All products are designed to give safe, dependable service if they are operated and maintained according to instructions. Read and understand this manual before operation.

This manual has been prepared to assist the owner and operators in the safe operation and suitable maintenance of the canopy. The information is applicable to products at the time of manufacture and does not include modifications made afterwards.

Read and understand this manual before attempting to put equipment into service. Familiarize yourself with the operating instructions and all the safety recommendations contained in this manual and those labeled on the equipment and on the tractor. Follow the safety recommendations and make sure that those with whom you work follow them.

Illustrations

The illustrations may not necessarily reproduce the full detail and the exact shape of the parts or depict the actual models, but are intended for reference only.

Direction Reference

All references to right and left, forward or rearward, are from the operator's seat, facing the steering wheel.

Safety Precautions

All products are designed to give safe, dependable service if they are operated and maintained according to instructions. **Read and understand this manual before operation.** It is the owner's responsibility to be certain anyone operating this product reads this manual, and all other applicable manuals, to become familiar with this canopy and all safety precautions. Failure to do so could result in serious personal injury or canopy damage. If you have any questions, consult your dealer.

To assist your TORO distributor/dealer in handling your needs, please record hereafter the model number and serial number of your canopy and tractor. It is also advisable to supply them to your insurance company. It will be helpful in the event that the canopy or tractor is lost or stolen.

TRACTOR CANOPY

MODEL: _____
SERIAL NUMBER: _____
DATE OF PURCHASE: _____
DEALER NAME: _____



Caution!

Tie-strap the sunshade /
roof / canopy assembly
during transportation!

Loose Parts

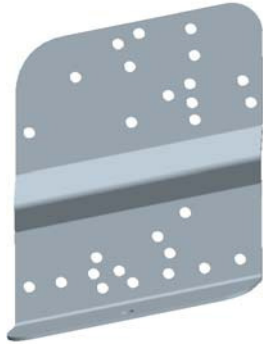

Left Exterior Bracket



Right Exterior Bracket

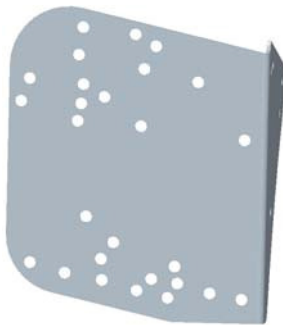

Left Interior Bracket



Right Interior Bracket

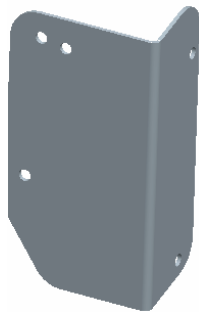

Left Stiffener Bracket



Right Stiffener Bracket

Loose Parts

No.		Description	QTY.
		Kit, Loose, Parts	1
1		Bracket, Exterior, LH	1
2		Bracket, Exterior, RH	1
3		Bracket, Interior, LH	1
4		Bracket, Interior, RH	1
5		Bracket, Stiffener, LH	1
6		Bracket, Stiffener, RH	1
7		Bolt, Flange, Full Thread, 3/8" x 4"	8
8		Bolt, Flange, 3/8" x 3/4"	10
9		Nut, Flange, 3/8", Yellow Dichrome	18
10		Bag, Small Part, 6 3/4" x 4"	3
11		Manual, Installation	1
12		Manual, Parts	1
13		Box, Cardboard, 10"x10"x10"	1
14		COQ Card	1

FOR GM3280D, GM3320, GM7200 ONLY

1. With ROPS (roll bar) folded down, remove the two anti-rattle leaf springs and keep them with the screws for use when the canopy is not installed.
2. Raise the roll bar to the upright position and install the two pins and secure them with the hairpin cotter pins.
3. Install a 3/8" – 16 X 1" or 1 – 1/4" bolt with a jam nut (screws and jam nuts are not provided) in the threaded plate on each side of the lower portion of the roll bar in the hinge area. Tighten the bolt until bolt is tight against the upper roll bar tube and tighten the jam nut.
4. Tighten the hinge bolts holding the upper roll bar to the lower roll bar.
5. Torque the ROPS pivot bolt to 75 +/- 8 ft-lbs to avoid any undo bouncing of ROPS and canopy.

PRE-ASSEMBLY

1. Choose Bolt Reference Diagram for your product.
2. Bolt the left interior plate to the outside of the sub frame using three 3/8" X 3/4" bolts and nuts.
3. Repeat for the right side.
4. Bolt left exterior plate to the left interior plate using correct mounting holes (see Bolt Reference Diagram for your model). Use 3/8" X 4" bolts, and fasten outer two bolts only.
5. Repeat for right side.

FOR NARROW ROPS INSTALL ONLY

1. Take the left stiffener bracket and position on the outside left of the frame. Use two of the fasteners already used on the outside to fasten the bracket into place as shown in illustrations.

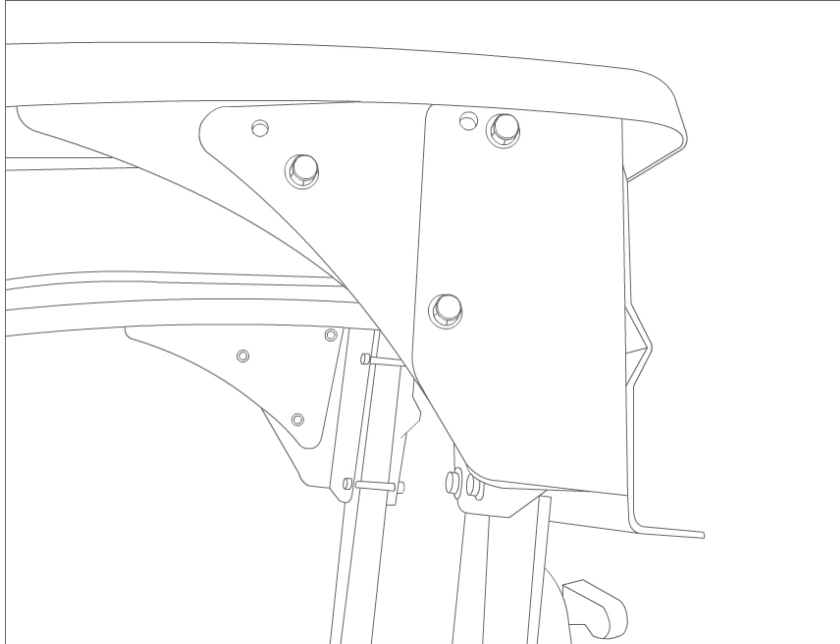

side view

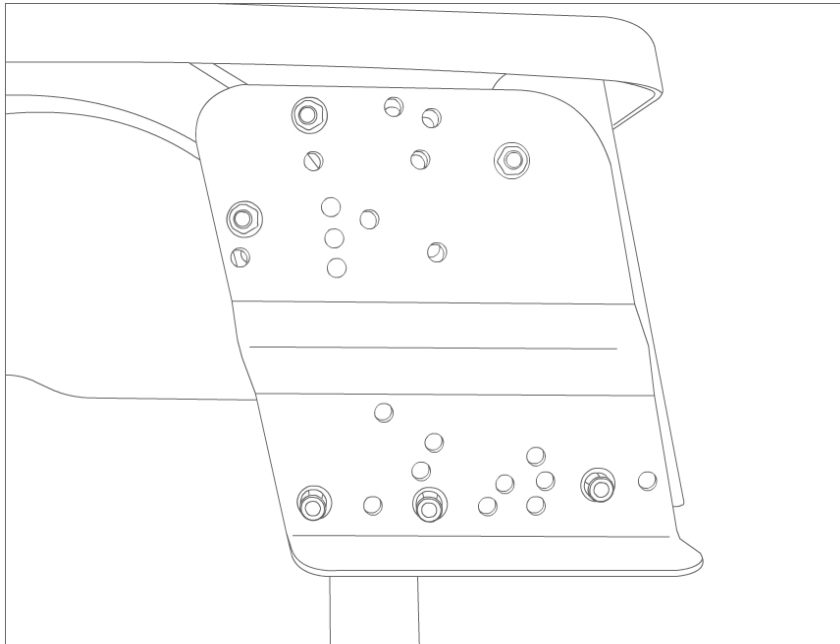

back view

2. Use two provided 3/8" x 3/4" flange bolts and nuts and to fasten to the rear mounting plate as shown.
3. Repeat steps one and two for the right stiffener bracket.

FOR WIDE ROPS INSTALL ONLY

1. Lift canopy over 2-post. Slide interior and exterior mounting plates between 2-post as shown in illustration.

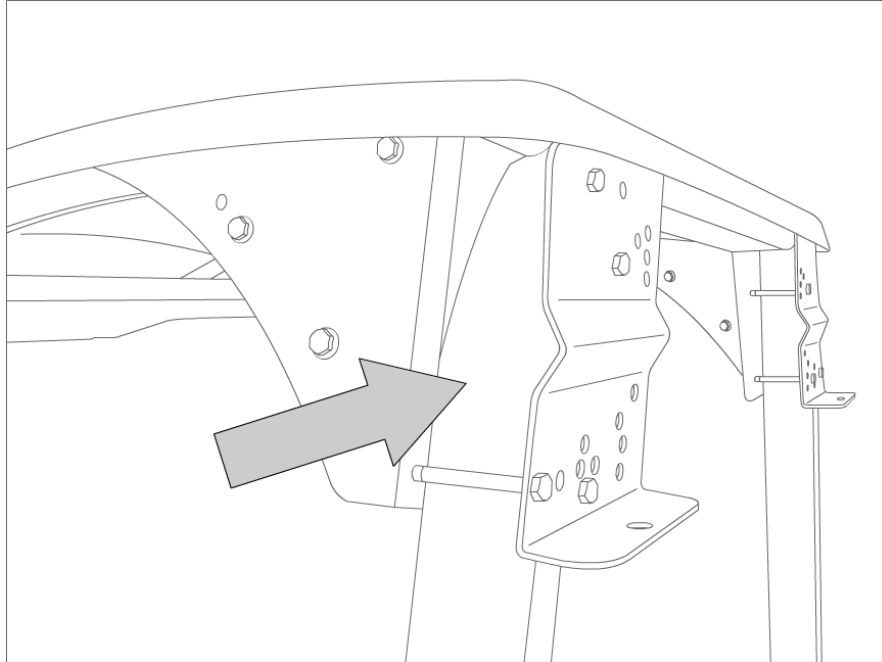

2. Bolt remaining inside fasteners with 3/8" X 4" bolts and nuts. (Using remaining holes from Step 4 of the Pre-Assembly).
3. Torque all fasteners to 42 ft.lbs.

Bolt Reference Diagram

Toro Groundsmaster 328D

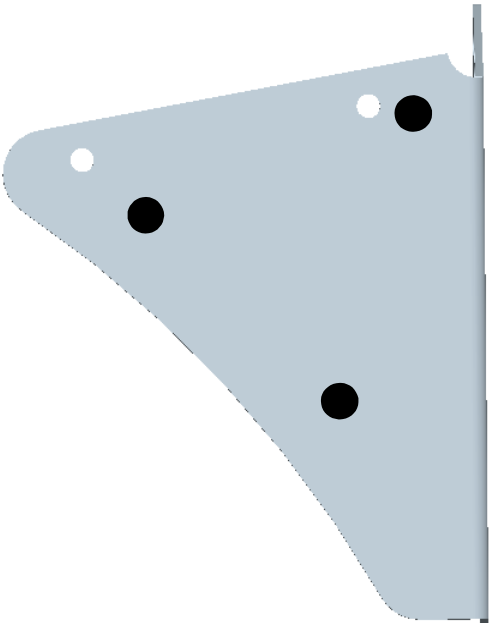

Bracket, Interior

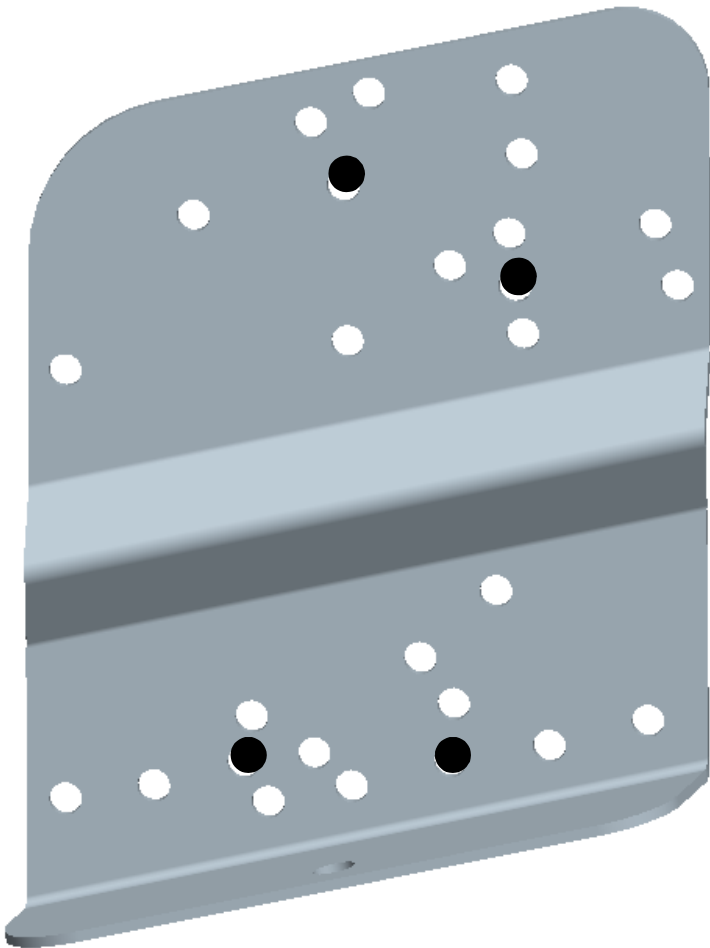

Bracket, Exterior

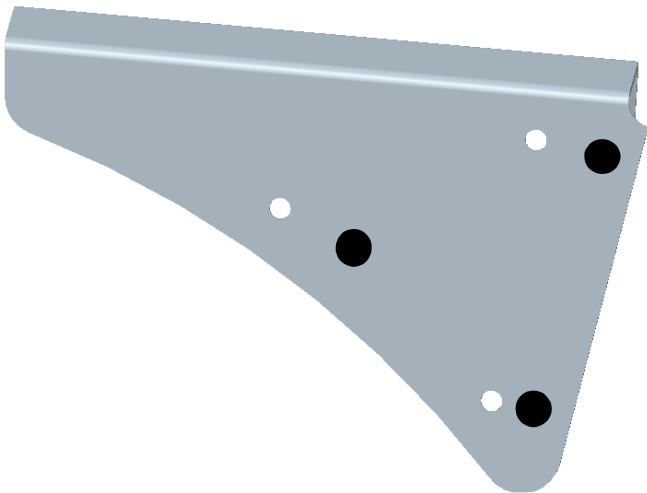

Bracket, Sub-Frame
(Welded to Canopy Frame)

Bolt Reference Diagram

Toro Groundsmaster
3280D, 3320

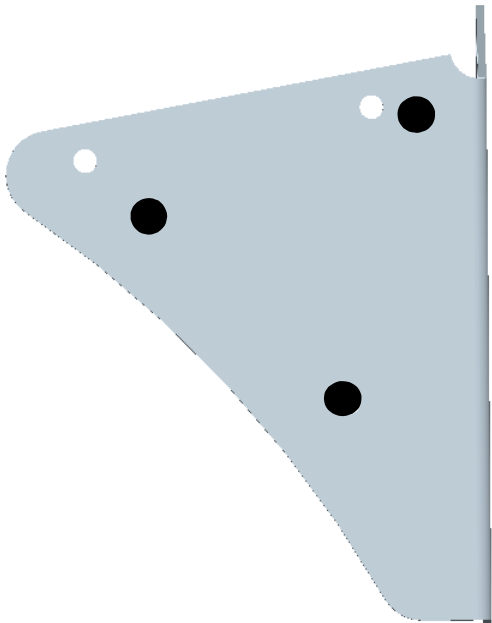

Bracket, Interior

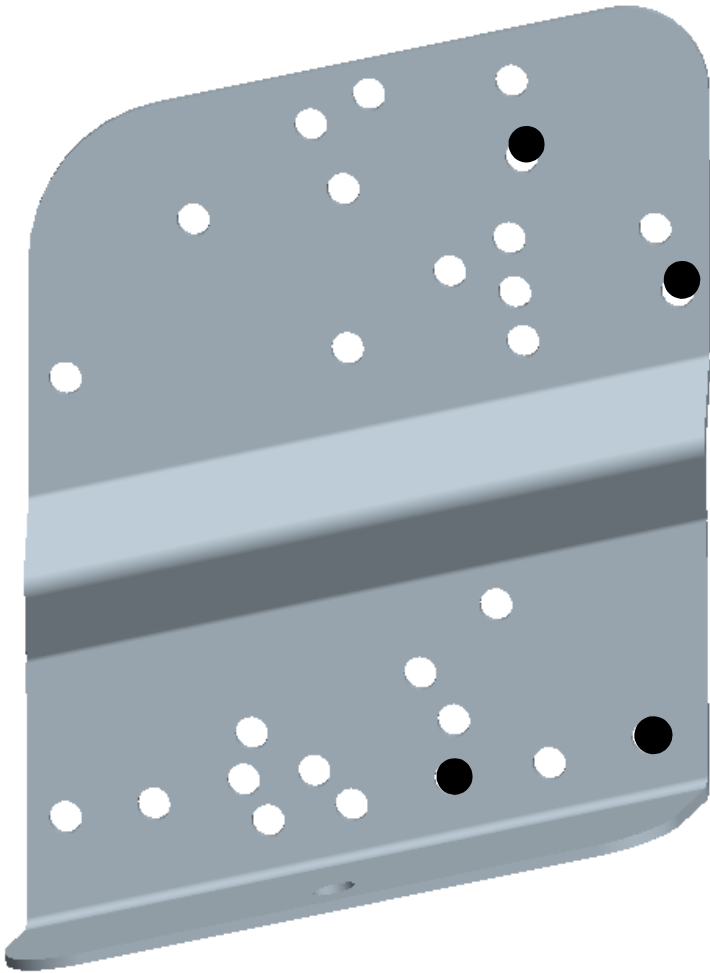

Bracket, Exterior

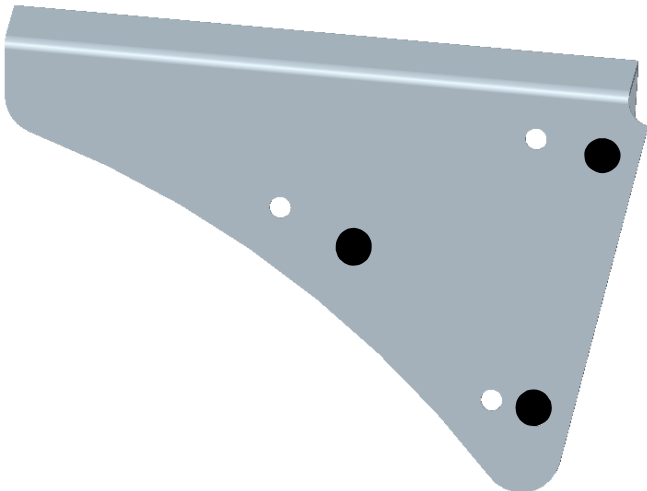

Bracket, Sub-Frame
(Welded to Canopy Frame)

Bolt Reference Diagram

Toro Groundsmaster
580D

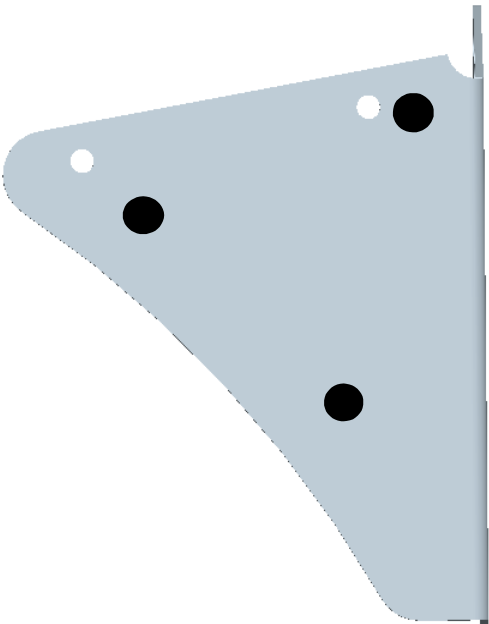

Bracket, Interior

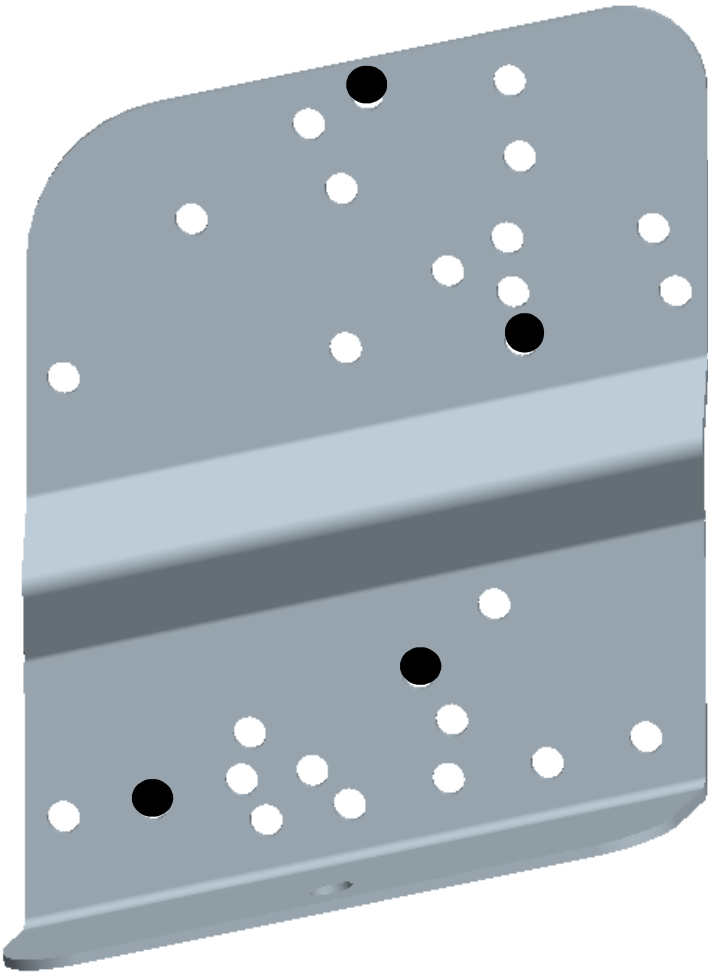

Bracket, Exterior

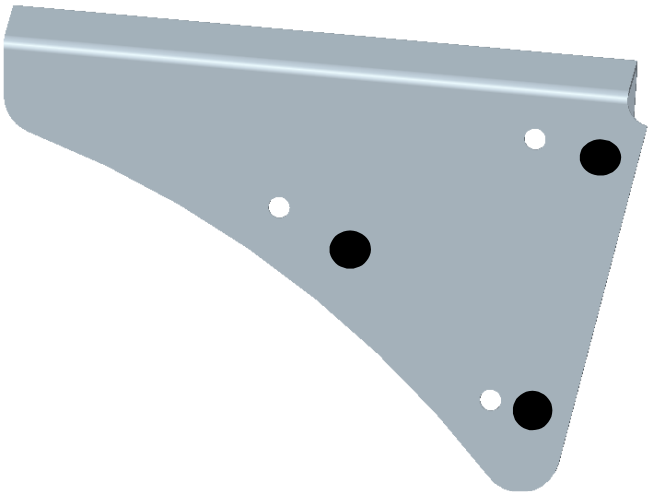

Bracket, Sub-Frame
(Welded to Canopy Frame)

Bolt Reference Diagram

Toro Groundsmaster
5900

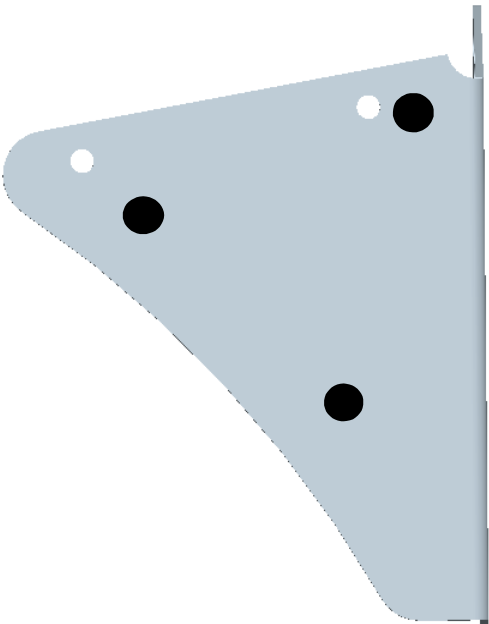

Bracket, Interior

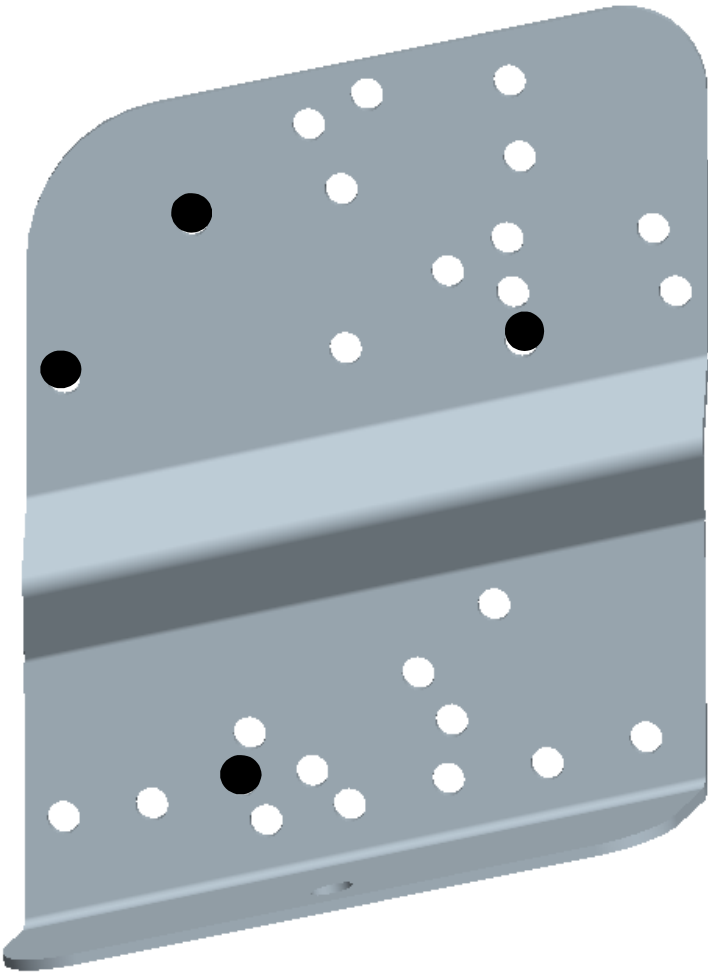

Bracket, Exterior

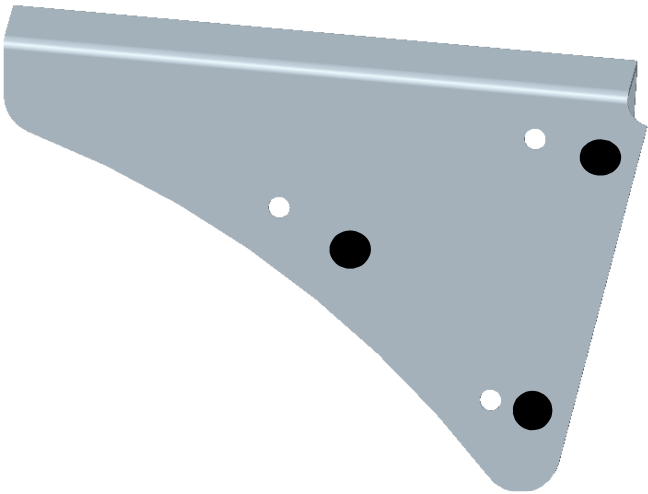

Bracket, Sub-Frame
(Welded to Canopy Frame)

Bolt Reference Diagram

Toro Groundsmaster
4000D, 4100D

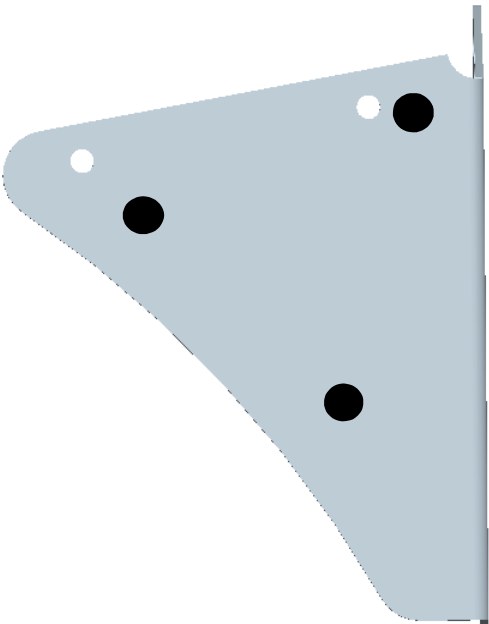

Bracket, Interior

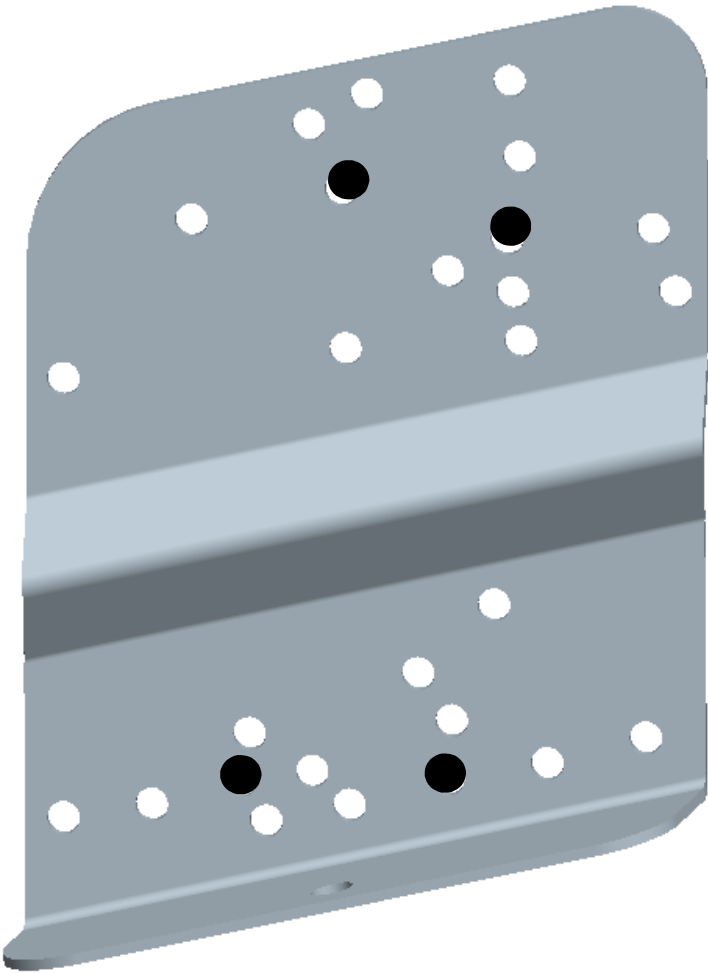

Bracket, Exterior

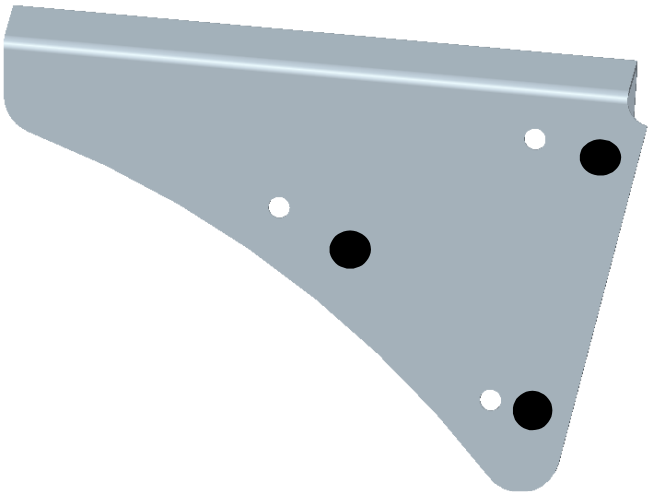

Bracket, Sub-Frame
(Welded to Canopy Frame)

Bolt Reference Diagram

Toro Groundsmaster
4500D, 4700D,
Reelmaster 6500D, 6700D
Reelmaster 7000D

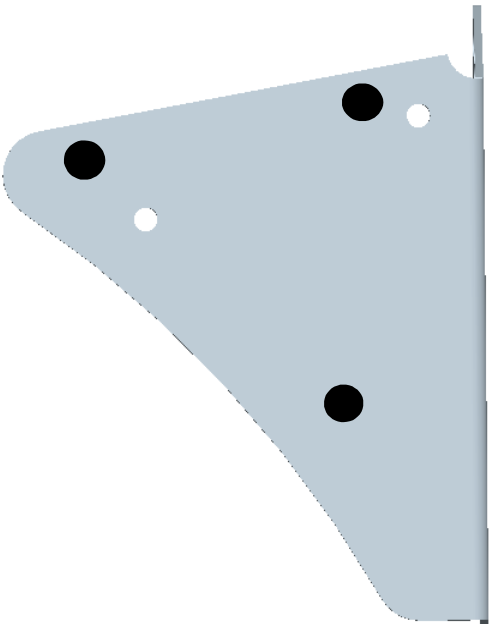

Bracket, Interior

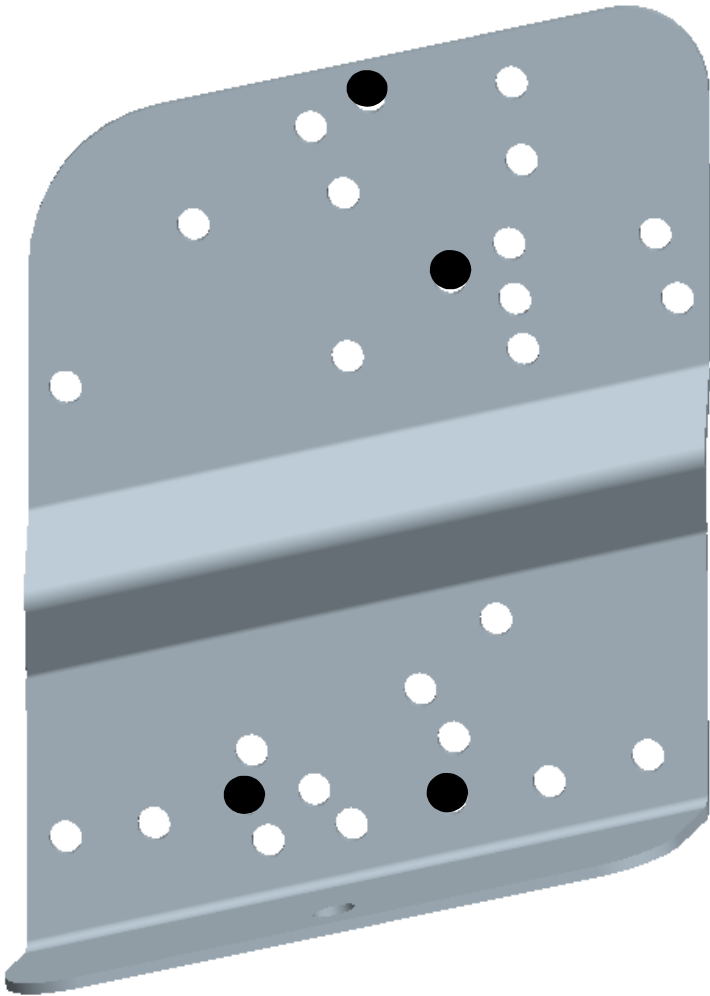

Bracket, Exterior

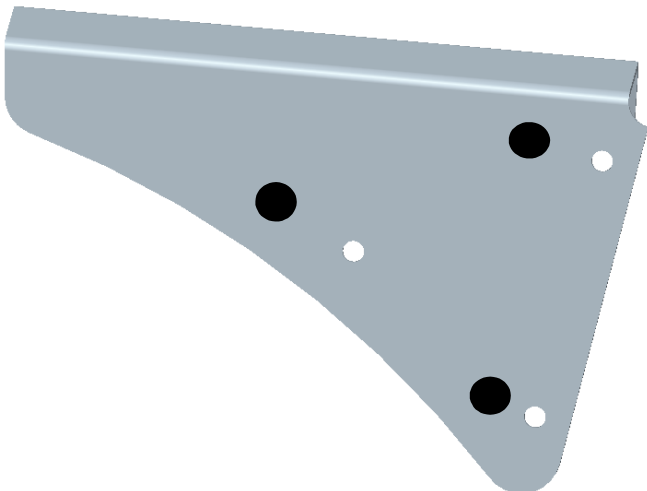

(Welded to Canopy Frame)

Bolt Reference Diagram

Toro Groundsmaster
7200, 7210D

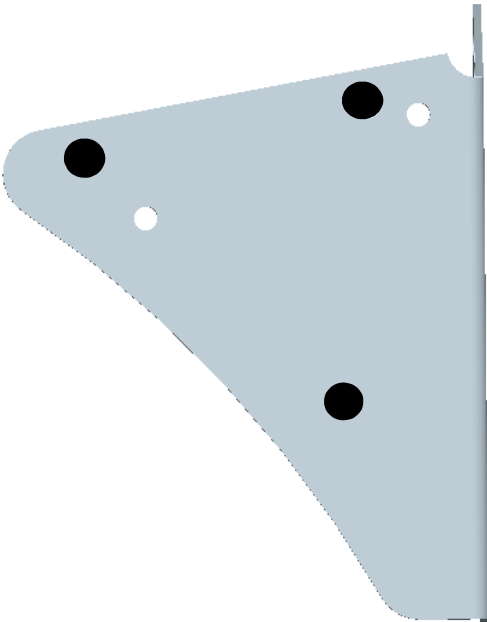

Bracket, Interior

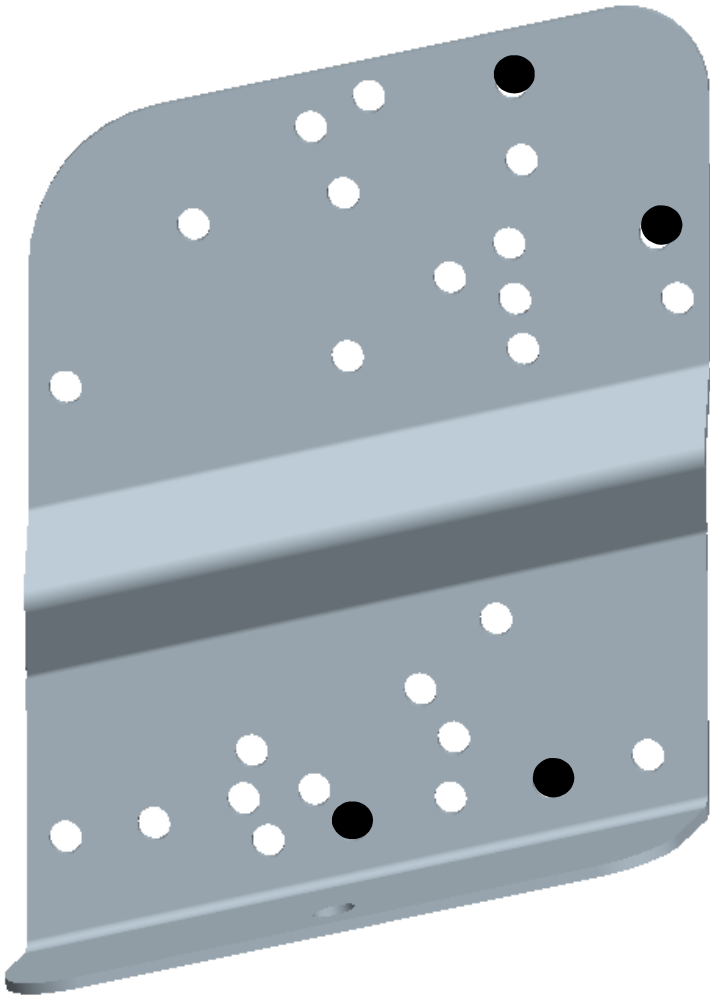

Bracket, Exterior

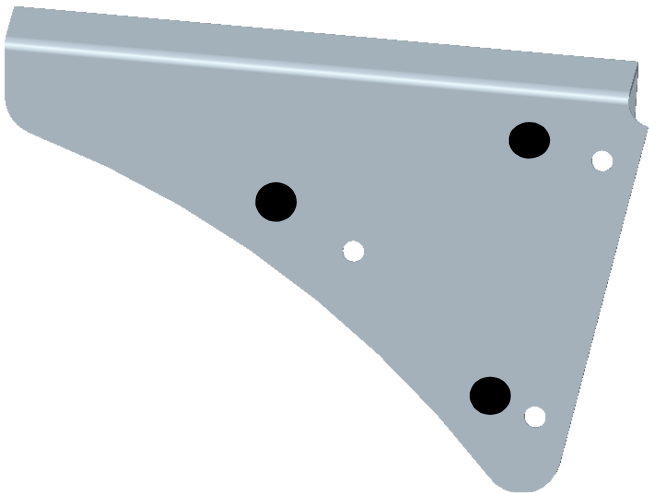

Bracket, Sub-Frame
(Welded to Canopy Frame)

Bolt Reference Diagram

Toro ReelMaster 5500D
5200D, 5400D

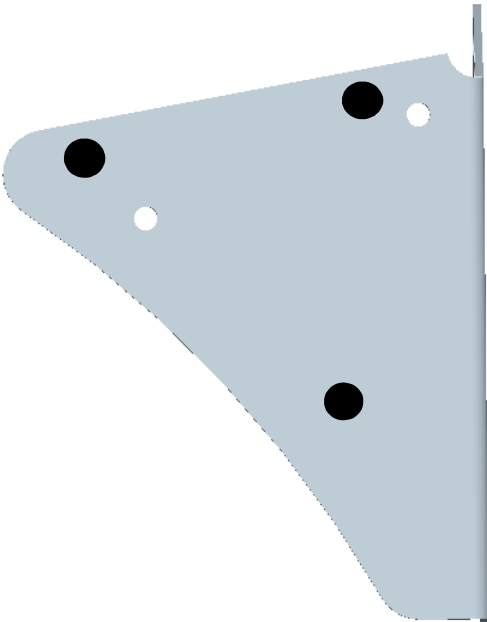

Bracket, Interior

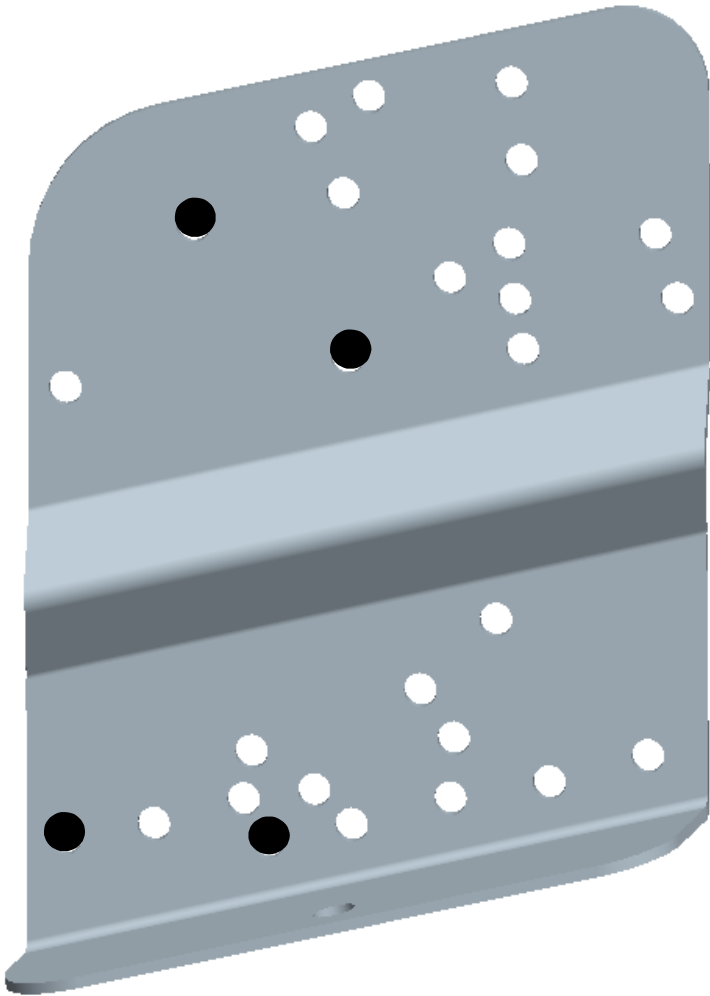

Bracket, Exterior

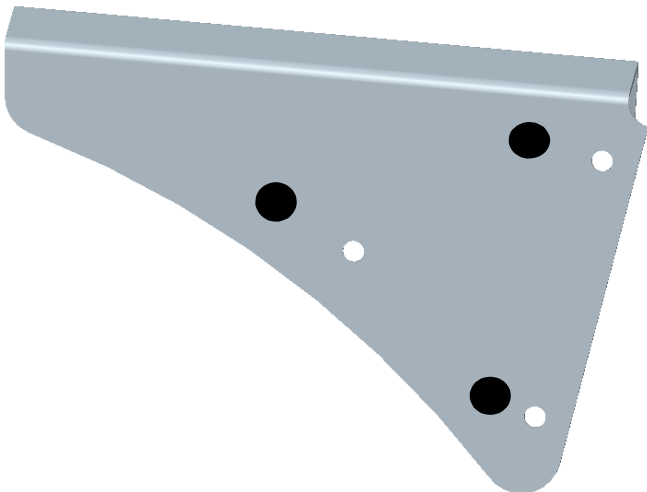

Bracket, Sub-Frame
(Welded to Canopy Frame)

Bolt Reference Diagram

Toro ReelMaster 5210
5410, 5510, 5610

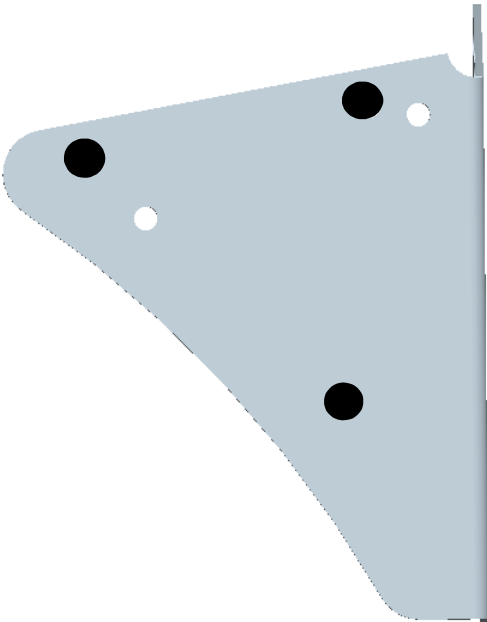

Bracket, Interior

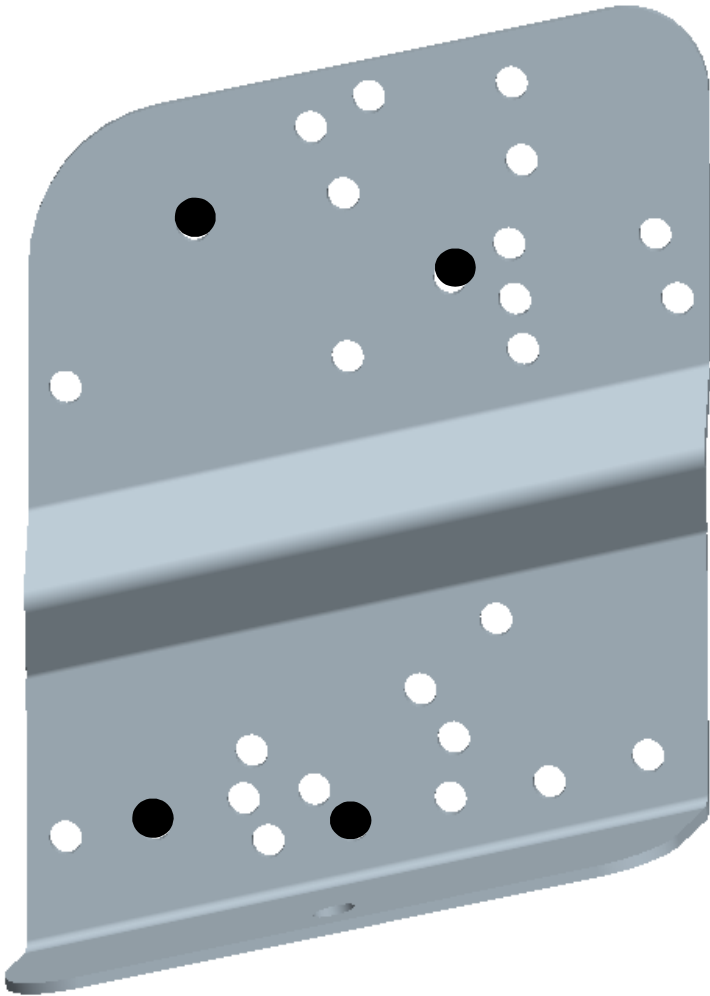

Bracket, Exterior

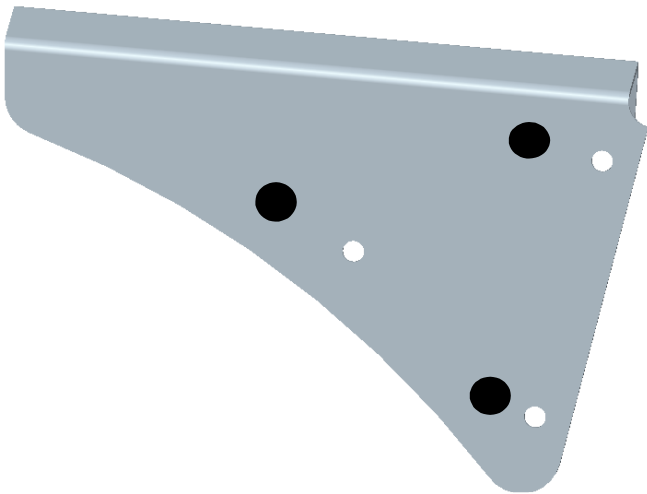

Bracket, Sub-Frame
(Welded to Canopy Frame)

Bolt Reference Diagram

Toro Groundsmaster 360

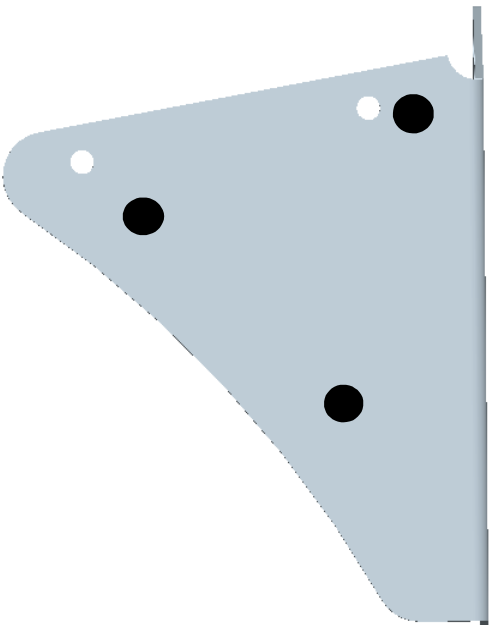

Bracket, Interior

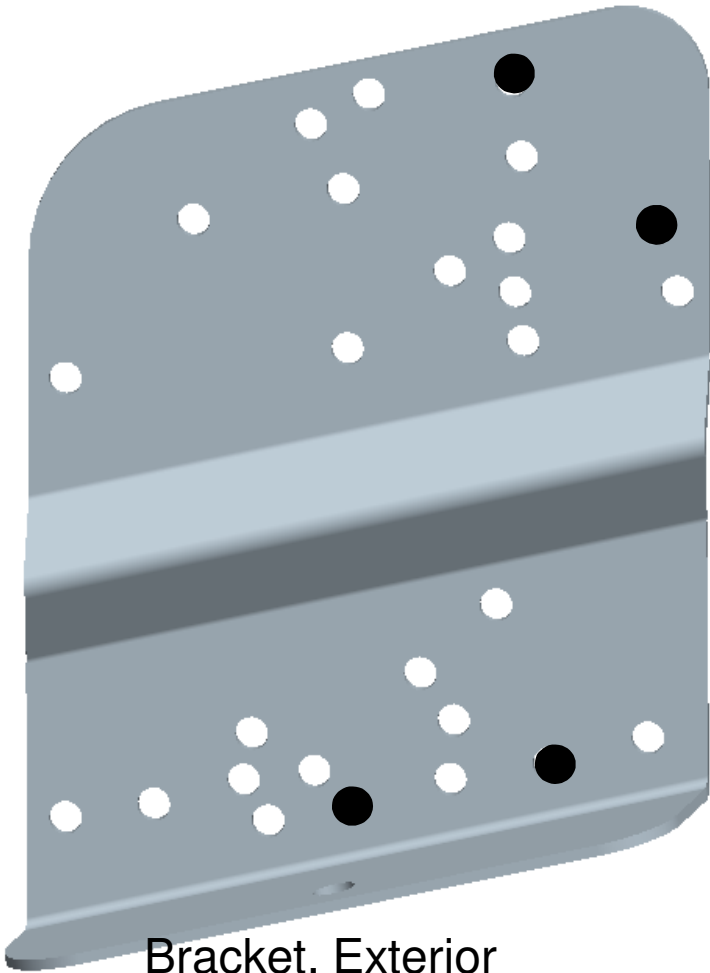

Bracket, Exterior

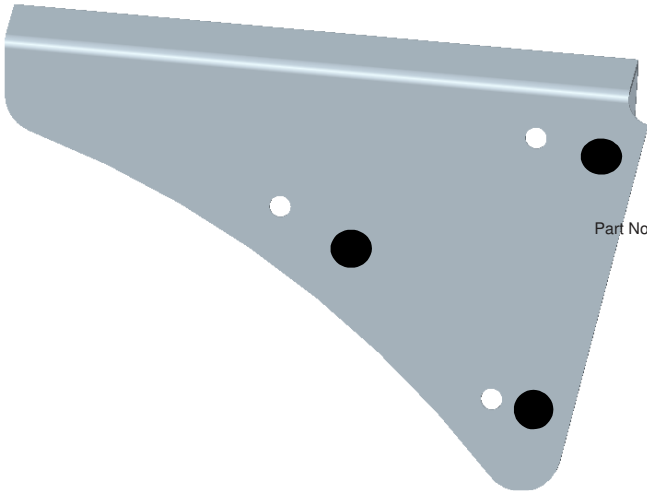

Bracket, Sub-Frame
(Welded to Canopy Frame)