

**TORO**

PART NO. 92-9541

**INSTALLATION  
INSTRUCTIONS****PRE-FILTER / REGULATOR KIT  
for Hydroject 3000****CAUTION**

To avoid personal injury from inadvertent start up or contact with a hot surface, stop engine, remove key from the switch and wait for unit to cool before servicing machine.

**DISASSEMBLY**

1. Position machine on a level surface and make sure engine is shut off. Shut off water supply.
2. Remove (4) capscrews and washers securing fuel tank to aerator frame. This will allow tank to be moved during installation of kit.

3. The following hoses, fittings and clamps, shown in figure 1, must be removed from machine. Retain clamps for use in installation of kit:

- A. 3/4" hose between inlet tee fitting and filter
- B. 3/4" hose between bulkhead fitting and inlet tee fitting.
- C. 3/4" hose and fittings between inlet bulkhead fitting and filter.
- D. 3/4" hose between pump inlet and filter.
- E. 3/8" hose between spray valve and filter.
- F. 1/4" black nylon hose between spray valve inlet and pressure gauge.
- G. Remove elbow fitting from right side of filter head. Remove but do not disassemble tee fitting, small 90° elbow fitting and straight fitting from elbow fitting on left side of filter head.

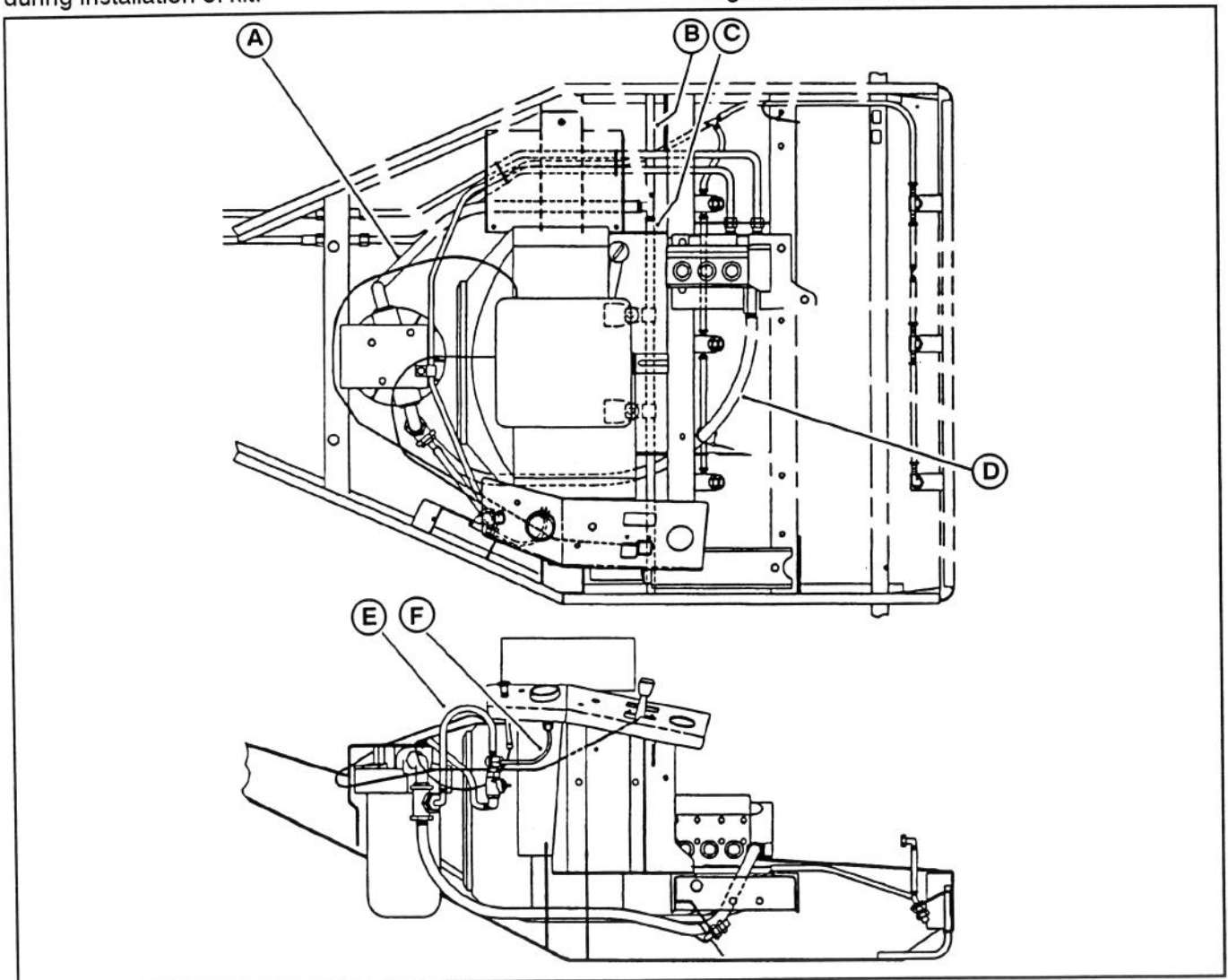

Figure 1

## ASSEMBLY

**NOTE:** When installing fittings, always use teflon tape or pipe sealant on threads.

4. Remove capscrew and nut securing belt retainer to side of machine (Fig. 2).
5. Using capscrew and nut, secure front end of filter bracket to outside of machine and belt retainer to inside of machine (Fig. 2).
6. Using bracket as a template, mark location on right side of machine, for rear bracket mounting hole. Drill a .406" dia. hole in side of machine and secure with a 3/8-16 x 1-1/4" lg. capscrew and locknut (Fig. 2).
7. Install a new 90° fitting to new bulkhead adapter. Mount bulkhead adapter and fitting to bulkhead on

right side of machine (side of machine opposite control panel), as shown in figure 2.

8. Mount new 3/4" x 38" lg. hose to old and new bulkhead fittings with (2) new hose clamps (Fig. 2).
9. Assembly R-clamps and male adapter fittings to pre-filter, as shown in figure 2.
10. Mount pre-filter assembly to filter bracket with (2) 5/16-18 x 3/4" lg. capscrews, washers and locknuts (Fig. 2). Arrows on pre-filter must point toward front (tiller end) of machine.
11. Mount a male adapter fitting and a 90° elbow fitting to regulator valve, positioning fittings as shown in figure 2.
12. Mount regulator valve assembly to mounting bracket with a strap, (2) carriage bolts and locknuts as shown in figure 2.

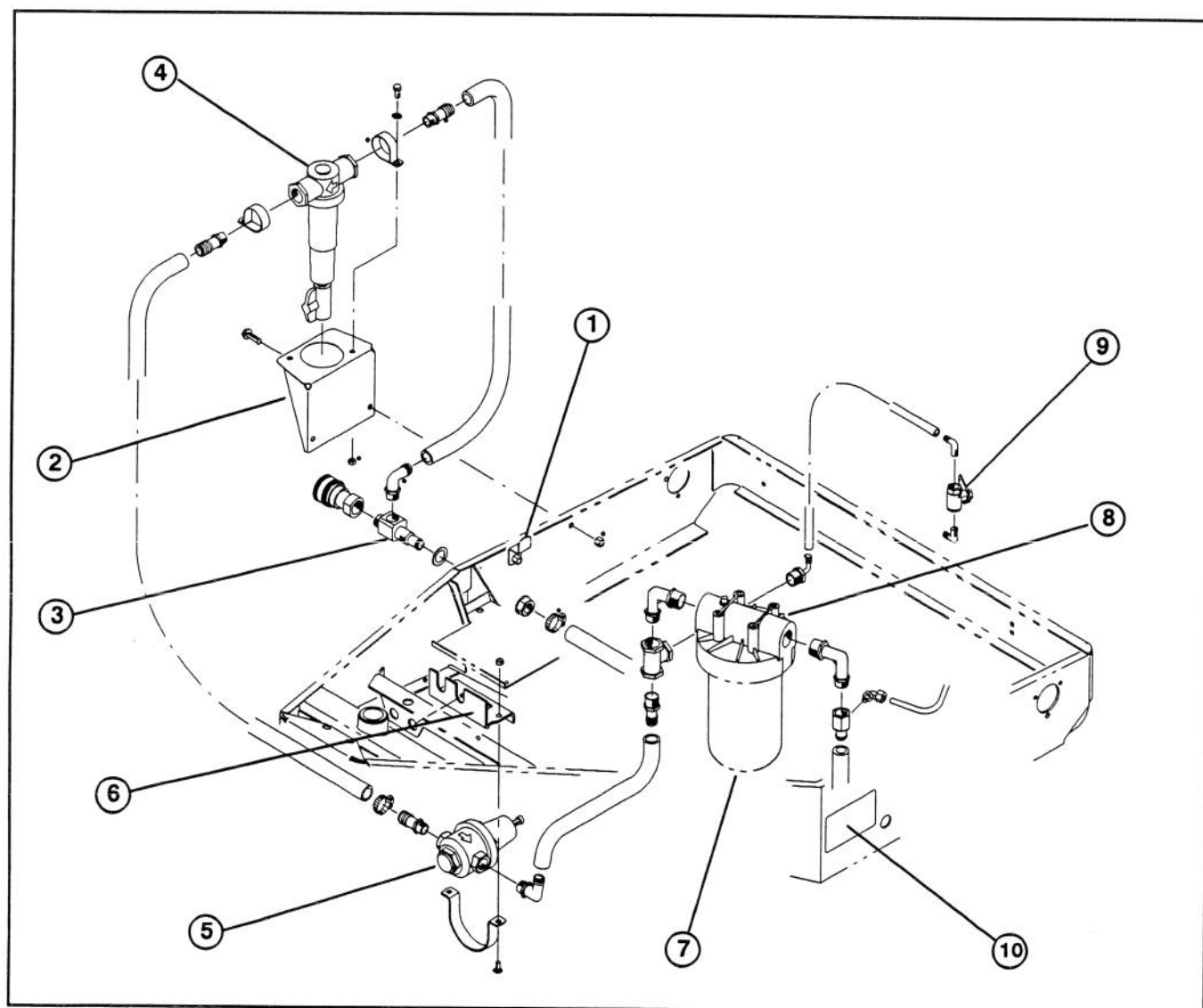

Figure 2

- |                     |                               |
|---------------------|-------------------------------|
| 1. Belt retainer    | 6. Regulator mounting bracket |
| 2. Filter bracket   | 7. Water filter               |
| 3. Bulkhead adapter | 8. Water filter head          |
| 4. Pre-filter       | 9. Spray valve                |
| 5. Regulator valve  | 10. Decal                     |

13. On front bulkhead, loosen bulkhead nuts enough to insert regulator valve mounting bracket between them. Insert bracket and tighten nuts to secure bracket in place (Fig. 2).

14. Install a new 90° fitting to right side of water filter head. Position fitting as shown in figure 2.

15. Install previously removed, tee fitting, small 90° elbow fitting and straight fitting to new 90° fitting on right side of filter head. Position fittings as shown in figure 2.

16. Install a new adapter fitting to old 90° fitting on left side of filter head. Position fitting as shown in figure 2.

17. Mount a 3/4" x 22" lg. hose to 90° fitting on bulkhead adapter and inlet fitting on pre-filter with (2) new hose clamps (Fig. 2).

18. Mount a 3/4" x 31" lg. hose to outlet fitting on pre-filter and inlet fitting on regulator valve with (2) new hose clamps (Fig. 2).

19. Mount a 3/4" x 5" lg. hose to outlet fitting on regulator valve and inlet fitting on water filter with (2) new hose clamps (Fig. 2).

20. Install a new 90° fitting to spray valve, as shown in figure 2.

21. Mount the 3/8" hose to inlet tee fitting on water filter and new 90° fitting on spray valve with (2) hose clamps (Fig. 2).

22. Mount the 1/4" hose to outlet fitting on water filter and pressure gauge (Fig. 2).

23. Mount a 3/4" x 44 lg. hose to outlet fitting on water filter and inlet fitting on pump with (2) new hose clamps (Fig. 2).

24. Affix decal over existing decal on left side of machine.

25. Install fuel tank to machine.

**IMPORTANT: Make sure all hoses are routed and secured away from all rotating or hot parts.**

### SERVICING PRE-FILTER

Sediment can be removed by opening ball valve, with water source attached, to flush. Reusable filter screen may be removed for cleaning by untwisting clear cover from filter by hand. Replace clear cover and hand tighten only (Fig. 3).

**IMPORTANT: Use of tools will damage filter.**

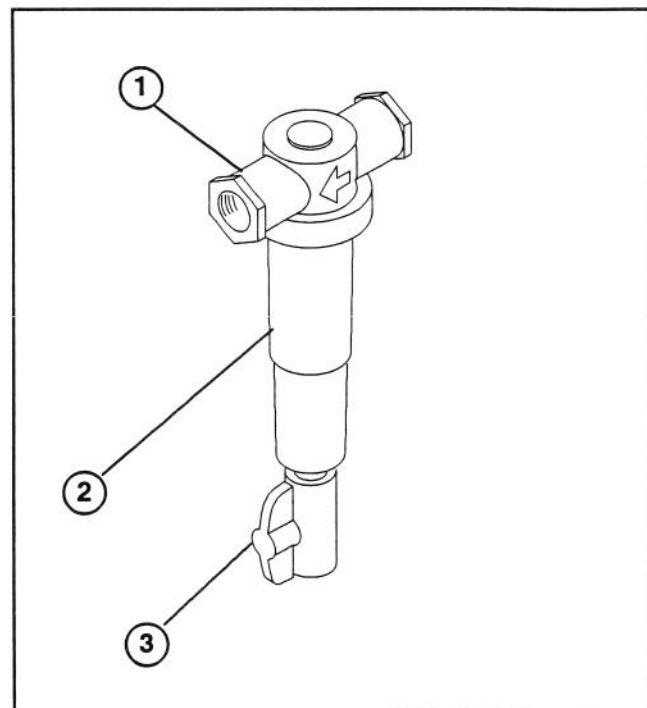

**Figure 3**

- 1. Body
- 2. Clear Cover
- 3. Ball Valve for Flushing

