



## Light Kit

### Greensmaster® 3300/3400 Series TriFlex™ Traction Unit

Model No. 04717

Form No. 3367-952 Rev C

## Installation Instructions

# Installation

## 1

### Installing Rocker Switch

#### Parts needed for this procedure:

1	Rocker switch
---	---------------

#### Procedure

#### ⚠ CAUTION

If you leave the key in the ignition switch, someone could accidentally start the engine and seriously injure you or other bystanders.

Remove the key from the ignition and disconnect the wire(s) from the spark plug(s) before you perform any maintenance. Set the wire(s) aside so that it does not accidentally contact the spark plug(s).

1. Remove the seven hex-socket screws holding the console cover in place (Figure 1) and remove the console cover.

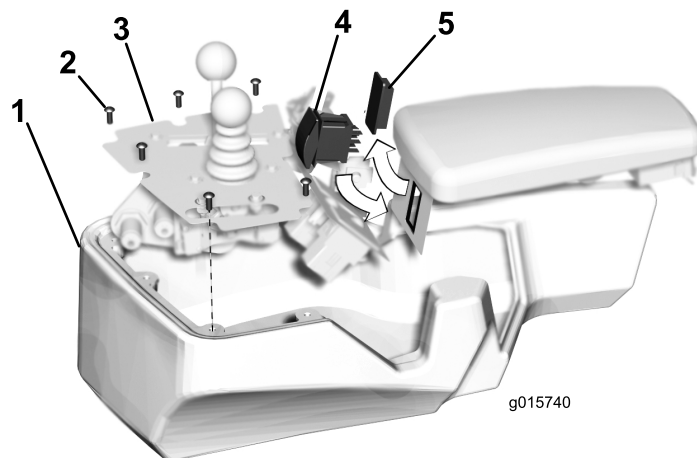

Figure 1

1. Console
2. Hex-socket screws
3. Exposed console (cover removed)
4. Rocker switch
5. Hole plug

2. From inside the console, press the plug out of the hole (Figure 1).
3. Press the rocker switch into the console mounting hole as shown in Figure 1.

## 2

### Mounting the Wiring Harness

#### Parts needed for this procedure:

1	Wiring harness
25	Cable tie

#### Procedure

1. Pull outward on the release tab below the seat, then lean the seat forward.
2. Remove the left-hand cover (Figure 2).

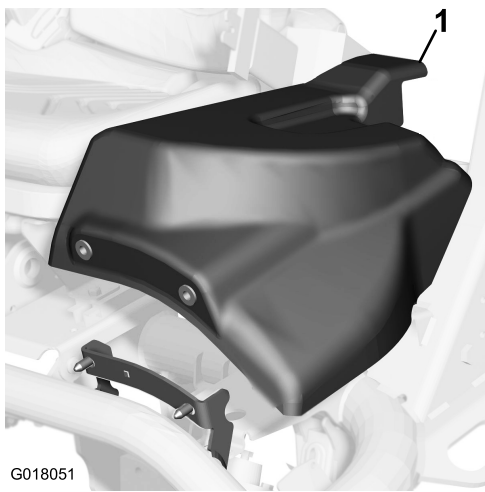

**Figure 2**

1. Left-hand cover

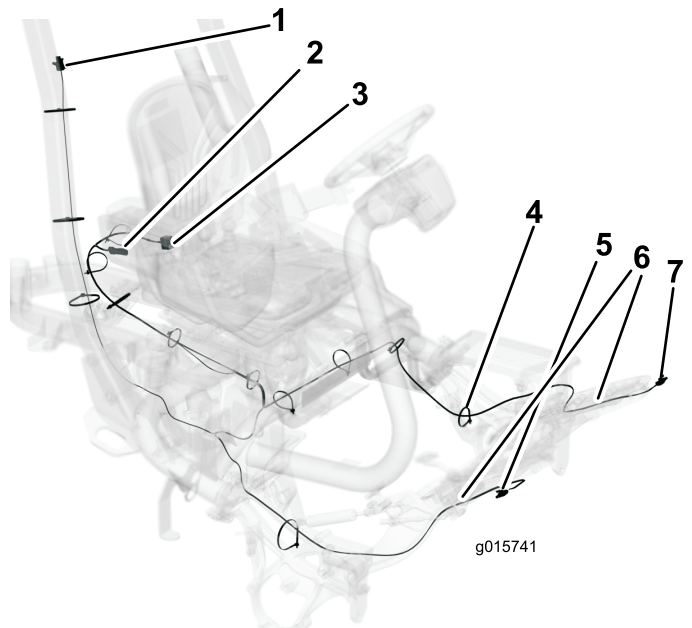

**Figure 3**

- |                            |                                 |
|----------------------------|---------------------------------|
| 1. Rear lamp connector     | 5. Forward right lamp connector |
| 2. Auxiliary connector     | 6. Casting hole                 |
| 3. Rocker switch connector | 7. Forward left lamp connector  |
| 4. Cable tie               |                                 |

3. Plug the rocker switch into the connector from inside the console.
4. Route the wiring harness up the ROPS to the rear lamp, securing it with cable ties (Figure 3).
5. Route the wiring harness from the console down to the seat frame and secure it with cable ties as shown in Figure 3.
6. Route one wire to the right and forward along the mower frame to the front lamp, securing it with cable ties.
7. Route the remaining wire to the left towards the area exposed in step 2, then forward along the frame to the front lamp, securing the wiring with cable ties.
8. Assure harness is routed and tied away from moving parts to eliminate the potential for harness to be severed.

**Note:** Special areas of concern are under the seat, left-hand pivot, and footrest.

9. Push wire harness into casting holes on the left and right sides (Figure 3).
10. Lower the seat, making sure the tab is secure on the pin.
11. Replace the left-hand cover using the slotted screw.
12. Position the console cover in place, then secure it with seven hex socket screws.

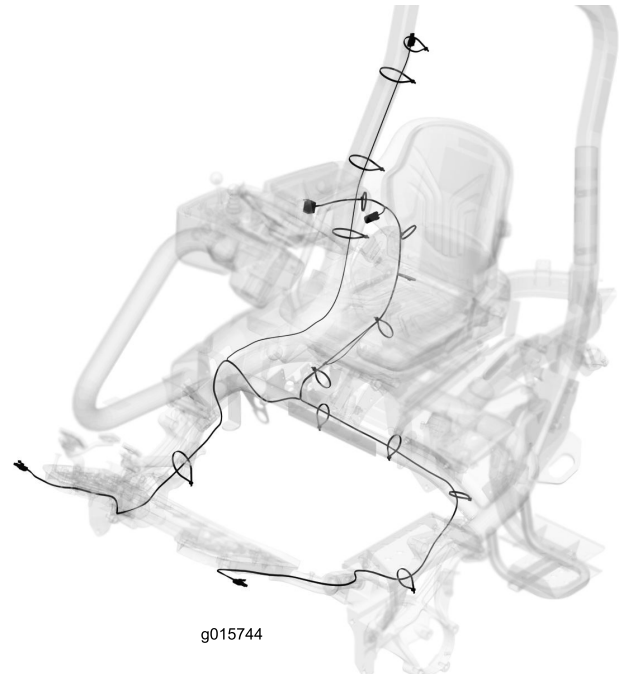

**Figure 4**

# 3

## Installing the Front Lamps

### Parts needed for this procedure:

2	Lamp
1	Left-handed support bracket
1	Right-handed support bracket
4	Flange nut (1/4 inch)
2	Flange nut (5/16 inch)
2	R-clamp
4	Flange-head bolt
2	Carriage bolt

### Procedure

1. Mount the right-handed support bracket to the front right side of the machine frame as shown in Figure 5. Route the wire harness through the R-clamp, then secure the bracket to the bottom of the frame using two flange bolts (1/4 inch), one R-clamp, and two flange nuts (1/4 inch).

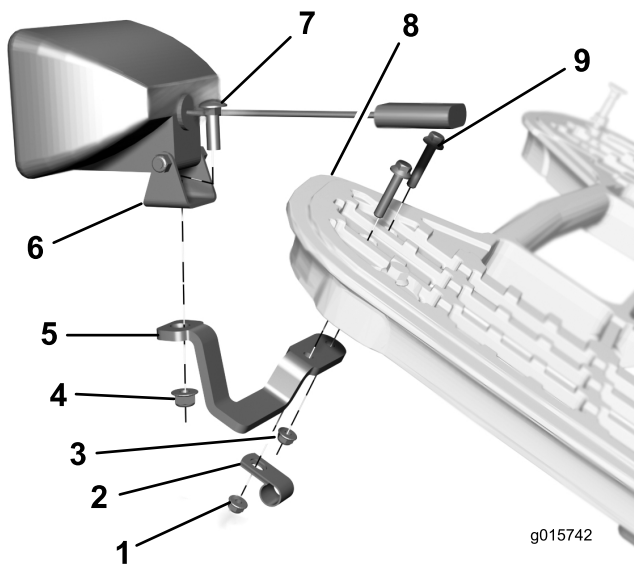

**Figure 5**

- |  |                  |
|--|------------------|
| 1. Flange nut (1/4), used to secure R-clamp  | 6. Lamp          |
| 2. R-clamp (Route wire harness through here) | 7. Carriage bolt |
| 3. Flange nut (1/4)                          | 8. Machine frame |
| 4. Flange nut (5/16 inch)                    | 9. Flange bolt   |
| 5. Support bracket (left-handed shown)       |                  |

2. Install a lamp to the right handed-support bracket as shown in Figure 5. Secure the lamp to the bracket using one carriage bolt and one flange nut (5/16 inch).
3. Secure wire harness to bracket with a cable tie, then plug lamp into wire harness connector.
4. Repeat each step to mount the left-handed bracket and lamp to the front left side of the machine frame.

# 4

## Installing the Rear Lamp

### Parts needed for this procedure:

1	Lamp
1	Bent plate
1	R-clamp
1	Carriage bolt
1	Flange nut (5/16)
2	Self-tapping flange bolt

### Procedure

1. Mount the bent plate to the ROPS as shown in Figure 6. Route the wiring harness through the R-clamp, then secure the bent plate using one R-clamp and two self-tapping flange bolts.

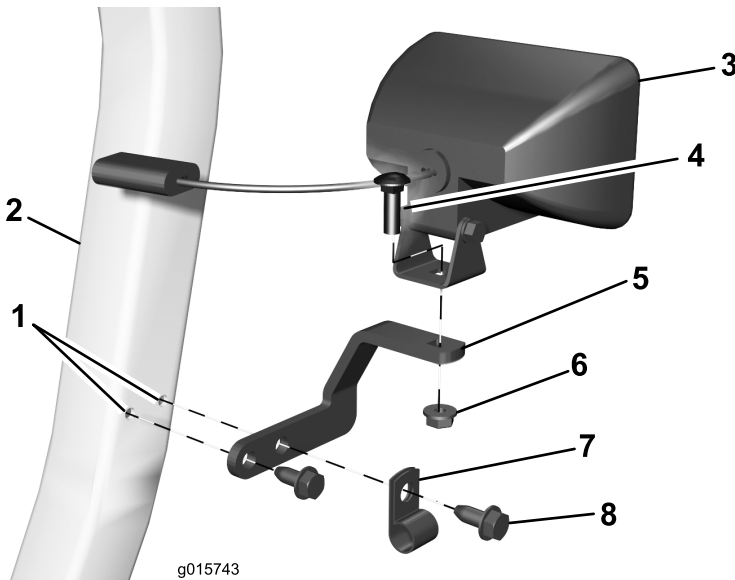

**Figure 6**

- |                        |  |
|------------------------|--|
| 1. ROPS mounting holes | 5. Bent plate                                  |
| 2. ROPS (right side)   | 6. Flange nut (5/16 inch)                      |
| 3. Lamp                | 7. R-clamp (Route wiring harness through here) |
| 4. Carriage bolt       | 8. Self-tapping flange bolt                    |

2. Install a lamp to the bent plate as shown in Figure 6. Secure the lamp using one carriage bolt and one flange nut (5/16 inch).
3. Secure wire harness to bent plate with cable tie, then plug lamp into wire harness connector.