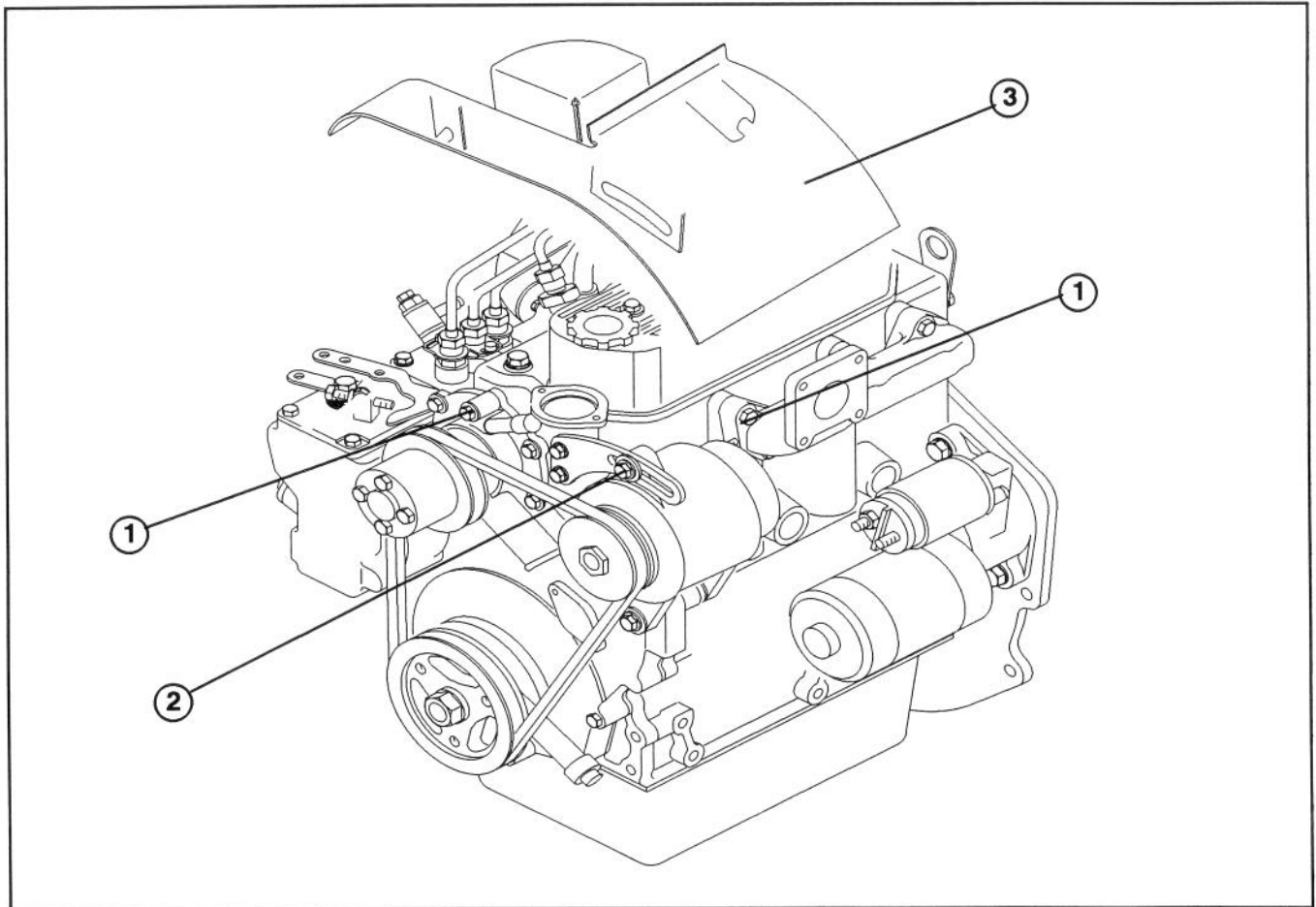

TORO[®]

PART NO. 92-5963

**INSTALLATION
INSTRUCTIONS****ENGINE COVER KIT
WORKMAN 3300D***Helping you put quality into play.™*

1. Raise bed and install safety support on fully extended lift cylinder rod (if so equipped).
2. Stop engine, set parking brake and remove key from ignition switch.
3. Loosen capscrew on front and side of engine shown in figure 1.
4. Remove capscrew securing alternator to adjusting bracket.
5. Position slotted engine cover mounting brackets onto capscrews and loosely secure.
6. Align slotted engine cover bracket with alternator bracket slot and loosely secure engine cover to alternator and adjusting bracket with capscrew removed.
7. Check belt tension by depressing it at mid span of crankshaft and alternator pulleys with 22 lbs. of force. A new belt should deflect .3-.5 in. A used belt should deflect .4-.55 in. Adjust belt tension as required and tighten capscrew.
8. Tighten all mounting capscrews.

**Figure 1**

1. Loosen these capscrews
2. Remove this capscrew
3. Engine cover