



Handle Extension Kit

2004 to 2008 ProCore® 648 Aerator

Model No. 125-3330

Form No. 3376-481 Rev A

Installation Instructions

Installation

Loose Parts

Use the chart below to verify that all parts have been shipped.

Procedure	Description	Qty.	Use
1	Hex-head bolt #10-24 x 3/4 inch	4	Mark the frame.
2	No parts required	—	Remove the control cover.
3	Control cover	1	Install the control cover.
4	Hex-head bolt (3/8 x 1 inch) Flange nut Cable tie	4 4 2	Install the handle.
5	No parts required	—	Remove the old traction handle.
6	Bail Roll pin	2 2	Install the bails.

Set the parking brake, stop the engine, remove the key, and wait for all moving parts to stop before leaving the operating position.

1

Marking the Frame

Parts needed for this procedure:

4	Hex-head bolt #10-24 x 3/4 inch
---	---------------------------------

Procedure

1. Remove the 2 hex-head bolts (#10-24 x 1/2 inch) as shown in Figure 1.

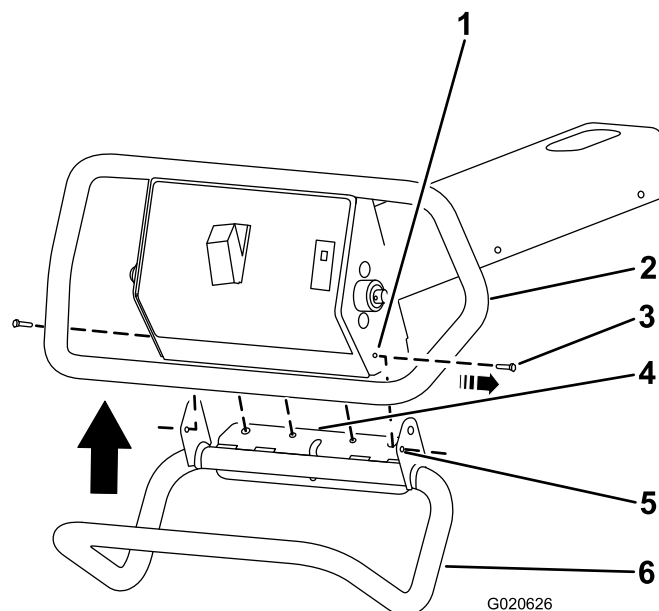

Figure 1

- | | |
|------------------------------------|------------------|
| 1. Frame hole | 4. Flange |
| 2. Frame | 5. Mounting hole |
| 3. Hex-head bolt #10-24 x 1/2 inch | 6. Handle |



2. Cut the 2 cable ties.
3. Push the handle up, and align the flange with the frame (Figure 1).
4. Align the mounting holes for the 2 hex-head bolts (#10-24 x 3/4 inch) of the handle with the frame holes of the frame (Figure 1).
5. Secure the handle to the frame using the 2 hex-head bolts (#10-24 x 3/4 inch) as shown in Figure 2.

Note: Ensure that the handle is flush with the bottom of the frame.

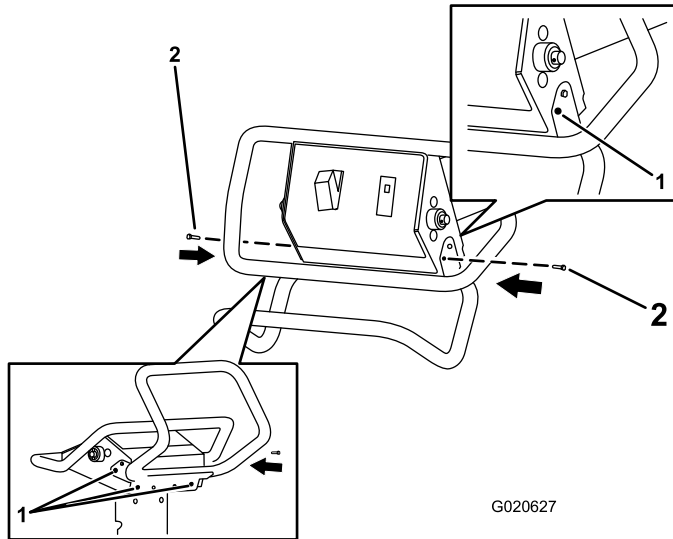

Figure 2

1. Holes
2. Hex-head bolt #10-24 x 3/4 inch

6. Using the 9.9 mm (0.390 inch) holes in the handle as a template, mark the 4 hole locations on the frame.
7. Remove the 2 hex-head bolts installed in step 5 and remove the handle.

2

Removing the Control Cover

No Parts Required

Procedure

1. Remove the 2 hex-head bolts (#10-24 x 1/2 inch) from the frame (Figure 3).

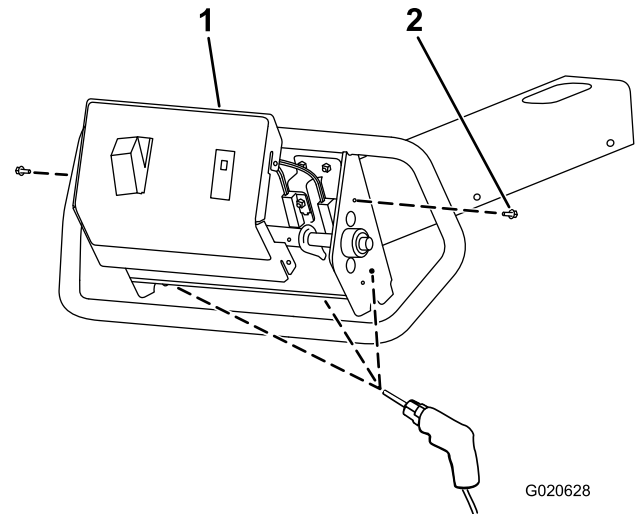

Figure 3

1. Control cover
2. Hex-head bolt #10-24 x 1/2 inch

2. Separate the control cover from the frame (Figure 3).

Note: Use care when separating the control cover, the switch and the light are wired to components in the frame.

3. Remove the wire harnesses from the switch and the light in the control cover (Figure 3).
4. Drill 4 holes (10 mm or 13/32 inch) in the frame at the locations marked in step 6 of procedure1 Marking the Frame (page 1); also refer to Figure 2 and Figure 3.
5. Remove the switch and the light from the control cover.

3

Installing the Control Cover

Parts needed for this procedure:

1	Control cover
---	---------------

Procedure

1. Remove the old control cover.
2. Install the switch and the light to the new control cover.
3. Install the wire harness to the switch.
4. Install the wire harness to the light.
5. Align the holes of the cover with the holes of the frame (Figure 4).

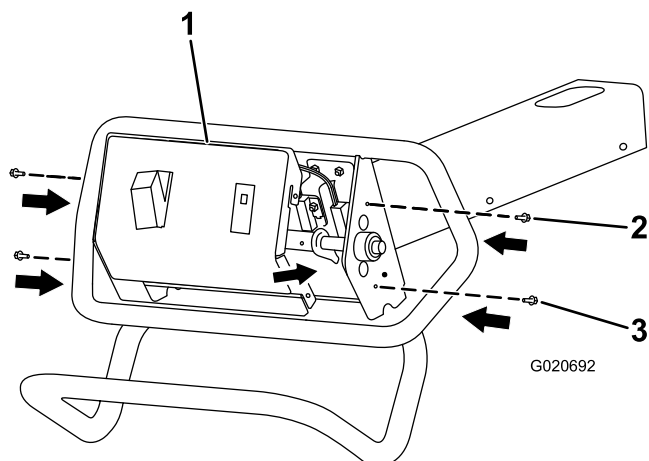

Figure 4

1. Control cover
2. Hex-head bolt #10-24 x 1/2 inch
3. Hex-head bolt #10-24 x 3/4 inch

6. Insert the panel into the frame (Figure 4).
7. Loosely assemble the panel to the frame using the 2 hex-head bolts (#10-24 x 1/2 inch) at the upper hole locations (Figure 4).

4

Installing the Handle

Parts needed for this procedure:

4	Hex-head bolt (3/8 x 1 inch)
4	Flange nut
2	Cable tie

Procedure

1. Align the holes of the handle to the holes of the frame (Figure 5).

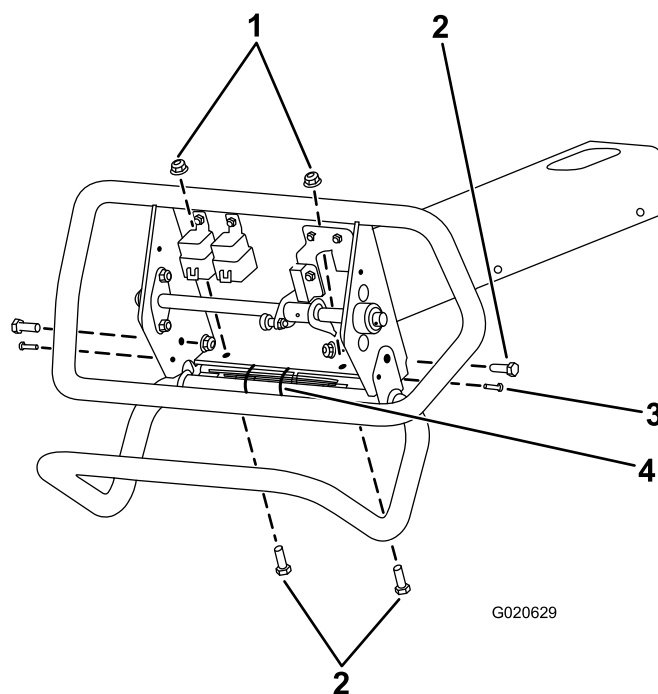

Figure 5

1. Flange nut
2. Hex-head bolt 3/8 x 1 inch
3. Hex-head bolt #10-24 x 3/4 inch
4. Cable tie

2. Loosely assemble the 2 hex-head bolts (#10-24 x 3/4 inch) through the handle, frame holes, and control cover (Figure 5).
3. Secure the handle to the frame using the 4 hex-head bolts (3/8 x 1 inch) and the 4 flange nuts (Figure 5).
4. Secure the 4 hex-head bolts (#10-24 x 3/4 inch) that mount the cover to the frame (Figure 5).
5. Install the two cable ties that secure the wire harness to the frame (Figure 5).

5

Removing the Old Traction Handle

No Parts Required

Procedure

1. Remove the roll pin from the left end of the traction handle (Figure 6).

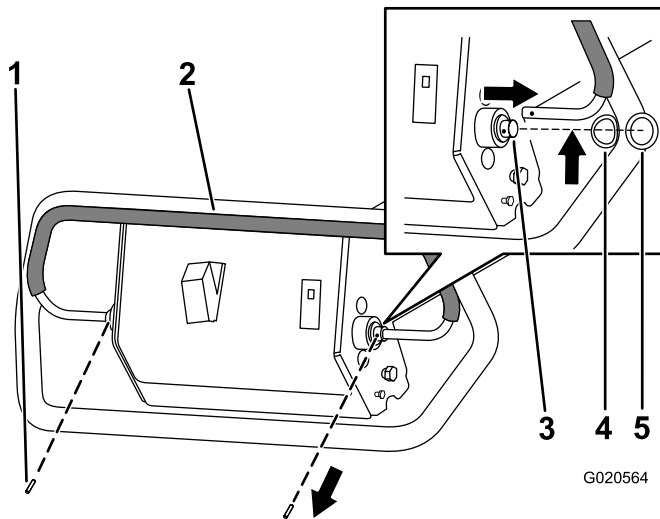

Figure 6

- | | |
|--------------------------|----------------|
| 1. Roll pin | 4. Wave washer |
| 2. Traction handle (old) | 5. Flat washer |
| 3. Pivot shaft | |

2. Remove the roll pin from the right end of the traction handle (Figure 6).
3. Lift the left end of the traction handle and move it left until the left end of the handle is free from the pivot shaft (Figure 6).
4. Move the traction handle to the right from the pivot shaft (Figure 6).
5. Remove the traction handle (Figure 6).

Note: Retain the flat washer and wave washer for installation.

6

Installing the Bails

Parts needed for this procedure:

2	Bail
2	Roll pin

Procedure

Note: The wave washer and the flat washer are on the inside of the roll pins.

1. Insert a bail into the left end of the pivot shaft (Figure 7).

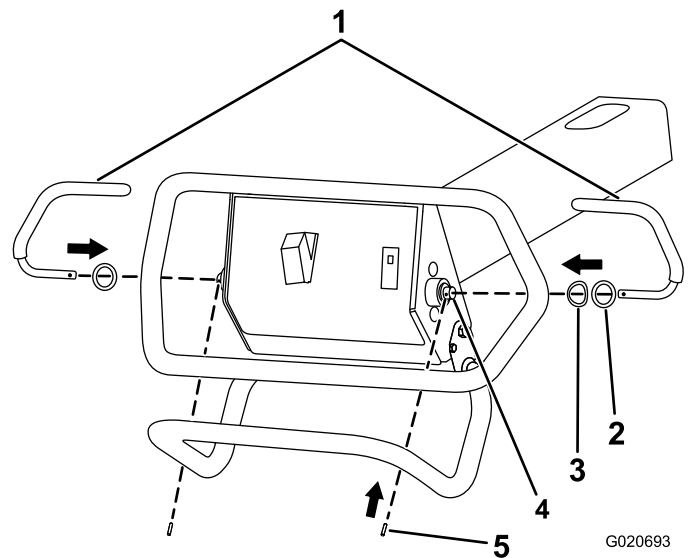

Figure 7

- | | |
|----------------|----------------|
| 1. Bails (new) | 4. Pivot shaft |
| 2. Flat washer | 5. Roll pin |
| 3. Wave washer | |

2. Align the hole in the bail with the hole in the pivot shaft (Figure 7).
3. Insert the roll pin into the holes of the bail and the pivot shaft (Figure 7).

Note: Lightly tap roll pin into position with a hammer when installing.

4. Insert a bail into the right end of the pivot shaft (Figure 7).
5. Align the hole in the bail with the hole in the pivot shaft (Figure 7).
6. Insert the roll pin into the holes of the bail and the pivot shaft (Figure 7).