



# Extended Hitch Kit

## GreensPro™ 1200 Greens Roller

Model No. 125-5708

Form No. 3376-521 Rev A

### Installation Instructions

1. Lower the wheels into the towing position so the tow bar is lowered into the down position. Refer to the Operator's Manual for the lowering procedure.
2. From the rear of the chassis, measure 40 cm (16 inches) onto the tow bar, mark the location and cut off the tow bar (Figure 1).

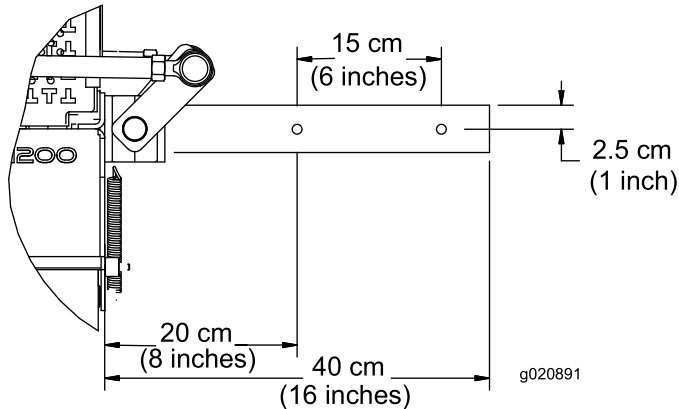

**Figure 1**

3. Using the dimensions shown in Figure 1, locate, mark and drill (2) .406 inch diameter holes through both walls of the tow bar.
4. Mount the hitch extension to the tow bar with (2) 3/8 x 3.50 inch bolts and 3/8 inch flange nuts, positioning the hitch extension as shown in Figure 2. Torque to 37 to 45 N-m (27 to 33 ft-lb).

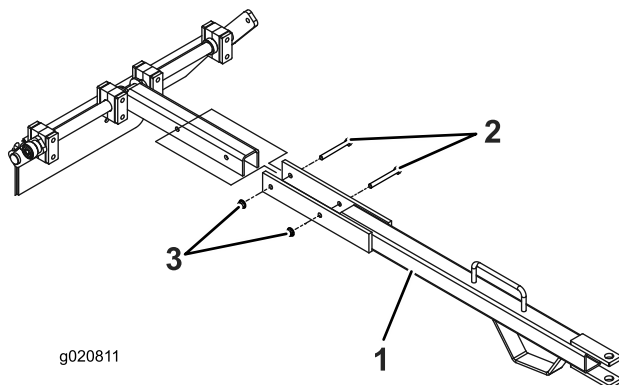

**Figure 2**

1. Hitch extension
2. Bolt
3. Flange nut

5. Using the dimensions shown in Figure 3 or one of the weights as a template, locate, mark and drill a .406 inch diameter hole through the rear plate of the chassis. If using one of the weights as a template, align the left hole with the existing hole in the chassis.

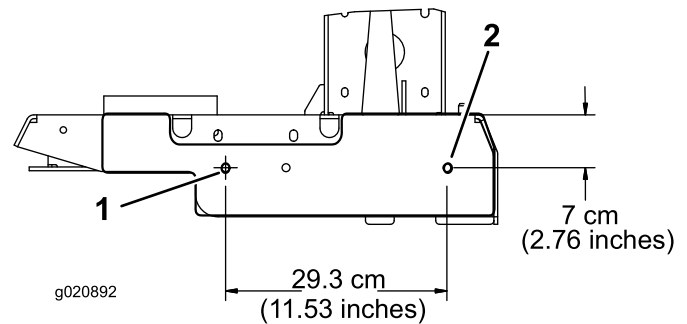

**Figure 3**

1. Existing hole
2. New hole

6. Mount the required amount of weight to the rear of the chassis with (2) 3/8 x 3.00 inch bolts and 3/8 inch flange nuts (Figure 4). Torque to 37 to 45 N-m (27 to 33 ft-lb).

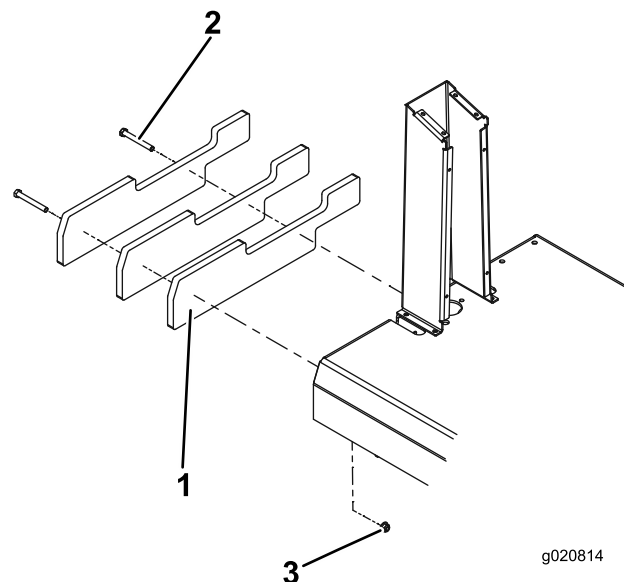

**Figure 4**

1. Weight
2. Bolt
3. Flange nut