



Turbo Baffle Kit

for 52in, 60in, and 72in Z Master® Decks

Model No. 107-1634

Form No. 3376-765 Rev A

Installation Instructions

Note: It is strongly recommended to use **low sail** cutting blades while bagging leaves with this kit. This will prevent excessive blowout of debris while bagging.

Contact your Authorized Service Dealer for the low sail blades. Refer to the *Operator's Manual* for the correct procedure to replace the blades.

Loose Parts

Use the chart below to verify that all parts have been shipped.

Description	Qty.	Use
No parts required	—	Prepare the unit.
Skid skirt	2	Install the turbo baffles.
Rubber skirt	2	
Carriage bolt (5/16 x 1 inch)	12	
Locknut (5/16 inch)	14	
Carriage bolt (5/16 x 1-1/4 inches)	2	

Preparing the Unit

⚠ WARNING

The cutting blade is sharp. Contact with the cutting blade can cause serious personal injury.

Wear gloves or wrap the sharp edges of the blade with a rag.

1. Use the Z Stand® to raise the front end of the mower. See the *Operator's Manual* for more information on using the Z Stand.
2. Thoroughly clean the mower deck. All debris must be removed to ensure that the baffle will fit properly against the mower deck.
3. Repair all bent or damaged areas of the mower deck and replace any missing parts.

Installing the Turbo Baffles

1. Cut the baffle length down to fit your specific deck size as shown in [Figure 1](#). Trim the baffle at the first notch for all 52 inch decks or at the second notch for all 60 inch decks.

Note: The baffle length is correct for **72 inch decks** and **does not need to be shortened**.

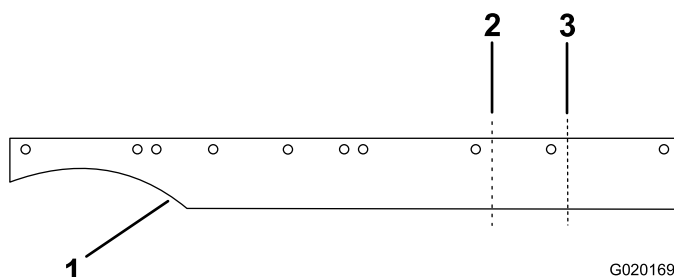

G020169

Figure 1

1. Baffle
2. First notch (cut here for 52 inch decks)
3. Second notch (cut here for 60 inch decks)

2. Locate the cutting arc that corresponds to your deck size. **Select one baffle only** and trim it along the shape of the corresponding arc ([Figure 2](#)).

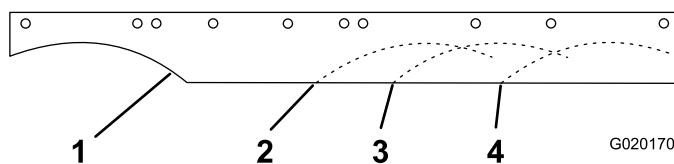

G020170

Figure 2

1. Baffle
2. Arc (52 inch decks)
3. Arc (60 inch decks)
4. Arc (72 inch decks)



3. Trim the skid skirts as follows:

- For 52 inch decks, trim the skid skirts at the second notch on the same side as shown in [Figure 3](#). Then shift the skirt over so that the holes in the skid skirt line up with the holes in the 52 inch mower deck.

- For 60 inch decks, trim the skid skirts at the first notch on opposite sides. Count the notches from the outside to in as shown in [Figure 4](#).
- For 72 inch decks, the skid skirts are the correct length and do not need to be trimmed.

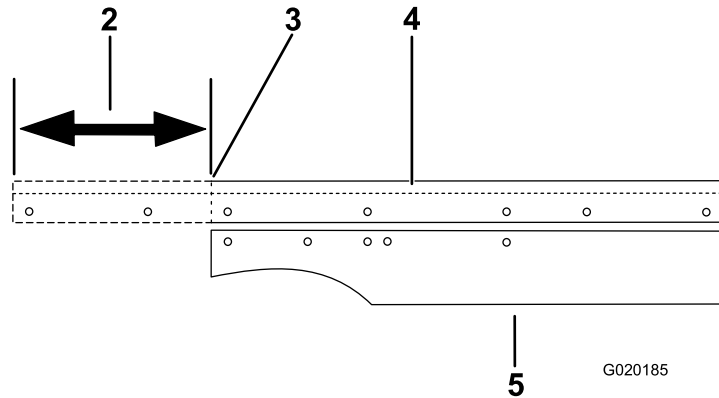
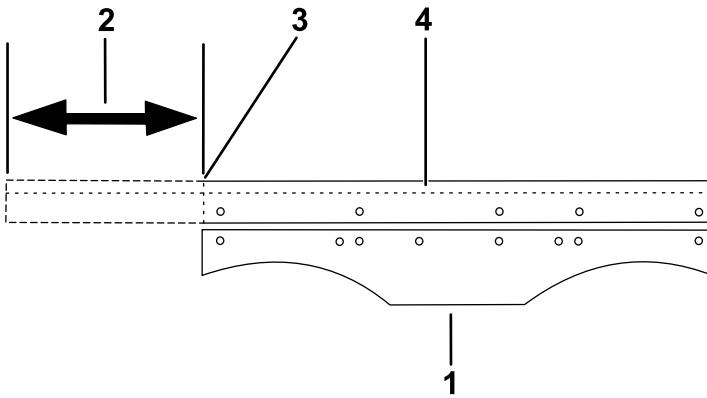

G020185

Figure 3
52 inch decks

- | | |
|---|---------------|
| 1. Baffle, left side, cut and shortened for 52 inch decks | 3. Trim here |
| 2. Cut this length | 4. Skid skirt |

5. Baffle, right (discharge) side, cut and shortened for 52 inch decks

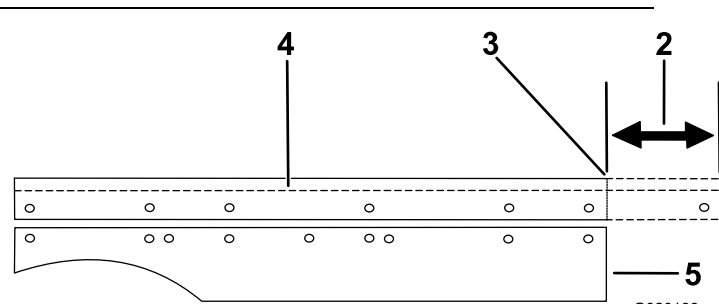
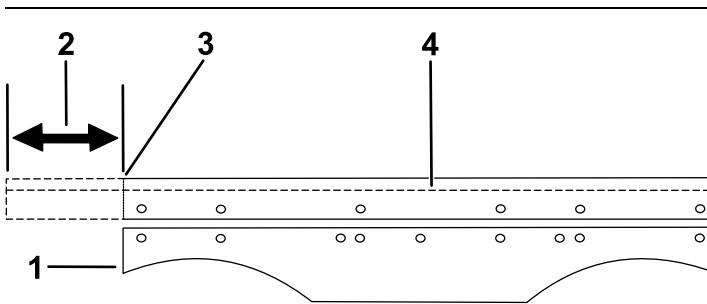

G020183

Figure 4
60 inch decks

- | | |
|---|---------------|
| 1. Baffle, left side, cut and shortened for 60 inch decks | 3. Trim here |
| 2. Cut this length | 4. Skid skirt |

5. Baffle, right (discharge) side, cut and shortened for 60 inch decks

4. Position the trimmed baffle and skid skirt as shown in [Figure 5](#).
5. Secure the baffle and skid skirt to the deck using six carriage bolts (5/16 x 1 inch) and six locknuts (5/16 inch) ([Figure 5](#)).

Note: 52 inch and 60 inch decks will require less fasteners due to the adjustments made previously to the kit.

6. Install a carriage bolt (5/16 x 1-1/4 inches) at the outer most hole of the baffle ([Figure 5](#)).
7. Repeat steps 4 through 6 for opposite side.
8. Move mower off the Z Stand. See the *Operator's Manual* for instructions.

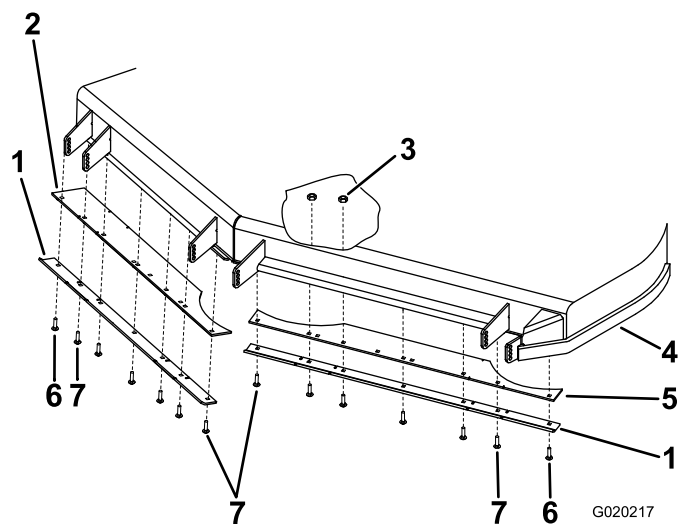

Figure 5

72 inch deck shown

- | | |
|-----------------------------------|--|
| 1. Skid skirt | 5. Baffle, left side |
| 2. Baffle, right (discharge) side | 6. Carriage bolt (5/16 x 1-1/4 inches) |
| 3. Locknut (5/16 inch) | 7. Carriage bolt (5/16 x 1 inch) |
| 4. Deck | |



Count on it.