



Semi-Pneumatic Front Tire Kit

Z Master® Riding Mower

Model No. 78582

Form No. 3376-915 Rev A

Installation Instructions

⚠ WARNING

CALIFORNIA Proposition 65 Warning

This product contains a chemical or chemicals known to the State of California to cause cancer, birth defects, or reproductive harm.

Loose Parts

Use the chart below to verify that all parts have been shipped.

Description	Qty.	Use
Bolt	1	Replace the tire.
Nut	1	
Seal guard	2	
Tire	1	

Replacing the Tire

1. Disengage the PTO, move the motion control levers to the neutral locked position and set the parking brake.
2. Stop the engine, remove the key, and wait for all moving parts to stop before leaving the operating position.
3. Raise the front of the machine and support with jack stands.
4. Remove the existing tire.
5. Install the new tire with the bolt, seal guards and nut (Figure 1).
6. Raise the machine up and remove the jack stands.

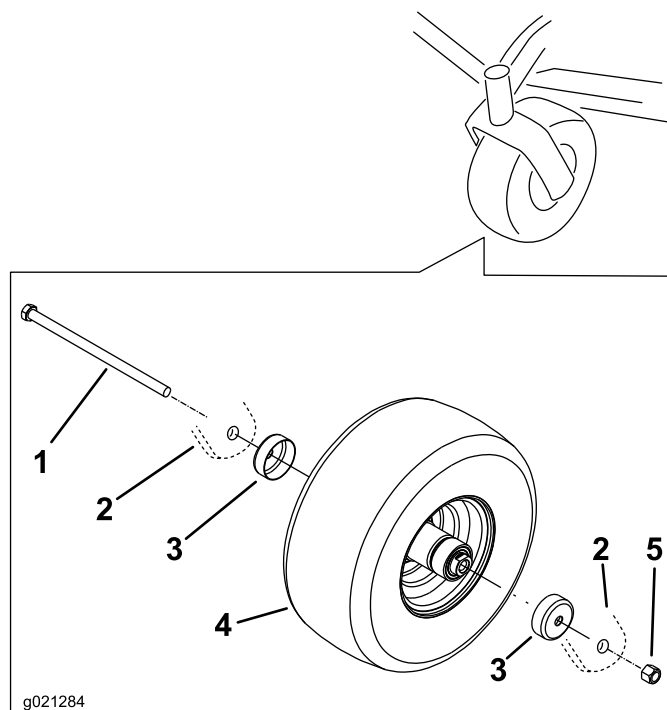

Figure 1

- | | |
|---------------|---------|
| 1. Bolt | 4. Tire |
| 2. Fork frame | 5. Nut |
| 3. Seal guard | |





Count on it.