



EZ Wheel Plate Kit

Forward Plate Compactors

Model No. 68068

Form No. 3377-661 Rev A

Installation Instructions

Installation

1. Slide a wheel onto the EZ wheel base.
2. Secure the wheel in place with a flat washer and a push nut.
3. Repeat steps 1 and 2 for the opposite side.
4. Hook the EZ wheel base onto the rear lift handles of the plate compactor.
5. Transport the plate compactor by pulling back on the plate compactor handle to shift the weight of the compactor onto the wheels.

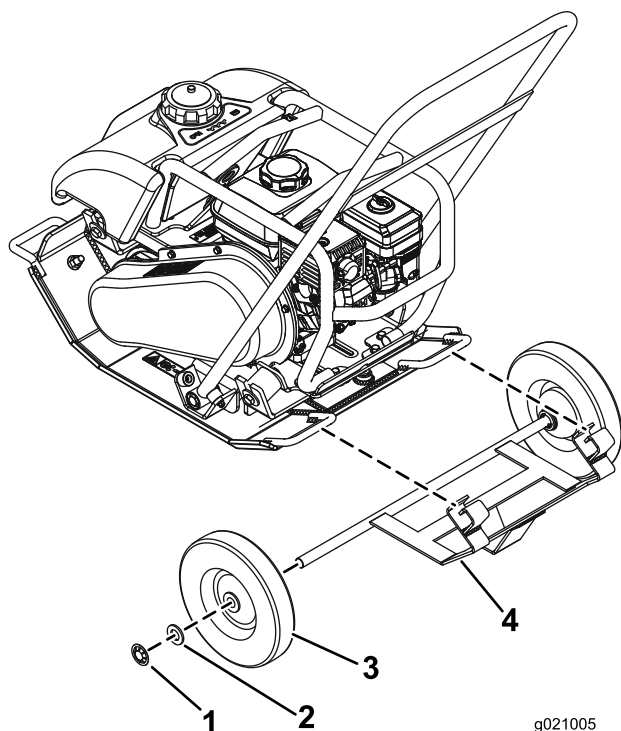

Figure 1

- | | |
|----------------|------------------|
| 1. Push nut | 3. Wheel |
| 2. Flat washer | 4. EZ wheel base |

