



Beacon Kit

Groundsmaster® 4000 Series Traction Unit with Yanmar Engine

Model No. 30661

Installation Instructions

⚠ WARNING

CALIFORNIA Proposition 65 Warning

This product contains a chemical or chemicals known to the State of California to cause cancer, birth defects, or reproductive harm.

Installation

Loose Parts

Use the chart below to verify that all parts have been shipped.

Procedure	Description	Qty.	Use
1	No parts required	–	Disconnect the battery
2	Switch, beacon Wire harness, beacon	1 1	Install the beacon switch
3	Beacon Beacon socket Beacon mount, ROPS U-bolt Flange nut, 3/8 inch Wire harness, beacon	1 1 1 1 2 1	Install the beacon to the ROPS
4	Beacon Beacon socket Beacon mount, cab Flange nut, 3/8 inch Cable tie Mounting pad Bolt, 3/8 x 7/8 inch Wire harness, beacon	1 1 1 1 3 3 1 1	Install the beacon to the cab
5	Decal, fuse Fuse, 10 amp	1 1	Install the fuse

Media and Additional Parts

Description	Qty.	Use
Installation instructions	1	Read instructions before installing and operating the kit
Parts catalog	1	Use to reference part numbers



1

Disconnecting the Battery

No Parts Required

Procedure

1. Position the machine on a level surface, set the parking brake, lower the cutting units, turn the ignition off, and remove the key from the ignition switch.

⚠ CAUTION

If you leave the key in the ignition switch, someone could accidentally start the engine and seriously injure you or bystanders.

Remove the key from the ignition switch before you do any maintenance.

2. Disconnect the negative battery cable from the battery post.

2

Installing the Beacon Switch

Parts needed for this procedure:

1	Switch, beacon
1	Wire harness, beacon

Procedure

1. Remove the steering tower cover from the steering tower (Figure 1).

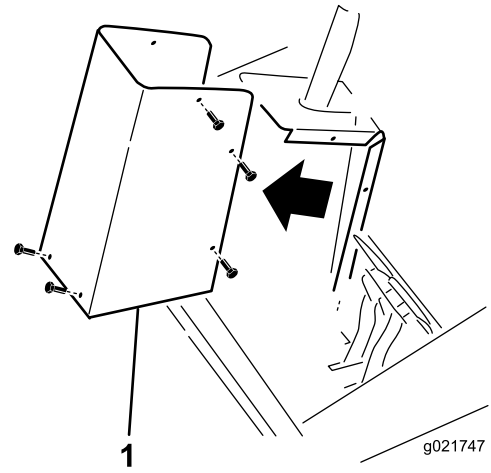

Figure 1

1. Steering tower cover

2. From the under side of the steering tower dash panel, press the plug out of the hole shown in Figure 2.

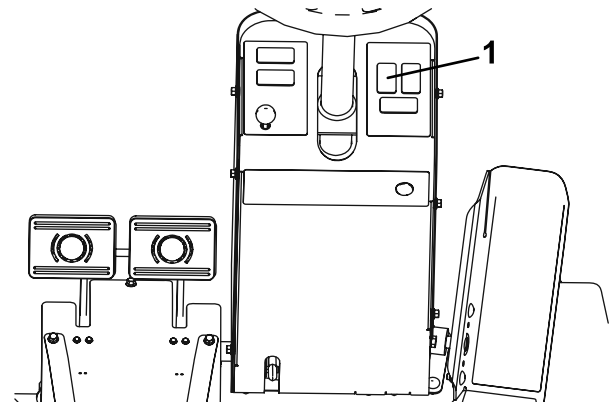

Figure 2

1. Remove this hole plug

3. Install the beacon switch into the hole in the steering tower dash panel (Figure 3). The turn signal switch is an On-Off-On switch.

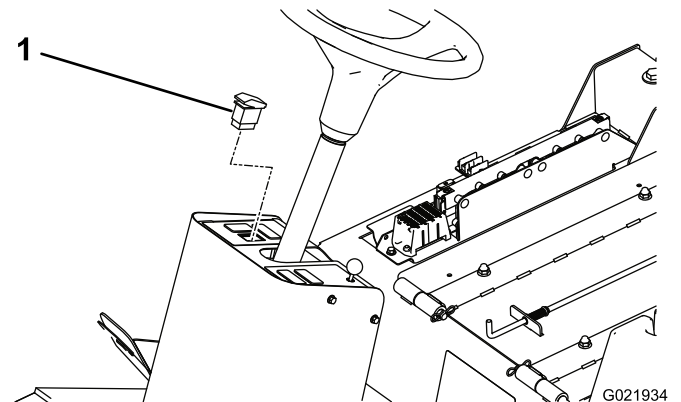

Figure 3

1. Beacon switch

4. Plug the connector body from the enclosed beacon wire harness into the beacon switch.
5. Cable tie the harness away from any hot or rotating components and avoid any possible pinch points.

Note: When routing the wires, ensure that the operation of the tilt steering does not damage the harness or pull on the wires.

3

Installing the Beacon to the ROPS (When not equipped with a cab)

Parts needed for this procedure:

1	Beacon
1	Beacon socket
1	Beacon mount, ROPS
1	U-bolt
2	Flange nut, 3/8 inch
1	Wire harness, beacon

Procedure

1. Route the wire harness to the right upright of the ROPS.
2. Loosely secure the beacon mount (ROPS) to the side of the ROPS post with the U-bolt and (2) 3/8 inch flange nuts, positioning as shown in Figure 4.

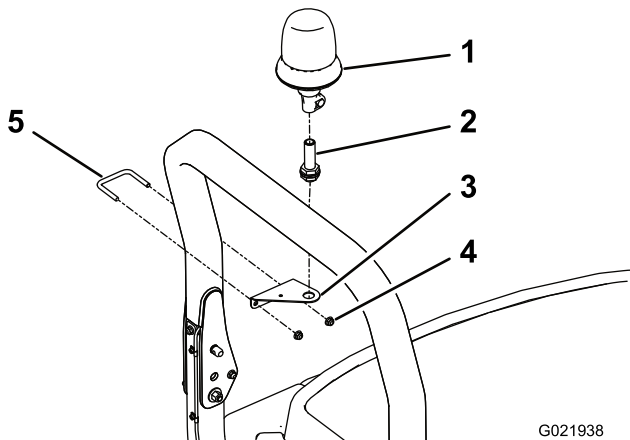
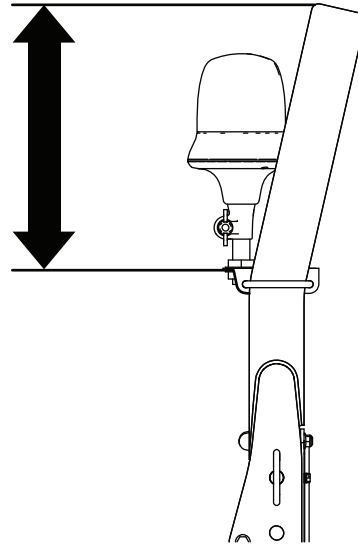

Figure 4

- | | |
|------------------|-------------------------|
| 1. Beacon | 4. Flange nut, 3/8 inch |
| 2. Beacon socket | 5. U-bolt |
| 3. Beacon mount | |

3. Position the beacon mount so it is 37 cm (14.50 inches) from the top of the ROPS and tighten the U-bolt nuts (Figure 5).



G021939

Figure 5

4. Mount the beacon socket to the beacon mount with the jam nut included (Figure 4).
5. Plug the beacon onto the socket and tighten the wing nut (Figure 4).
6. Route the wire harness up the ROPS post and plug it into the beacon socket.

4

Installing the Beacon (When equipped with a cab)

Parts needed for this procedure:

1	Beacon
1	Beacon socket
1	Beacon mount, cab
1	Flange nut, 3/8 inch
3	Cable tie
3	Mounting pad
1	Bolt, 3/8 x 7/8 inch
1	Wire harness, beacon

Procedure

1. Route the wire harness to the front right corner post of the cab.

- Secure the beacon mount (cab) to the tab on the right corner of the cab frame with a 3/8 x 7/8 inch screw and a 3/8 inch flange nut (Figure 6).

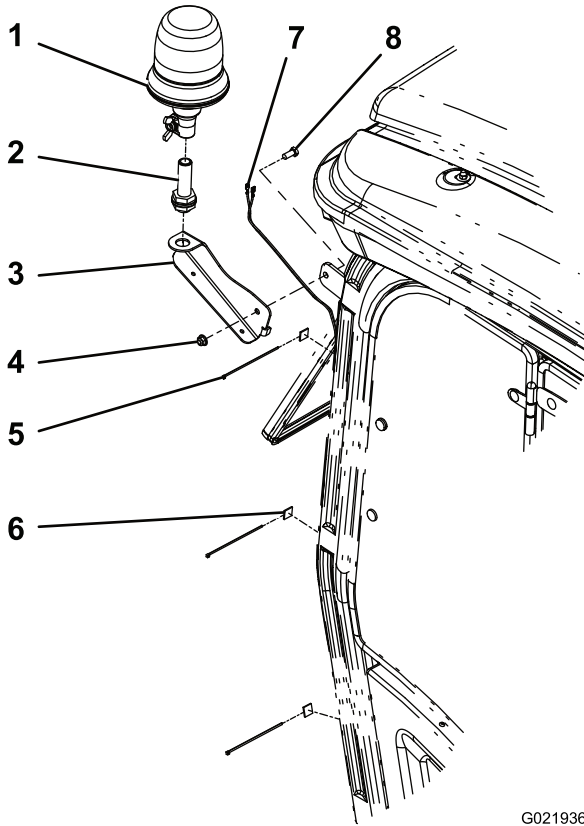

Figure 6

G021936

- | | |
|-------------------------|-------------------------|
| 1. Beacon | 5. Cable tie |
| 2. Beacon socket | 6. Mounting pad |
| 3. Beacon mount, cab | 7. Bolt, 3/8 x 7/8 inch |
| 4. Flange nut, 3/8 inch | 8. Wire harness, beacon |

- Mount the beacon socket to the beacon mount with the jam nut included (Figure 6).
- Plug the beacon onto the socket and tighten the wing nut (Figure 6).
- Route the wire harness up the corner of the cab post and plug it into the beacon socket (Figure 6).
- Affix the (3) mounting pads to the cab post and secure the wire harness to the pads with cable ties (Figure 6).

5

Installing the Fuse

Parts needed for this procedure:

1	Decal, fuse
1	Fuse, 10 amp

Procedure

- Remove the (2) Allen head screws securing the power center cover to the frame and remove the cover (Figure 7).

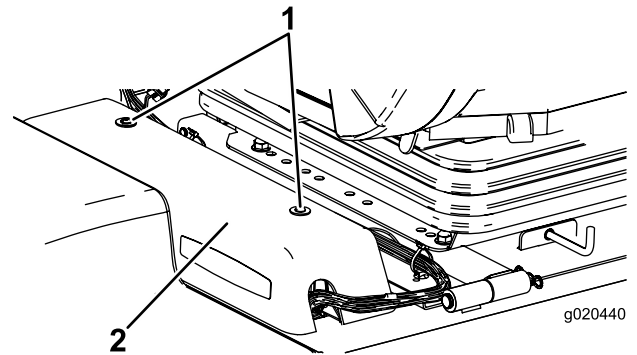

Figure 7

g020440

- | | |
|----------------------|-----------------------|
| 1. Allen head screws | 2. Power center cover |
|----------------------|-----------------------|

- Affix the beacon decal to the fuse block decal at the location shown in (Figure 8). Make sure the decal surface is clean and dry before affixing the decal.

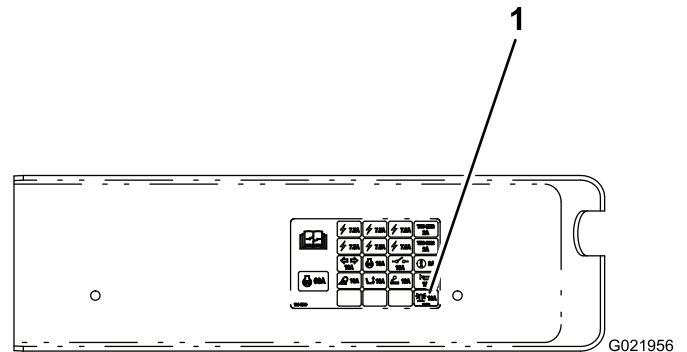

Figure 8

G021956

- Install beacon decal here

- Route the wire harness under the traction unit up into the power center (Figure 9).

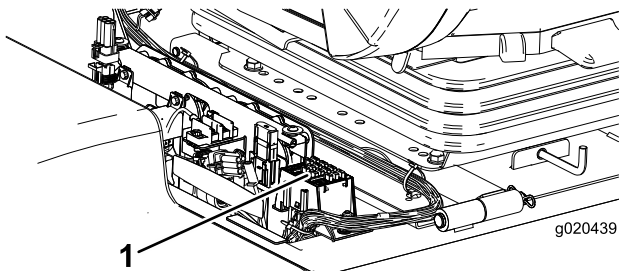

Figure 9

1. Power center

4. Remove the outer screw securing the jumper strip to the ground terminal (Figure 10).

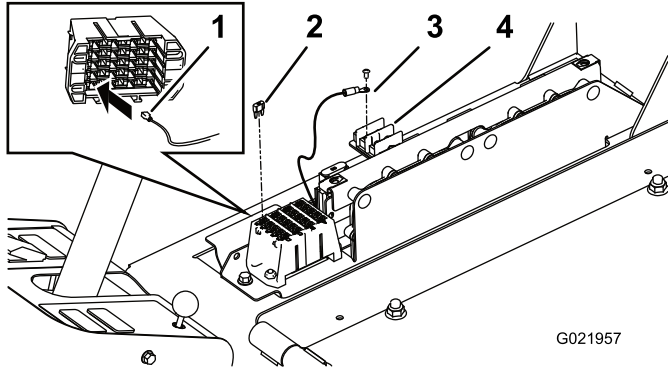

Figure 10

- | | |
|--------------------|---------------------------------|
| 1. Spade connector | 4. Ground terminal/jumper strip |
| 2. Fuse, 10 amp | 5. |
| 3. Ground wire | |

5. Secure the wire harness ring terminal (ground wire) to the jumper strip/ground terminal with the screw previously removed (Figure 10).
6. Plug the wire harness spade connector into the underside of fuse block slot which corresponds to the location on the decal (Figure 10).
7. Insert the 10 amp fuse into the fuse block (Figure 10).
8. Install the power center cover and secure it with the (2) Allen head screws.

6

Connecting the Battery

No Parts Required

Procedure

Connect the negative battery cable to the battery post.

Operation

Controls

Beacon Switch

Press the beacon switch to the On position to activate the beacon.

Notes:



Count on it.