



Paver Mat Kit For Forward Plate Compactors

Model No. 68064

Model No. 68065

Form No. 3377-656 Rev B

Installation Instructions

Installation

1. Disconnect the hose that connects the sprinkler to the rest of the watering system and remove it from the machine.
2. Apply Loctite to the bolt threads before installation.
3. Mount the paver mat to the plate compactor with the parts positioned as shown in Figure 1, and secure it using 2 bolts, a paver clamp, and 2 locknuts.

Reconnect the hose to the sprinkler.

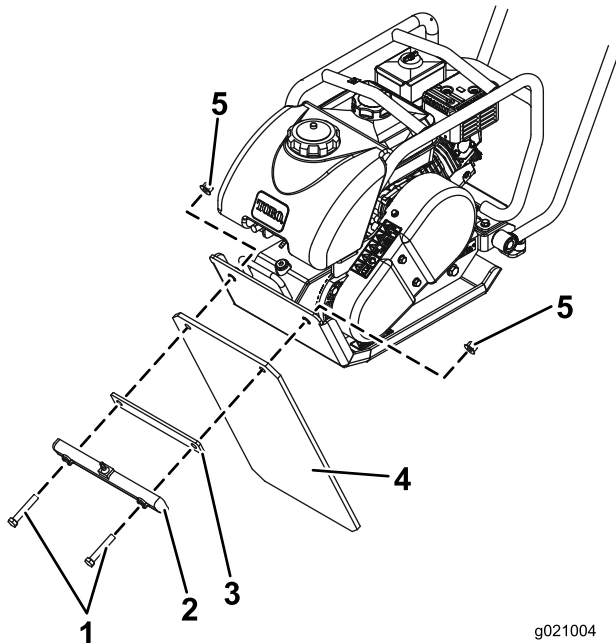

g021004

Figure 1

- | | |
|----------------|--------------|
| 1. Bolts | 4. Paver mat |
| 2. Sprinkler | 5. Locknut |
| 3. Paver clamp | |

