



MODEL NO. 30122

# INSTALLATION INSTRUCTIONS

## SULKY KIT

(FOR COMMERCIAL WALK MOWERS)

1. Slide wheels onto axle and secure each side with a flat washer and cotter pin.
2. Mount seat brackets to seat with (4) capscrews and star lockwashers as shown in illustration.
3. Loosely secure seat and brackets to seat support of frame with (4) carriage bolts, belleville washers and knobs. Washers to be positioned outside of seat brackets.
4. Loosely secure footrest to frame with (2) U-bolts and locknuts as shown in illustration.
5. Mount hitch bracket to inside rear of mower frame with (2) capscrews and locknuts. Position bracket as shown in illustration.

**Note:** On mowers with a serial number prior to 5000001, mounting holes for bracket must be drilled in mower frame. Using bracket as a template, mark mounting hole locations and drill (2) 11/32" dia. holes in frame. Bracket should be positioned in approximately the center of the frame.

6. To attach sulky to mower, raise right side of sulky until hitch tongue can be inserted into hitch bracket hole.

7. Adjust seat and footrest to desired operating position and tighten respective mounting knobs and locknuts.

**Note:** Check tire pressure and make sure they are inflated to 30 psi.



## WARNING

1. Maximum seating capacity is one person. Never carry passengers.
2. Engage traction control slowly to prevent front of mower from rising off ground.
3. Use caution when operating on rough or undulating terrain or when going through ditches, as upper handle pivots downward as front of mower rises.
4. Do not use sulky when mowing on hilly terrain or if sharp turns are required.
5. When riding on sulky keep shoes on footrest and knees outside of handlebars.

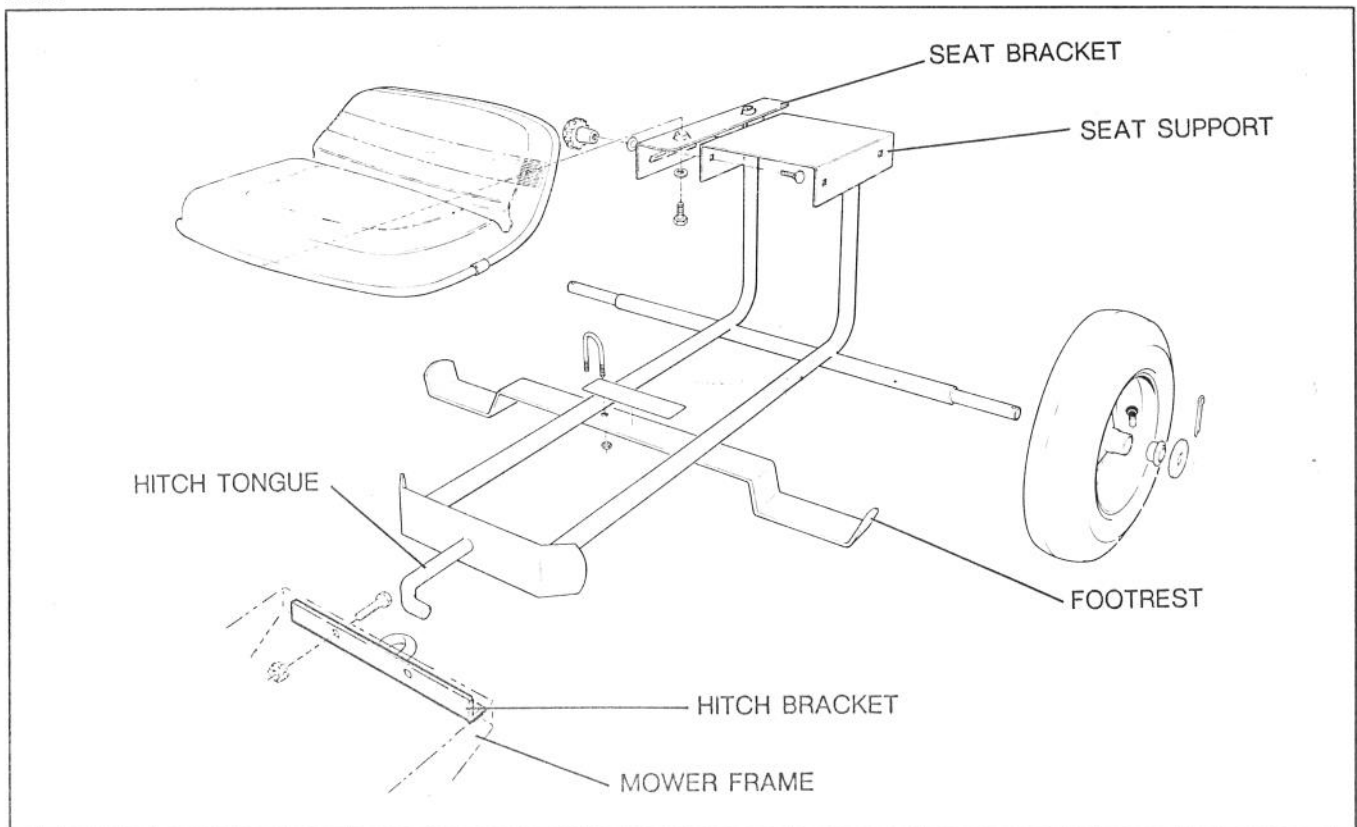

Figure 1