



Depth Gauge Kit

ProCore® SR Aerator

Model No. 125-3300

Form No. 3379-203 Rev A

Installation Instructions

⚠ WARNING

CALIFORNIA Proposition 65 Warning

This product contains a chemical or chemicals known to the State of California to cause cancer, birth defects, or reproductive harm.

Installation

1. Disengage the PTO and engage the parking brake.
2. Stop the engine and remove the key from ignition switch.
3. Mount the depth gauge to the flat side of the slide block with two #10 x 1/2 inch machine screws, positioning the components as shown in Figure 1.
4. Using the tube clamp, weld plate and two 1/4 x 2-1/2 inch screws, loosely mount the depth gauge to the rod end of the top link cylinder (Figure 1). Make sure the clamps are loose enough to allow them to be rotated to the desired position.
5. Make sure the top of cylinder is clean enough to accept the installation of a decal.
6. Affix the depth decal to the top of the cylinder at a location that is visible to the operator and does not interfere with hydraulic hoses or other obstructions (Figure 1). The end of the decal with the letter "J" is to be positioned toward the aerator.
7. Check to make sure the cylinder rod can extend and retract fully without interfering with other tractor or aerator components. Then, tighten the depth gauge mounting screws when the desired location is attained.
8. The letters on the decal do not correspond to a particular depth. Run the aerator on a test plot to determine the desired setting and note the corresponding position on the depth indicator. The operator then can adjust the cylinder while in operation to a deeper setting "J" or shallower setting "A" as desired.

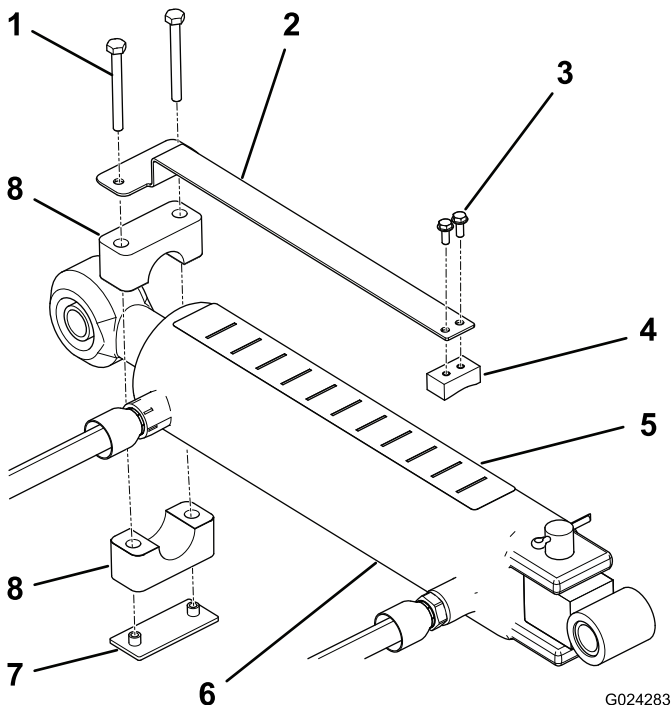

G024283

Figure 1

- | | |
|----------------------|----------------|
| 1. Screw | 5. Depth decal |
| 2. Depth gauge | 6. Cylinder |
| 3. Machine screw (2) | 7. Weld plate |
| 4. Slide block | 8. Tube clamp |

