



Tow Pole Hitch for End-Dump Concrete Mixers

Model No. 68130

Model No. 68131

Model No. 68132

Installation Instructions

⚠ WARNING

CALIFORNIA Proposition 65 Warning

This product contains a chemical or chemicals known to the State of California to cause cancer, birth defects, or reproductive harm.

Safety

Safety and Instructional Decals



Safety decals and instructions are easily visible to the operator and are located near any area of potential danger. Replace any decal that is damaged or lost.

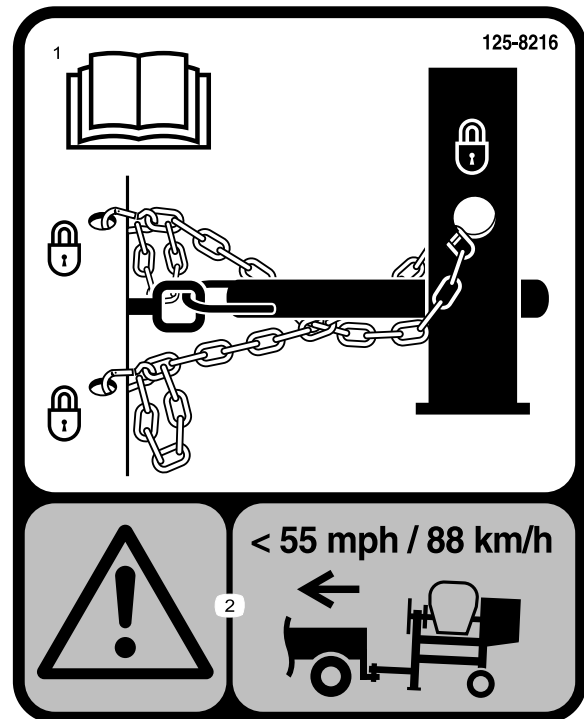

125-8216

1. Read the *Operator's Manual* for information on how to tow the machine.
2. Warning—limit towing speed to less than 55 mph / 88 km/h.



Installation

Loose Parts

Use the chart below to verify that all parts have been shipped.

Procedure	Description	Qty.	Use
1	Tow pole	1	Install the tow pole.
	Front stabilizer leg (shipped with the machine)	1	
	Short bolt	6	
	Long bolt	1	
	Locknut	7	
2	Hitch assembly	1	Install the hitch assembly.
	Flange-head bolt	2	
	Locknut	2	
3	Safety chain	1	Install the safety chain and connecting links.
	Connecting link	2	

1

Parts needed for this procedure:

1	Tow pole
1	Front stabilizer leg (shipped with the machine)
6	Short bolt
1	Long bolt
7	Locknut

Procedure

1. Lower the rear stabilizer legs; refer to the machine *Operator's Manual*.
2. Place jack stands under the front frame rail to prevent the machine from tipping forward (Figure 1).

⚠ WARNING

Mechanical or hydraulic jacks may fail to support the machine and cause serious injury.

Use jack stands when supporting the machine.

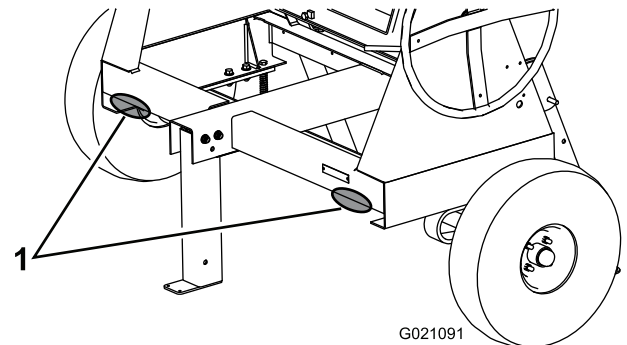

Figure 1

1. Support points

3. Remove the 2 nuts and bolts that secure the front stabilizer leg to the frame (Figure 2), and remove the front stabilizer leg.

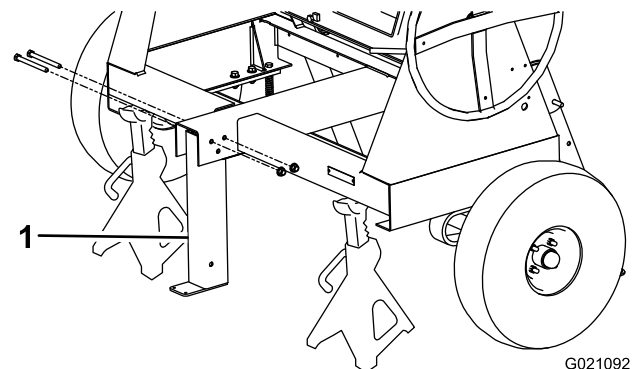

Figure 2

1. Front stabilizer leg

4. Install the tow pole into the opening at the front of the machine, and secure it with 6 short bolts and 6 locknuts torqued to 102 N-m (75 ft-lb); refer to Figure 3.

2

Installing the Hitch Assembly

Parts needed for this procedure:

1	Hitch assembly
2	Flange-head bolt
2	Locknut

Procedure

- Using 2 flange-head bolts and 2 locknuts, loosely install the hitch assembly in the middle position of the mounting plate.

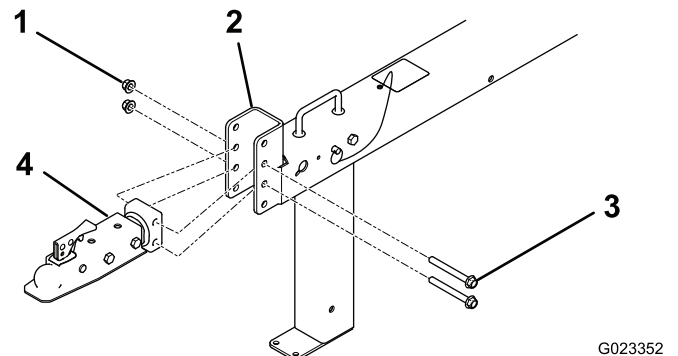

Figure 5
Ball hitch shown

- Locknut (2)
- Mounting plate
- Flange-head bolt (2)
- Hitch assembly

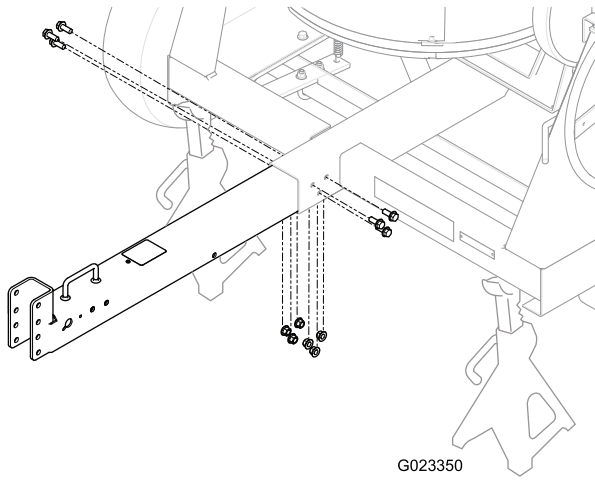

Figure 3

- Align the top rear hole in the front stabilizer leg (Figure 4) to the rearmost hole near the handle at the front of the tow pole.

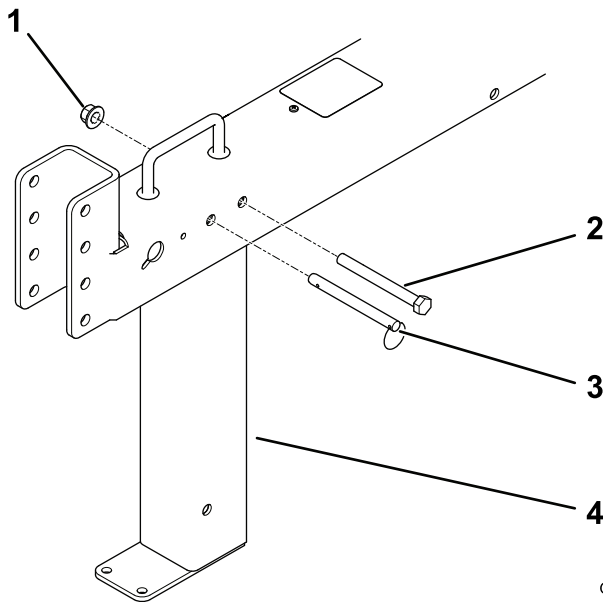

Figure 4

- Locknut
- Long bolt
- Clevis pin
- Front stabilizer leg

- Install the long bolt through the holes, and secure it with a locknut torqued to 102 N-m (75 ft-lb); refer to Figure 4.

Note: The stabilizer leg pivots rearward on the bolt. If you install the bolt into the wrong hole, the stabilizer leg will not work properly.

- Insert the clevis pin (Figure 4) to lock the front stabilizer leg in position.

Note: Rotate the stabilizer leg up for towing the machine, and down when the machine is stationary. Always insert the clevis pin through the appropriate holes to ensure that the stabilizer leg does not move unexpectedly.

- Position the machine so that the tow pole is level.
- Check the relationship between the hitch of the machine and the hitch of the tow vehicle, and mount the hitch assembly in 1 of the following positions:
 - If the hitches are approximately the same height, keep the hitch assembly in the middle position of the mounting plate; refer to Figure 6.
 - If the hitch of the tow vehicle is high, mount the hitch assembly in the top position.
 - If the hitch of the tow vehicle is low, mount the hitch assembly in the bottom position.

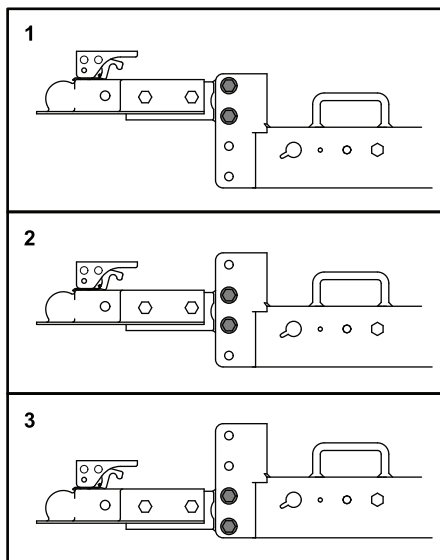

G023353

Figure 6
Ball hitch shown

1. Top position
2. Middle position
3. Bottom position

4. Torque the 2 nuts and 2 bolts to 102 N-m (75 ft-lb).

Important: Refer to the machine *Operator's Manual* for information about hitching and towing the machine.

3

Installing the Safety Chain and Connecting Links

Parts needed for this procedure:

1	Safety chain
2	Connecting link

Installing the Safety Chain

1. Form a hook on the end of a bendable piece of rod or stiff wire (not included), and insert it through both keyholes in the tow pole of the machine (Figure 7).

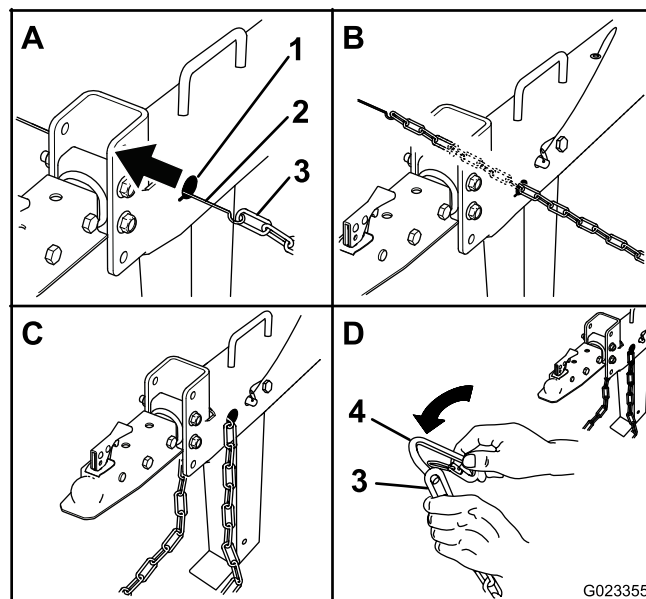

G023355

Figure 7

1. Keyhole
2. Rod or wire (not included)
3. Safety chain
4. Connecting link

2. Attach the safety chain to the length of rod or wire (Figure 7).
3. Pull the rod, or wire, and the safety chain through both keyholes (Figure 7).

Note: Ensure that approximately equal lengths of safety chain extend from either side of the tow pole.