



Count on it.

Operator's Manual

TR-34D Trench Roller

Model No. 68039—Serial No. 313000001 and Up

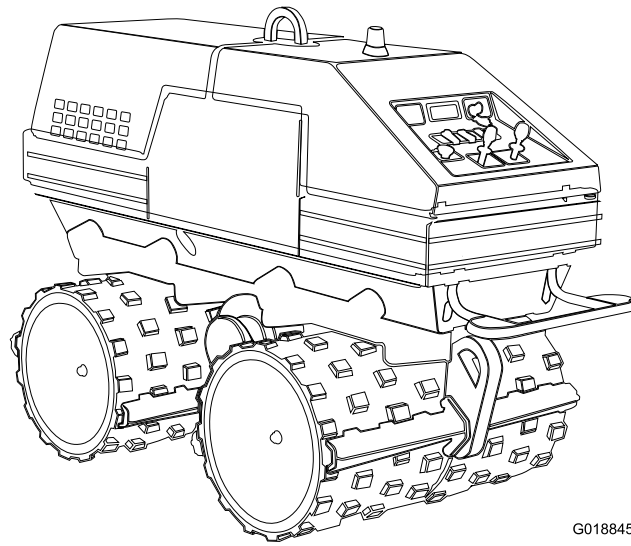

G018845



⚠ WARNING

**CALIFORNIA
Proposition 65 Warning**

This product contains a chemical or chemicals known to the State of California to cause cancer, birth defects, or reproductive harm.

Diesel engine exhaust and some of its constituents are known to the State of California to cause cancer, birth defects, and other reproductive harm.

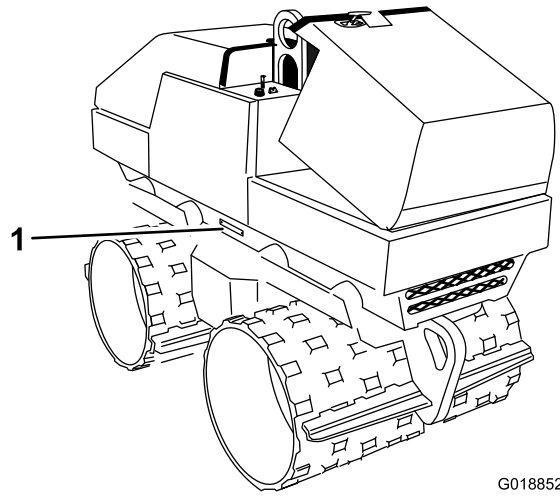

G018852

Figure 1

1. Model and serial number location

| |
|------------------|
| Model No. _____ |
| Serial No. _____ |

Important: This engine is not equipped with a spark arrester muffler. It is a violation of California Public Resource Code Section 4442 to use or operate the engine on any forest-covered, brush-covered, or grass-covered land. Other states or federal areas may have similar laws.

Introduction

This machine is intended for use in various soil for landscaping and construction work. It is designed to perform a specialized function.

Read this information carefully to learn how to operate and maintain your product properly, and to avoid injury and product damage. You are responsible for operating the product properly and safely.

You may contact Toro directly at www.Toro.com for product and accessory information, help finding a dealer, or to register your product.

Whenever you need service, genuine Toro parts, or additional information, contact an Authorized Service Dealer or Toro Customer Service and have the model and serial numbers of your product ready. Figure 1 identifies the location of the model and serial numbers on the product. Write the numbers in the space provided.

Figure 2 shows the location of the identification numbers on radio-control transmitter and radio-control receiver. Write the numbers in the space provided.

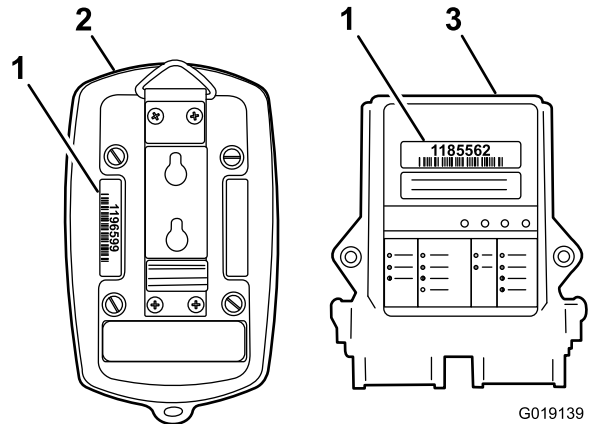

G019139

Figure 2

1. Transmitter serial number tag
2. Radio-control transmitter
3. Radio-control receiver tag
4. Receiver serial number tag

| |
|------------------------------|
| Transmitter Serial No. _____ |
| Receiver Serial No. _____ |

This manual identifies potential hazards and has safety messages identified by the safety alert symbol (Figure 3), which signals a hazard that may cause serious injury or death if you do not follow the recommended precautions.



Figure 3

1. Safety alert symbol
-

This manual uses 2 other words to highlight information. **Important** calls attention to special mechanical information and **Note** emphasizes general information worthy of special attention.

Contents

| | |
|--|----|
| Removing the Machine from Storage..... | 60 |
| Troubleshooting | 61 |

| | |
|--|----|
| Introduction | 2 |
| Safety | 5 |
| Safe Operating Practices..... | 5 |
| Stability Data | 7 |
| Slope Chart | 8 |
| Tilt Chart | 9 |
| Safety and Instructional Decals | 10 |
| Product Overview | 13 |
| Controls | 14 |
| Specifications | 21 |
| Operation | 21 |
| Pre-start Checklist | 22 |
| Fuel | 22 |
| Accessing the Machine | 24 |
| Engine Oil and Hydraulic Fluid | 25 |
| Starting and Stopping the Engine..... | 27 |
| Stopping the Machine | 28 |
| Using the Parking Brake | 28 |
| Moving a Non-functioning Machine | 30 |
| Lifting the Machine | 30 |
| Preparing the Machine for Transport..... | 31 |
| Moving and Vibrating Operation | 32 |
| Recovering the Machine After a Tip-over Event..... | 35 |
| Maintenance | 39 |
| Recommended Maintenance Schedule(s) | 39 |
| Pre-maintenance Procedures | 40 |
| Lubrication | 40 |
| Greasing the Machine | 40 |
| Engine Maintenance | 41 |
| Changing the Engine Oil and Filter | 41 |
| Servicing the Air Filter | 44 |
| Engine Hardware | 45 |
| Fuel System Maintenance | 46 |
| Replacing the Fuel Filter/Water Separator Canister..... | 46 |
| Draining the Fuel Tank | 47 |
| Fuel Lines and Fuel Injectors | 48 |
| Electrical System Maintenance | 49 |
| Servicing the Battery..... | 49 |
| Electrical and Electronic..... | 51 |
| Cooling System Maintenance | 53 |
| Servicing the Cooling System | 53 |
| Hydraulic System Maintenance | 54 |
| Replacing the Hydraulic Filter | 54 |
| Changing the Hydraulic Fluid..... | 55 |
| Checking the Hydraulic Lines..... | 56 |
| Hydraulic and Fuel Tank Access..... | 57 |
| Removing the Right-side Panel..... | 57 |
| Installing the Right-side Panel | 57 |
| Eccentric Maintenance | 58 |
| Changing the Eccentric Lubricant..... | 58 |
| Cleaning | 59 |
| Removing Debris from the Machine..... | 59 |
| Cleaning the Chassis | 59 |
| Storage | 60 |

Safety

Improper use or maintenance by the operator or owner can result in injury. To reduce the potential for injury, comply with these safety instructions and always pay attention to the safety alert symbol **A**, which means: *Caution, Warning, or Danger*—personal safety instruction. Failure to comply with the instruction may result in personal injury or death.

Safe Operating Practices

This product is capable of crushing or amputating hands and feet. Always follow all safety instructions to avoid serious injury or death.

A WARNING

Engine exhaust contains carbon monoxide, an odorless, deadly poison that can kill you.

Do not run the engine indoors or in an enclosed area.

Training

- Read the *Operator's Manual* and other training material. If the operator(s) or mechanic(s) cannot read English, it is the owner's responsibility to explain this material to them.
- Become familiar with the safe operation of the equipment, operator controls, and safety signs.
- All operators and mechanics should be trained. The owner is responsible for training the users.
- Never let children or untrained people operate or service the equipment. Local regulations may restrict the age of the operator.
- The owner/user can prevent and is responsible for accidents or injuries occurring to himself or herself, other people or property.

Preparation

- Evaluate the terrain to determine the proper and safe actions to perform the job. Only use accessories and attachments approved by the manufacturer.
- Wear appropriate clothing including hard hat, safety glasses, long pants, safety shoes, and hearing protection. Long hair, loose clothing or jewelry may get tangled in moving parts.
- Inspect the area where the equipment is to be used and remove all objects such as tools, building materials, and personal items which can be damaged by the machine.
- Use extra care when handling fuels. They are flammable and vapors are explosive.
 - Use only an approved container for storing and transporting fuel.
 - Never remove the fuel cap or add fuel to the machine with the engine running.

- Never add fuel to the machine or drain fuel from the machine indoors.
- Allow the engine to cool before fueling the machine.
- Do not smoke while fueling the machine.
- Check that the operator's presence controls, safety switches, and shields are attached and functioning properly. Do not operate unless they are functioning properly.
- Before compacting soil, have the area marked for underground utilities.

Operation

- Never run an engine in an enclosed area.
- Never carry people, animals, or equipment on top of the machine.
- Only operate in good light, keeping away from holes and hidden hazards.
- Be sure all traction controls are in neutral and parking brake is engaged before starting the engine.
- Slow down and use extra care on hillsides. Soil conditions affect the machine's stability.
- Never park on a hill.
- Never operate the machine with the vibration function On, and moving across the side of a hill.
- Do not operate in standing water.
- Do not park the machine for an extended period in a trench, ditch, or low-lying area that might fill with water. Lift or move the machine to a level, well drained surface.
- Do not operate at the edge of embankments or roads because the machine may tip over.
- Slow down and use caution when making turns and crossing roads and sidewalks.
- Use care when approaching blind corners, shrubs, trees, or other objects that may obscure vision.
- Stop on level ground, engage parking brake, shut off the engine before leaving the operator's position for any reason.
- Look behind and down before backing up to be sure of a clear path.
- Ensure that the area is clear of other people before operating the machine. Stop the machine if anyone enters the area.
- Never carry passengers and keep pets and bystanders away.
- Keep feet clear of drums.
- Hearing protection is required when operating this equipment.
- Do not operate the machine under the influence of alcohol or drugs.
- Locate the pinch point areas marked on the machine and keep hands and feet away from these areas.

- For foot protection, wear steel toe shoes or toe pads.
- Never operate with the guards not securely in place. Be sure all interlocks are attached, adjusted properly, and functioning properly.
- Do not exceed the rated operating capacity of the machine, as the machine may become unstable which may result in loss of control.
- Do not change the engine governor setting or overspeed the engine.
- Use care when loading or unloading the machine into a trailer or truck.
- Never leave the machine running unattended. Always stop the engine, set the parking brake, and remove the key before leaving.
- Never jerk the controls; use a steady motion.
- Watch for traffic when operating near or crossing roadways.
- Do not touch parts which may be hot from operation. Allow them to cool before attempting to maintain, adjust, or service.
- Check for overhead clearances (i.e. branches, doorways, electrical wires) before driving under any objects and do not contact them.
- Ensure that you operate the machine in areas where there are no obstacles in close proximity to the operator. Failure to maintain adequate distance from trees, walls, and other barriers may result in injury as the machine backs up during operation if the operator is not attentive to the surroundings. Only operate the unit in areas where there is sufficient clearance for the operator to safely maneuver the product.
- Lightning can cause severe injury or death. If lightning is seen or thunder is heard in the area, do not operate the machine; seek shelter.
- Never operate the machine with the vibration function Off, and moving up or down a grade that is greater than 55 percent (29°).
- Never operate the machine with the vibration function Off, and moving across the side of a hill with a grade that is greater than 18 percent (10°).
- Remove obstacles such as rocks, tree limbs, etc. from the work area. Watch for holes, ruts, or bumps, as uneven terrain could overturn the machine. Tall grass can hide obstacles.
- Use only Toro-approved attachments. Attachments can change the stability and the operating characteristics of the machine. Warranty may be voided if used with unapproved attachments.
- Keep all movements on slopes slow and gradual. Do not make sudden changes in speed or direction.
- Avoid starting or stopping on a slope. If the machine loses traction, ensure that the vibration function is turned to the Off position and proceed slowly, straight down the slope.
- Avoid turning on slopes. If you must turn, turn slowly.
- Do not operate near drop-offs, ditches, or embankments. The machine could suddenly turn over if a drum goes over the edge of a cliff or ditch, or if an edge caves in.
- Do not operate on wet grass. Reduced traction could cause sliding.

Slope Operation

Slopes are a major factor related to loss-of-control and tip-over accidents, which can result in severe injury or death. All slopes require extra caution.

- Do not park the machine on a hillside or slope.
- If possible, avoid driving the machine across a slope. When crossing a slope is necessary, drive the machine straight up the slope, across the top, and then straight down the slope.
- Slow down and use caution when making turns and when changing directions on slopes.
- Do not operate the machine on hillsides or slopes exceeding the angles recommended in Stability Data (page 7). See also the Slope Chart (page 8) and Tilt Chart (page 9).
- Never operate the machine with the vibration function On, and moving up or down a grade that is greater than 45 percent (24°).
- Park the machine on a level surface, set the parking brake, stop the engine, and remove the key. Wait for all movement to stop before adjusting, cleaning, or repairing.
- Clean debris from the drives, muffler, and engine to help prevent fires. Clean up fuel, oil, and hydraulic fluid spillage.
- Let the engine cool before storing and do not store near flame.
- Do not store fuel near flames or drain indoors.
- Never allow untrained personnel to service the machine.
- Use jack stands to support components of the machine when required.
- Carefully release pressure from components with stored energy.
- Disconnect the battery before making any repairs. Disconnect the negative terminal first and the positive last. Reconnect positive first and negative last.
- Keep hands and feet away from moving parts. If possible, do not make adjustments with the engine running.
- Charge batteries in an open well ventilated area, away from spark and flames. Unplug the charger before connecting or disconnecting it from the battery. Wear protective clothing and use insulated tools.



Maintenance and Storage

- Keep all parts in good working condition and all hardware tightened. Replace all worn or damaged decals.
- Keep nuts and bolts tight. Keep equipment in good condition.
- Never tamper with safety devices.
- Keep the machine free from the buildup of mud, rocks, or other debris. Clean up oil or fuel spillage. Allow the machine to cool before storing.
- Use extra care when handling fuels. They are flammable and vapors are explosive.
 - Use only an approved container.
 - Never remove the fuel cap or add fuel when the engine is running. Allow the engine to cool before refueling. Do not smoke.
 - Never refuel the machine indoors.
 - Never store the machine or fuel container inside where there is an open flame, such as near a water heater or furnace.
 - Never fill a fuel container while it is inside a vehicle, trunk, cargo box of a truck, or any surface other than the ground.
 - Keep container nozzle in contact with the tank during filling.
- Stop and inspect the equipment if you strike an object. Make any necessary repairs before restarting.
- Use only genuine Toro replacement parts to ensure that original standards are maintained.
- Battery acid is poisonous and can cause burns. Avoid contact with skin, eyes, and clothing. Protect your face, eyes, and clothing when working with a battery.
- Battery gases can explode. Keep cigarettes, sparks and flames away from the battery.
- Keep your body and hands away from pin hole leaks or nozzles that eject high pressure hydraulic fluid. Use cardboard or paper to find hydraulic leaks; never use your hands. Hydraulic fluid escaping under pressure can penetrate skin and cause injury requiring surgery within a few hours by a qualified surgeon or gangrene may result.

Stability Data

The following tables list the maximum slope recommended for the machine in the positions listed in the tables. Slopes over the listed degree in the stability data table may cause the machine to become unstable.

Stability Data Table

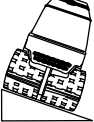
| Slope Operation Type: | Operational Limit: Vibration Off Grade (Degrees) | Operational Limit: Vibration On Grade (Degrees) |
|---|--|---|
|  Uphill | 55% (29°) | 45% (24°) |
|  Downhill | 55% (29°) | 45% (24°) |
|  Across the hill | 18% (10°) | 0% (0°) |

Slope Chart

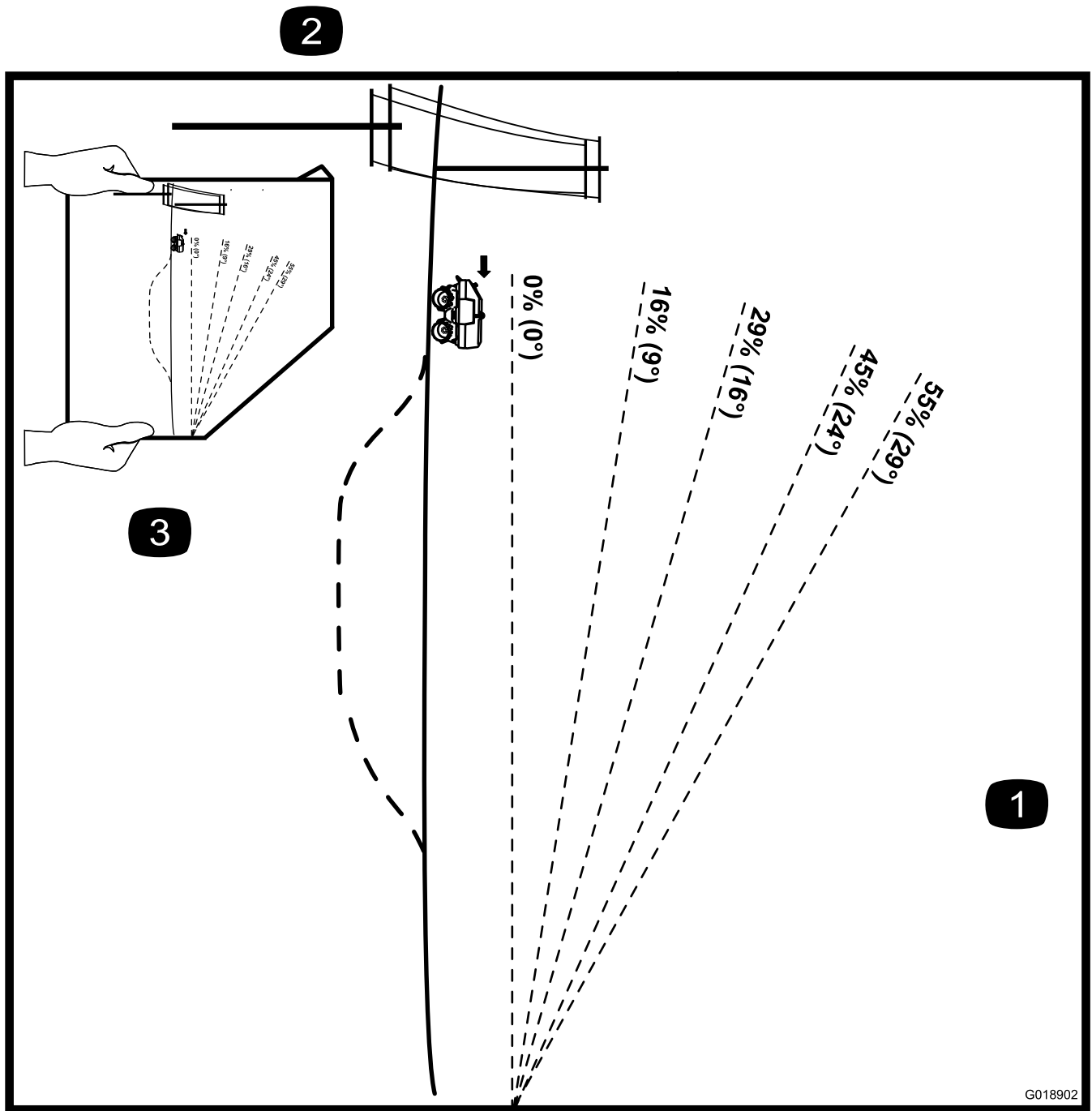

Figure 4

This page may be copied for personal use.

1. To determine the maximum slope you can safely operate the machine, refer to the Stability Data section. Use the grade indicator to determine the grade of incline before operating. **Do not operate this machine on a grade greater than that specified in the Stability Data section.** Fold along the appropriate line to match the observed grade.
2. Align this edge with a vertical surface such as a utility pole, tree, building, etc.
3. Example of how to compare grade with folded edge.

Note: For tilt limits, refer to Figure 5.

Tilt Chart

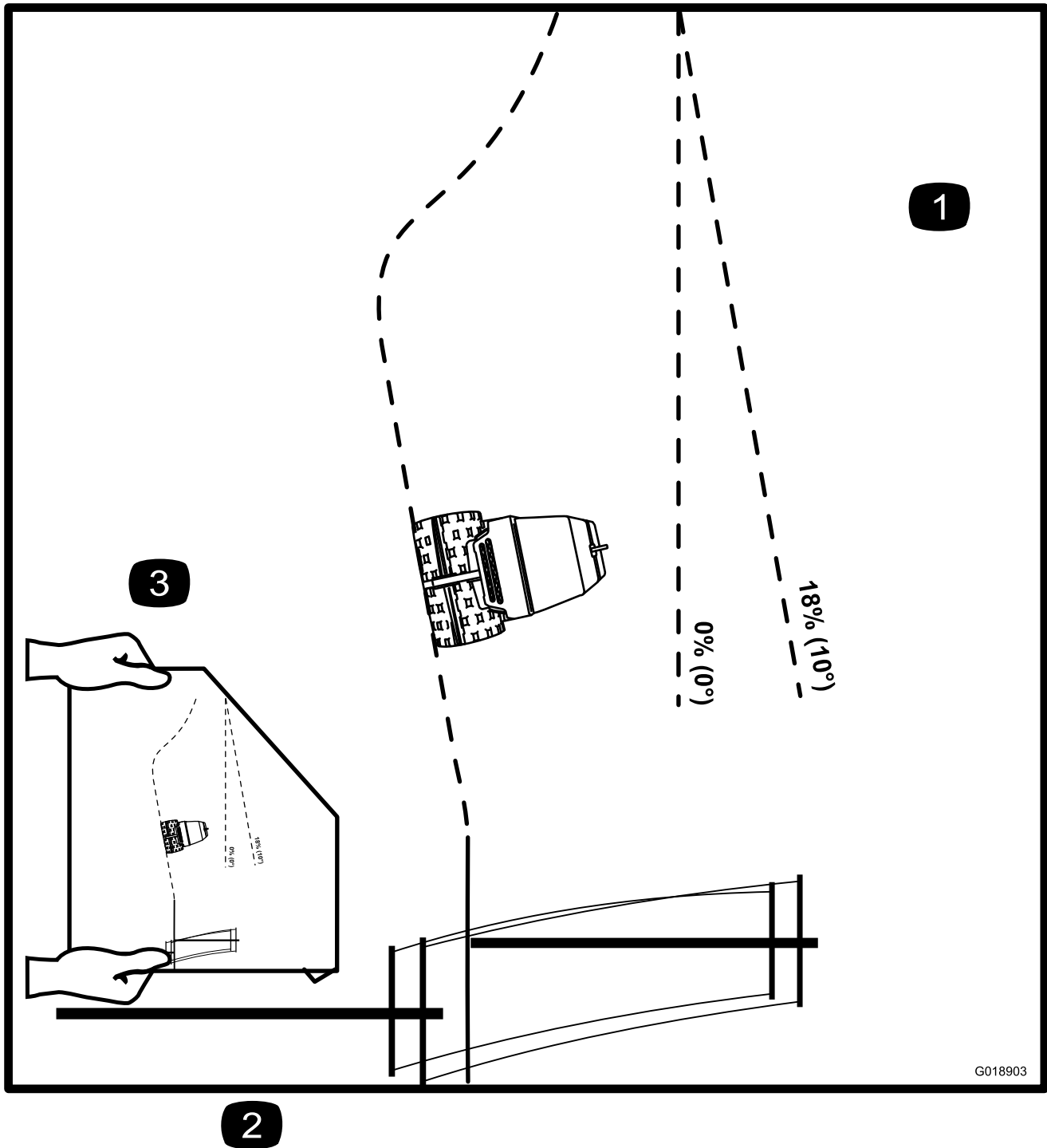

Figure 5

This page may be copied for personal use.

1. To determine the maximum tilt you can safely operate the machine, refer to the Stability Data section. Use the tilt indicator to determine the degree of slope before operating. **Do not operate this machine on a slope greater than that specified in the Stability Data section.** Fold along the appropriate line to match the recommended slope.
2. Align this edge with a vertical surface such as a utility pole, tree, building, etc.
3. Example of how to compare slope with folded edge.

Note: For slope limits, refer to Figure 4.

Safety and Instructional Decals



Safety decals and instructions are easily visible to the operator and are located near any area of potential danger. Replace any decal that is damaged or lost.

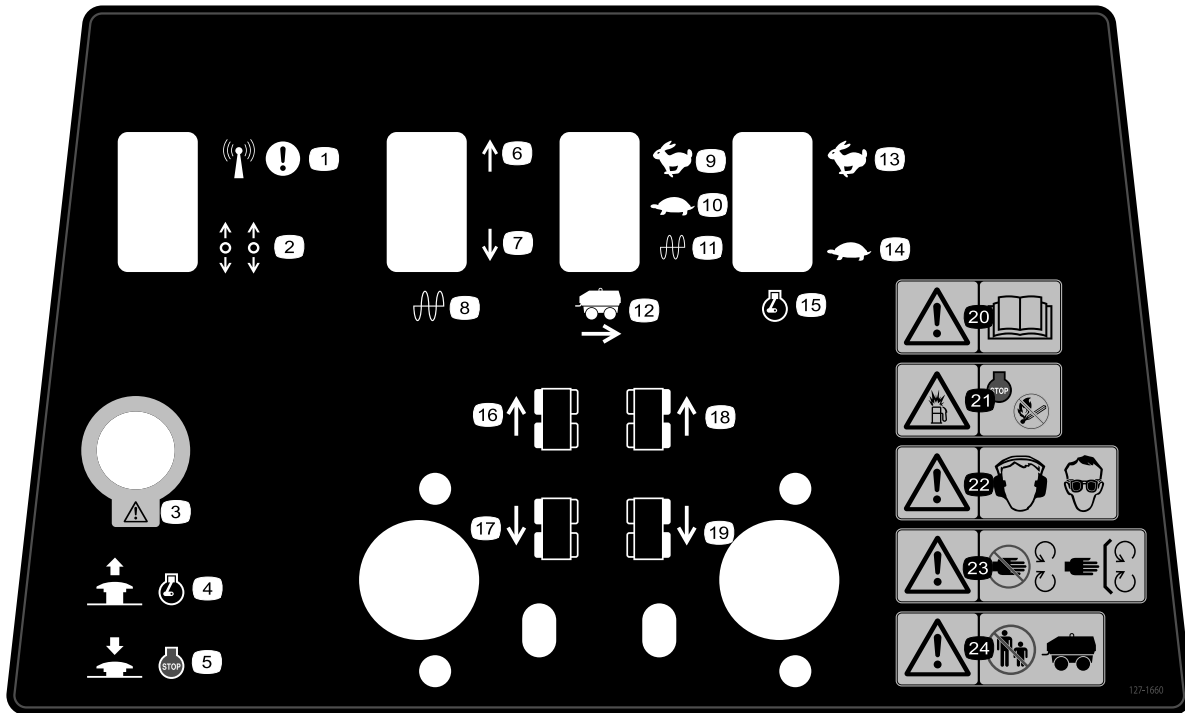

127-1660

- | | | |
|----------------------------------|----------------------------|--|
| 1. Remote-control mode | 9. Fast—travel speed | 17. Left-reverse traction |
| 2. Manual mode | 10. Slow—travel speed | 18. Right-forward traction |
| 3. Warning—emergency stop | 11. Vibration On | 19. Right-reverse traction |
| 4. Pull up to run the engine | 12. Travel-speed/vibration | 20. Warning—read the <i>Operator's Manual</i> . |
| 5. Press down to stop the engine | 13. Fast—engine speed | 21. Explosion hazard, fuel—stop the engine and extinguish all flames before refueling. |
| 6. Forward vibration | 14. Slow—engine speed | 22. Warning—wear hearing protection; wear eye protection. |
| 7. Reverse vibration | 15. Engine speed control | 23. Warning—keep away from moving parts; keep guards and shields in place. |
| 8. Vibration direction toggle | 16. Left-forward traction | 24. Warning—keep bystanders away when operating the machine. |



127-1656

1. Read the *Operator's Manual* for information on the radio-control mode—1) Position the switch to the radio-control mode; 2) Rotate the key to the engine-stop position; 3) Press the link/start button once—wait for the active-link light to illuminate; 4) Press the link/start button to start the engine.
2. Read the *Operator's Manual* for information on the manual mode—1) Position the switch to the manual mode; 2) Position the traction switch to slow; 3) If the engine is warm, position the engine-speed switch to slow; if the engine is cold, position the engine-speed switch to fast; 4) Turn the key to the engine-start position for 10 seconds or less to start the engine, then release the key to the engine-run position.
3. LED display
4. Engine—stop
5. Engine—run
6. Engine—start



125-4964

1. Read the *Operator's Manual* for oil information.



117-2718



125-4963

1. Warning—keep hands away from hot surfaces

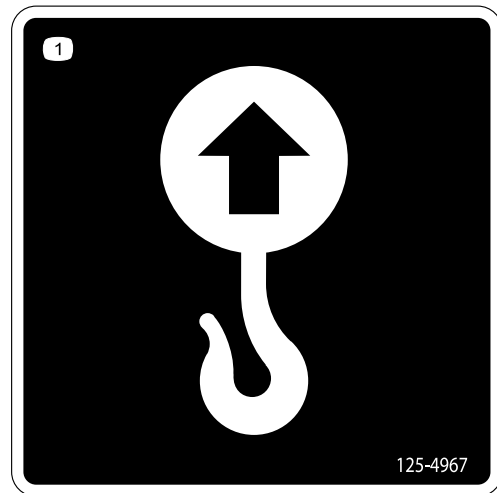

125-4967

1. Lift point



125-8478

1. Diesel fuel

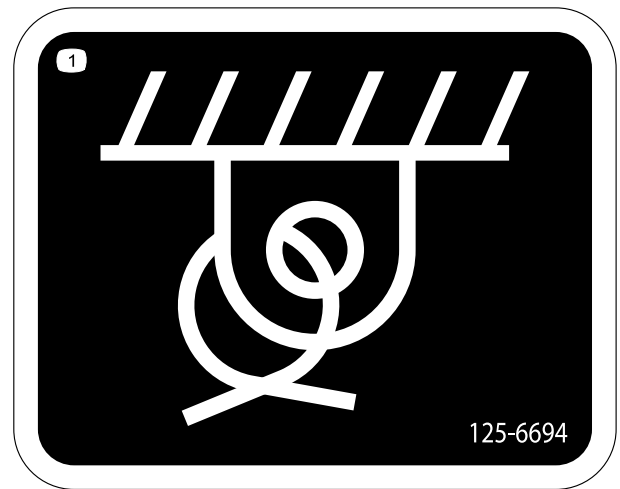

125-6694

1. Tie down location

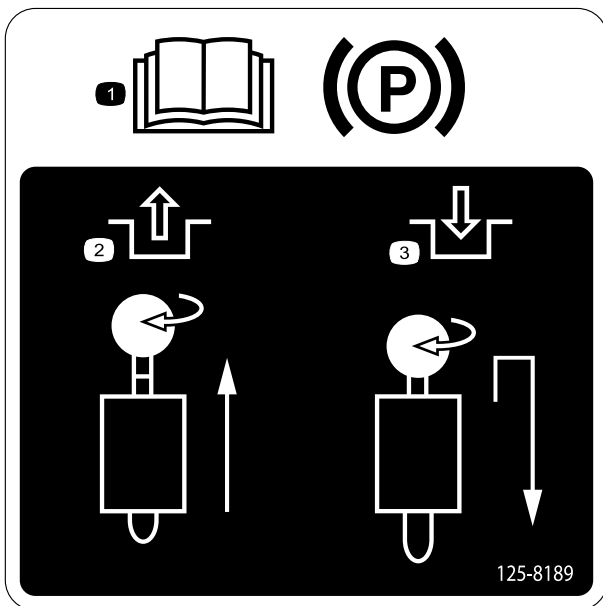

125-8189

1. Read the *Operator's Manual* for information on operating the parking brake.
2. To release the parking brake, pull the knob up fully, rotate it 90° clockwise, and then gently release the knob.
3. To set the parking brake, pull the knob up slightly, rotate it 90° clockwise, and then gently release the knob.

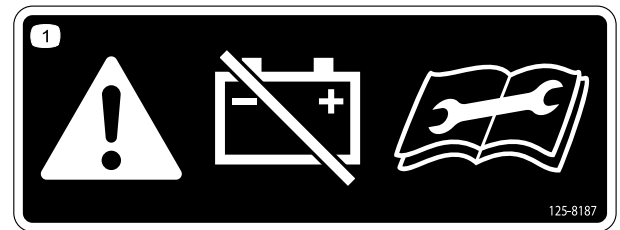

125-8187

1. Warning—disconnect the battery and consult the *Operator's Manual* before performing service or maintenance on the machine.

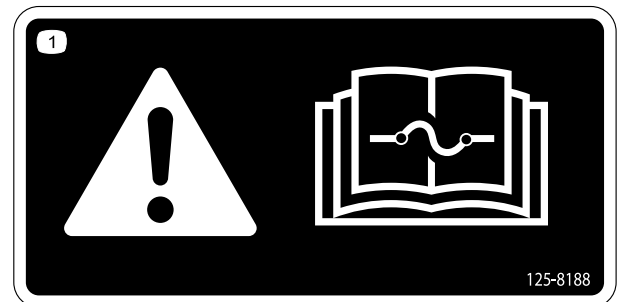

125-8188

1. Warning—read the *Operator's Manual* for information on fuses.

Product Overview

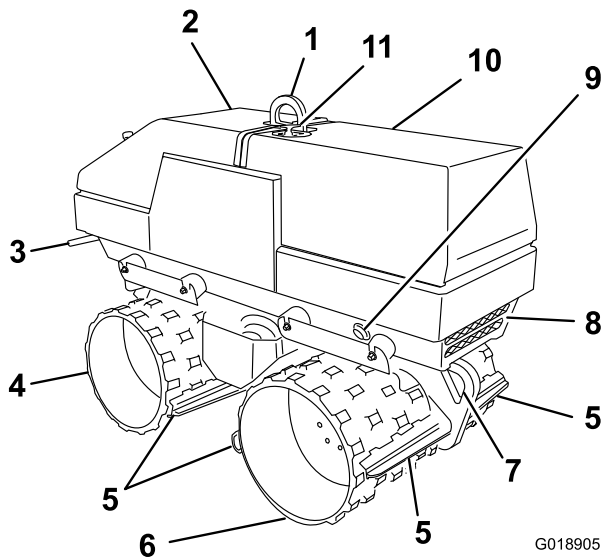

Figure 6

G018905

- | | |
|---------------------|---------------------------|
| 1. Lifting ring | 7. Forward, tie-down ring |
| 2. Rear hood | 8. Air inlet |
| 3. Safety bar | 9. Oil-cooler duct |
| 4. Right-rear drum | 10. Front hood |
| 5. Scraper bar | 11. Hood-latch handle |
| 6. Right-front drum | |

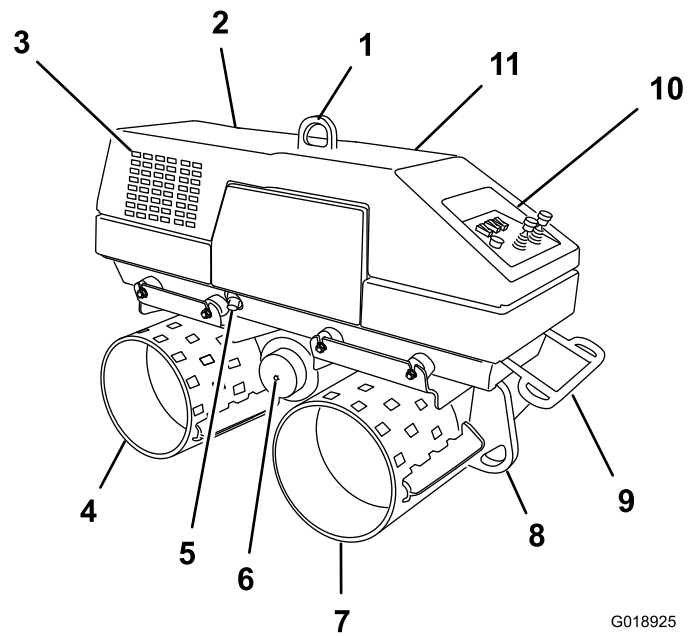

Figure 8

G018925

- | | |
|------------------------|------------------------|
| 1. Lifting ring | 7. Left-rear drum |
| 2. Front hood | 8. Rear, tie-down ring |
| 3. Engine grill | 9. Safety bar |
| 4. Left-front drum | 10. Control panel |
| 5. Engine-exhaust pipe | 11. Rear hood |
| 6. Eccentric oil plug | |

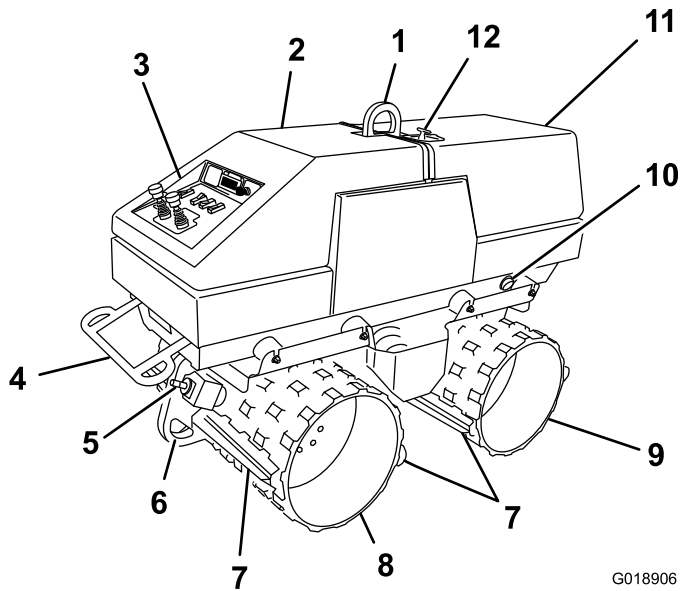

Figure 7

G018906

- | | |
|------------------------|-----------------------|
| 1. Lifting ring | 7. Drum scraper |
| 2. Rear hood | 8. Right-rear drum |
| 3. Control panel | 9. Right-front drum |
| 4. Safety bar | 10. Oil-cooler duct |
| 5. Parking brake | 11. Front hood |
| 6. Rear, tie-down ring | 12. Hood-latch handle |

Controls

Become familiar with all the controls (Figure 9 and Figure 17) before you start the engine and operate the machine.

Control Panel

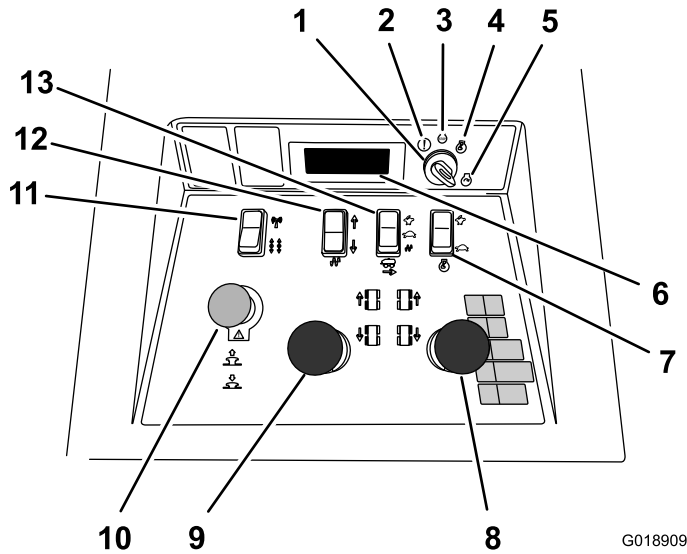

Figure 9

G018909

- | | |
|--------------------------------------|--|
| 1. Key and key switch | 8. Right, traction-control (forward/reverse) |
| 2. Information | 9. Left, traction-control (forward/reverse) |
| 3. Engine—stop | 10. Emergency-stop button |
| 4. Engine—run | 11. Mode switch (remote-control mode manual mode) |
| 5. Engine—start | 12. Vibration-direction switch (forward reverse) |
| 6. LED display | 13. Travel-speed/vibration switch (fast slow vibration On) |
| 7. Engine-speed switch (fast slow) | |

LED Display

Location and operation: The LED display is located on the control panel. The display is embedded into the electronic ignition control block, and is controlled through the microprocessor. The display provides the operator or mechanic operating information about the systems on the machine. The following section describes the information shown in the display.

Display while starting-up—voltage: During engine start-up, the display shows the battery voltage level. Rotate the key switch to the Start position to display the battery voltage.

Display while running the machine—rpm: When the engine is running, the display shows the engine rpm. After starting the machine, the key switch will rotate back to engine-run position and the engine rpm is indicated in the display.

Display when the key switch is in the information position—hour meter—faults/warnings—software version: To view operation information for the machine, rotate the key switch to the information position (counterclockwise from the Off position).

- Hour meter
- Fault messages
- Fault history
- Warnings
- Software version

Note: Operation information is stored in nonvolatile memory. In the event that battery power is lost, this information remains intact. Upon restoring battery power, the stored operation information is available for display.

Hour Meter

The hour meter display indicates the total number of hours the machine has run.

Rotate the key switch to the Accessory position to display the hour meter information.

Fault Messages

The fault messages define the situations that cause the engine of the machine to shut down or not start. These safeguards include engine protect circuits or other machine protection devices. Fault messages will be shown on the display and will indicate what event has shut down the engine.

Rotate the key switch to the information position to view the fault messages should they occur.

- **LOW OIL**—this message displays when the proper oil pressure is not achieved or maintained (monitored by the oil pressure switch).
- **CYL HEAD TEMP**—this message displays when the temperature of the cylinder head exceeds the safe operating temperature (monitored by the temperature switch in the cylinder head).
- **TILT**—this message displays when the machine tip angle is exceeded (monitored by the tip switch).
- **ESTOP**—this message displays when the emergency stop button on the control panel is depressed, and has not been reset (monitored by the emergency stop button position).

Note: The LED display always indicates the last fault message that occurred. The nonvolatile memory in the microprocessor always requires an input, therefore the last message will be displayed even after the fault has been corrected.

Fault History

The microprocessor records the last 20 fault messages to the nonvolatile memory; access the fault history as follows:

1. Rotate the key switch to the Information position to display the hour meter, last fault, and software version level.
2. During the display of the last fault, quickly rotate the key switch to the Off position, and then rotate the key switch to the Information position.

Note: The display will show the last 20 faults, beginning with the most recent. To turn off the display at any time, turn the key switch to the Off position.

Warnings

Warning messages are defined as messages that indicate the electrical system is not operating correctly. Warning messages will flash in the display when the machine is running in the manual operator mode. The 3 warning messages are as follows:

Note: If the V Reg L or the Bat Low message is indicated in the display, stop the engine. If a V Reg L warning message is indicated, refer to your *Engine Operator's Manual*. If a Bat Low warning message is indicated, check the alternator output voltage and charge or replace the battery.

- **V REG**—the voltage regulator low message indicates that the electrical system is not charging correctly.
- **BAT LOW**—the battery low message indicates the voltage level of the battery is low. This message will display when the battery output is 10 volts or less.
- **RPM LOW**—the revolutions per minute low message indicates the engine speed is below the minimum speed (monitored by alternator output).

Software Version

The software version display indicates revision level of the software for the microprocessor.

To display the software version information, rotate the key switch to the Information position.

Key Switch

Use the key switch to start and run the engine, stop the engine, and power the accessory display. The key switch has 4 positions: Information, Off, Run, and Start.

- Start the engine by rotating the key switch to the engine-start position, and then releasing the key when engine starts; the key it will move automatically to the engine-run position (Figure 10).

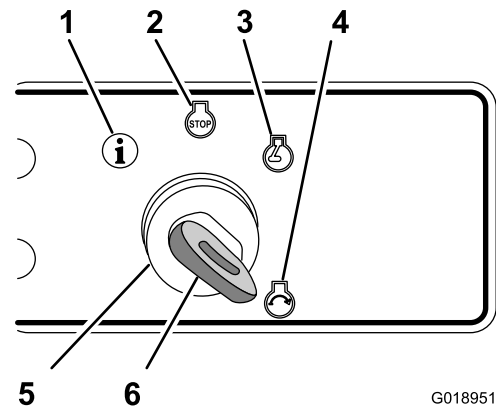

Figure 10

- | | |
|----------------|-----------------|
| 1. Information | 4. Engine—start |
| 2. Engine—Off | 5. Key switch |
| 3. Engine—run | 6. Key |

- Stop the engine by rotating the key switch to the engine-Off position (Figure 10).
- Display the hour meter, the last fault message, and the software version by rotating the key switch to the Information position (Figure 10).

Mode Switch

Use the mode switch to control the reception of commands from the remote-control transmitter. Selecting the switch to the radio-control mode or manual-mode position changes intended machine form of operation (Figure 11).

Important: Prolong the battery life of the machine by selecting the mode switch to the *manual mode* position when the machine is not in use.

Note: Select the mode switch to the radio-control mode position to operate the machine with the **remote-control transmitter**.

Select the mode switch to the manual-mode position to operate the machine with the **control panel**.

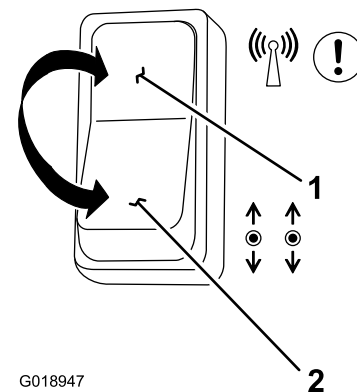

Figure 11

- | | |
|-----------------------|----------------|
| 1. Radio-control mode | 2. Manual mode |
|-----------------------|----------------|

Vibration Direction Switch

Use the vibration direction switch to select the direction eccentric rotation when the vibration function active (Figure 12).

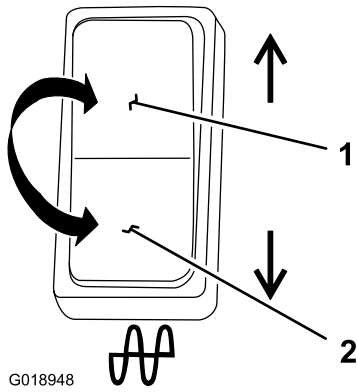

Figure 12

1. Vibrate forward
2. Vibrate reverse

- Vibration movement in a forward direction.
- Vibration movement in the reverse direction.

Travel-speed/Vibration Switch

Important: Select the slow, travel-speed setting when moving the machine in and out of the trench, when loading the machine onto a transport vehicle, and when unloading the machine from a transport vehicle.

Use the travel-speed switch to control travel speed of the machine (vibration Off) or activate the machine-vibration function (Figure 13).

Note: The vibration function is inoperative when moving the machine in the fast-travel speed or the slow-travel speed settings.

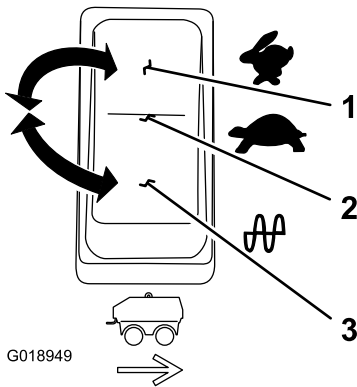

Figure 13

1. Fast-travel (vibration-off)
2. Slow-travel (vibration-off)
3. Vibration On (slow travel)

Engine-speed Switch

Use the engine-speed switch to change the engine RPM between the slow and fast, engine-speed settings (Figure 14).

Important: Perform machine operations such as moving the machine and vibration functions with the engine-speed switch in the fast, engine-speed position.

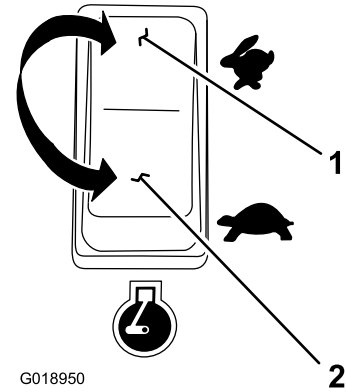



Figure 14

1. Fast, engine-speed
2. Slow, engine-speed

Emergency Stop Button

Use the emergency stop in any situation when the immediate stop of the machine is required. Pressing the emergency stop button will shut the machine off immediately.

The emergency stop button is located on the control panel and is labeled  G021430 below the red-colored button. Perform the following steps to stop the machine in an emergency situation, and reset the machine when the emergency-stop condition is corrected:

1. Press the emergency stop button down to immediately shut off the machine (Figure 15).

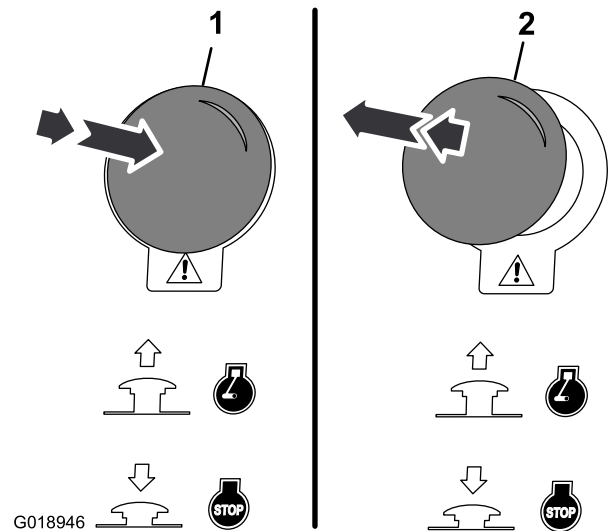

Figure 15

1. Emergency stop position
2. Reset for normal operation

2. Pull the emergency stop button up to resume normal machine operation (Figure 15).

Traction Controls

Move the left and right, traction-control levers to manually move the machine in the forward or reverse direction (straight, left or right) (Figure 16).

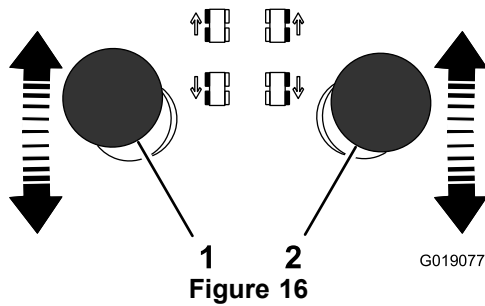

Radio Set

A radio set is a matched address code and radio frequency for a radio-control transmitter and the radio-control receiver. The address codes and radio frequency for the radio set are unique, and must match for the machine to function properly. This relationship assures that the transmitter can control only one receiver/machine, and that multiple compactors can be used on the job site without interference. Refer to the 7 digit serial numbers that you recorded on page titled Introduction (Figure 2).

Remote-control Transmitter

Important: Keep the remote-control transmitter dry. Do not pressure wash the remote-control transmitter.

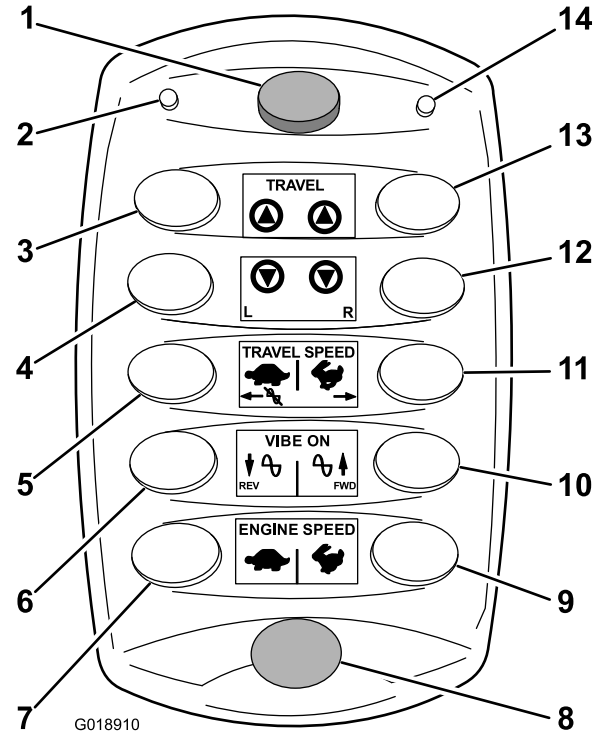

Figure 17

- | | |
|---|--|
| 1. Link / start button (green) | 8. Emergency-stop/power-Off button |
| 2. Low battery light (remote-control transmitter) | 9. Fast, engine-speed button (not functional) |
| 3. Left, forward-traction button (up arrow) | 10. Forward vibration button (vibration On) |
| 4. Left, reverse-traction button (down arrow) | 11. Fast, travel-speed button (vibration Off) |
| 5. Slow, travel-speed button (vibration Off) | 12. Right, reverse-traction button (down arrow) |
| 6. Reverse vibration button (vibration On) | 13. Right, forward-traction button (up arrow) |
| 7. Slow, engine-speed button | 14. Active link light (flashes) (not functional) |

Link/Start Button

Press the link/start button (green button) to establish a radio link between the remote-control transmitter and the radio receiver in the machine and to start the engine in the machine (Figure 17).

Note: The link/start button is the top button (centered left and right) on the remote-control transmitter.

Functions:

1. Establish a link to the radio receiver of the machine.
2. Start the engine of the machine.

Traction-control Buttons

Press and hold the traction-control buttons to move the machine in the forward or reverse direction (straight, left or right) (Figure 17).

Important: To stop the movement of the machine, release the traction-control buttons.

- Move the machine forward.
- Move the machine backward.
- Turn the machine left.
- Turn the machine right.

Travel Speed Buttons

Important: Use the slow-travel speed setting when moving the machine in and out of trenches, when loading the machine onto a trailer, and when unloading the machine from a trailer.

Use the travel speed buttons on the remote-control transmitter to control the travel speed of the machine (vibration Off) or activate the vibration function of the machine (Figure 17).

Note: The vibration function is inoperative when moving the machine in the fast travel-speed setting or slow travel-speed setting.

- Move the machine at minimum-travel speed.
- Move the machine at maximum-travel speed.
- Stop the vibration function (press and release either the slow or fast, travel-speed button).

Vibration On Buttons

Use the vibrate On buttons to select the direction eccentric rotation when the vibration function active (Figure 17).

Note: To stop the vibration function with the remote-control transmitter, press the slow, travel-speed button; refer to Travel Speed Buttons (page 18).

- Vibrate in a forward direction.
- Vibrate in a reverse direction.

Engine Speed Buttons

The engine-speed buttons on the remote-control transmitter do not function. The engine speed is automatically controlled by the microprocessor in the machine when operating in the remote-control mode.

When the machine is started with the remote-control transmitter, the engine will start at the slow-engine speed, after 1 second the engine will automatically accelerate to the fast-engine speed and sustain that speed.

Emergency-stop/Power-Off Button

Press the emergency-stop/power-Off button (red button) turn off the machine in an emergency situation or during normal operation (Figure 17).

Note: The emergency-stop/power-Off button is the bottom button (centered left and right) on the remote-control transmitter.

- Turn off the machine off immediately in an emergency situation.
- Turn off the machine during normal operation.

Parking Brake

The parking brake mechanism is a spring loaded plunger that rests against the surface of the drum when the brake is engaged. Use the brake knob to engage and disengage the parking brake of the machine; refer to Using the Parking Brake (page 28).

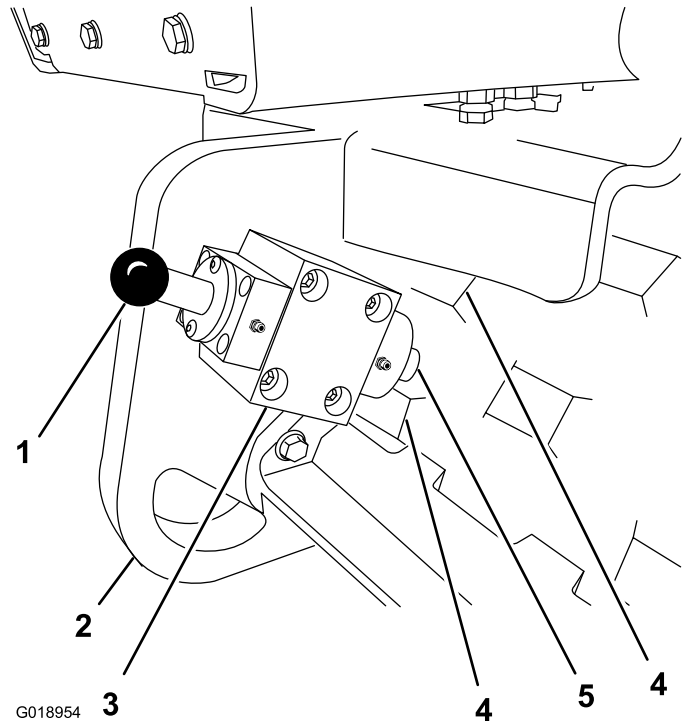

Figure 18

- | | |
|------------------------|-------------|
| 1. Brake knob | 4. Drum pad |
| 2. Rear, tie-down ring | 5. Plunger |
| 3. Parking brake | |

Anti-crush Bar

The anti-crush bar is a safety device that is located at the rear of the machine, and below the control panel. When triggered, the anti-crush bar prevents the machine from reverse travel in the event that the operator becomes entrapped behind the machine.

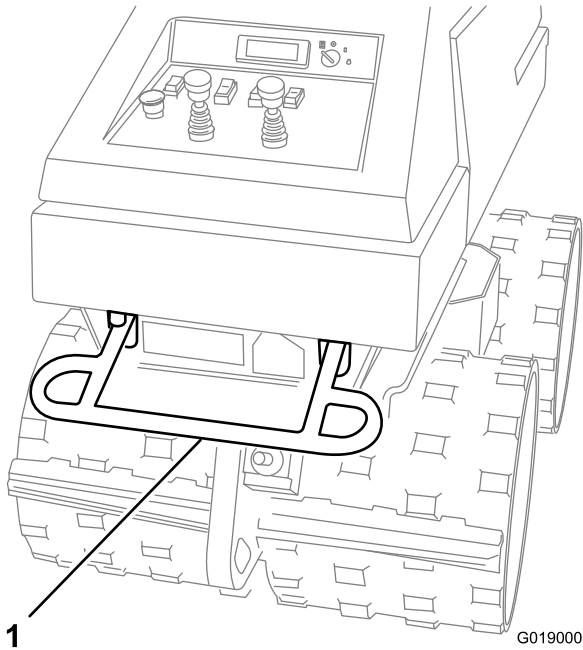

Figure 19

1. Anti-crush bar

Fuel Gauge

The fuel gauge is part of the fuel-tank cap, and indicates the level of fuel in the fuel tank.

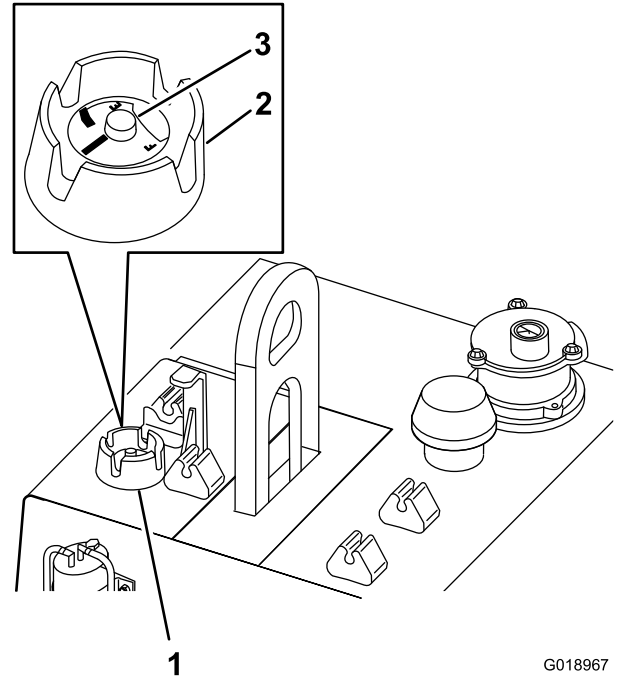

Figure 20

1. Fuel-tank cap and fuel gauge
2. Fuel-tank cap
3. Fuel gauge

G018967

Hydraulic-filter Gauge

The hydraulic-filter gauge indicates the pressure of hydraulic fluid flowing through the hydraulic filter.

The pressure ranges for the hydraulic-filter gauge are as follows:

- Normal (green): 0 to 137 kPa (0 to 20 PSI)
- Caution (yellow): 137 to 172 kPa (20 to 25 PSI)
- Service the filter (red): 172 to 689 kPa (25 to 100 PSI)

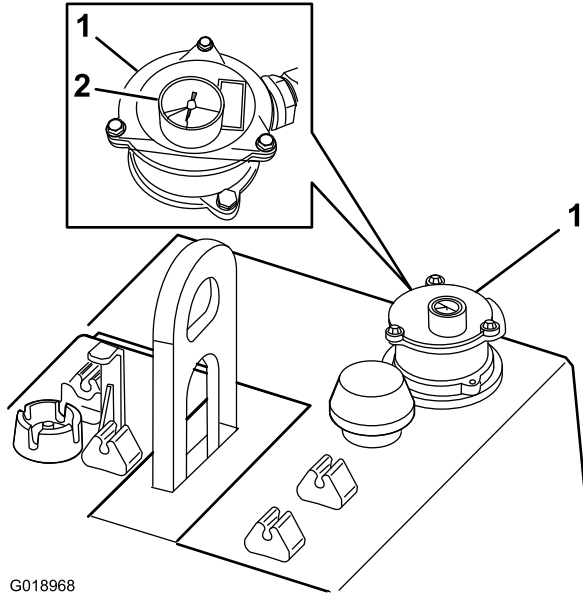

G018968

Figure 21

1. Hydraulic-filter housing 2. Hydraulic-filter gauge

Hydraulic-tank Gauge

Use the hydraulic-tank gauge to observe the level of hydraulic fluid in the tank. The tank gauge is located on the left-rear side of the hydraulic tank.

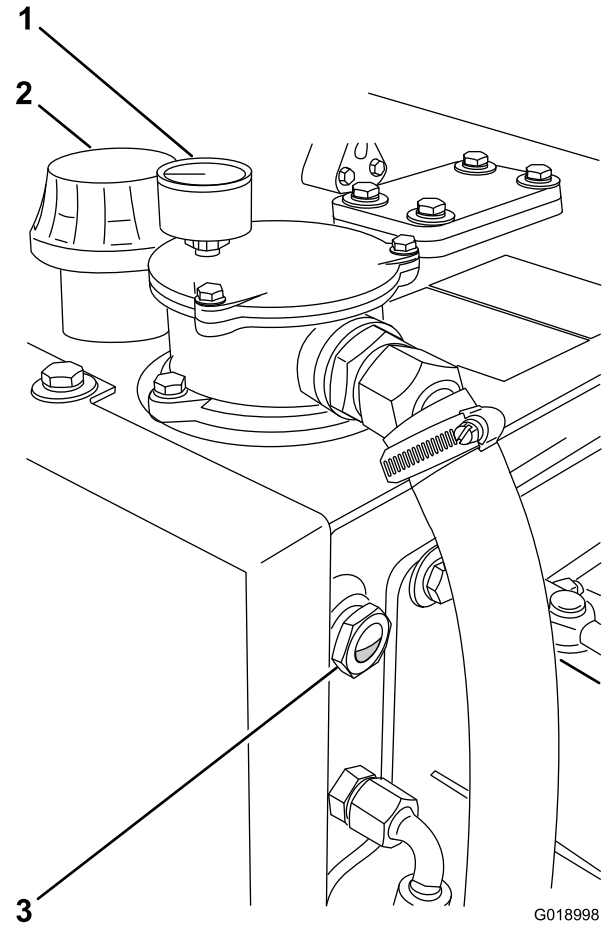

G018998

Figure 22

1. Hydraulic-filter gauge 3. Hydraulic-tank gauge
2. Cap/breather

Specifications

Note: Specifications and design are subject to change without notice.

| Model 68039 | |
|-------------------------|----------------------|
| Width | 86 cm (34 inch) |
| Length | 167.7 cm (66 inch) |
| Height | 119 cm (46.4 inch) |
| Weight | 1406 Kg (3100 lb) |
| Engine oil capacity | 0.95 L (2 fl qt) |
| Fuel capacity | 11.3 L (3 US gallon) |
| Hydraulic tank capacity | 49 L (13 US gallon) |

Vibration Specifications

| Description | Value |
|----------------------------------|------------------------|
| Vibration Frequency | 33.3 Hz (2000 vpm) |
| Centrifugal Force | 69.87 kN (15709 lb) |
| Total Applied Force | 82.7 kN (18609 lb) |
| Static Linear Pressure | 85 N/cm (48 psi) |
| Dynamic Linear Pressure | 432 N/cm (247 psi) |
| Total Applied Linear Pressure | 516 N/cm (295 psi) |
| Static Applied Padfoot Pressure | 516 N/cm (73.06 psi) |
| Dynamic Applied Padfoot Pressure | 127 N/cm (370 psi) |
| Total Applied Padfoot Pressure | 647.5 N/cm (443.3 psi) |

Operation

⚠ WARNING

- Never move the machine across a slope greater than 18% grade (10°).
- Never park the machine on a hill.

⚠ CAUTION

- Before starting the machine, make sure that there are no persons near the machine or obstacles under the machine.
- Exposure to loud noise can cause hearing impairment or loss. Wear ear protection when operating the machine.
- The machine can injure your feet. Keep feet clear of drums and wear foot protection, steel toe shoes, or toe pads when operating the machine.

Important: Users must be trained to operate the machine. Read the *Operator's Manual* and *Engine Owner's Manual*. Learn to operate the machine safely.

Important: Before operating the machine, check the fuel and oil level, and remove debris from the machine. Ensure that the area is clear of people and debris. You should also know and have marked the locations of all utility lines.

Note: Determine the left and right sides of the machine from the normal operating position.

Pre-start Checklist

1. Check the engine oil level.
2. Check the engine air filter element.
3. Check the engine fuel level.
Note: Always use clean, fresh fuel to prevent damage to the fuel injection components.
4. Check the hydraulic fluid level.
5. Check the hardware for looseness.
6. Check the hoses for loose fittings and signs of a leak.
7. Check that the Emergency Stop button is not damaged, and that the bottom moves up and down.
8. Check that the Anti-crush bar, switch, and actuation components are not damaged, and that all parts move and work properly.

Fuel

Use only clean, fresh diesel fuel with an ultra low (<15 ppm) sulfur content. The minimum cetane rating for the diesel fuel should be 40. Purchase fuel in quantities that can be used within 30 days to ensure fuel freshness.

Fuel tank capacity: 11.5 L (3 US gallon)

Important: Do not use kerosene or gasoline instead of diesel fuel. Failure to observe this caution will damage the engine.

- Outside air temperatures **above** 20° F (-7° C), use summer grade diesel fuel (No. 2-D)
Note: Use of summer grade fuel above 20° F (-7° C) will contribute toward longer fuel pump life and increased power.
- Outside air temperatures **below** 20° F (-7° C), use winter grade (No. 1-D or No. 1-D/2-D blend)
Note: Use of winter grade fuel at lower temperatures provides easier starting and reduce fuel filter plugging.

⚠ WARNING

Fuel is harmful or fatal if swallowed. Long-term exposure to vapors can cause serious injury and illness.

- Avoid prolonged breathing of vapors.
- Keep your face away from nozzle and fuel tank or fuel container opening.
- Keep fuel away from your eyes and skin.

Filling the Fuel Tank

⚠ DANGER

Under certain conditions, diesel fuel and fuel vapors are highly flammable and explosive. A fire or explosion from fuel can burn you and others and can cause property damage.

- Use a funnel and fill the fuel tank outdoors, in an open area, when the engine is off and is cold. Wipe up any fuel that spills.
- Do not fill the fuel tank completely full. Add fuel to the fuel tank until the level is 1/4 to 1/2 in. (6 to 13 mm) below the bottom of the filler neck. This empty space in the tank allows the fuel to expand.
- Never smoke when handling fuel, and stay away from an open flame or where fuel fumes may be ignited by a spark.
- Never fill the fuel tank inside an enclosed trailer.
- Do not operate without entire exhaust system in place and in proper working condition.

⚠ DANGER

In certain conditions during fueling, static electricity can be released causing a spark which can ignite the fuel vapors. A fire or explosion from fuel can burn you and others and can damage property.

- Always place fuel containers on the ground away from your vehicle before filling.
- Do not fill fuel containers inside a vehicle or on a truck or trailer bed because interior carpets or plastic truck bed liners may insulate the container and slow the loss of any static charge.
- When practical, remove equipment from the truck or trailer and refuel the equipment with its wheels on the ground.
- If this is not possible, then fuel such equipment on a truck or trailer from a portable container, rather than from a fuel dispenser nozzle.
- If a fuel dispenser nozzle must be used, keep the nozzle in contact with the rim of the fuel tank or container opening at all times until fueling is complete.

Important: Store fuel in a clean, safety-approved container and keep the cap in place.

1. Remove the cap for the fuel tank by turning the cap counterclockwise and the lifting the cap up until the quantity sensor is clear of the filler neck of the fuel tank. (Figure 23).

Note: Do not allow the dirt and debris to enter the fuel tank or to accumulate on the quantity sensor.

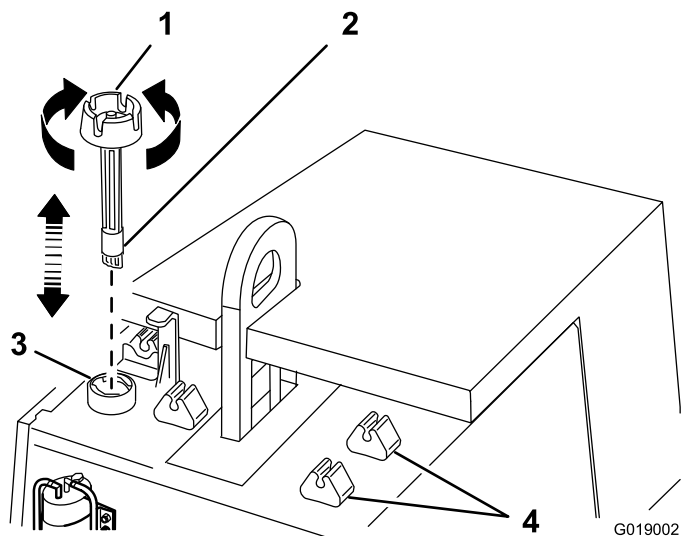

Figure 23

- | | |
|--------------------|----------------------------|
| 1. Fuel cap | 3. Filler neck (fuel tank) |
| 2. Quantity sensor | 4. Hood clip |

2. Fill the tank with fuel until the level is 6 to 13 mm (1/4 to 1/2 inch) below the bottom of the filler neck.
3. Install the fuel tank cap by inserting the quantity sensor of the fuel cap through the filler neck.
4. Tighten the fuel cap clockwise hand tight (Figure 23).

Priming the Fuel System

Bleed the fuel system before starting the engine if any of the following conditions occur:

- Initial start up of a new machine.
- Engine has ceased running due to lack of fuel.
- Maintenance has been performed upon fuel system components (e.g., filter replaced).

Note: When performed, the engine should start after priming the fuel system. However, if engine does not start, air may be trapped between injection pump and injectors; contact your Authorized Service Dealer.

1. Remove the key, and allow the engine to cool.

2. Open the forward hood; refer to Opening the Hood (page 24).
3. Ensure that the fuel level in the tank is greater than one-third full.
4. Remove the fuel cap and sensor assembly (Figure 24).

Note: Do not allow the dirt and debris to enter the fuel tank or accumulate on the quantity sensor.

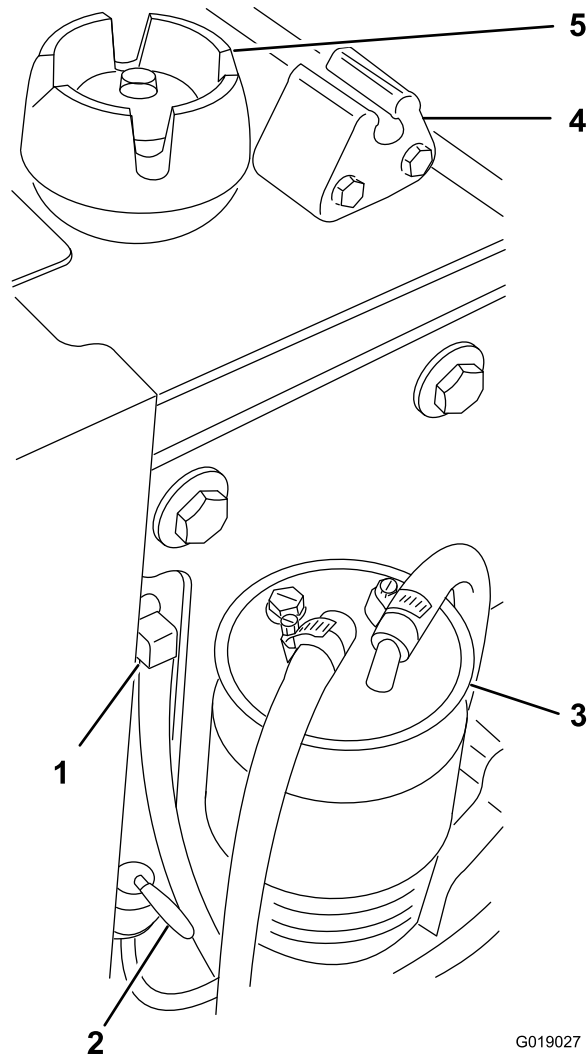

Figure 24

- | | |
|-------------------------|--------------------|
| 1. Fuel return line | 4. Hood clip |
| 2. Fuel-shutoff valve | 5. Fuel cap/sensor |
| 3. Fuel/water separator | |

5. At the fuel pump, operate the priming lever until fuel is heard flowing back into the fuel tank through the fuel return line. (Figure 25).

Accessing the Machine

Opening the Hood

Open the forward hood as follows:

1. At the forward hood, pivot the latch handle for the hood to the vertical position (Figure 26).

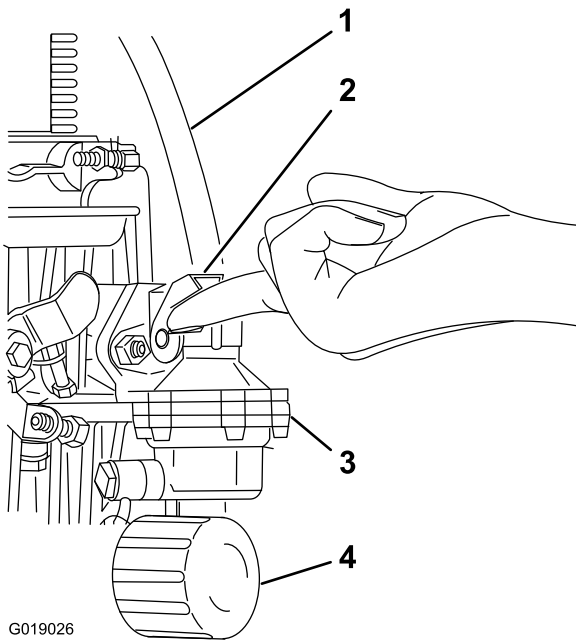

Figure 25

- | | |
|-----------------------|---------------|
| 1. Fuel line | 3. Fuel pump |
| 2. Fuel priming lever | 4. Oil filter |

6. Install the fuel cap and sensor assembly (Figure 24).
7. Close the forward hood; refer to Closing the Hood (page 25).

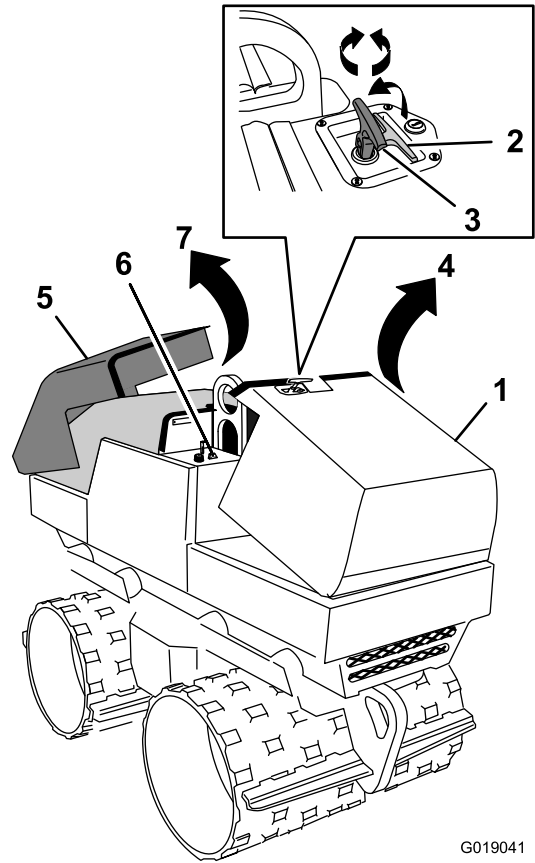

Figure 26

- | | |
|----------------------------|----------------------|
| 1. Forward hood | 5. Rear hood |
| 2. Latch handle (stowed) | 6. Hood clip |
| 3. Latch handle (vertical) | 7. Rear hood opening |
| 4. Forward hood opening | |

2. Rotate the latch handle clockwise (Figure 26).
3. Grasp the latch handle tightly, and pull up firmly to unseat the hood from the hood clips (Figure 26).
4. Rotate the hood up (Figure 26).

Open the rear hood as follows:

Note: Ensure that the forward hood is open before opening the rear hood.

1. Grasp the forward edge of the rear hood.
2. Pull up firmly on the hood to unseat it from the hood clips (Figure 26).
3. Rotate the hood up (Figure 26).

Closing the Hood

Note: If the rear hood and the forward hood are open, the rear hood must be closed before closing the forward hood.

Close the rear hood as follows:

1. Grasp the forward edge of the rear hood.
2. Rotate the hood down (Figure 26).
3. Push down firmly on the hood to seat it into the hood clips.

Close the forward hood as follows:

Note: Ensure that the rear hood is closed before closing the forward hood.

1. Grasp the latch handle, and rotate the hood down (Figure 26).
2. Push down firmly on the hood to seat it into the hood clips.
3. Rotate the latch handle counterclockwise (Figure 26).
4. Pivot the handle down to the stowed position (Figure 26).

Engine Oil and Hydraulic Fluid

Checking the Level of the Engine Oil

Service Interval: Before each use or daily

Oil Type: Detergent diesel engine oil (all trademark oils which fulfil at least one of the following specifications: ACEA-B2/E2 or higher, or API service CH-4 or higher)

Crankcase Capacity: 1.9 L (2 qt)

Viscosity: Refer to Figure 27.

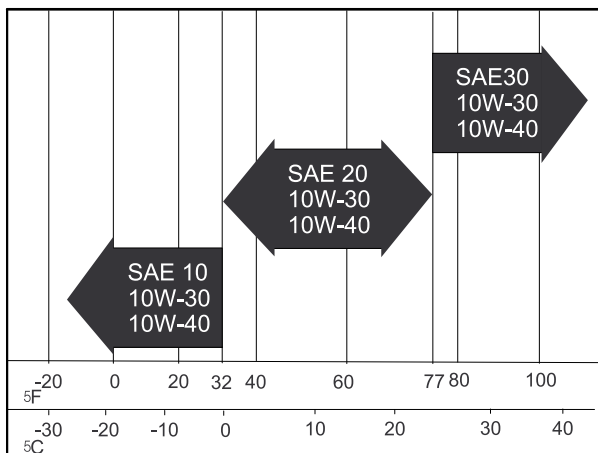

G001061

Figure 27

3. Open the forward hood; refer to Opening the Hood (page 24).
4. Clean around the oil dipstick and dipstick fitting (Figure 28).

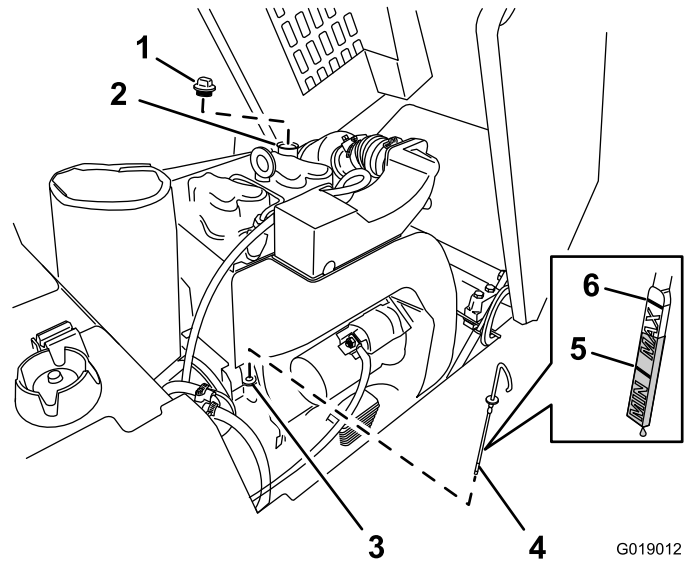

Figure 28

G019012

- | | |
|---------------------|------------------|
| 1. Oil-filler cap | 4. Dipstick |
| 2. Oil-filler neck | 5. Min oil-level |
| 3. Dipstick fitting | 6. Max oil-level |

5. Pull out the dipstick and wipe the metal end clean.
6. Slide the dipstick into the dipstick fitting.
7. Pull the dipstick out and look at the metal end.
8. If the oil level is below the Min-level mark on the dipstick (Figure 28), perform the following steps:
 - A. Clean around the oil-filler cap, and remove the cap (Figure 28).
 - B. Slowly pour enough oil into the oil-fill tube to raise the level on the dipstick to between the Min- and Max-oil level (Figure 28).
 - C. Install the oil-filler cap (Figure 28).
- 9.
- Important: Do not overfill the crankcase with oil because the engine may be damaged.**
10. Insert the dipstick into the dipstick fitting, and seat the dipstick firmly.
11. Close the hood; refer to Closing the Hood (page 25).

1. Park the machine on a level surface.
2. Stop the engine, remove the key, and allow the engine to cool.

Checking the Hydraulic Fluid Level

Service Interval: Before each use or daily

Hydraulic Tank Capacity: 49 L (13 US gallons)

- **Toro Premium Transmission/Hydraulic Tractor Fluid** (refer to your Authorized Toro Dealer for more information)
- **Toro Premium All Season Hydraulic Fluid** (refer to your Authorized Toro Dealer for more information)
- If either of the above Toro fluids are not available, you may use **Mobilfluid 424** multipurpose tractor lubricant.

Important: Always use the correct hydraulic fluid. Unspecified fluids will damage the hydraulic system.

Note: The hydraulic fluid specifications must fall within the listed range for all of the following material properties and the fluid should meet the listed industry standards. Toro will not assume responsibility for damage caused by improper substitutions, so use only products from reputable manufacturers who will stand behind their recommendations.

Hydraulic Fluid Table—

| Material Properties | |
|--|------------------------------------|
| Viscosity, ASTM D445 | cSt at 40° C (104° F): 55 to 62 |
| | cSt at 110° C (230° F): 9.1 to 9.8 |
| Viscosity index, ASTM D2270 | 140 to 152 |
| Pour Point, ASTM D97 | -37 to -43° C (-35 to -46° F) |
| Industry Standards | |
| API GL-4, AGCO Powerfluid 821 XL, Ford New Holland FNHA-2-C-201.00, Kubota UDT, John Deere J20C, Vickers 35VQ25 and Volvo WB-101/BM. | |

Note: Many hydraulic fluids are almost colorless, making it difficult to spot leaks. A red dye additive for the hydraulic system oil is available in 2/3 oz. (20 ml) bottles. One bottle is sufficient for 4-6 gal (15-22 l) of hydraulic oil. Order part no. 44-2500 from your Authorized Toro Dealer.

1. Park the machine on a level surface.
2. Stop the engine, remove the key, and allow the engine to cool.
3. Open the rear hood; refer to Opening the Hood (page 24).
4. Clean the area around the cap/breather and filler neck of the hydraulic tank. Clean the hydraulic tank sight gauge (Figure 29).

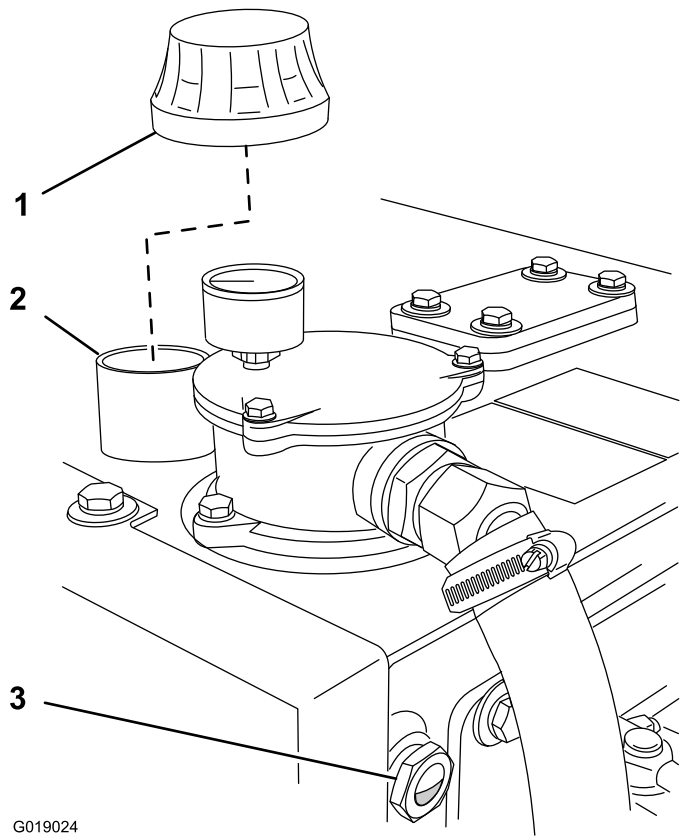

G019024

Figure 29

1. Breather/cap
2. Hydraulic tank filler neck
3. Sight gauge

5. Check that the fluid level displayed in the sight gauge indicates a 6.35 to 12.5 mm (0.25 to 0.50 inch) air bubble seen at the top of the gauge (Figure 29).
6. If the hydraulic fluid level is low, perform the following steps:

⚠ DANGER

The breather/cap is designed to pressurize the hydraulic tank to 34.5 kPa (5 PSI). Loosen the cap slowly to avoid injury whenever adding fluid or maintaining the hydraulic system.

- A. Place a rag over the hydraulic tank breather/cap, and slowly turn the cap counterclockwise to remove the breather/cap.
 - B. Add fresh hydraulic fluid to the tank through the hydraulic tank filler neck.
- Note:** Add hydraulic fluid until the fluid level indicates a 6.35 to 12.5 mm (0.25 to 0.50 inch) air bubble seen at the top of the sight gauge.
- C. Install the breather/cap on the hydraulic tank filler neck.

7. Close the rear hood; refer to Closing the Hood (page 25).

Starting and Stopping the Engine

Start and stop the machine in either the manual mode (at the control panel) or in the remote-control mode (with the remote-control transmitter).

Starting the Engine—Manual Mode

Important: If the engine is run at high speeds when the hydraulic system is cold (i.e., when the ambient air temperature is near freezing or lower), hydraulic system damage could occur. When starting the engine in cold conditions, allow the hydraulic system to warm by operating the engine at slow-engine speed for 2 to 5 minutes before switching to the fast-engine speed.

1. Ensure that the handle of the fuel-shutoff valve is to the On position. (Figure 24).
2. At the control panel, press the mode switch to the manual-mode position; refer to Mode Switch (page 15).
3. Press the engine-speed switch to the slow, engine-speed position; refer to Engine-speed Switch (page 16).
4. Insert the key into the key switch, and rotate the key clockwise to the Start position.

Important: Do not engage the starter for more than 10 seconds at a time. If the engine fails to start, allow a 30-second cooldown period between attempts. Failure to follow these instructions can burn out the starter motor.

5. Release the key when engine starts.

Note: The key will move automatically to the engine-run position.

Starting the Engine—Remote-control Mode

Important: When the ambient air temperature is near freezing or lower, start the engine in the manual mode and allow the hydraulic system to warm before operating the machine in the remote-control mode; refer to Starting the Engine—Manual Mode (page 27).

1. At the control panel, press the mode switch to the remote-control mode position; refer to Mode Switch (page 15).
2. Ensure that the key switch is rotated to the Off position; refer to Key Switch (page 15).
3. At the radio-control transmitter, press the On button once to establish a radio link with the machine.
4. Press and hold the On button again to start the engine.

Note: The engine speed is automatically controlled by the microprocessor on the machine. The engine will start and operate at the slow-engine speed for one second, and then automatically accelerate the engine to the fast-engine speed.

Stopping the Engine—Manual Mode

These instructions describe how to stop the engine at the control panel under normal operating circumstances.

1. Ensure that the mode switch is selected to the manual-control position; refer to Mode Switch (page 15).
2. Press the travel-speed/vibration switch to the slow, travel-speed position (vibration Off); refer to Travel-speed/Vibration Switch (page 16).
3. Press the engine-speed switch to the slow position; refer to Engine-speed Switch (page 16).

Note: If the engine has been working hard or is hot, allow the machine to run at the slow-engine speed setting for a 1 or 2 minutes before turning the ignition key off. This helps cool the engine before it is stopped. In an emergency, stop the engine immediately.

4. Rotate the key switch counterclockwise to the Off position; refer to Key Switch (page 15).

Stopping the Engine—Remote-control Mode

These instructions describe how to stop the engine with the radio-control transmitter under normal operating circumstances.

1. On the radio-control transmitter, press the slow, travel-speed button (vibration Off); refer to Travel Speed Buttons (page 18).

Note: If the engine has been working hard or is hot, allow the machine to run for a 1 or 2 minutes before turning the ignition key off. This helps cool the engine before it is stopped. In an emergency, stop the engine immediately.

2. On the radio-control transmitter, press the emergency-stop/power-off button (the red button); refer to Emergency-stop/Power-Off Button (page 18).

Note: Store the radio-control transmitter in a safe, dry place (the transmitter storage compartment under the rear hood).

Emergency Stop—Manual Mode

Important: The emergency stop button on the control panel will stop the engine in both the manual mode and the remote-control mode.

This instruction describes how to stop the engine at the control panel in an emergency circumstance.

At the control panel, press the Emergency Stop button down; refer to Emergency Stop Button (page 16).

Note: Pull the emergency stop button up to resume normal machine operation.

Emergency Stop—Remote-control Mode

Important: The emergency stop button on the control panel will stop the engine in both the manual mode and the remote-control mode.

This instruction describe how to stop the engine with the radio-control transmitter in an emergency circumstance.

At the radio-control transmitter, press the **Emergency Stop/Power off button (the red button)**; refer to **Emergency-stop/Power-Off Button** (page 18).

Stopping the Machine

⚠ WARNING

Never park the machine on a hill.

⚠ CAUTION

A child or untrained bystander could attempt to operate the machine and be injured.

Remove the key from the switch when leaving the machine, even if just for a few seconds.

Important: Do not park the machine for an extended period in a trench, ditch, or low-lying area that might fill with water. Lift or move the machine to a level, well drained surface.

Stopping the Machine—Manual Mode

1. Release both of the traction controls refer to **Traction Controls** (page 17).
2. Stop the engine; refer to **Stopping the Engine—Manual Mode** (page 27).
3. Set the parking brake; refer to **Using the Parking Brake** (page 28).
4. Remove the key from the key switch; refer to **Key Switch** (page 15).

Stopping the Machine—Remote-control Mode

Important: To avoid depleting the battery of the machine, select the mode switch to the manual-mode position when stopping the machine.

1. Release all the traction-control buttons; refer to **Traction-control Buttons** (page 18).
2. Stop the engine; refer to **Stopping the Engine—Remote-control Mode** (page 27).

3. Select the mode switch on the control panel to the manual mode position; refer to **Mode Switch** (page 15).
4. Set the parking brake; refer to **Using the Parking Brake** (page 28).
5. Remove the key from the key switch; refer to **Key Switch** (page 15).

Using the Parking Brake

⚠ WARNING

Failure to set the parking brake when the machine is left unattended could cause damage to the machine or injury. Always set the parking brake before leaving the machine.

⚠ CAUTION

Failure to disengage the parking brake before moving the machine may cause damage to the parking brake or the machine or both. Release the parking brake before moving the machine.

Setting the Parking Brake

Important: Whenever possible, park the machine on a firm, level surface.

Important: The plunger for the parking brake must be on the against the side of the drum pad and the surface of the drum.

1. Set the machine to manual mode; refer to **Moving the Machine—Manual Mode** (page 32).
2. Set the engine-speed switch to the slow, engine-speed position, refer to **Engine-speed Switch** (page 16).
3. Set the travel speed to the slow-travel/vibration-off position; refer to **Travel-speed/Vibration Switch** (page 16).
4. Using the traction controls, center the parking brake between 2 drum pads; refer to **Traction Controls** (page 17).
5. Pull the brake knob of the parking brake out slightly and rotate the knob approximately 90° clockwise or until the plunger is released (Figure 30).

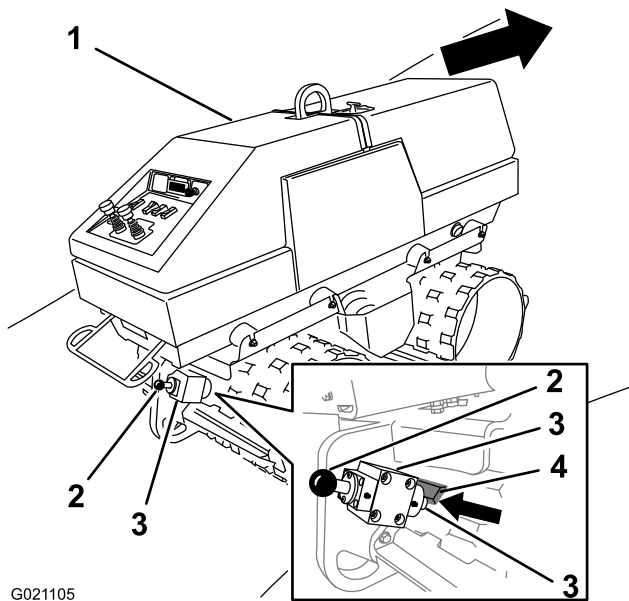

G021105

Figure 33

- | | |
|--------------------------|-------------------------------|
| 1. Parked machine—uphill | 4. Plunger |
| 2. Brake knob | 5. Drum pad (uphill position) |
| 3. Parking brake | |

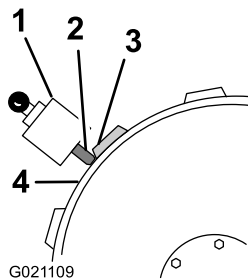

G021109

Figure 34

- | | |
|------------------|--|
| 1. Parking brake | 3. Drum pad rotating downward (parking the machine uphill) |
| 2. Plunger | 4. Drum surface |

8. Stop the engine and remove the key; refer to Stopping the Engine—Manual Mode (page 27).

Releasing the Parking Brake

Note: When the parking brake is released, the plunger is in the up-lock position, approximately 12.7 mm (1/2 inch) above the drum pads.

1. Pull the parking brake handle out fully and rotate the handle approximately 90° clockwise or until it snaps into the up-lock position (Figure 30).
2. Gently release the parking brake handle, allowing it to retract until the parking brake is resting in the retract detent (Figure 31 and Figure 33).

Moving a Non-functioning Machine

Important: Do not tow or pull a non-functioning machine. Retrieve and transport the machine using lifting equipment, refer to Lifting the Machine (page 30) and Preparing the Machine for Transport (page 31).

Important: Do not allow a non-functioning machine to remain located in a trench, ditch, or low-lying area that might fill with water. Lift the non-functioning machine and locate it on a level, well drained surface.

Lifting the Machine

Important: Ensure the lifting equipment has a 2110 Kg (4650 lb) vertical lift capacity.

Important: Never lift a machine with the engine running.

Lift the machine using the lift ring (Figure 35) as follows:

1. Stop the engine; refer to Stopping the Engine—Manual Mode (page 27) and Stopping the Engine—Remote-control Mode (page 27).
2. Ensure that the forward hood and rear hood are closed and latched.
3. Connect the lift rigging to the lift ring on the machine (Figure 35), and lift the machine.

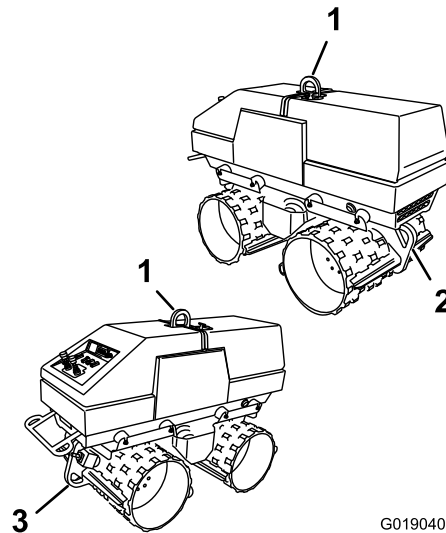

G019040

Figure 35

- | | |
|---------------------------|------------------------|
| 1. Lift Ring | 3. Rear, tie-down ring |
| 2. Forward, tie-down ring | |

Preparing the Machine for Transport

Important: Ensure that the transport vehicle is rated for a 1406 Kg (3100 lb) load and has tie-down points.

- **Lift the machine** onto a transport vehicle; refer to Lifting the Machine (page 30).
- **Drive the machine** on a transport vehicle.

⚠ DANGER

You can lose of control of the machine when driving it on ramps onto or off of the transport vehicle when left-hand and right-hand drums have unequal traction.

Ensure that the ramps and drums provide equal traction to the left-hand and right-hand sides of the machine.

Important: Use ramps that have a 2110 Kg (4650 lb) capacity and a solid, continuous-traction surface.

Important: The ramp used to support the machine while loading it onto the transport vehicle cannot exceed 55% (29°) angle limit of the machine; refer to Tilt Chart (page 9).

Note: Do not operate or drive the machine on the roadway.

1. Set the machine to the slow-travel speed (vibration Off); refer to Travel-speed/Vibration Switch (page 16) and Travel Speed Buttons (page 18).
2. Set the engine speed to the fast, engine-speed position; refer to Engine-speed Switch (page 16).
3. Drive the machine onto the transport vehicle.
4. Stop the engine; refer to Stopping the Engine—Manual Mode (page 27) and Stopping the Engine—Remote-control Mode (page 27).

5. Secure the machine to the transport vehicle using blocking and load binders between the anchor rings on the transport vehicle and the tie-down rings on the machine (Figure 36).

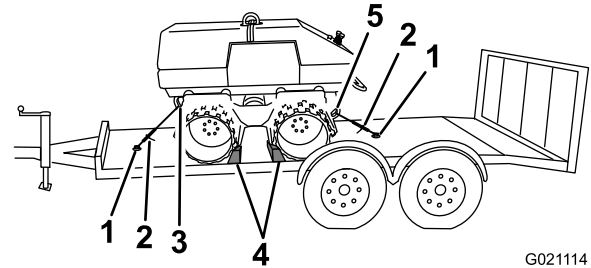

Figure 36

- | | |
|---------------------------|------------------------|
| 1. Anchor ring | 4. Blocking |
| 2. Load binder | 5. Rear, tie-down ring |
| 3. Forward, tie-down ring | |

-
6. Ensure that the ramps are secure before transporting the machine.

Moving and Vibrating Operation

⚠ CAUTION

Trenches without wall support can collapse and trap equipment and personnel. In trenches without wall supports, operate the machine in the remote-control mode.

Important: Use the slow, travel-speed setting for the following operations:

- When moving the machine up, down, or across slopes.
- When moving the machine in and out of trenches.
- When moving the machine around corners.
- When loading the machine on to the transport vehicle.
- When unloading the machine from the transport vehicle.

Moving the Machine Across a Slope

⚠ CAUTION

If the machine tips over, engine oil can flood the cylinders; starting the machine after a tip-over event will cause damage to the engine. Follow the instructions for recovering the machine after a tip-over event; refer to **Recovering the Machine After a Tip-over Event** (page 35).

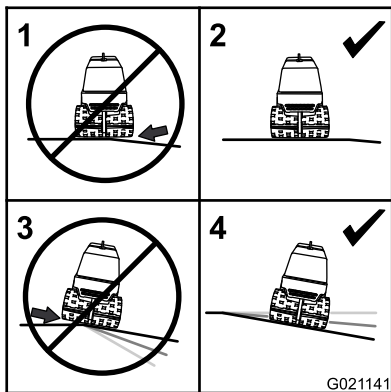

Figure 37

1. Do not move the machine across an incline where the machine is partially on the plane.
2. Move the machine across when fully on the plane.
3. Do not move the machine across an incline where the machine is partially on the slope.
4. When necessary, move the machine across an incline where the machine is fully on a slope of 18% (10°) or less.

Moving the Machine—Manual Mode

Use the traction controls to move the machine forward or backward, and turn the machine left or right.

⚠ CAUTION

Do not operate the machine with the parking brake engaged. Failure to disengage the parking brake may cause damage to the parking brake or the machine or both.

Important: When moving and steering the machine, keep both hands on the traction-control levers.

1. Start the engine using the manual mode; refer to **Starting the Engine—Manual Mode** (page 27).
2. Select the engine-speed switch to the fast, engine-speed position; refer to **Engine-speed Switch** (page 16).
3. Select a travel-speed/vibration switch position for the following operations:

Refer to **Travel-speed/Vibration Switch** (page 16)

- Move the machine forward: slow-travel speed or fast-travel speed.
 - Move the machine backward: slow-travel speed.
 - Turn the machine: slow-travel speed.
4. Disengage the parking brake; refer to **Releasing the Parking Brake** (page 30).
 5. Move and steer the machine by doing the following:
 - To **stop** the movement or turning of the machine, return the levers to the neutral (default) position (Figure 38).

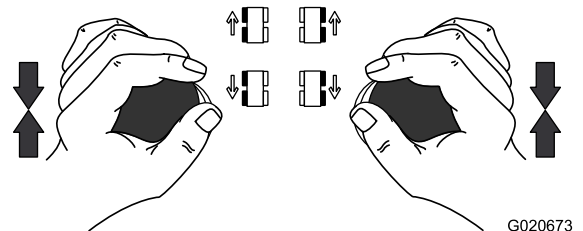

Figure 38

- To move the machine **forward**, grasp the both traction-control levers with your hands and push both levers forward (Figure 39).

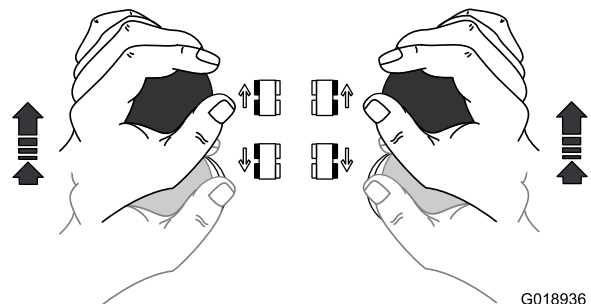

Figure 39

- To move the machine **backward**, grasp the traction-control levers with your hands and pull back on both levers. To stop the machine, return the levers to the neutral position (Figure 40).

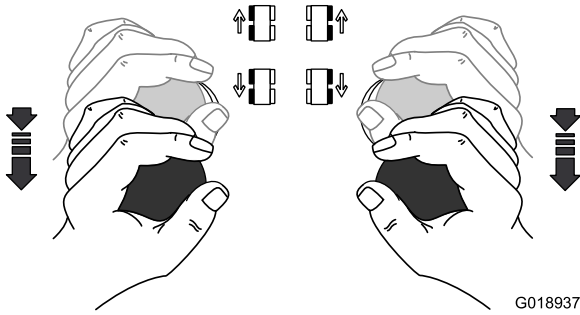

Figure 40

- To turn the machine **left**, grasp the both traction-control levers with your hands and pull the left, traction-control lever backward, and push the right, traction-control lever forward (Figure 41).

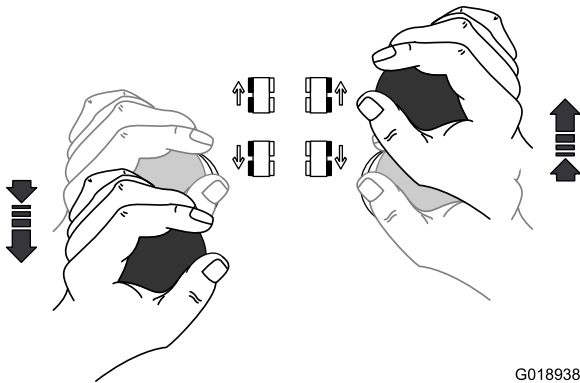

Figure 41

- To turn the machine **right**, grasp the both traction-control levers with your hands and push the left, traction-control lever forward, and pull the right, traction-control lever backward (Figure 42).

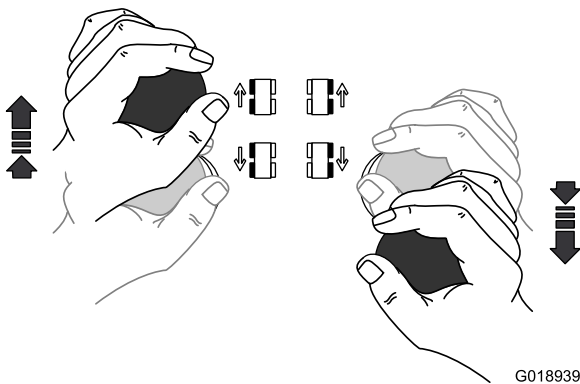

Figure 42

Moving the Machine—Remote-control Mode

The traction-control buttons for moving the machine in the forward or backward direction (straight, left or right) are located on the remote-control transmitter. Use the remote-control transmitter to move and steer the machine as follows:

Important: To stop the movement of the machine, release the traction-control button.

- Start the engine using the remote-control mode; refer to Starting the Engine—Remote-control Mode (page 27)

Note: The engine speed is automatically controlled by the microprocessor on the machine. The engine will crank over and operate at the slow-engine speed for one second, and then automatically accelerate the engine to the fast-engine speed.

- Select the travel-speed/vibration buttons for the following operations:

Refer to Travel-speed/Vibration Switch (page 16)

- Move the machine forward: slow or fast, travel-speed button.
- Move the machine backward: slow, travel-speed button.
- Turn the machine: slow, travel-speed button.

- Perform the following steps to move and control the machine direction of travel:

Note: The buttons must be pushed and held down to move the machine.

- To **stop** the movement or turning of the machine, release the traction button(s).
- To move the machine **forward**, press and hold the left, forward-traction button and the right, forward-traction button (Figure 43).

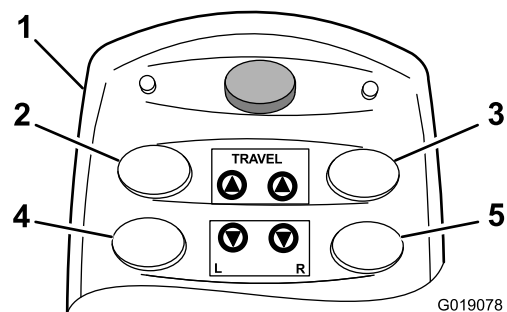

Figure 43

- | | |
|-----------------------------------|-----------------------------------|
| 1. Remote-control transmitter | 4. Left, reverse-traction button |
| 2. Left, forward-traction button | 5. Right, reverse-traction button |
| 3. Right, forward-traction button | |

- To move the machine **backward**, press and hold the left, reverse-traction button and the right, reverse-traction button (Figure 43).
- To turn the machine **left**, press and hold the left, reverse-traction button and the right, forward-traction button (Figure 43).
- To turn the machine **right**, press and hold the left, forward-traction button and the right, reverse-traction button (Figure 43).

Vibrating Operation

Move and steer the machine to align it to the site location; refer to Moving the Machine—Manual Mode (page 32) or Moving the Machine—Remote-control Mode (page 33).

- When operating in the **Manual mode** (control panel) start the vibration function by perform the following:
 1. Select the engine-speed switch to the fast, engine-speed position (Figure 44).

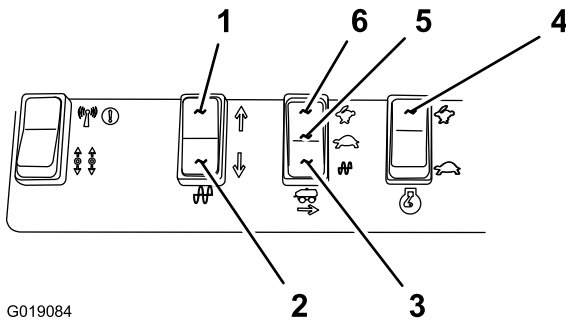

Figure 44

- | | |
|---|---------------------------------------|
| 1. Vibration-direction switch—forward | 4. Engine-speed switch—fast |
| 2. Vibration-direction switch—reverse | 5. Travel-speed/vibration switch—slow |
| 3. Travel-speed/vibration switch—vibration On | 6. Travel-speed/vibration switch—fast |

2. Select a vibration direction as follows:
 - Start the vibration function in the forward direction by pressing the vibration direction switch forward (Figure 44).
 - Start the vibration function in the reverse direction by pressing the vibration direction switch backward (Figure 44)

3. Select the travel-speed/vibration switch to the vibration On position (fully backward).
4. Steer the machine using the traction controls; refer to Moving the Machine—Manual Mode (page 32).
5. Stop the vibration function by selecting travel-speed/vibration switch to the slow-travel speed (fully forward) position, or to the middle position (fast-travel speed).

- When operating in the **Remote-control mode** (remote-control transmitter) start the vibration function by perform the following:

1. Select a vibration direction as follows:
 - Start the vibration function in the forward direction by pressing and releasing the forward-vibration button (Figure 45).
 - Start the vibration function in the reverse direction by pressing and releasing the reverse-vibration button (Figure 45)

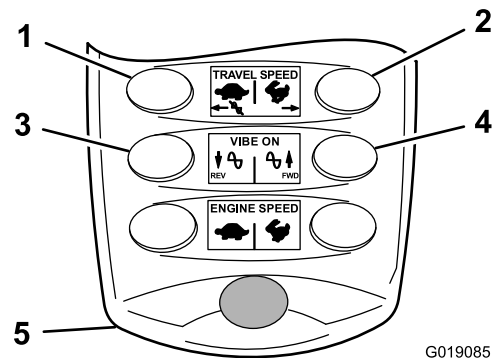

Figure 45

- | | |
|------------------------------|-------------------------------|
| 1. Slow, travel-speed button | 4. Reverse-vibration button |
| 2. Fast, travel-speed button | 5. Remote-control transmitter |
| 3. Forward-vibration button | |

2. Steer the machine using the traction control buttons; refer to Moving the Machine—Remote-control Mode (page 33).
3. Stop the vibration function by select either selecting the slow, travel-speed button or the fast, travel-speed button.

Recovering the Machine After a Tip-over Event

Retrieving the Machine

1. Connect the lifting equipment to the one of the following lifting points for the following rollover event.

- The machine is on its side:
 - A. Secure the lifting equipment to the lifting ring of the machine (Figure 46); refer to Lifting the Machine (page 30).

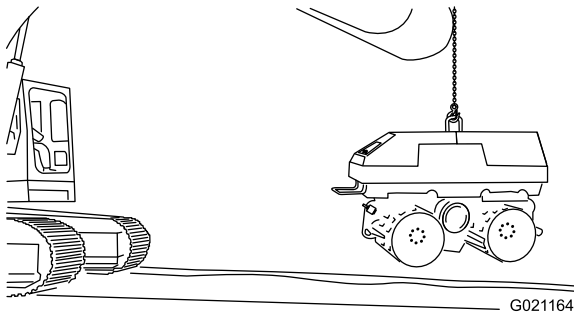

Figure 46

- B. Slowly raise the lifting equipment to rotate the machine so the top of the machine is up (Figure 46).

Note: When lifting the machine, ensure that it does not swing excessively.

- The machine is upside down:

Note: Recovering a machine that is upside down requires 2 units of lifting equipment.

- A. Attach the first unit of lifting equipment to the forward or rear tie-down ring (Figure 47).

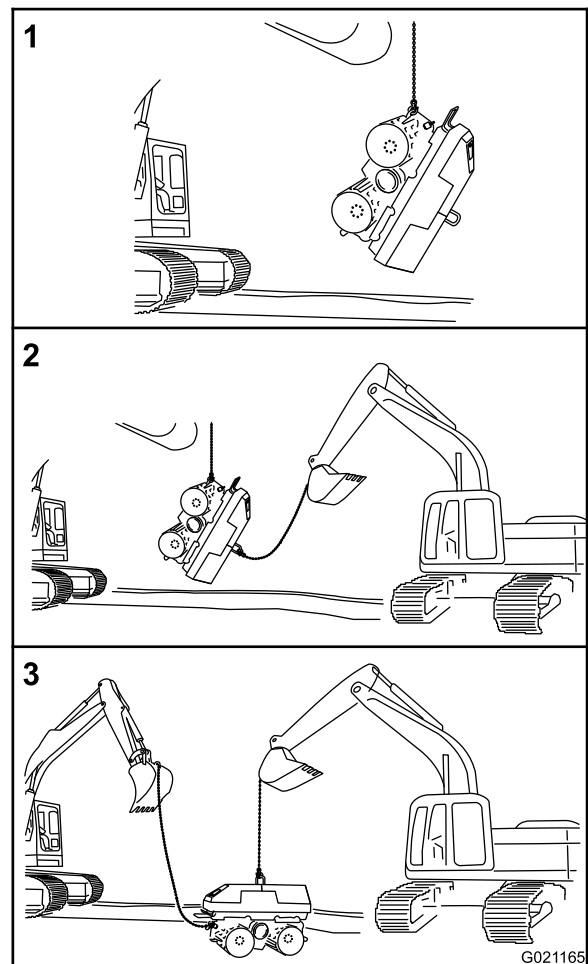

Figure 47

- B. Slowly raise the lifting equipment to rotate the machine vertical (Figure 47).
- C. Attach the second unit of lifting equipment to the lifting ring (Figure 47); refer to Lifting the Machine (page 30).
- D. Transfer the weight of the machine from the first unit of lifting equipment to the second lifting unit (Figure 47).

Note: The machine should be aligned with the top up.

2. Move the machine to a level surface.
3. Lower the machine and disconnect the lifting equipment (Figure 47).
4. Clean any debris from the exhaust duct, oil-cooler duct, control panel, and the forward and side grills; refer to Product Overview (page 13).
5. Inspect the machine for damage.

Important: Repair damage to the machine before operating it.

Note: Closely inspect the anti-crush bar, control panel, parking brake, and the hydraulic lines for the motor on the eccentric.

6. Check the engine, air-filter element by looking at the pleats of the element while shining a bright light on the inside of the filter.

Note: Replace the air-filter element if it is covered with oil, dirt, or dust; refer to Servicing the Air Filter (page 44).

Removing the Fuel Injectors

1. Open the forward hood; refer to Opening the Hood (page 24).
2. Close the fuel-shutoff valve (Figure 24).
3. Clean any dirt and debris from the engine.

Note: Ensure that no dirt is on the cylinder head area near the fuel injectors.

4. Remove the bolt, washer, and clamp that secures the fuel hose to the top-forward side of the forward-cylinder head.

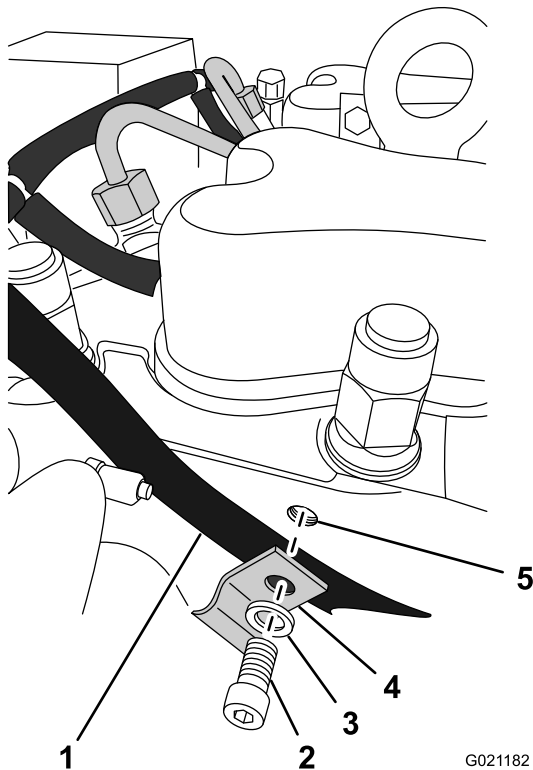

Figure 48

G021182

- | | |
|--------------|--------------------------|
| 1. Fuel hose | 4. Clamp |
| 2. Bolt | 5. Forward-cylinder head |
| 3. Washer | |

5. Remove the bolt and nut that secure the fuel-tube clamp to the support bracket, and remove the clamp.

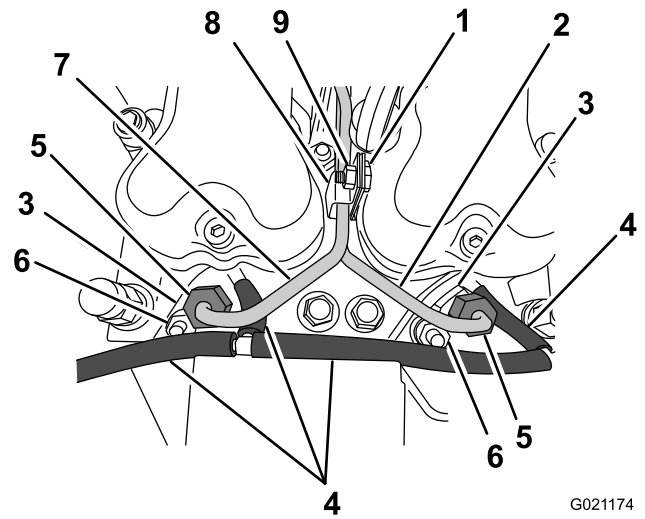

Figure 49

G021174

- | | |
|----------------------|-------------------|
| 1. Bolt | 6. Retainer nut |
| 2. Forward-fuel tube | 7. Rear fuel tube |
| 3. Retainer | 8. Clamp |
| 4. Rubber hose | 9. Nut (6 mm) |
| 5. Tube nut | |

6. Loosen the tube nuts for both of the fuel injectors (Figure 49 and Figure 50).
7. Pull the fuel tubes away from the fuel injectors.
8. Remove the retainer nuts, washers, lock washers, and retainers that secure the fuel injectors to the cylinder head (Figure 50).

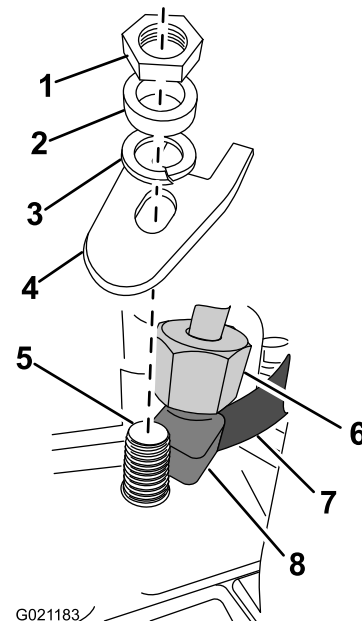

Figure 50

G021183

- | | |
|-----------------|--------------|
| 1. Retainer nut | 5. Stud |
| 2. Washer | 6. Tube nut |
| 3. Lock washer | 7. Fuel hose |
| 4. Retainer | 8. Injector |

Note: Do not remove the rubber hoses from the injectors.

- Using a twisting and pulling motion, remove the **rear-fuel injector** from the cylinder head (Figure 51).

Note: If necessary, remove the cable ties that secure the fuel hose.

Note: Secure the fuel-injector gaskets for installation in step 1-A of Installing the Fuel Injectors (page 37).

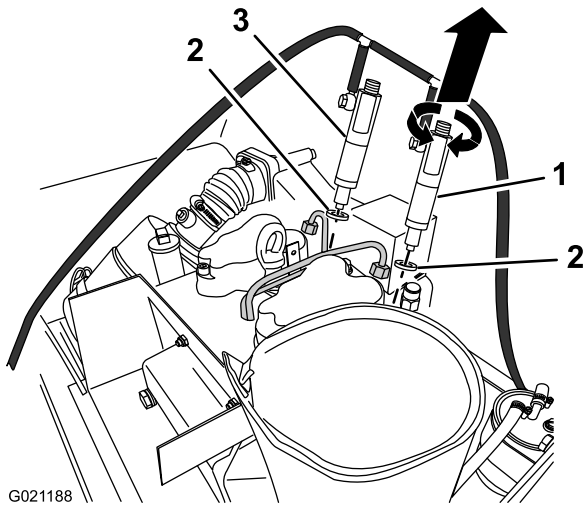

Figure 51

- Rear-fuel injector

- Using a twisting and pulling motion, remove the **forward-fuel injector** from the cylinder head (Figure 51).

Purging the Cylinders of Oil

- Wrap the end of the fuel tubes and the fuel injectors with a clean rag.

Note: These rags will protect the tubes and injectors from contamination.

- Loosely pack rags into the cylinder-head area of the fuel injector holes.

Note: These rags will absorb the oil that is ejected from the cylinder.

Important: Stand away from the engine.

- Select the engine-speed switch to the slow, engine-speed position.
- Use the key switch to crank the engine for 3 seconds.
- Replace any oil-soaked rags at the area of the fuel injector holes.
- Repeat steps 4 and 5 until oil stops ejecting from the fuel injector holes.
- Remove the rags from the fuel-injector holes and the fuel injectors.

Installing the Fuel Injectors

- Install the fuel injectors as follows:

- Install the gaskets around the bottom tips of the fuel injectors.

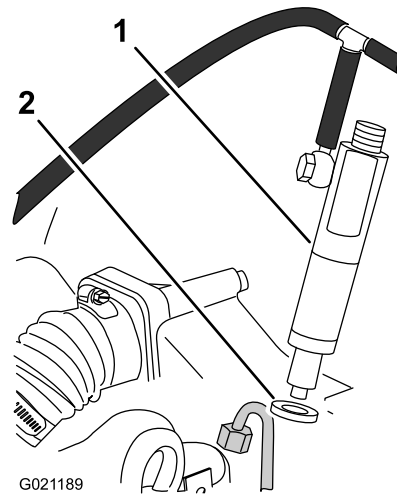

Figure 52

- Fuel injector
- Gasket

- Install the forward-fuel injector into the cylinder head.

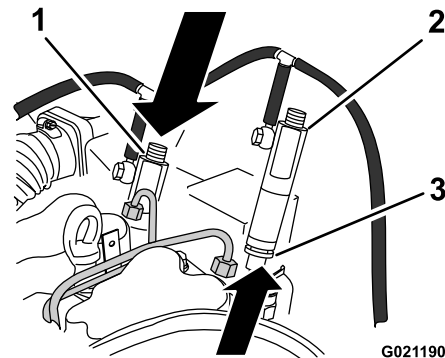

Figure 53

- Forward-fuel injector
- Rear-fuel injector
- Gasket

- Install the rear-fuel injector into the cylinder head.

Important: Ensure that the fuel injectors are fully seated into the cylinder head.

- Install the retainers, washers, lock washers, and nuts that were removed in step 8 of Removing the Fuel Injectors (page 36).
- Torque the retainer nuts to 23 N-m (17 lb ft).
- Align the fuel tubes over the fuel injectors.
- Thread the fuel-tube nuts onto the fuel injectors.

- H. Secure the fuel tubes to the support bracket with the clamp, bolt, and nut that were removed in step 5 of Removing the Fuel Injectors (page 36).
 - I. Tighten the fuel-tube nuts to 25 N-m (19 ft-lb).
 - J. Secure the fuel hose to the top-forward side of the forward-cylinder head with the bolt, washer, and clamp removed in step 4 of Removing the Fuel Injectors (page 36).
2. Check the level of the engine oil; refer to Checking the Level of the Engine Oil (page 25).
 3. Check the hydraulic fluid level; refer to Checking the Hydraulic Fluid Level (page 26).
 4. Open the fuel-shutoff valve (Figure 24).
 5. Prime the fuel system; refer to Priming the Fuel System (page 23).
 6. Select the engine-speed switch to the slow, engine-speed position.
 7. Start the engine, refer to Starting the Engine—Manual Mode (page 27).

Note: The engine may initially produce blue-white smoke while it runs.

8. Run the engine in the following order:
 - A. slow-engine-speed for 2 minutes
 - B. fast-engine-speed for 5 minutes
 - C. slow-engine-speed for 1 minute
 - D. stop the engine.

Note: Refer to Engine-speed Switch (page 16) and Stopping the Engine—Manual Mode (page 27).

Maintenance

Recommended Maintenance Schedule(s)

| Maintenance Service Interval | Maintenance Procedure |
|------------------------------|---|
| After the first 25 hours | <ul style="list-style-type: none">• Change the engine oil and filter. |
| After the first 50 hours | <ul style="list-style-type: none">• Replace the hydraulic filter. |
| Before each use or daily | <ul style="list-style-type: none">• Check the engine oil level.• Check the hydraulic fluid level.• Service the air filter, housing and cover for the engine.• Remove debris from the machine.• Check for loose fasteners. |
| Every 40 hours | <ul style="list-style-type: none">• Grease the machine (Grease immediately after every washing).• Replace the air filter of the engine (more frequently if conditions are dusty or sandy).• Tighten the engine mounting hardware.• Clean the cooling system. |
| Every 100 hours | <ul style="list-style-type: none">• Change the engine oil and filter.• Replace the fuel filter/water separator canister.• Check the battery cable connections.• Replace the hydraulic filter or when the hydraulic-filter gauge indicates Caution (yellow) or Service Filter (red).• Check the hydraulic lines for leaks, loose fittings, kinked lines, loose mounting supports, wear, weather, and chemical deterioration.• Check for accumulation of dirt and debris in the chassis. |
| Every 250 hours | <ul style="list-style-type: none">• Check and clean the fuel injectors. |
| Every 350 hours | <ul style="list-style-type: none">• Change the eccentric lubrication. |
| Every 400 hours | <ul style="list-style-type: none">• Check the fuel lines and connections for deterioration, damage, or loose connections. |
| Every 800 hours | <ul style="list-style-type: none">• Change the hydraulic fluid. |
| Every 1,500 hours | <ul style="list-style-type: none">• Replace all moving hydraulic hoses. |
| Monthly | <ul style="list-style-type: none">• Check the battery voltage. |
| Yearly | <ul style="list-style-type: none">• Drain the fuel tank. |
| Yearly or before storage | <ul style="list-style-type: none">• Touch up chipped paint |

⚠ WARNING

After operating the machine, the muffler, engine, and engine shroud are hot and can burn you if touched.

Allow all components in the engine compartment to cool before performing any maintenance on the machine.

⚠ CAUTION

If you leave the key in the ignition switch, someone could accidentally start the engine and seriously injure you or other bystanders.

Remove the key from the ignition before you do any maintenance.

Important: Refer to your *Engine Manual* for additional maintenance procedures.

Note: Determine the left and right sides of the machine from the normal operating position.

Premaintenance Procedures

Before performing maintenance on the machine, perform the following steps:

1. Park the machine on a level surface.
2. Set the parking brake; refer to Using the Parking Brake (page 28).
3. Stop the engine and remove the key; refer to Starting and Stopping the Engine (page 27).
4. Allow the engine to cool.

Lubrication

Greasing the Machine

Service Interval: Every 40 hours—Grease the machine (Grease immediately after every washing).

Grease Type: Lithium base grease.

1. Open the forward and rear hoods; refer to Opening the Hood (page 24).
2. Clean the grease fittings with a rag.
3. Connect a grease gun to the fittings (Figure 54).

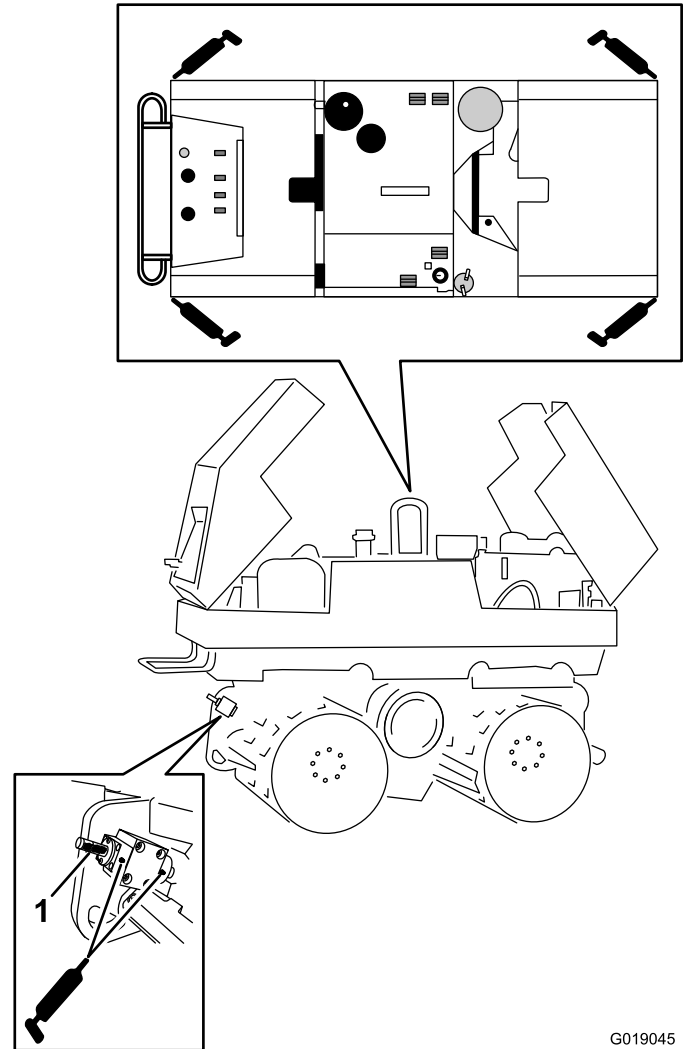

G019045

Figure 54

1. Brake handle

4. Pump grease into the grease fittings until grease begins to ooze out of the bearings (approximately 3 pumps).
5. Clean off any excess grease with a rag.
6. Close the forward and rear hoods; refer to Closing the Hood (page 25).

Engine Maintenance

Changing the Engine Oil and Filter

Service Interval: After the first 25 hours—Change the engine oil and filter.

Every 100 hours—Change the engine oil and filter.

Note: Change oil and oil filter more frequently when operating conditions are extremely hot or dusty.

Oil Type: Detergent, diesel-engine oil (all trademark oils which fulfil at least one of the following specifications: **ACEA-B2/E2** or higher, or **API** service CH-4 or higher)

Crankcase Capacity: 1.9 L (2 qt)

Viscosity: Refer to Figure 55.

Toro Premium Engine Oil is available from your Authorized Toro Dealer.

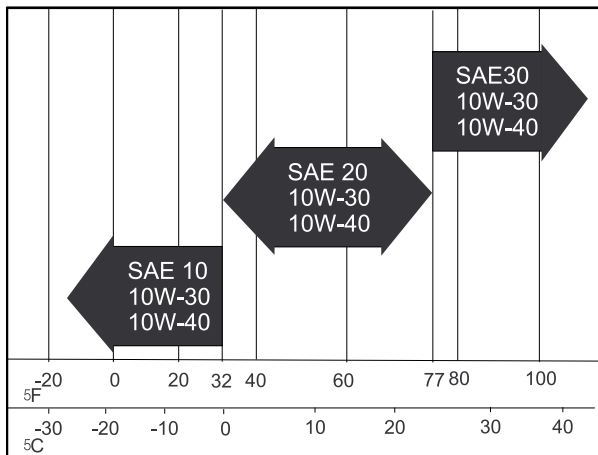

Figure 55

G001061

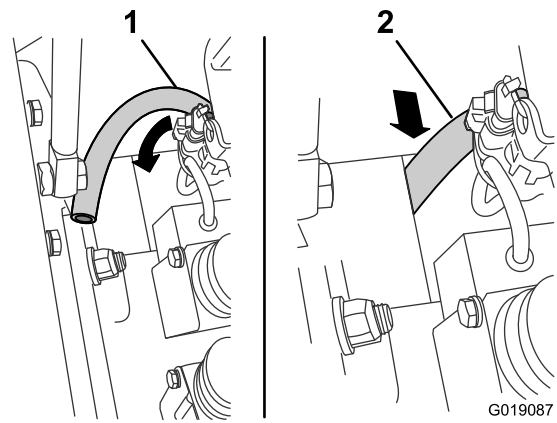

Figure 56

1. Engine oil drain hose (stowed position)
2. Engine oil drain hose (drain position)

3. Move the free end of the hose from the stowed position, out the opening at the bottom of the engine compartment, and to the drain position.

Note: The drain hose should be aligned below the front grill.

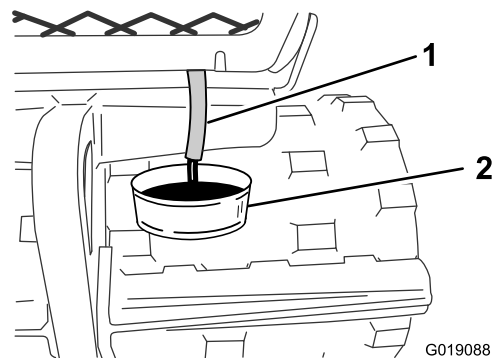

Figure 57

1. Engine oil drain hose (drain position)
2. Drain pan

Draining the Engine Oil

CAUTION

Components will be hot if the machine has been running. If you touch hot components you may be burned.

Allow the machine to cool before performing maintenance or touching components under the hood.

Prepare to drain the engine oil as follows:

1. Open the forward hood; refer to Opening the Hood (page 24).
2. At the left-front area of the engine, locate the drain hose that is attached to the engine oil drain valve.

4. Start the engine and allow it to run at the slow-engine speed for five minutes; refer to Starting the Engine—Manual Mode (page 27) and Engine-speed Switch (page 16).

Note: Warming the engine oil allows it to drain better.

5. Stop the engine and remove the key.
6. Place a drain oil pan below the oil drain hose.

Note: Use a drain pan with a 3 L (3.17 qt) capacity or more.

Drain the engine oil as follows:

⚠ CAUTION

Hot engine components can cause injury. Use caution when opening and closing the oil-drain valve.

1. Locate the oil-drain valve at the front, bottom area of the engine (Figure 58).
2. Rotate the lever for the drain valve counterclockwise to the open position. (Figure 58).

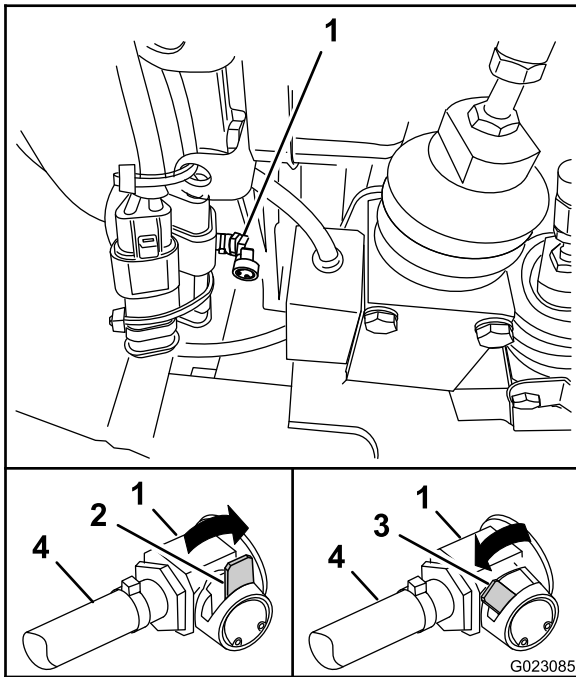

Figure 58

1. Oil-drain valve
2. Lever (closed position)
3. Lever (open position)
4. Drain hose

3. When the oil has completely drained from the engine, rotate the lever on the drain valve clockwise to the closed position (Figure 58).

Note: Dispose of the used oil at a certified recycling center.

4. Wipe the end of the drain hose, pull the hose into the engine compartment, and place it in the stowed position (Figure 56).
5. Change the oil filter; refer to Changing the Oil Filter (page 42).

Changing the Oil Filter

1. Place a shallow pan or rag under the filter to catch oil (Figure 59).

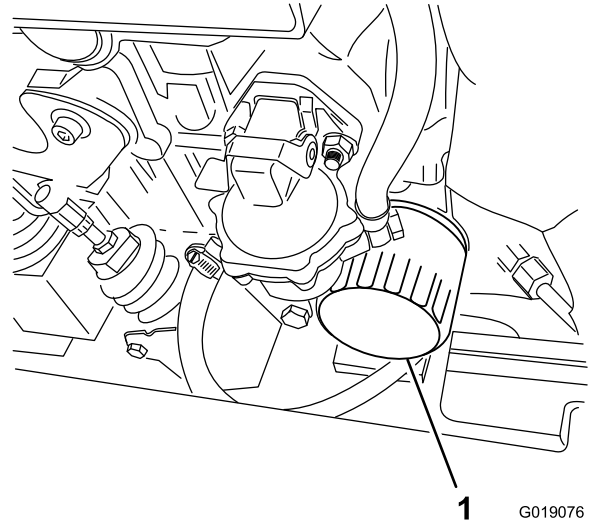

Figure 59

1. Engine oil filter

2. Rotate the oil filter counterclockwise and remove the old filter (Figure 59).

Note: Dispose the used oil filter at a certified recycling center.

3. On the engine, wipe the sealing surface of the filter adapter clean with a rag.
4. Prepare the new oil filter as follows:
 - A. Pour new oil of the proper type through the center hole of the filter until the oil reaches the bottom of the threads.
 - B. Allow a minute or two for the oil to be absorbed by filter material, then pour off the excess oil.
 - C. Apply a thin coat of new oil to the rubber gasket on the replacement filter.
5. Install the replacement oil filter to the filter adapter. Turn the oil filter clockwise until the rubber gasket contacts the filter adapter, then tighten the filter an additional 1/2 turn (Figure 59).
6. Fill the crankcase with the specified oil; refer to Filling the Engine with Oil (page 43).

Filling the Engine with Oil

Engine oil capacity: 0.95 L (2 qt)

1. Clean around the oil-filler cap, and remove the cap.
2. Slowly pour approximately 0.76 L (1.5 qt) of the specified oil in through the oil-filler neck (Figure 60).

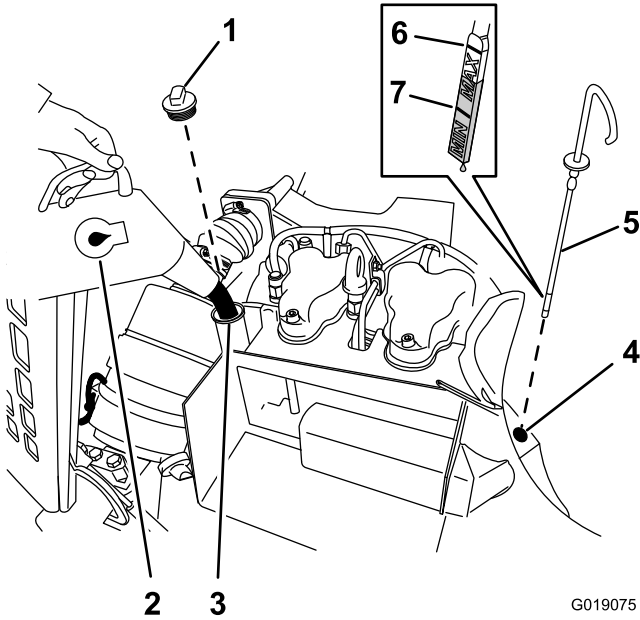

Figure 60

G019075

- | | |
|---------------------|------------------|
| 1. Oil-filler cap | 5. Dipstick |
| 2. Engine oil | 6. Max-oil level |
| 3. Oil-filler neck | 7. Min-oil level |
| 4. Dipstick fitting | |

- D. Pull the dipstick out and look at the metal end.
- E. If the oil level is below the Min-level mark on the dipstick, slowly pour enough oil into the oil-fill tube to raise the level on the dipstick to between the Min- and Max-oil level (Figure 60).

Important: Do not overfill the crankcase with oil.

- F. Install the oil filler cap in the filler neck (Figure 60).
- G. Insert the dipstick into the dipstick fitting, and seat the dipstick firmly.
4. Start the engine and allow it to run at the slow-engine speed for 2 minutes; refer to Starting the Engine—Manual Mode (page 27) and Engine-speed Switch (page 16).
5. Stop the engine and wait for 2 minutes; refer to Stopping the Engine—Manual Mode (page 27).
6. Repeat steps 3-B through 3-G.
7. Close the hood; refer to Closing the Hood (page 25).

3. Check the engine oil level as follows:
 - A. Clean around the oil dipstick and dipstick fitting.
 - B. Pull out the dipstick and wipe the metal end clean.
 - C. Slide the dipstick fully into the dipstick fitting.

Servicing the Air Filter

Important: Prevent engine damage by always operating the machine with the air filter and cover installed.

Servicing the Air Filter, Housing, and Cover

Service Interval: Before each use or daily—Service the air filter, housing and cover for the engine.

1. Open the forward hood; refer to Opening the Hood (page 24).
2. Check the air-filter housing and air-intake boot for damage. Check the entire intake system for damage, signs of leaks, and loose hose clamps.

Note: Repair or replace damaged components before operating the machine.

3. Release the latches on the air-filter cover and pull it off of the air filter housing (Figure 61).

Important: Do not remove the air filter.

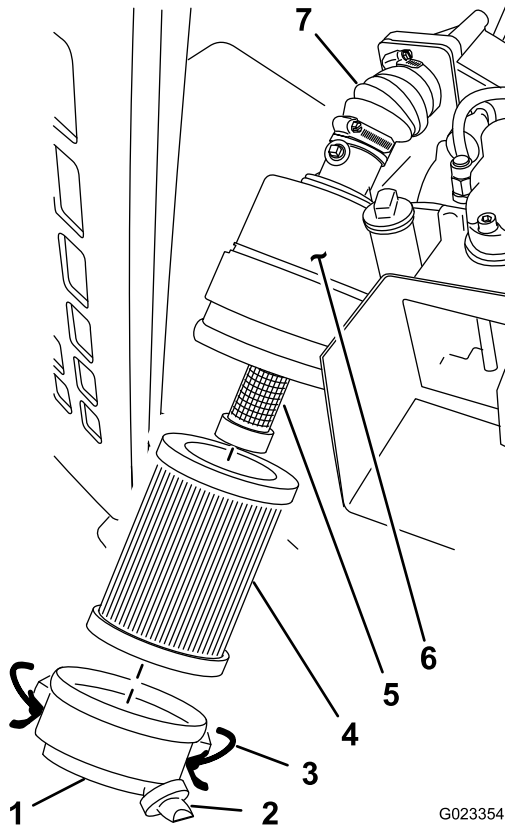

Figure 61

- | | |
|-----------------------|-------------------------|
| 1. Air-filter cover | 5. Secondary-air filter |
| 2. Dust cap | 6. Air-filter housing |
| 3. Latch | 7. Air-intake boot |
| 4. Primary-air filter | |

4. Squeeze the dust cap sides to open it and knock the dust out.

5. Clean the inside of the air-filter cover with compressed air.
6. Check the visible portion of the exterior air filter surface.
 - If the filter surface is clean, perform the following:
 - A. Install the air filter cover with the dust cap facing down and back, and secure the latches on the filter cover (Figure 61).
 - Note:** Ensure that the cover is seated correctly and seals with the air filter housing.
 - B. Close the forward hood; refer to Closing the Hood (page 25).
- If the filter surface is dirty, replace the air filter as described in Replacing the Air Filter (page 44).

Replacing the Air Filter

Service Interval: Every 40 hours—Replace the air filter of the engine (more frequently if conditions are dusty or sandy).

1. Release the latches on the air-filter cover and pull it off of the air-filter housing (Figure 61).
2. Gently remove the primary-air filter from the air-filter housing (Figure 61).

Note: Avoid knocking the filter into the side of the housing.

Important: Do not attempt to clean the air filter.

3. Gently remove the secondary-air filter from the air-filter housing (Figure 61).
4. Inspect the new filter elements and the rubber seal for damage.

Note: If the filter is damaged, install a new air filter that is undamaged.

5. Install the secondary-air filter into the air-filter housing (Figure 61).

Important: Do not press on the soft, inside area of the filter.

Note: Ensure that it is centered in the housing and fully seated by pushing on the outer rim of the filter while installing it.

6. Install the primary-air filter into the air-filter housing (Figure 61).

Important: Do not press on the soft, inside area of the filter.

Note: Ensure that it is centered in the housing and fully seated by pushing on the outer rim of the filter while installing it.

- Install the air-filter cover with the dust cap facing down and back, and secure the latches on the filter cover (Figure 61).

Note: Ensure that the cover is seated correctly and seals with the air filter housing.

- Close the forward hood; refer to Closing the Hood (page 25).

Engine Hardware

Tightening the Engine Mounting Hardware

Service Interval: Every 40 hours—Tighten the engine mounting hardware.

- Open the forward hood; refer to Opening the Hood (page 24).
- Tighten the 4 nuts and 4 bolts that secure the engine to the upper frame to 68 N-m (50 lb-ft); refer to Figure 62 and Figure 63.

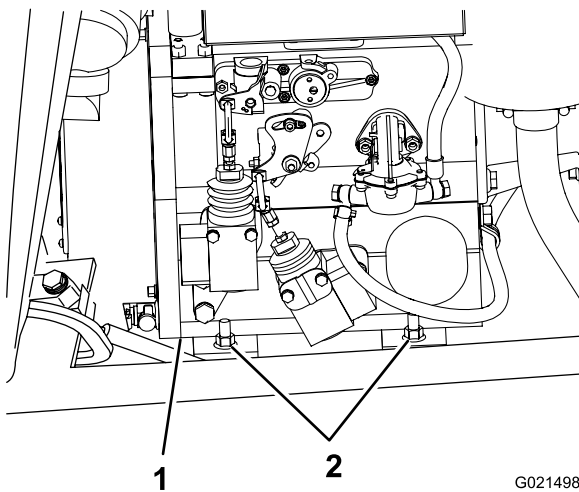

Figure 62

G021498

- Engine (left side)
- Nut (engine mounting)

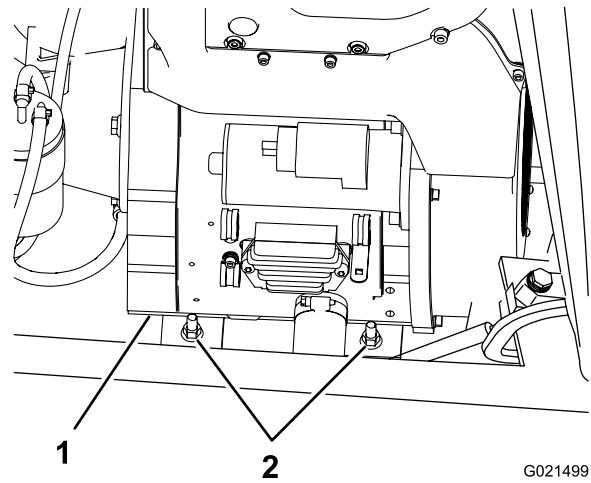

Figure 63

G021499

- Engine (right side)
 - Nut (engine mounting)
-
- Close the forward hood; refer to Closing the Hood (page 25).

Fuel System Maintenance

⚠ DANGER

Under certain conditions, diesel fuel and fuel vapors are highly flammable and explosive. A fire or explosion from fuel can burn you and others and can cause property damage.

- Use a funnel and fill the fuel tank outdoors, in an open area, when the engine is off and is cold. Wipe up any fuel that spills.
- Do not fill the fuel tank completely full. Add fuel to the fuel tank until the level is 6 to 13 mm (1/4 to 1/2 inch) below the bottom of the filler neck. This empty space in the tank allows the fuel to expand.
- Never smoke when handling fuel, and stay away from an open flame or where fuel fumes may be ignited by a spark.
- Store fuel in a clean, safety-approved container and keep the cap in place.

Replacing the Fuel Filter/Water Separator Canister

Service Interval: Every 100 hours/Monthly (whichever comes first)—Replace the fuel filter/water separator canister.

Removing the fuel filter/water separator

1. Open the forward hood; refer to Opening the Hood (page 24).
2. Locate the fuel-shutoff valve at the right-lower corner of the fuel tank (Figure 64).

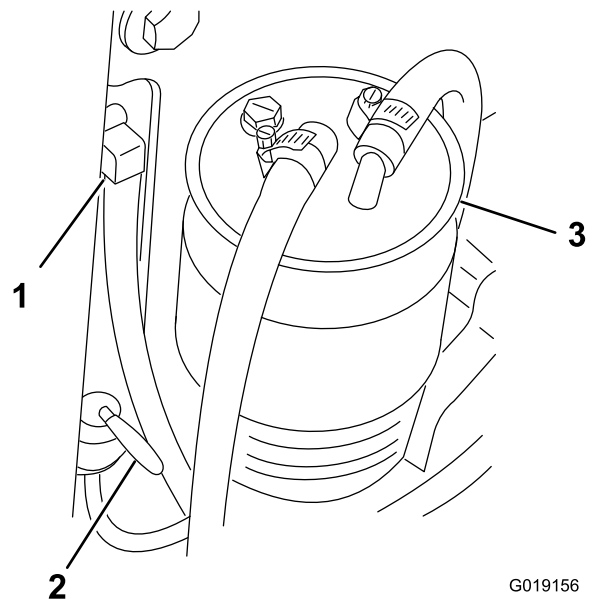

G019156

Figure 64

1. Fuel return line
2. Fuel-shutoff valve
3. Fuel/water separator

3. Rotate the handle of the fuel-shutoff valve to the Off position (Figure 64).
4. Locate the fuel filter/water separator canister on the right-forward side of the heat shield for the fuel tank (Figure 65).

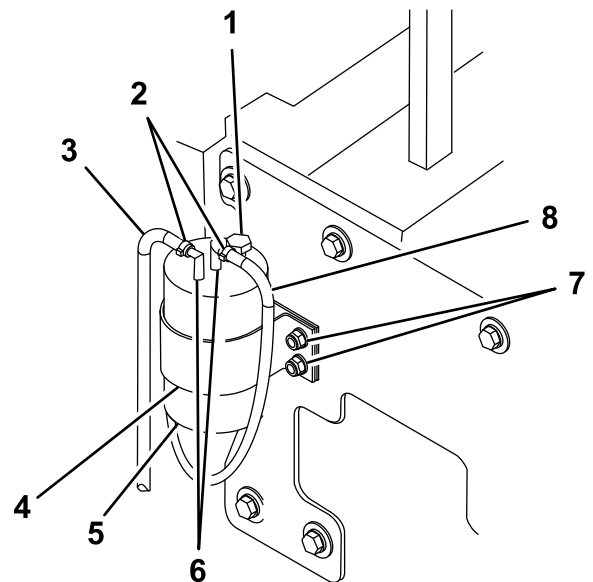

G019090

Figure 65

1. Hex-head plug
2. Hose clamps
3. Fuel outlet hose
4. Canister Strap
5. Fuel filter/water separator canister
6. Fittings
7. Nuts
8. Fuel inlet hose

5. Clean the area where the filter canister mounts.

- Loosen the hose clamps that secure the 2 fuel lines (Figure 65).
- Loosen the 2 nuts that secure the canister strap and the filter/separator canister to the studs on the fuel tank heat shield (Figure 65).

Installing the Fuel Filter/Water Separator

- Remove the hex-head plug from the replacement fuel filter/water separator (Figure 66).

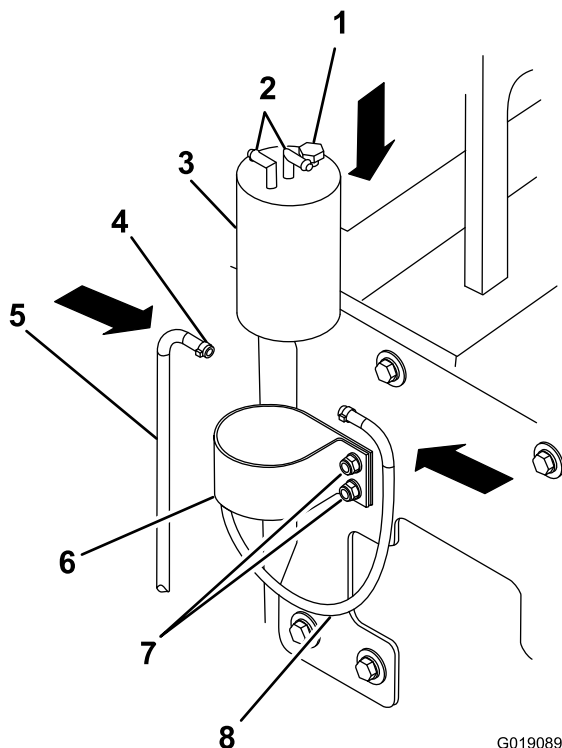

Figure 66

G019089

- | | |
|---|---------------------|
| 1. Hex-head screw | 5. Fuel outlet hose |
| 2. Fittings | 6. Canister Strap |
| 3. Fuel filter/water separator canister | 7. Nuts |
| 4. Hose clamp | 8. Fuel inlet hose |

- Fill the replacement filter/water separator with clean, fresh fuel.
- Apply PTFE thread-sealing tape to the threads of the hex-head plug and install the plug in the replacement filter separator.
- Remove the old filter/separator canister from the straps.
- Install the replacement canister in straps with the hex-head plug toward the heat shield (Figure 66).
- Tighten the nuts that secure the filter/separator canister and strap to the heat shield (Figure 66).
- Transfer the hoses and clamps, one at a time, from the old filter/separator canister to the replacement

canister. Slide the hoses over the fittings of a new filter/separator canister (Figure 66).

- Tighten the hose clamps.
- Drain and discard the old filter.

Note: Dispose the used fuel filter at a certified recycling center.

- Rotate the handle of the fuel-shutoff valve to the On position (Figure 64).
- Close the forward hood; refer to Closing the Hood (page 25)

Draining the Fuel Tank

Service Interval: Yearly

Draining the Fuel Tank

- Ensure that the engine and exhaust system is cool.
- Open the both hoods; refer to Opening the Hood (page 24).
- Remove the right-side panel; refer to Removing the Right-side Panel (page 57).
- Place a waste-fuel container with a 11.5 L (3 US gallons) capacity under drain valve at the right-lower corner of the fuel tank (Figure 67).

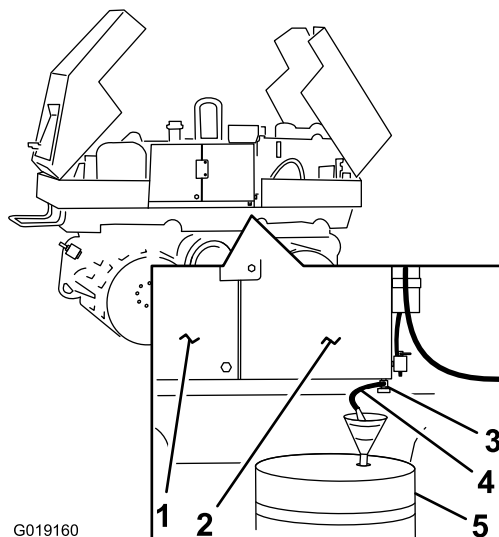

G019160

Figure 67

- | | |
|----------------------------|--|
| 1. Hydraulic tank | 4. 6 mm (1/4 inch) fuel-resistant hose |
| 2. Fuel tank | 5. Waste-fuel container |
| 3. Drain valve (fuel tank) | |

- Slip a fuel-resistant hose with a 6 mm (1/4 inch) inside diameter over the fitting of the drain valve (Figure 67).

Note: Ensure that the fuel resistant hose is long enough to reach the waste fuel container.

- Place the free end of the hose into the waste fuel container (Figure 67).
- Open the drain valve and allow the tank to empty.
- Close the drain valve and remove the hose that was attached to the valve in step 5 (Figure 67).

Note: Dispose of the drained fuel at a certified recycling center.

- Install the right-side panel; refer to Installing the Right-side Panel (page 57).
- Close the both hoods; refer to Closing the Hood (page 25).

Fuel Lines and Fuel Injectors

Checking the Fuel Lines and Connections

Service Interval: Every 400 hours/Yearly (whichever comes first)

Note: Contact your Toro Authorized Service Dealer for assistance in fixing damaged fuel lines.

- Inspect the fuel lines and connections for deterioration, damage, or loose connections.
- Inspect the fuel lines and connections for leaks.
- Tighten any loose connections.

Servicing the Fuel Injectors

Service Interval: Every 250 hours

Contact your Toro Authorized Service Dealer maintenance of the fuel injection system.

Electrical System Maintenance

Servicing the Battery

WARNING

CALIFORNIA Proposition 65 Warning

Battery posts, terminals, and related accessories contain lead and lead compounds, chemicals known to the State of California to cause cancer and reproductive harm. Wash hands after handling.

Important: The machine is equipped with a dry-cell battery. Automotive (wet-cell) batteries are not designed to withstand severe vibration or being inverted. Do not replace the dry-cell battery of this machine with an automotive (wet-cell) battery.

Always keep the battery clean and fully charged. Use a paper towel to clean the battery case. If the battery terminals are corroded, clean them with a solution of four parts water and one part baking soda. Apply a light coating of grease to the battery terminals to reduce corrosion.

The machine-electrical system is 12 volt.

Checking the Battery Voltage of the Machine

Service Interval: Monthly—Check the battery voltage.

1. Insert the machine key into the key switch and rotate the key switch to the Run position.
2. Wait 5 minutes, and note the voltage shown on the LED display.

Note: Refer to the battery charge table to determine the charge state of the battery.

Battery Charge-state Table

| Volts | Battery State |
|----------------|------------------|
| 12.7 and above | 100% charge |
| 12.7–12.6 | 85–100% charge |
| 12.6–12.4 | 75–85% charge |
| 12.4–12.2 | 50–75% charge |
| 12.2–12.0 | 25–50% charge |
| Below 12.0 | Fully discharged |

Checking the Battery Cable Connection

Service Interval: Every 100 hours—Check the battery cable connections.

Check that the battery cable clamps are secure to the positive and negative battery terminals.

Charging the Battery

▲ WARNING

Charging the battery produces gasses that can explode.

Never smoke near the battery and keep sparks and flames away from battery.

Important: Always keep the battery fully charged. This is especially important to prevent battery damage when the temperature is below 32°F (0°C).

1. Clean the exterior of the battery case and the battery posts.

Note: Connect the leads of the battery charger to battery posts before connecting the charger to the electrical source.
2. Look at the battery and identify the positive and negative battery posts.
3. Connect the positive lead of the battery charger to the positive-battery post (Figure 68).

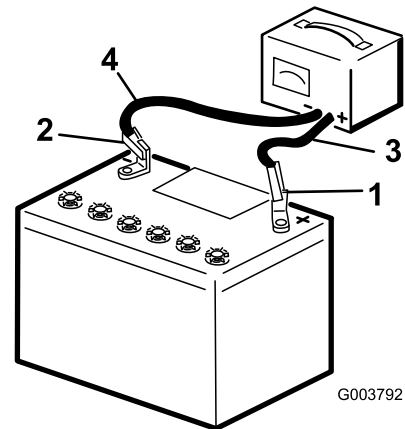

Figure 68

1. Positive-battery post
2. Negative-battery post
3. Red (+) charger lead
4. Black (-) charger lead

4. Connect the negative lead of the battery charger to the negative-battery post (Figure 68).
5. Connect the battery charger to the electrical source.

Important: Do not overcharge the battery.

Note: Charge the battery as shown in battery charging table.

Battery-charger Table

| Charger setting | Charging time |
|------------------|------------------|
| 4 to 6 amperes | 30 minutes |
| 25 to 30 amperes | 10 to 15 minutes |

- When the battery is fully charged, unplug the charger from the electrical source, then disconnect the charger leads from the battery posts (Figure 68).

Jump Starting the Battery

⚠ DANGER

Jump starting a weak battery that is cracked, frozen, has low electrolyte level, or an open/shorted battery cell, can cause an explosion resulting in serious personal injury.

Do not jump start a weak battery if these conditions exist.

⚠ WARNING

Batteries contain acid and produce explosive gases.

- Shield the eyes and face from the batteries at all times.
- Do not lean over the batteries.

⚠ CAUTION

Corrosion or loose connections can cause unwanted electrical voltage spikes at anytime during the jump starting procedure.

Do not attempt to jump start with loose or corroded battery terminals or damage to the engine may occur.

⚠ CAUTION

Connecting the jumper cables incorrectly (wrong polarity) can immediately damage the electrical system.

Be certain of battery terminal polarity and jumper cable polarity when hooking up batteries.

Note: The following instructions are adapted from the SAE J1494 Rev. Dec. 2001 – Battery Booster Cables – Surface Vehicle Recommended Practice (SAE – Society of Automotive Engineers).

These instructions are for negative ground systems only.

Ensure the following conditions are met before jump starting the machine:

- The electrical systems of both machines have same rated voltage.
- The machines do not touch.
- The electrical systems of both machines are switched off.

- Check the weak battery for terminal corrosion (white, green, or blue “snow”), it must be cleaned off prior to jump starting. Clean and tighten battery cable connections as necessary.
- Make sure the battery of the booster machine is in good condition and fully charged to 12.6 volts or greater.

Note: Use 4 to 6 AWG (American Wire gauge) jumper cables with short lengths to reduce voltage drop between systems.

Ensure that the cables are color coded or labeled for the correct polarity.

- Connect the positive (+) cable to the positive (+) terminal of the discharged battery that is wired to the starter or solenoid as shown in Figure 69.

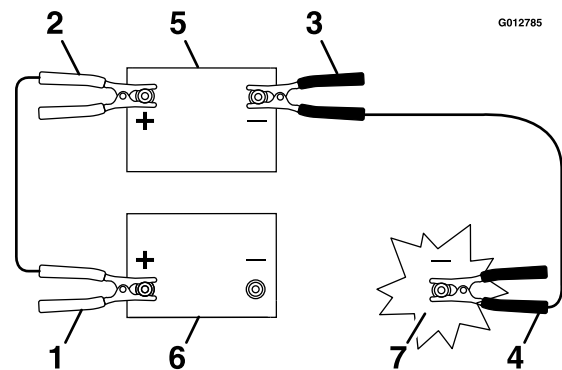

Figure 69

- Positive (+) cable on discharged battery
 - Positive (+) cable on booster battery
 - Negative (-) cable on the booster battery
 - Negative (-) cable on the engine block
 - Booster battery
 - Discharged battery
 - Engine block
-
- Connect the other end of the positive cable to the positive terminal of the booster battery.
 - Connect the black negative (-) cable to the other terminal (negative) of the booster battery.
 - Make the final connection on the engine block of the stalled machine (not to the negative battery post) and away from the battery. Stand Back.**
 - Start the stalled machine and remove the cables in the reverse order of connection (the engine block (black) connection is the first to disconnect).

Electrical and Electronic

Diagnostic Light Codes

Important: Keep the remote-control receiver and transmitter dry.

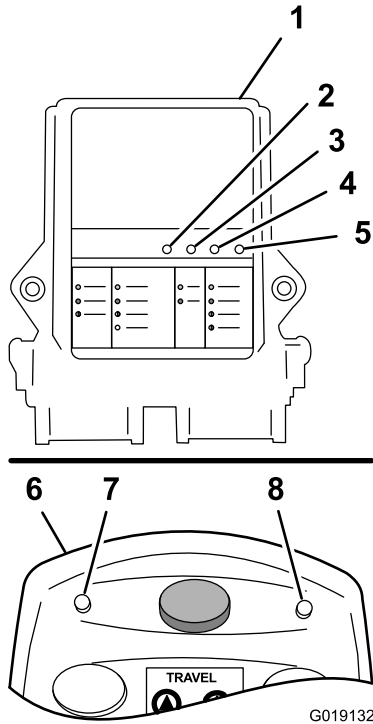

Figure 70

- | | |
|----------------------------|-------------------------------|
| 1. Remote-control receiver | 5. Status light |
| 2. Emergency-stop light | 6. Remote-control transmitter |
| 3. Function or fault light | 7. Battery light (red) |
| 4. Link light | 8. Active light (yellow) |

The following table explains the diagnostic codes for the indicator lights of the remote-control receiver:

Remote-control Receiver Diagnostic Codes Table

| Light | System | Condition |
|-----------------------------------|-------------------|---------------------------------|
| Green (steady) | Emergency stop | Active |
| Red (steady) | Emergency stop | Inactive |
| Flashing red | Emergency stop | Fault |
| Green (steady) | Function or Fault | Function On (no fault) |
| Red (steady) | Function or Fault | Short to ground or over current |
| Flashing red | Function or Fault | Short to supply |
| Not lit | Function or Fault | No function On |
| Green (steady) | Link | Connected |
| Red (steady) | Link | No link |
| Green (steady) | Status | OK |
| Red (steady) | Status | Fault |
| Green (flashing) | Status | Low battery |
| Red (flashing) | Status | Internal fuse open (blown) |
| Red and green (flashing together) | Link and status | Setup failure |

The following table explains the diagnostic codes for the indicator lights of the remote-control transmitter:

Remote-control Transmitter Diagnostic Codes Table

| Light | Flash rate | Condition |
|-----------------------------------|-------------------------|--|
| Yellow (active) | Medium | Normal operation. The light will remain illuminated momentarily when a function button is pressed or released. |
| | Slow | Download mode (not used) |
| Red (battery) | Slow | The transmitter battery is low |
| | Fast (10 seconds) | Transmitter failure |
| Yellow (active) and Red (battery) | Fast (together) | Configuration mode (not used) |
| | Slow (together) | Stuck button detected |
| | Slow (after power down) | Unit still powered |

Replacing the Radio-control Transmitter Batteries

The radio-control transmitter features a light that indicates the battery power in the transmitter is low. The light is located to the right of the link/start button (Figure 71).

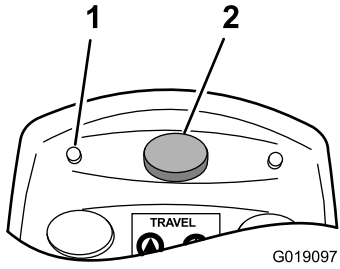

Figure 71

- 1. Battery light
- 2. Link / start button (green button)

If the low-battery light (red) for the radio-control transmitter is illuminated, change the batteries as follows:

Note: Use 4 AA batteries (1.5 volt).

1. Loosen the 4 screws that secure the battery cover from the back of the radio-control transmitter, and remove the cover (Figure 72).

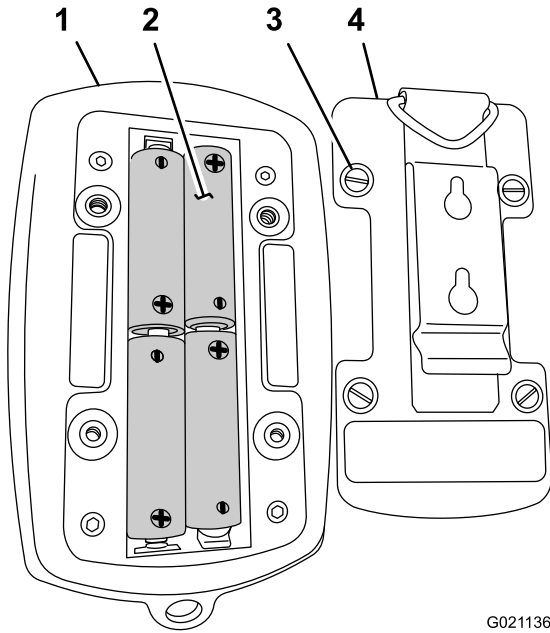

Figure 72

- 1. Remote-control transmitter (back side)
- 2. AA battery
- 3. Screw
- 4. Battery cover

2. Remove the depleted batteries.

Note: Dispose of batteries in accordance with relevant Federal, state, and local laws.

3. Insert the replacement batteries (Figure 72).

4. Install the battery cover to the transmitter and secure with the 4 screws (Figure 72) loosened in step 1.

Servicing the Fuses

The electrical system is protected by 3 fuses. The electrical system typically requires no maintenance; however, if a fuse blows, check the component/circuit for a malfunction or a short. Figure 73 shows the fuse positions in the junction box.

Note: If the machine will not start, either the ECM (electronic-control module) or the radio-control receiver fuse could be open (blown).

Service the fuses as follows:

1. Stop the engine and remove the key.
2. Open the rear hood; refer to Opening the Hood (page 24).
3. Remove the positive battery cable from the battery.
4. Locate the junction box in the right side of the compartment.
5. Remove the 8 bolts that secure the auxiliary panel to the junction box. Remove the auxiliary panel and gasket (Figure 73).

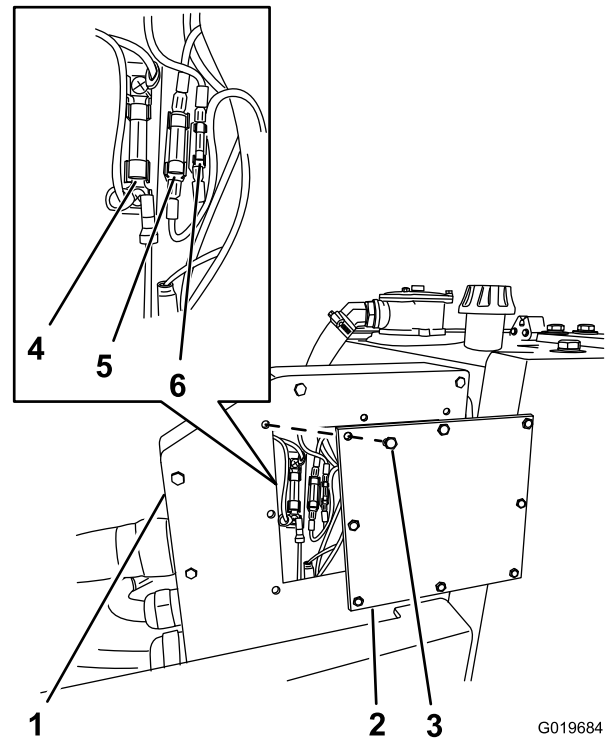

Figure 73

- 1. Junction box
- 2. Auxiliary panel
- 3. Bolt
- 4. 30 Amp fuse, electronic control module (+12 volt)
- 5. 10 Amp fuse, radio (ground)
- 6. 1 Amp fuse, radio (+12 volt)

6. Check the fuses for damage or an open circuit (blown); refer to Figure 73.

Note: Replace fuses as needed.

7. Install the auxiliary panel to the junction box using the 8 bolts removed in step 5 (Figure 73).
8. Install the positive battery cable to the battery.
9. Close the rear hood; refer to Closing the Hood (page 25)

Cooling System Maintenance

Servicing the Cooling System

⚠ DANGER

Rotating shaft and fan can cause personal injury.

- Do not operate the machine without the covers in place.
- Keep fingers, hands and clothing clear of rotating fan and drive shaft.
- Shut off the engine and remove the ignition key before performing maintenance.

Cleaning Cooling System

Service Interval: Every 40 hours—Clean the cooling system.

Clean the cooling system at each scheduled maintenance. Perform the following steps to clean the air inlet screens and engine cooling fins of the cooling system:

1. Wash the machine with soapy water.
2. Rinse off mud and dirt with water.
3. Blow off dirt and debris from the engine with pressurized air (30 psi maximum).

Hydraulic System Maintenance

Replacing the Hydraulic Filter

Removing the Hydraulic Filter

Service Interval: After the first 50 hours—Replace the hydraulic filter.

Every 100 hours—Replace the hydraulic filter or when the hydraulic-filter gauge indicates Caution (yellow) or Service Filter (red).

⚠ DANGER

The breather/cap is designed to pressurize the hydraulic tank to 34.5 kPa (5 psi). Loosen the cap slowly to avoid injury whenever adding fluid or maintaining the hydraulic system.

⚠ CAUTION

Before disconnecting any hydraulic lines, be sure the engine is off and relieve all pressure from the hydraulic system.

Important: Do not substitute an automotive oil filter or severe hydraulic system damage may result.

Note: Refer to Hydraulic-filter Gauge (page 20).

1. Open the rear hood; refer to Opening the Hood (page 24).
2. Bleed the pressure from the hydraulic tank as follows:
 - A. Place a rag over the hydraulic tank breather/cap, and slowly turn the cap counterclockwise to remove the breather/cap (Figure 74).

Note: The tank pressure will vent to the atmosphere.

- B. Install the breather/cap (Figure 74).

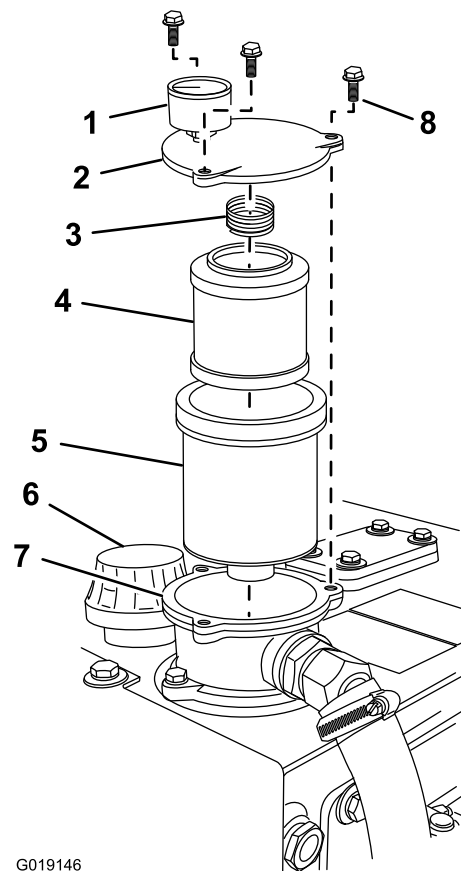

Figure 74

- | | | |
|---------------------------|-------------------|-------------------------|
| 1. Hydraulic-filter gauge | 4. Filter element | 7. Filter housing gauge |
| 2. Filter cover | 5. Filter bowl | 8. Hex-head bolt |
| 3. Spring | 6. Breather/cap | |

⚠ CAUTION

Ensure that the hydraulic-filter gauge indicates 0 kPa (0 psi) before removing the filter cover from the filter housing.

3. Remove the hydraulic filter as follows:
 - A. Remove the 3 hex-head bolts that secure the filter cover to the filter housing (Figure 74).
 - B. Remove the filter cover, spring, filter element, and filter bowl (Figure 74).

Note: Dispose the used filter element at a certified recycling center.

Installing the Hydraulic Filter

1. Install the filter as follows:
 - A. Wipe the filter bowl clean with a clean, lint-free cloth.
 - B. Install the filter bowl into the filter housing Figure 74.
 - C. Apply a thin coat of the specified hydraulic fluid to the surface of the gasket on the new filter element; refer to the hydraulic fluids listed in Changing the Hydraulic Fluid (page 55).
 - D. Install the new filter element into the filter bowl (Figure 74).
 - E. Install the spring (Figure 74).
 - F. Align the filter cover to the filter housing, and align the hydraulic filter gauge adjacent to the breather/cap on the hydraulic tank (Figure 74).
 - G. Thread the 3 hex head screws that were remove in step A of Removing the Hydraulic Filter (page 54) through the filter cover and into the filter housing (Figure 74).
 - H. Torque the screws to 9.9 N-m (7 ft-lb).
2. Check the hydraulic fluid level in the tank; refer to Hydraulic-tank Gauge (page 20).

Note: If the fluid level is low, add hydraulic fluid; refer to Checking the Hydraulic Fluid Level (page 26).

⚠ WARNING

Hydraulic fluid escaping under pressure can penetrate skin and cause injury. Fluid injected into the skin must be surgically removed within a few hours by a doctor familiar with this form of injury or gangrene may result.

- **Keep your body and hands away from pin hole leaks or nozzles that eject high pressure hydraulic fluid.**
 - **Use cardboard or paper to find hydraulic leaks, never use your hands.**
3. Start the engine and check that the hydraulic filter gauge is in the normal range; refer to Starting the Engine—Manual Mode (page 27)
 4. Check that there no hydraulic leaks.
 5. Stop the engine; refer to Emergency Stop—Manual Mode (page 27).
 6. Close the rear hood; refer to Closing the Hood (page 25).

Changing the Hydraulic Fluid

Service Interval: Every 800 hours/Yearly (whichever comes first)—Change the hydraulic fluid.

Hydraulic Fluid Specification:

Note: Use only one of the following fluids in the hydraulic system.

- **Toro Premium Transmission/Hydraulic Tractor Fluid** (refer to your Authorized Toro Dealer for more information)
- **Toro Premium All Season Hydraulic Fluid** (refer to your Authorized Toro Dealer for more information)
- If either of the above Toro fluids are not available, you may use **Mobilfluid 424** multipurpose tractor lubricant .

Important: Always use the correct hydraulic fluid. Unspecified fluids will damage the hydraulic system.

Note: The hydraulic fluid specifications must fall within the listed range for all of the following material properties and the fluid should meet the listed industry standards.

Toro will not assume responsibility for damage caused by improper substitutions, so use only products from reputable manufacturers who will stand behind their recommendations.

Hydraulic Fluid Table

| Material Properties | |
|--|------------------------------------|
| Viscosity, ASTM D445 | cSt at 40° C (104 ° F): 55 to 62 |
| | cSt at 110° C (230° F): 9.1 to 9.8 |
| Viscosity index, ASTM D2270 | 140 to 152 |
| Pour Point, ASTM D97 | -37 to -43° C (-35 to -46° F) |
| Industry Standards | |
| API GL-4, AGCO Powerfluid 821 XL, Ford New Holland FNHA-2-C-201.00, Kubota UDT, John Deere J20C, Vickers 35VQ25 and Volvo WB-101/BM. | |

Note: Many hydraulic fluids are almost colorless, making it difficult to spot leaks. A red dye additive for the hydraulic system oil is available in 20 ml (2/3 fl oz) bottles. One bottle is sufficient for 15 to 22 L (4 to 6 US gallons) of hydraulic oil. Order part no. 44-2500 from your Authorized Toro Dealer.

1. Ensure that the engine and exhaust system is cool.
2. Open the both hoods; refer to Opening the Hood (page 24).
3. Remove the right-side panel; refer to Removing the Right-side Panel (page 57).
4. Drain the hydraulic tank as follows:
 - A. Place a rag over the hydraulic tank breather/cap, and remove the cap.

- B. Place a waste oil container with a 57 L (15 US gallons) capacity under the drain plug at the right-lower side of the hydraulic tank (Figure 77).

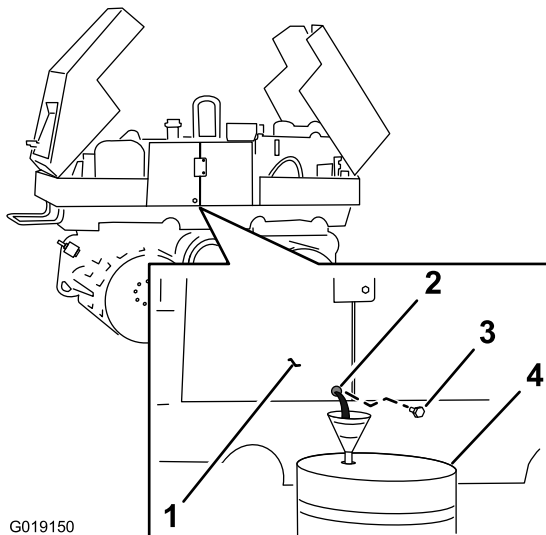

Figure 75

- | | |
|--------------------|------------------------|
| 1. Hydraulic tank | 3. Drain plug |
| 2. Drain-plug hole | 4. Waste-oil container |

- C. Remove the drain plug and allow the hydraulic fluid to drain into the container (Figure 77).

Note: Dispose of the used oil at a certified recycling center.

- D. Clean the drain plug and apply PTFE thread-sealing tape to the threads.
- E. When the hydraulic oil is drained from the tank, install the drain plug in the drain plug hole, and tighten (Figure 77).
5. Fill the hydraulic tank as follows:
- Fill the hydraulic tank with approximately 49 L (13 US gallons) of Toro Premium Transmission/Hydraulic Tractor Fluid or an equivalent; refer to Hydraulic-tank Gauge (page 20).
 - Install the hydraulic tank breather/cap.
 - Start the engine and let it run for a 1 or 2 minutes.
 - Stop the engine and check for hydraulic fluid leaks.
 - Check the hydraulic fluid level. If necessary, add hydraulic fluid until the fluid level indicates a 6.35–12.5 mm (0.25–0.50 inch) air bubble seen at the top of the sight gauge; refer to Checking the Hydraulic Fluid Level (page 26).
6. Install the right-side panel; refer to Installing the Right-side Panel (page 57).
7. Close the both hoods; refer to Closing the Hood (page 25).

Checking the Hydraulic Lines

Service Interval: Every 100 hours—Check the hydraulic lines for leaks, loose fittings, kinked lines, loose mounting supports, wear, weather, and chemical deterioration. (Repair all damaged hydraulic lines before operating the machine.)

Every 1,500 hours/Every 2 years (whichever comes first)—Replace all moving hydraulic hoses.

⚠ WARNING

Hydraulic fluid escaping under pressure can penetrate skin and cause injury. Fluid injected into the skin must be surgically removed within a few hours by a doctor familiar with this form of injury or gangrene may result.

- Keep your body and hands away from pin hole leaks or nozzles that eject high pressure hydraulic fluid.
- Use cardboard or paper to find hydraulic leaks, never use your hands.

Hydraulic and Fuel Tank Access

Installing the Right-side Panel

Removing the Right-side Panel

1. Remove the bolts and washers that secure the front of the right-side panel to the **front-hood rail** (Figure 76).

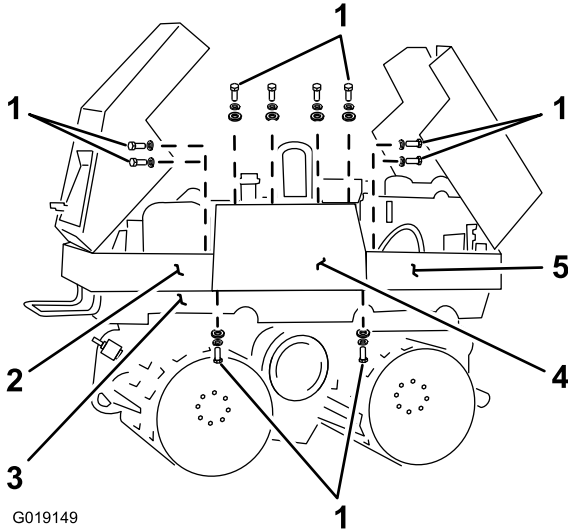

Figure 76

- | | |
|----------------------|---------------------|
| 1. Bolts and washers | 4. Right-side panel |
| 2. Rear hood rail | 5. Front hood rail |
| 3. Upper frame | |

1. Align the right-side panel with the mounting points at the hydraulic tank, fuel tank, upper frame, rear-hood rail, and front-hood rail (Figure 76 and Figure 77).
2. Secure the right-side panel to the **hydraulic tank and fuel tank** with the bolts and washers (Figure 76) removed in step 4 in Removing the Right-side Panel (page 57).
3. Secure the right-side panel to the **front and rear hood rails** with the bolts and washers (Figure 76) removed in steps 1 and 2 in Removing the Right-side Panel (page 57).
4. Secure the right-side panel to the **upper frame** with the bolts and washers (Figure 76) removed in step 3 in Removing the Right-side Panel (page 57).

2. Remove the bolts and washers that secure the back of the right-side panel to the **rear-hood rail** (Figure 76).
3. Remove the bolts and washers that secure the right-side panel to the **upper frame** (Figure 76).
4. Remove the bolts and washers that secure the top of the right-side panel to the **hydraulic tank and fuel tank** (Figure 76).
5. Remove right-side panel from the machine chassis as shown in Figure 77.

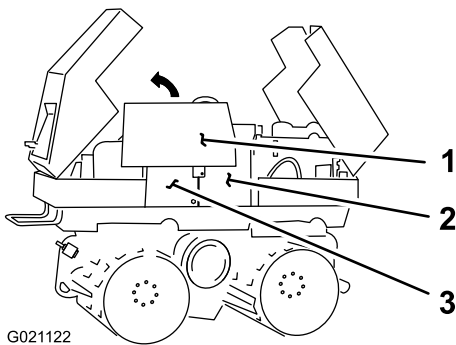

Figure 77

- | | |
|---------------------|-------------------|
| 1. Right-side panel | 3. Hydraulic tank |
| 2. Fuel tank | |

Eccentric Maintenance

Changing the Eccentric Lubricant

Service Interval: Every 350 hours—Change the eccentric lubrication.

Oil Type: Detergent oil (API service SG, SH, SJ, or higher)

Oil Capacity: 235 ml (8 ounce)

Viscosity: SAE 30W

Toro Premium Engine Oil is available from your Authorized Toro Dealer.

Draining the Eccentric Lubrication

1. Locate the hydraulic motor for the eccentric at the right-lower exterior of the machine (Figure 78).

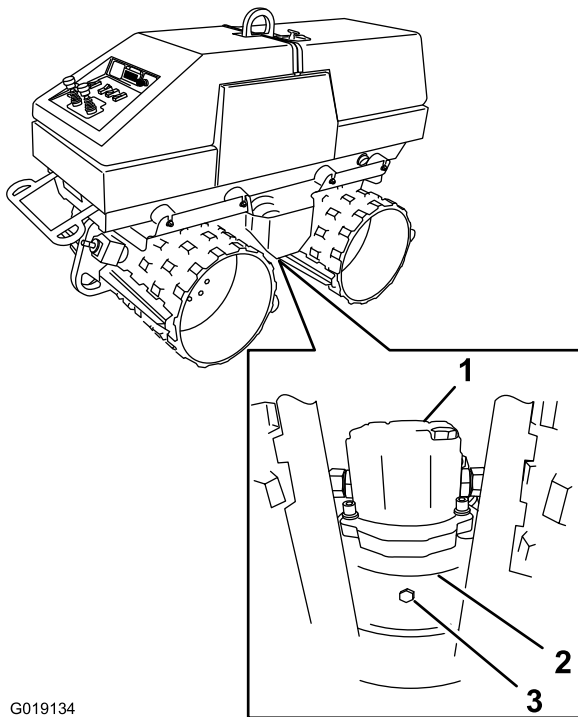

Figure 78

1. Hydraulic motor
2. Eccentric-motor cap
3. Drain plug

2. Locate the eccentric-motor cap on which hydraulic motor mounts (Figure 78).
3. Place a drain pan beneath the eccentric-motor cap.

4. Remove the drain plug from the bottom of the eccentric-motor cap and allow the oil to drain (Figure 78).
5. Clean the drain plug and apply PTFE thread-sealing tape to the threads.
6. Install the drain plug into the drain hole of the eccentric-motor cap (Figure 78).

Filling the Eccentric with Lubricant

1. Locate the eccentric end cap at the left-lower exterior of the machine (Figure 79).

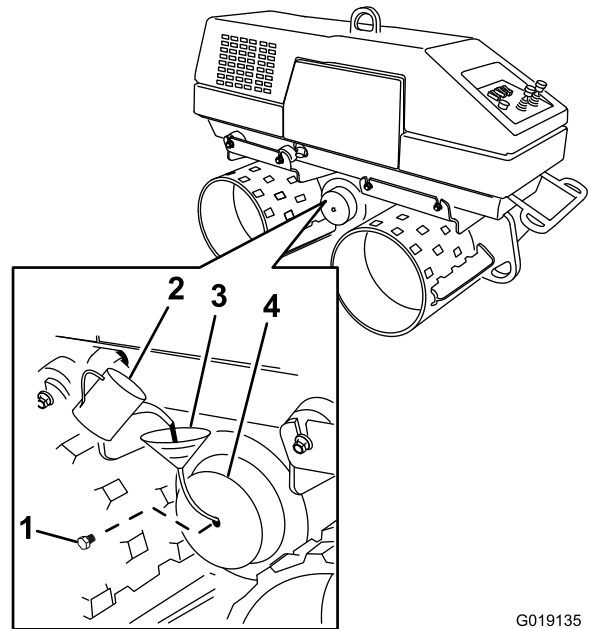

Figure 79

1. Fill plug
2. SAE 30W oil
3. Funnel with attached hose
4. Eccentric end cap

2. Remove the fill plug from the eccentric end cap (Figure 79).
3. Pour 235 ml (8 ounce) of the specified oil into the eccentric oil reservoir through the fill hole as shown in Figure 79.

Note: A funnel with an attached hose is recommended.

4. Clean the fill plug and apply PTFE thread-sealing tape to the threads.
5. Install the fill plug into the fill hole of the end cap (Figure 79).

Cleaning

Removing Debris from the Machine

Service Interval: Before each use or daily

Important: Operating the engine with blocked grill and/or cooling shrouds removed, will result in engine damage from overheating.

1. Park the machine on a level surface, turn the engine off , and remove the key; refer to Starting and Stopping the Engine (page 27).
2. Open the forward and rear hoods and allow the engine to cool; refer to Opening the Hood (page 24).
3. Clean any debris from the front grills.
4. Wipe away debris from the air filter.
5. Clean any dirt and debris on the engine and in the cooling fins with a brush or blower.

Important: It is preferable to blow dirt out, rather than washing it out. If water is used, keep it away from electrical items and hydraulic valves. Do not use a high-pressure washer. High-pressure washing can damage the electrical system and hydraulic valves or deplete grease.

6. Clean debris from the hood opening, muffler, and heat shields.
7. Clean debris from the oil-cooler duct (Figure 6) and the engine-exhaust pipe (Figure 8).
8. Close the hoods; refer to Closing the Hood (page 25).

Cleaning the Chassis

Service Interval: Every 100 hours—Check for accumulation of dirt and debris in the chassis.

Over time, the chassis under the engine collects dirt and debris that must be removed. Using a flashlight, inspect the area under the engine, fuel tank, and hydraulic tank on a regular basis. When the debris is 25–50 mm (1–2 inch) deep, have an Authorized Service Dealer remove the drums and flush the chassis clean.

Storage

1. Park the machine on a level surface, turn the engine off, and remove the key, refer to Starting and Stopping the Engine (page 27).
2. Remove dirt and grime from the entire machine.

Important: You can wash the machine with mild detergent and water. Do not pressure wash the machine. Avoid excessive use of water, especially near the control panel, engine, hydraulic pumps, and motors.

3. Service the air filter; refer to Servicing the Air Filter (page 44).
4. Grease the machine; refer to Greasing the Machine (page 40).
5. Change the engine oil; refer to Checking the Level of the Engine Oil (page 25).
6. Prepare the fuel system as follows:
 - A. Remove the fuel filter/water separator; refer to Removing the fuel filter/water separator (page 46).
 - B. Remove the hex-head plug from the fuel filter/water separator canister; refer to Removing the fuel filter/water separator (page 46).
 - C. Drain the fuel from the canister.
 - D. Install the hex-head plug remove in step B in the fuel filter/water separator canister.
 - E. Install the fuel filter/water separator; refer to Removing the fuel filter/water separator (page 46).
 - F. Drain the fuel tank; refer to Draining the Fuel Tank (page 47).
 - G. Flush the fuel tank with fresh, clean, fresh fuel.
 - H. Secure all fuel system fittings.

7. Charge the battery; refer to Servicing the Battery (page 49).
8. Check and tighten all bolts, nuts, and screws. Repair or replace any part that is damaged.
9. Paint all scratched or bare metal surfaces. Paint is available from your Authorized Service Dealer.
10. Store the machine in a clean, dry garage or storage area. Remove the key from the ignition switch and keep it in a memorable place.
11. Cover the machine to protect it and keep it clean.

Removing the Machine from Storage

1. Check and tighten all fasteners.
2. Perform any needed maintenance procedures; refer to Maintenance (page 39).
3. Check the engine oil level; refer to Checking the Level of the Engine Oil (page 25).
4. Check the hydraulic fluid level; refer to Checking the Hydraulic Fluid Level (page 26).
5. Charge the battery; refer to Servicing the Battery (page 49).
6. Fill the fuel tank with fresh fuel; refer to Filling the Fuel Tank (page 22).

Troubleshooting

| Problem | Possible Cause | Corrective Action |
|--|---|--|
| The starter does not crank. | <ol style="list-style-type: none"> 1. Emergency stop button activated. 2. The battery is discharged. 3. The electrical connections are corroded or loose. 4. A fuse is blown or loose. 5. The relay or switch is damaged. 6. Starter or starter solenoid is damaged. 7. Internal engine components are seized. | <ol style="list-style-type: none"> 1. Reset the emergency stop button. 2. Charge the battery or replace it. Select the mode switch to the manual-mode position when stopping the machine. 3. Clean and tighten the ground terminal. Check the electrical connections for good contact. 4. Correct or replace the fuse. 5. Contact your Authorized Service Dealer. 6. Contact your Authorized Service Dealer. 7. Contact your Authorized Service Dealer. |
| The engine cranks, but will not start. | <ol style="list-style-type: none"> 1. Incorrect starting procedure. 2. The fuel tank is empty. 3. The fuel-shutoff valve is closed. 4. The fuel system is contaminated with dirt, water, stale fuel, or incorrect fuel. 5. Improper fuel grade for cold weather use. 6. Fuel filter is obstructed. 7. There is air in the fuel. 8. The injection nozzles or pump are malfunctioning. 9. Air filter is obstructed. 10. Tip switch is faulty. 11. The engine crankcase has too much oil. 12. Slow cranking speed. 13. Engine RPM is too low. 14. Worn cylinder or piston rings. | <ol style="list-style-type: none"> 1. Refer to Starting and Stopping the Engine. 2. Fill with fresh fuel; Refer to Adding Fuel. 3. Open the fuel-shutoff valve. 4. Drain and flush the fuel system; add fresh fuel. 5. Drain the fuel system and replace the fuel filter. Add fresh fuel of proper grade for ambient temperature conditions. You may need to warm the entire machine. 6. Replace the fuel filter; refer to Servicing the Fuel Filter. 7. Check for air leaks at the fuel hose connections and fittings between the fuel tank and engine; Tighten the fittings or replace damaged hoses. Refer to Priming the Fuel System. 8. Contact your Authorized Service Dealer. 9. Clean or replace the air filter; refer to Servicing the Air filter. 10. Contact your Authorized Service Dealer. 11. Drain to the correct level; refer to Servicing the Engine. 12. Check the battery, oil viscosity, and starting motor (contact your Authorized Service Dealer). 13. Reset to correct value; Contact your Authorized Service Dealer. 14. Replace; Contact your Authorized Service Dealer. |

| Problem | Possible Cause | Corrective Action |
|---|---|---|
| The engine starts, but does not keep running. | <ol style="list-style-type: none"> 1. The fuel tank venting is restricted. 2. Fuel filter is obstructed. 3. Improper fuel grade for cold weather use. 4. There is air in the fuel system. 5. Dirt or water is in the fuel system. 6. The fuel pump is damaged. 7. Engine exhaust is restriction at the exhaust pipe. | <ol style="list-style-type: none"> 1. Loosen the cap. If the engine runs with the cap loosened, replace the cap. 2. Replace; refer to Servicing the Fuel Filter. 3. Drain the fuel system and replace the fuel filter. Add fresh fuel of proper grade for ambient temperature conditions. 4. Check for air leaks at the fuel hose connections and fittings between the fuel tank and engine; Tighten the fittings or replace damaged hoses. Refer to Priming the Fuel System. 5. Drain and flush the fuel system; add fresh fuel. 6. Contact your Authorized Service Dealer. 7. Clean or replace the exhaust pipe. |
| The engine runs, but knocks or misses. | <ol style="list-style-type: none"> 1. The fuel system is contaminated with dirt, water, stale fuel, or incorrect fuel. 2. The engine overheating. 3. There is air in the fuel system. 4. The fuel injection nozzles are damaged. 5. The engine has low compression. 6. The fuel injection pump timing is incorrect. 7. There is excessive carbon build-up in the engine. 8. The engine has internal wear or damage. | <ol style="list-style-type: none"> 1. Drain and flush the fuel system; add fresh fuel. 2. Refer to Engine Overheats. 3. Bleed nozzles and check for air leaks at the fuel hose connections and fittings between the fuel tank and engine. 4. Contact your Authorized Service Dealer. 5. Contact your Authorized Service Dealer. 6. Contact your Authorized Service Dealer. 7. Contact your Authorized Service Dealer. 8. Contact your Authorized Service Dealer. |
| The engine will not idle. | <ol style="list-style-type: none"> 1. The fuel tank venting is restricted. 2. The fuel system is contaminated with dirt, water, stale fuel, or incorrect fuel. 3. The air filter is obstructed. 4. The fuel filter is obstructed. 5. There is air in the fuel. 6. The fuel pump is damaged. 7. The engine has low compression. | <ol style="list-style-type: none"> 1. Loosen the cap. If the engine runs with the cap loosened, replace the cap. 2. Drain and flush the fuel system; add fresh fuel. 3. Clean or replace the air filter; refer to Servicing the Air filter. 4. Replace the fuel filter. 5. Bleed the nozzles and check for air leaks at fuel hose connections and fittings between the fuel tank and engine. 6. Contact your Authorized Service Dealer. 7. Contact your Authorized Service Dealer. |

| Problem | Possible Cause | Corrective Action |
|--|--|--|
| The engine overheats. | <ol style="list-style-type: none"> 1. The cooling air system is restricted. 2. The crankcase oil level is incorrect. 3. The engine experiences excessive load. 4. The fuel system has the incorrect fuel type. 5. Defective injector or injection timing is incorrect. | <ol style="list-style-type: none"> 1. Clean any debris from the front and side grills. Inspect and clean the engine cooling air inlet and outlet, and the cylinder heads and cylinders. 2. Fill or drain to the full mark. 3. Reduce the ground speed; refer to operating the Travel Speed Switch or the Travel Speed Buttons. 4. Drain and flush the fuel system; add fresh fuel. 5. Contact your Authorized Service Dealer. |
| There is excessive black smoke from exhaust. | <ol style="list-style-type: none"> 1. The engine experiences excessive load. 2. Air filter is obstructed. 3. The fuel system has the incorrect fuel type 4. The injection pump timing is incorrect. 5. The injection pump is damaged. 6. The injection nozzles are damaged. | <ol style="list-style-type: none"> 1. Reduce the ground speed; refer to operating the Travel Speed Switch or the Travel Speed Buttons. 2. Clean or replace the air filter; refer to Servicing the Air filter. 3. Drain the fuel system and refill with specified fuel. 4. Contact your Authorized Service Dealer. 5. Contact your Authorized Service Dealer. 6. Contact your Authorized Service Dealer. |
| There is excessive white smoke from exhaust. | <ol style="list-style-type: none"> 1. The engine crankcase has too much oil. 2. The engine has worn valves or valve guides. 3. The oil seat at intake valve is defective. 4. The injection pump timing is incorrect. 5. The fuel injection nozzles are damaged. 6. The engine has low compression. | <ol style="list-style-type: none"> 1. Check the oil level and drain to the full mark. 2. Contact your Authorized Service Dealer. 3. Contact your Authorized Service Dealer. 4. Contact your Authorized Service Dealer. 5. Contact your Authorized Service Dealer. 6. Contact your Authorized Service Dealer. |
| A low oil warning message is indicated in the LED display. | <ol style="list-style-type: none"> 1. The engine crankcase has a low oil level. 2. The oil pressure switch is faulty. | <ol style="list-style-type: none"> 1. Service the engine oil; refer to Checking the Engine Oil Level. 2. Replace the oil pressure switch. |
| The engine consumes an excessive quantity of oil. | <ol style="list-style-type: none"> 1. The engine has worn valves or valve guides. 2. The engine has low compression. 3. The engine crankcase has too much oil. 4. The oil filter or oil pressure switch is loose. 5. The oil drain valve leaking. | <ol style="list-style-type: none"> 1. Contact your Authorized Service Dealer. 2. Contact your Authorized Service Dealer. 3. Check the oil level and drain to the full mark. 4. Tighten the oil filter or pressure switch. 5. Drain the oil and replace the drain valve. |

| Problem | Possible Cause | Corrective Action |
|--|---|--|
| The engine loses power. | <ol style="list-style-type: none"> 1. The engine experiences excessive load. 2. The fuel tank vent is restricted. 3. The fuel system is contaminated with dirt, water, stale fuel, or incorrect fuel. 4. There is air in the fuel system. 5. The injection pump timing is incorrect. 6. The injection pump is damaged. 7. The air filter is dirty. 8. The engine exhaust is restriction at the exhaust pipe. 9. The crankcase oil level is incorrect. 10. The engine is overheating. 11. The engine has low compression. | <ol style="list-style-type: none"> 1. Reduce the ground speed; refer to operating the Travel Speed Switch or the Travel Speed Buttons. 2. Contact your Authorized Service Dealer. 3. Drain and flush the fuel system; add fresh fuel. 4. Bleed the nozzles and check for air leaks at fuel hose connections and fittings between the fuel tank and engine. 5. Contact your Authorized Service Dealer. 6. Contact your Authorized Service Dealer. 7. Clean or replace the air filter; refer to Servicing the Air filter. 8. Clean or replace the exhaust pipe. 9. Fill or drain the oil to the full mark. 10. Refer to Engine Overheats. 11. Contact your Authorized Service Dealer. |
| The machine lacks power. | <ol style="list-style-type: none"> 1. The engine is not warmed up. 2. The hydraulic fluid level is low. 3. The hydraulic filter or strainer is obstructed. 4. The fuel filter is obstructed. 5. The hydraulic manifold is faulty. | <ol style="list-style-type: none"> 1. Run the machine at the slow-engine speed for 5 minutes before machine operation. 2. Add hydraulic fluid; refer to Checking the Hydraulic Fluid Level. 3. Replace the hydraulic filter; refer Replacing the Hydraulic Filter. 4. Replace the fuel filter. 5. Contact your Authorized Service Dealer. |
| The voltage regulator message is indicated in the LED Display. | <ol style="list-style-type: none"> 1. The electrical system is faulty. 2. The battery is not charging. | <ol style="list-style-type: none"> 1. Check all wires and repair. 2. Contact your Authorized Service Dealer. |
| The machine does not drive. | <ol style="list-style-type: none"> 1. The traction control lever not fully engaged. 2. The parking brake is engaged. 3. Rocks or foreign material are wedged between the scraper and drum. 4. The hydraulic fluid level low. 5. The solenoid is faulty in the directional control valve. 6. The hydraulic pump and/or wheel motor is damaged. 7. The relief valve is damaged. | <ol style="list-style-type: none"> 1. Move the traction control lever fully. 2. Release the parking brake. 3. Remove the rocks or material. 4. Add hydraulic fluid to the reservoir. 5. Contact your Authorized Service Dealer. 6. Contact your Authorized Service Dealer. 7. Contact your Authorized Service Dealer. |
| The machine has no high travel speed. | <ol style="list-style-type: none"> 1. The solenoid is faulty in the directional control valve. 2. The check valve is installed backward. 3. The hydraulic manifold is faulty. | <ol style="list-style-type: none"> 1. Contact your Authorized Service Dealer. 2. Contact your Authorized Service Dealer. 3. Contact your Authorized Service Dealer. |
| The drums rotate at different speeds. | <ol style="list-style-type: none"> 1. The check valve is faulty. | <ol style="list-style-type: none"> 1. Contact your Authorized Service Dealer. |

| Problem | Possible Cause | Corrective Action |
|--|--|--|
| The machine has no vibration function. | <ol style="list-style-type: none"> 1. The eccentric support bearing is siezed. 2. The eccentric motor is faulty. 3. The solenoid is faulty in the directional control valve. | <ol style="list-style-type: none"> 1. Contact your Authorized Service Dealer. 2. Contact your Authorized Service Dealer. 3. Contact your Authorized Service Dealer. |
| The machine operates in manual mode, but not in radio-remote control mode. | <ol style="list-style-type: none"> 1. The mode switch is in the manual-mode position. 2. The ignition switch is in the On position. 3. The battery for the radio-control transmitter is faulty. 4. The battery in the machine has low voltage. 5. The operator is using the wrong radio-control transmitter for the machine. 6. The radio-control receiver has no power. | <ol style="list-style-type: none"> 1. Select the mode switch to the remote-control mode position. 2. Rotate the key switch to the Off position, and remove the key. 3. Replace the batteries in the transmitter. 4. Charge or replace the battery in the machine. 5. Compare the serial number on the back of the transmitter with the serial number on the cover of the of the radio-control receiver. 6. Check and replace open (blown) fuse for the receiver power or ground circuit. |
| The machine suddenly stopped when in radio-control mode. | <ol style="list-style-type: none"> 1. The machine is out of range for the remote-control transmitter. 2. The battery in the machine has low voltage. 3. The battery for the radio-control transmitter is faulty. 4. The fuse for the receiver power or ground circuit is open (blown) . 5. The wiring in the machine has an open circuit. | <ol style="list-style-type: none"> 1. Walk toward machine. 2. Charge or replace the battery in the machine. 3. Replace the batteries in the transmitter. 4. Replace the fuse. 5. Check all wires and repair any wiring damage. |
| Not all of the machine functions operate. | <ol style="list-style-type: none"> 1. The radio-control receiver has a possible chip failure. | <ol style="list-style-type: none"> 1. Contact your Authorized Service Dealer. |

Notes:

Notes:



The Toro Warranty

A limited warranty (see warranty periods below)

Conditions and Products Covered

The Toro Company and its affiliate, Toro Warranty Company, pursuant to an agreement between them, jointly warrant your Toro Concrete, Masonry, and Compaction Equipment Products listed below to be free from defects in materials or workmanship.

This warranty covers the cost of parts and labor, but you must pay transportation costs.

The following time periods apply from the date of purchase:

| Products | Warranty Period |
|---------------------------|---------------------------------|
| Concrete Mixers | 1 year |
| • Spindle Bearings | Lifetime* (original owner only) |
| Mortar Mixers | 1 year |
| • Drum Bearings and Seals | Lifetime* (original owner only) |
| Forward Plate Compactors | 2 years |
| Reversible Plates | 1 year |
| Rammer Compactors | 2 years |
| Mud Buggy | 1 year |
| Vibrating Trench Roller | 2 years |
| Concrete Saws | 1 year |
| Masonry Saws | 1 year |
| Power Trowels | 1 year |
| Screeds | 1 year |
| Concrete Vibrators | 1 year |

Where a warrantable condition exists, we will repair the Product at no cost to you including diagnosis, labor, and parts.

*Lifetime Warranty - If the bearing(s) or seal(s) on your mixer fail, it will be replaced under warranty, at no cost for parts or labor.

Instructions for Obtaining Warranty Service

If you think that your Toro Product contains a defect in materials or workmanship, follow this procedure¹:

1. Contact any Authorized Servicing Outlet to arrange service at their dealership. To locate one convenient to you, access our website at www.Toro.com. Select "Where to Buy" and select "Contractor" under product type. You may also call our toll free number below.
2. Bring the product and your proof of purchase (sales receipt) to them.
3. If for any reason you are dissatisfied with the Service Outlet's analysis or with the assistance provided, contact us at:

SWS Customer Care Department
Toro Warranty Company
8111 Lyndale Avenue South
Bloomington, MN 55420-1196
Toll Free: 800-888-9926

¹Toro Authorized Rental Customers who have purchased products directly from Toro and have signed the Toro Rental Customer Agreement have the ability to perform their own warranty work. Please visit Toro's Rental Portal for electronic warranty claim filing procedures or call the toll free number above.

Owner Responsibilities

You must maintain your Toro Product by following the maintenance procedures described in the *Operator's Manual*. Such routine

maintenance, whether performed by a dealer or by you, is at your expense. Parts scheduled for replacement as required maintenance ("Maintenance Parts"), are warranted for the period of time up to the scheduled replacement time for that part. Failure to perform required maintenance and adjustments can be grounds for disallowing a warranty claim.

Items and Conditions Not Covered

Not all product failures or malfunctions that occur during the warranty period are defects in materials or workmanship. This express warranty does not cover the following:

- Product failures which result from the use of non-Toro replacement parts, or from installation and use of add-on, modified, or unapproved accessories
- Product failures which result from failure to perform required maintenance and/or adjustments
- Product failures which result from operating the Product in an abusive, negligent or reckless manner
- Parts subject to consumption through use unless found to be defective. Examples of parts which are consumed, or used up, during normal product operation include, but are not limited to, belts, wipers, spark plugs, tires, filters, gaskets, wear plates, seals, O-rings, drive chains, clutches.
- Failures caused by outside influence. Items considered to be outside influence include, but are not limited to, weather, storage practices, contamination, use of unapproved coolants, lubricants, additives, or chemicals, etc.
- Normal "wear and tear" items. Normal "wear and tear" includes, but is not limited to, worn painted surfaces, scratched decals, etc.
- Any component covered by a separate manufacturer's warranty
- Pickup and delivery charges

General Conditions

Repair by an Authorized Servicing Outlet or Self-Service as an Authorized Rental Customer is your sole remedy under the warranty.

Neither The Toro Company nor Toro Warranty Company is liable for indirect, incidental or consequential damages in connection with the use of the Toro Products covered by this warranty, including any cost or expense of providing substitute equipment or service during reasonable periods of malfunction or non-use pending completion of repairs under this warranty. All implied warranties of merchantability and fitness for use are limited to the duration of this express warranty. Some states do not allow exclusions of incidental or consequential damages, or limitations on how long an implied warranty lasts, so the above exclusions and limitations may not apply to you.

This warranty gives you specific legal rights, and you may also have other rights which vary from state to state.

Except for the engine warranty coverage and the Emissions warranty referenced below, if applicable, there is no other express warranty. The Emissions Control System on your Product may be covered by a separate warranty meeting requirements established by the U.S. Environmental Protection Agency (EPA) or the California Air Resources Board (CARB). Refer to the California Emission Control Warranty Statement supplied with your Product or contained in the engine manufacturer's documentation for details.

Countries Other than the United States or Canada

Customers who have purchased Toro products outside the United States or Canada should contact their Toro Distributor (Dealer) to obtain guarantee policies for your country, province, or state. If for any reason you are dissatisfied with your Distributor's service or have difficulty obtaining guarantee information, contact the Toro importer. If all other remedies fail, you may contact us at Toro Warranty Company.

Australian Consumer Law: Australian customers will find details relating to the Australian Consumer Law either inside the box or at your local Toro Dealer.