



# Electric Hose Reel Kit

## Multi Pro WM Turf Sprayer

Model No. 41243—Serial No. 31400001 and Up

### Operator's Manual

## Introduction

Read this manual carefully to learn how to operate and maintain your product properly. The information in this manual can help you and others avoid injury and product damage. Although Toro designs and produces safe products, you are responsible for operating the product properly and safely.

You may contact Toro directly at [www.Toro.com](http://www.Toro.com) for product and accessory information, help finding a dealer, or to register your product.

Whenever you need service, genuine Toro parts, or additional information, contact an Authorized Service Dealer or Toro Customer Service and have the model and serial numbers of your product ready. Figure 1 illustrates the location of the model and serial numbers on the product.

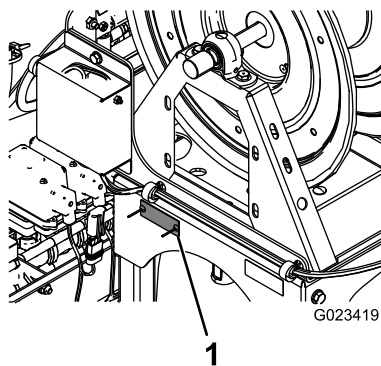

Figure 1

1. Model and serial number plate

Model No. _____
Serial No. _____

### ⚠ WARNING

#### CALIFORNIA Proposition 65 Warning

**This product contains a chemical or chemicals known to the State of California to cause cancer, birth defects, or reproductive harm.**

**Use of this product may cause exposure to chemicals known to the State of California to cause cancer, birth defects, or other reproductive harm.**

**Note:** This product complies with all relevant European directives; for details, please see the separate product specific Declaration of Conformity (DOC) sheet.

Determine the left and right sides of the machine from the normal operating position.

**Important:** Teflon® tape is required for the installation of this kit. The tape is used to wrap threads of fittings before assembly. Threads should be wrapped starting at the base and traveling to the tip of fitting to ensure a waterproof seal.

**Important:** You will need a non-petroleum-based lubricant, such as vegetable oil, to install this kit.

## Safety

Improper use or maintenance by the operator or owner can result in injury. To reduce the potential for injury, comply with these safety instructions and always pay attention to the safety alert symbol, which means Caution, Warning, or Danger—personal safety instruction. Failure to comply with the instruction may result in personal injury or death.

Read also the safety and operation instructions in the vehicle *Operator's Manual*.

- Do not aim the hand sprayer at any person or animal. Fluids under high pressure can penetrate skin and cause severe injury, possibly resulting in amputation or death. Hot liquids and chemicals can also cause burns or injury.



If any part of the body comes in contact with the spray stream, immediately consult a physician familiar with injected fluid injuries.

- Do not place your hand or any other part of your body in front of the spray nozzle.
- Do not leave the equipment under pressure when you are not present.
- Do not use the hand sprayer if the hose, trigger lock, nozzle, or any other part is damaged or missing.
- Do not use the hand sprayer if there are any leaks in any hoses, fittings, or other components.
- Do not spray near power lines.
- Do not drive while spraying with a hand sprayer.
- Wear rubber gloves, safety goggles, and a full body protective suit when spraying chemicals with the hand sprayer.
- Lightning can cause severe injury or death. If lightning is seen or thunder is heard in the area, do not operate the machine; seek shelter.

## **⚠ CAUTION**

**Chemicals are hazardous and can cause personal injury.**

- **Read the directions on the chemical labels before handling the chemicals and follow all manufacturer recommendations and precautions.**
- **Keep chemicals away from your skin. Should contact occur, wash the affected area thoroughly with soap and clean water.**
- **Wear goggles and any other protective equipment recommended by the chemical manufacturer.**

## **Safety and Instructional Decals**



Safety decals and instructions are easily visible to the operator and are located near any area of potential danger. Replace any decal that is damaged or lost.

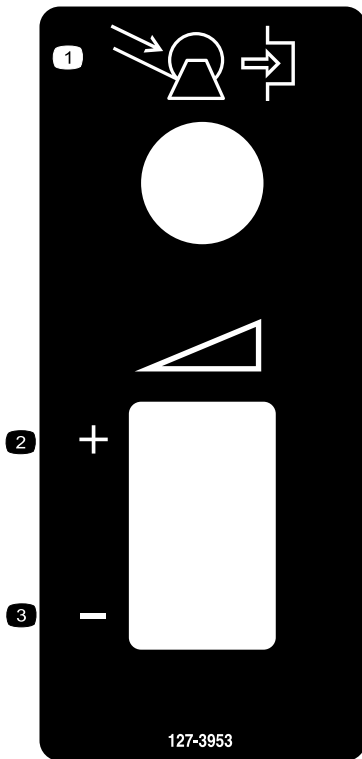

**127-3953**

1. To retract the hose reel, engage the button.
2. Increase spray rate
3. Decrease spray rate

# Setup

## Loose Parts

Use the chart below to verify that all parts have been shipped.

Procedure	Description	Qty.	Use
<b>1</b>	No parts required	–	Prepare the machine.
<b>2</b>	Hose-reel frame Shoulder bolt Flange nut (5/16 inch) Bolt (5/16 inch) Jam nut Hose-reel base Long bolt (3/8 inch) Flange nut (3/8 inch)	2 4 4 2 2 1 4 4	Install the hose-reel frame.
<b>3</b>	Wire harness Switch box Swivel plate Bolt (5/6 inch) Flange nut (5/16 inch) Thrust washer Snap ring Hose reel Spray-gun bracket Carriage bolt Flange nut (5/16 inch) Short bolt (3/8 inch) Small washer Flange nut (3/8 inch) Spring pin Large washer	1 1 1 2 2 1 1 1 1 2 2 4 4 4 1 1	Install the switch box and hose reel.
<b>4</b>	Control valve Pressure gauge T-fitting O-ring Long bolts Hose-reel supply hose Hose clamp Supply-hose valve Cable tie R-clamp	1 1 1 1 4 1 4 1 3 1	Install the control valve.
<b>5</b>	Long hose with fitting Spray gun Small hose clamp	1 1 1	Connect the spray hose.

# 1

## Preparing the Machine

### No Parts Required

#### Procedure

1. Ensure that the machine is empty of all fluids.

**Note:** If chemicals have been used in the machine, flush the system thoroughly with clean water; refer to your vehicle *Operator's Manual* for instructions.

2. Park the machine on a flat area, set the parking brake, stop the pump, stop the engine, and remove the ignition key.
3. Disconnect the negative battery terminal from the battery.

# 2

## Installing the Hose-reel Frame

### Parts needed for this procedure:

2	Hose-reel frame
4	Shoulder bolt
4	Flange nut (5/16 inch)
2	Bolt (5/16 inch)
2	Jam nut
1	Hose-reel base
4	Long bolt (3/8 inch)
4	Flange nut (3/8 inch)

#### Procedure

1. Mount the 2 hose-reel frames to the side of the machine using 4 shoulder bolts and 4 flange nuts (5/16 inch) as shown in Figure 2.

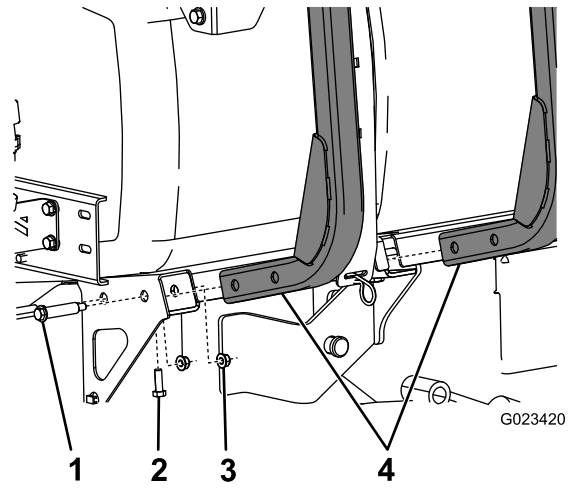

Figure 2

1. Shoulder bolt
2. Bolt (5/16 inch)
3. Flange nut (5/16 inch)
4. Hose-reel frames

2. Secure the underside of the hose-reel frames to the machine using 2 bolts (5/16 inch) and 2 jam nuts (Figure 2).
3. Lower the hose-reel base onto the hose-reel frames, and secure them with 4 long bolts (3/8 inch) and 4 flange nuts (3/8 inch) as shown in Figure 3.

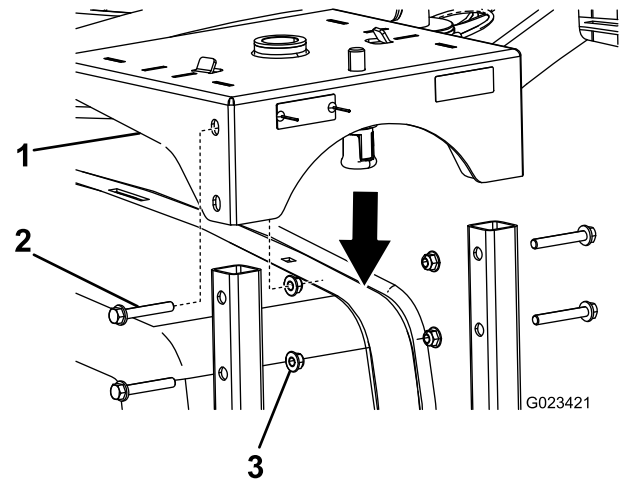

Figure 3

1. Hose-reel base
2. Long bolt (3/8 inch)
3. Flange nut (3/8 inch)

# 3

## Installing the Switch Box and Hose Reel

### Parts needed for this procedure:

1	Wire harness
1	Switch box
1	Swivel plate
2	Bolt (5/6 inch)
2	Flange nut (5/16 inch)
1	Thrust washer
1	Snap ring
1	Hose reel
1	Spray-gun bracket
2	Carriage bolt
2	Flange nut (5/16 inch)
4	Short bolt (3/8 inch)
4	Small washer
4	Flange nut (3/8 inch)
1	Spring pin
1	Large washer

### Procedure

1. Route the wire harness up through the hole in the bottom of the switch box.
2. Moving down the wire harness, connect the harness to the rate switch, the hose-reel button, and the power relay (Figure 4).

**Note:** The fuse for the hose-reel motor is located in the switch box.

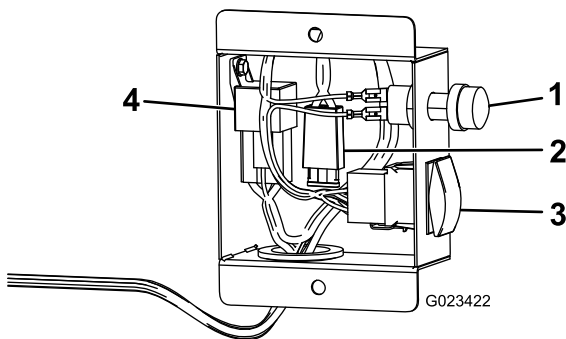

Figure 4

1. Hose-reel button
2. Fuse
3. Rate switch
4. Power relay

3. Drop the swivel plate into the hole on the hose-reel base.
4. On the underside of the hose-reel frame, attach the thrust washer and snap ring to the post on the swivel plate (Figure 5).

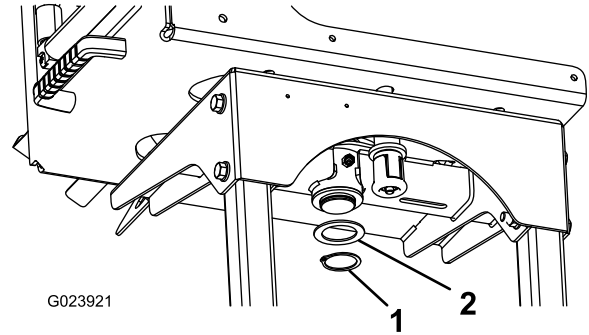

Figure 5

1. Thrust washer
2. Snap ring

5. Mount the switch box to the swivel plate using 2 bolts (5/16 inch) and 2 flange nuts (5/16 inch) as shown in Figure 6.

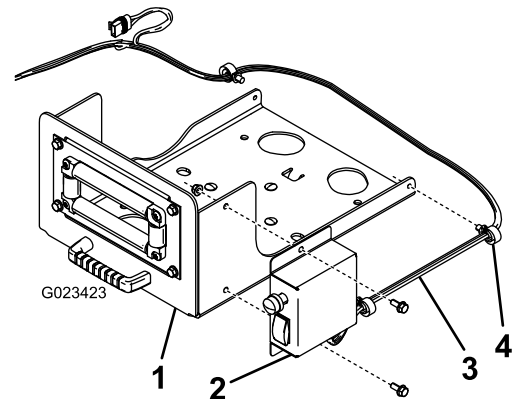

Figure 6

1. Swivel plate
2. Switch box
3. Wiring harness
4. Wiring-harness clip

6. Secure the wiring harness to the sides of the swivel plate using the existing clips (Figure 6).
7. Secure the hose reel to the swivel plate using 4 short bolts (3/8 inch), 4 small washers, and 4 flange nuts (3/8 inch) as shown in Figure 7.

**Note:** The hose-reel motor should face away from the switch panel.

# 4

## Installing the Control Valve

### Parts needed for this procedure:

1	Control valve
1	Pressure gauge
1	T-fitting
1	O-ring
4	Long bolts
1	Hose-reel supply hose
4	Hose clamp
1	Supply-hose valve
3	Cable tie
1	R-clamp

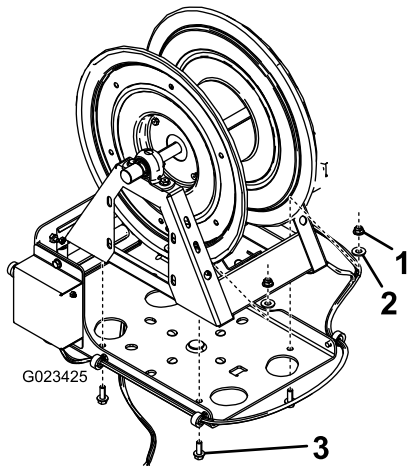

Figure 7

1. Flange nut (3/8 inch)
2. Small washer
3. Short bolt (3/8 inch)

8. Install the large washer and spring pin to the underside of the hose-reel frame (Figure 8).

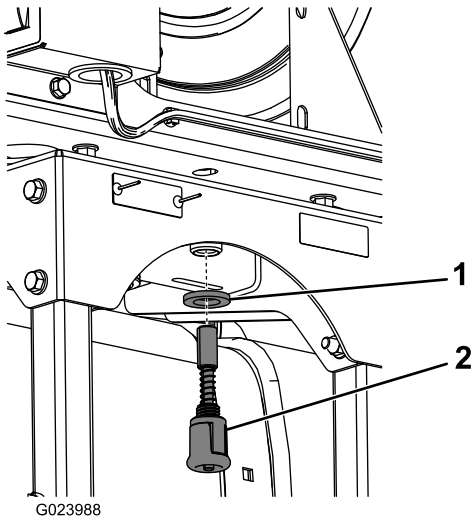

Figure 8

1. Large washer
2. Spring pin

9. Connect the remaining wiring harness plugs to the motor, the main harness power, and the hose reel kit plugs.

### Procedure

1. Disconnect the pressure transducer wire from the pressure-gauge port.
2. Remove the 4 long bolts securing the pressure-gauge port to the boom valves and discard them (Figure 9). Retain the flat washers and nuts.

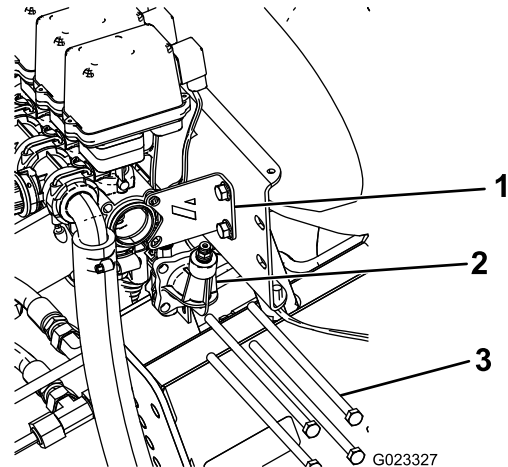
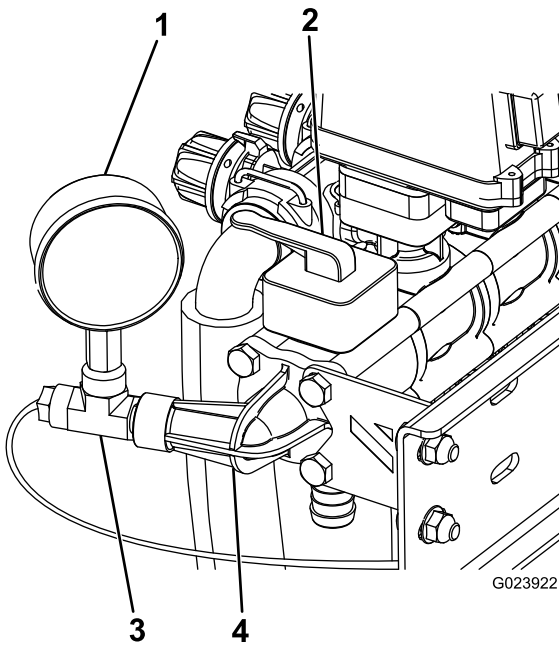

Figure 9

1. Stabilizing bracket
2. Pressure-gauge port
3. Long bolt

3. Remove and retain the 2 bolts and nuts securing the stabilizing bracket to the valve assembly (Figure 9).
4. Install the O-ring, the new control valve, and the previously removed pressure-gauge port, and stabilizing bracket using 4 long bolts; refer to Figure 10.



**Figure 10**

- 1. Pressure gauge
- 2. Control valve
- 3. T-fitting
- 4. Pressure-gauge port

5. Connect the T-fitting to the pressure-gauge port (Figure 10).
6. Connect the pressure gauge to the T-fitting (Figure 10).
7. Connect the pressure transducer wire to the T-fitting.
8. Connect the hose-reel supply hose to the control valve using a hose clamp.
9. Secure the R-clamp to the rear stabilizing bracket using the existing bolt and nut (Figure 11).

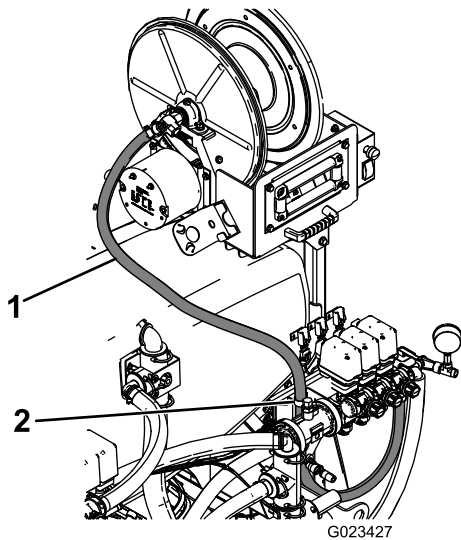
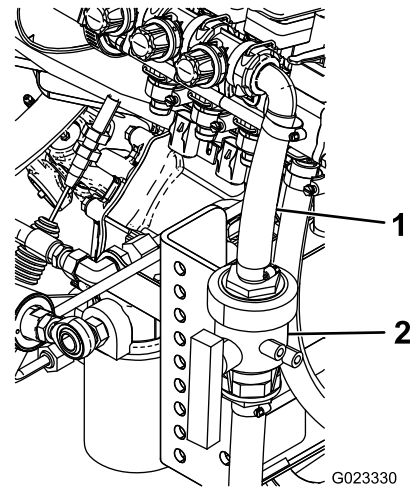

**Figure 11**

- 1. Hose-reel supply hose
- 2. R-clamp

10. Route the hose-reel supply hose through the R-clamp, and attach it to the hose reel with a hose clamp.

11. Secure the wire harness to the hose-reel supply hose using 3 cable ties.
12. From the top of the tank-supply hose, measure down 13 cm (5 inches) and cut the hose.
13. Connect the 2 hose ends to the supply hose valve using 2 hose clamps (Figure 12).



**Figure 12**

- 1. Tank-supply hose
- 2. Supply-hose valve

# 5

## Connecting the Spray Hose

### Parts needed for this procedure:

1	Long hose with fitting
1	Spray gun
1	Small hose clamp

### Procedure

1. Wrap Teflon® tape around the threads of the hose fitting on the long hose, and install the fitting into the connecting tube on the reel (Figure 13).

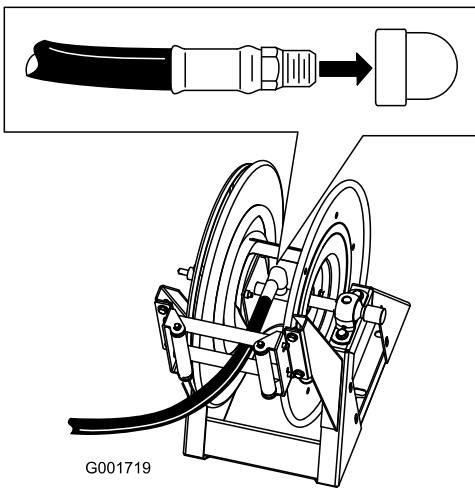

Figure 13

2. Connect the free end of the long hose to the fitting on the spray gun (Figure 14).

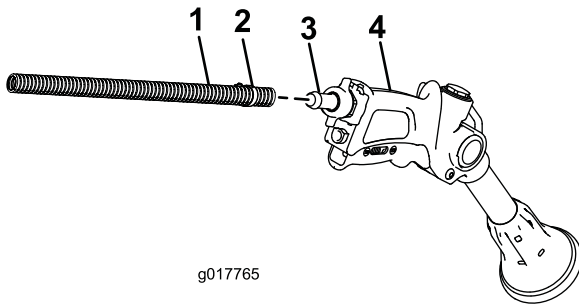

Figure 14

- |               |              |
|---------------|--------------|
| 1. Hose       | 3. Barb      |
| 2. Hose clamp | 4. Spray gun |

3. Secure the end of the hose with a small hose clamp.
4. Connect the negative battery wire to the battery.
5. Press the hose wind button, and carefully guide the hose onto the reel moving the hose from side to side to evenly distribute the hose.

### ⚠ CAUTION

Hands, loose clothing, long hair, and jewelry could get caught in the hose and reel while rewinding and cause injury.

- Keep your hands clear of the reel and hose while it is rewinding.
- Do not wear loose clothing or jewelry and tie up long hair.

## Operation

### ⚠ WARNING

Fluid under pressure can penetrate skin and cause injury.

- Keep your body and hands away from nozzles that eject high-pressure fluid.
- Do not aim the sprayer at any person or animal.
- Make sure that all fluid hoses and lines are in good condition and that all connections and fittings are tight before applying pressure to the system.
- Use cardboard or paper to find leaks.
- Safely relieve all pressure in the system before performing any work on it.
- Get immediate medical help if fluid is injected into skin.
- Hot liquids and chemicals can cause burns or other harm.

**Important:** Always empty and clean the sprayer immediately after each use. Failure to do so may cause the chemicals to dry or thicken in the lines, clogging the pump and other components.

Clean the spray system after **each** spraying session. To properly clean the spray system:

- Use 3 separate rinses.
- Use a minimum of 189 L (50 gallons) for each rinse.
- Use the cleaners and neutralizers as recommended by the chemical manufacturers.
- Use pure, clean water (no cleaners or neutralizers) for the **last** rinse.

## Switching from Boom-spray Mode to Hand-spray Mode

1. Stop the machine, turn the booms off, and set the parking brake.

### ⚠ WARNING

Driving while using the hand sprayer can cause loss of control, resulting in injury or death. Do not operate the hand sprayer while driving.

2. At the back of the machine, ensure that the trigger lock on the spray gun is locked.
3. Flip the lever on the control valve to the Open position.
4. At the operator's position, turn the pump on.
5. Switch the master boom to the On position.

6. Set the engine to the desired speed, then engage the neutral engine-speed lock.

**Important:** Do not use a pressure setting higher than 1034 kPa (150 psi) with the hand sprayer.

routine (refer to your sprayer *Operator's Manual*). Failure to properly clean the spray gun may degrade the performance and reliability of the hose reel kit and spray gun.

7. Use the rate switch to set the desired pressure.

## Spraying with the Hand Sprayer

1. Pull out the desired amount of hose from the reel.

**Important:** Do not pull the hose with the spray gun. Always hold the hose and pull on it directly. Pulling on the hose with the gun may break the fitting on the gun or damage the hose.

2. Release the trigger lock.
3. Direct the spray gun nozzle at the area to be sprayed and pull the trigger.
4. Release the trigger and set the trigger lock when you are finished.

## Switching from Hand-spray Mode to Boom-spray Mode

1. Press the rewind button on the hose reel until only a few feet of hose is out of the reel.

**Note:** The hose-reel rewind button can only be used when the supervisor key on the sprayer console is in the Unlocked position.

### **⚠ CAUTION**

Hands, loose clothing, long hair, and jewelry could get caught in the hose and reel while rewinding and cause injury.

- Keep your hands clear of the reel and hose while it is rewinding.
  - Do not wear loose clothing or jewelry and tie up long hair.
2. Flip the lever on the control valve to the Closed position.
  3. Direct the spray gun nozzle at an area where it is safe to spray, release the trigger lock, and pull the trigger until all remaining fluid is out of the hose, then set the trigger lock.
  4. Return the spray gun to the holder on the back of the reel.
  5. Return the engine to idle speed.
  6. Stop the pump.

**Important:** Ensure that you flush the spray gun with fresh clean water during your daily cleaning

**Notes:**

**Notes:**



# The Toro Total Coverage Guarantee

## A Limited Warranty

### Conditions and Products Covered

The Toro Company and its affiliate, Toro Warranty Company, pursuant to an agreement between them, jointly warrant your Toro Commercial product ("Product") to be free from defects in materials or workmanship for two years or 1500 operational hours\*, whichever occurs first. This warranty is applicable to all products with the exception of Aerators (refer to separate warranty statements for these products). Where a warrantable condition exists, we will repair the Product at no cost to you including diagnostics, labor, parts, and transportation. This warranty begins on the date the Product is delivered to the original retail purchaser.

\* Product equipped with an hour meter.

### Instructions for Obtaining Warranty Service

You are responsible for notifying the Commercial Products Distributor or Authorized Commercial Products Dealer from whom you purchased the Product as soon as you believe a warrantable condition exists. If you need help locating a Commercial Products Distributor or Authorized Dealer, or if you have questions regarding your warranty rights or responsibilities, you may contact us at:

Toro Commercial Products Service Department  
Toro Warranty Company  
8111 Lyndale Avenue South  
Bloomington, MN 55420-1196  
952-888-8801 or 800-952-2740  
E-mail: commercial.warranty@toro.com

### Owner Responsibilities

As the Product owner, you are responsible for required maintenance and adjustments stated in your *Operator's Manual*. Failure to perform required maintenance and adjustments can be grounds for disallowing a warranty claim.

### Items and Conditions Not Covered

Not all product failures or malfunctions that occur during the warranty period are defects in materials or workmanship. This warranty does not cover the following:

- Product failures which result from the use of non-Toro replacement parts, or from installation and use of add-on, or modified non-Toro branded accessories and products. A separate warranty may be provided by the manufacturer of these items.
- Product failures which result from failure to perform recommended maintenance and/or adjustments. Failure to properly maintain your Toro product per the Recommended Maintenance listed in the *Operator's Manual* can result in claims for warranty being denied.
- Product failures which result from operating the Product in an abusive, negligent, or reckless manner.
- Parts subject to consumption through use unless found to be defective. Examples of parts which are consumed, or used up, during normal Product operation include, but are not limited to, brake pads and linings, clutch linings, blades, reels, rollers and bearings (sealed or greasable), bed knives, spark plugs, castor wheels and bearings, tires, filters, belts, and certain sprayer components such as diaphragms, nozzles, and check valves, etc.
- Failures caused by outside influence. Conditions considered to be outside influence include, but are not limited to, weather, storage practices, contamination, use of unapproved fuels, coolants, lubricants, additives, fertilizers, water, or chemicals, etc.
- Failure or performance issues due to the use of fuels (e.g. gasoline, diesel, or biodiesel) that do not conform to their respective industry standards.

### Countries Other than the United States or Canada

Customers who have purchased Toro products exported from the United States or Canada should contact their Toro Distributor (Dealer) to obtain guarantee policies for your country, province, or state. If for any reason you are dissatisfied with your Distributor's service or have difficulty obtaining guarantee information, contact the Toro importer.

- Normal noise, vibration, wear and tear, and deterioration.
- Normal "wear and tear" includes, but is not limited to, damage to seats due to wear or abrasion, worn painted surfaces, scratched decals or windows, etc.

### Parts

Parts scheduled for replacement as required maintenance are warranted for the period of time up to the scheduled replacement time for that part. Parts replaced under this warranty are covered for the duration of the original product warranty and become the property of Toro. Toro will make the final decision whether to repair any existing part or assembly or replace it. Toro may use remanufactured parts for warranty repairs.

### Deep Cycle and Lithium-Ion Battery Warranty:

Deep cycle and Lithium-Ion batteries have a specified total number of kilowatt-hours they can deliver during their lifetime. Operating, recharging, and maintenance techniques can extend or reduce total battery life. As the batteries in this product are consumed, the amount of useful work between charging intervals will slowly decrease until the battery is completely worn out. Replacement of worn out batteries, due to normal consumption, is the responsibility of the product owner. Battery replacement may be required during the normal product warranty period at owner's expense. Note: (Lithium-Ion battery only): A Lithium-Ion battery has a part only prorated warranty beginning year 3 through year 5 based on the time in service and kilowatt hours used. Refer to the *Operator's Manual* for additional information.

### Maintenance is at Owner's Expense

Engine tune-up, lubrication, cleaning and polishing, replacement of filters, coolant, and completing recommended maintenance are some of the normal services Toro products require that are at the owner's expense.

### General Conditions

Repair by an Authorized Toro Distributor or Dealer is your sole remedy under this warranty.

**Neither The Toro Company nor Toro Warranty Company is liable for indirect, incidental or consequential damages in connection with the use of the Toro Products covered by this warranty, including any cost or expense of providing substitute equipment or service during reasonable periods of malfunction or non-use pending completion of repairs under this warranty. Except for the Emissions warranty referenced below, if applicable, there is no other express warranty. All implied warranties of merchantability and fitness for use are limited to the duration of this express warranty.**

Some states do not allow exclusions of incidental or consequential damages, or limitations on how long an implied warranty lasts, so the above exclusions and limitations may not apply to you. This warranty gives you specific legal rights, and you may also have other rights which vary from state to state.

### Note regarding engine warranty:

The Emissions Control System on your Product may be covered by a separate warranty meeting requirements established by the U.S. Environmental Protection Agency (EPA) and/or the California Air Resources Board (CARB). The hour limitations set forth above do not apply to the Emissions Control System Warranty. Refer to the Engine Emission Control Warranty Statement supplied with your product or contained in the engine manufacturer's documentation for details