

TORO®MODEL NO. 38310-1000001 thru
9000001 & UP**OPERATOR'S
MANUAL****POWER SHOVEL****Safety Instructions**

To assure maximum safety, optimum performance, and to gain knowledge of the product, it is essential that you or any other operator of the Power Shovel read and understand the contents of this manual before the motor is ever started. Pay particular attention to the safety alert symbol which means CAUTION, WARNING, or DANGER — "Personal safety instructions." Read and understand the instruction because it has to do with safety. Failure to comply with the instruction may result in personal injury.

The Power Shovel is designed and tested to offer reasonably safe service; however failure to operate it in accordance with the following Safety Instructions MAY RESULT IN PERSONAL INJURY.

BEFORE OPERATING

1. Read and understand the contents of this manual before operating the machine. Become familiar with all controls and know how to stop quickly.
2. Keep everyone, especially children and pets, away from area of operation. Never allow children to operate the Power Shovel.
3. Inspect area thoroughly where the Power Shovel will be used. Remove door

mats, sleds, boards, sticks, wire and any other foreign objects which might be picked up and thrown by the Power Shovel.

4. Inspect the Power Shovel. If any portion of the Power Shovel, including decals, is defective or damaged, repair or replace it before operation is commenced. Also, tighten any loose nuts, bolts and screws.

5. Wear adequate winter clothing and boots that will help provide secure footing on slippery surfaces. Do not wear loose fitting clothing that could possibly get caught in moving parts.

6. Do not use the Power Shovel on gravel or crushed rock surfaces unless used in accordance with Operator's Instructions; refer to page 6, item 5.

7. To prevent electric shock, use only an approved extension cord, suitable for outdoor use in cold temperatures. Replace damaged extension cord immediately.

WHILE OPERATING

8. Keep people and pets a safe distance away from the Power Shovel and the area of operation.
9. Avoid accidental starting. Do not insert key until after Power Shovel is plugged in; also, remove key before carrying plugged-in unit.

COPYRIGHT © ALL RIGHTS RESERVED

The Toro Company — 1980, Rev. 1981, 1982, 1983, 1984, 1985, 1986, 1987, 1988
MINNEAPOLIS, MN 55420 — U.S.A.

Safety Instructions

10. If cord is damaged in any manner while plugged in, pull extension cord from wall receptacle and replace the cord.

11. Do not abuse cord. Never carry the Power Shovel by the cord or pull sharply on cord to disconnect from receptacle. Keep cord away from heat, oil and sharp edges.

12. Operate the Power Shovel only when there is good visibility or light. Always maintain secure footing and balance and keep a firm grip on the handle. **DO NOT USE THE POWER SHOVEL ON A ROOF.**

13. Be attentive when using the Power Shovel, and stay alert for holes in the terrain and other hidden hazards.

14. **STAY AWAY FROM DISCHARGE OPENING WHILE OPERATING THE POWER SHOVEL.** Keep face, hands, feet and any other part of your body or clothing away from concealed, moving or rotating parts.

15. Never operate the Power Shovel near bystanders, glass enclosures, automobiles and trucks, window wells or a dropoff without proper adjustment of the snow discharge angle; refer to Operating Tips, page 5, item 2.

16. If a solid object is hit or the Power Shovel vibrates abnormally, stop the Power Shovel and wait for all movement to stop. Disconnect extension cord and check the Power Shovel immediately for possible damage, an obstruction or loose parts. Vibration is generally a warning of trouble. Repair any damage before operating the Power Shovel again.

17. Disconnect cord from receptacle and remove key from handle if the Power Shovel will be left unattended.

18. Before unclogging the discharge area, cleaning, inspecting or repairing, stop the Power Shovel and wait for all moving parts to stop. Also, disconnect cord from receptacle to prevent accidental starting.

MAINTAINING POWER SHOVEL

19. Perform only those maintenance instructions described in this manual. Disconnect cord from receptacle before performing maintenance procedures to prevent possibility of accidental starting. If major repairs are ever needed, contact the local Authorized TORO Service Dealer for assistance.

20. Keep the Power Shovel in safe operating condition by keeping nuts, bolts and screws tight. Check all fasteners frequently to assure they are tight.

21. Store the Power Shovel indoors when not in use in a dry, safe place out of the reach of children. Keep extension cord with the Power Shovel to prevent misplacement and remove key from handle.

22. At the time of manufacture, the Power Shovel conforms with or exceeds safety standards in effect for electric snow movers. Therefore, to assure optimum performance and safety, purchase genuine TORO replacement parts and accessories to keep the TORO all TORO. **NEVER USE "WILL FIT" ACCESSORIES.** The Toro logo assures that replacement parts are genuine.

Operating Instructions

PREPARATION

Tie the extension cord to the Power Shovel cord (Fig. 4) before connecting the two components to prevent separation during operation.

Then insert the extension cord into wall outlet and insert key into key hole located on the front side of the control grip (Fig. 4).

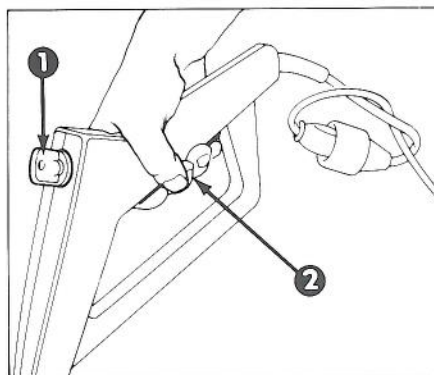

Figure 4

- 1. Key
- 2. Switch Bar



CAUTION
Use only an extension cord suitable for outdoor use in cold temperatures.



WARNING

Disconnect the unit before inspecting, unclogging and cleaning the discharge area to prevent accidental starting. Accidental starting could cause personal injury.

OPERATING TIPS

1. Start the Power Shovel and tilt forward until the scraper blade contacts the ground. Push the Power Shovel forward at a rate of speed comfortable for the operator yet slow enough to clear path completely. The width and depth of the snow may govern the speed of travel.
2. Direct the snow to the right or left by holding the Power Shovel at a slight angle (Fig. 5).

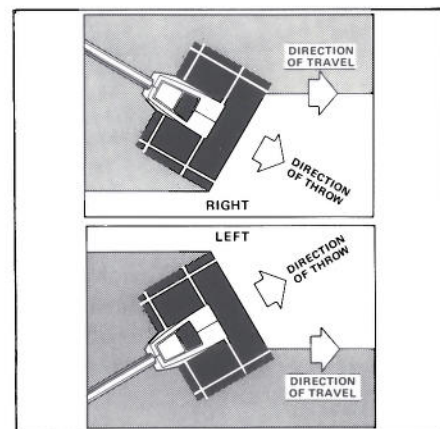

Figure 5

STARTING/STOPPING

To start the Power Shovel, install the key and squeeze the switch bar; to stop, release the switch bar. (Fig. 4).

The Power Shovel comes equipped with a thermal overload switch designed to shut the unit off temporarily in the event of a current overload or excessive temperature. After a short cool down period, the unit will automatically reset and restart if the switch bar is again depressed.

3. For the most efficient snow removal, throw the snow down wind, slightly overlapping each swath.
4. Keep the area to be cleaned clear of stones, toys or other foreign objects which may be picked up and thrown. Such items could be covered by snowfall and therefore be unnoticed until struck by the rotor. Always be sure to keep children and pets away from the area of operation.

Operating Instructions

5. Should you find it necessary to clear snow from over crushed rock or gravel, push down on the handle to raise the scraper clear of loose material that could be thrown.
6. The Power Shovel is designed to remove snow up to 4" deep in one pass. When clearing deeper drifts, hold the unit by the upper control grip and the center handle grip and use a swinging or sweeping motion. Remove a maximum of 4" with each pass and repeat as many times as is required.
7. Keep the cord clear of obstructions, sharp objects and rotor. Do not pull sharply on the cord or abuse it in any manner. Frequently inspect the cord; if damaged, replace.
8. Remove the key and disconnect the extension cord when through using the Power Shovel. Do not misplace the key; store for safe keeping. Hang the Power Shovel by the control grip using a nail and the hole in the rear of the control grip. Hang the extension cord with the Power Shovel so it will not be misplaced or possibly damaged.

Maintenance



CAUTION

To prevent accidental starting of the Power Shovel while performing maintenance, disconnect extension cord and remove key from handle.

LUBRICATION

The Power Shovel does not require lubrication.

REPLACING ROTOR

A worn rotor can be replaced by using the following procedure:

1. Remove the rotor pin, locknut and washer using a 9/16" open end wrench and a 9/16" socket (Fig. 6).
2. Remove the locknut and washer from the opposite end (Fig. 6).
3. Remove the rotor and felt washer (Fig. 6).

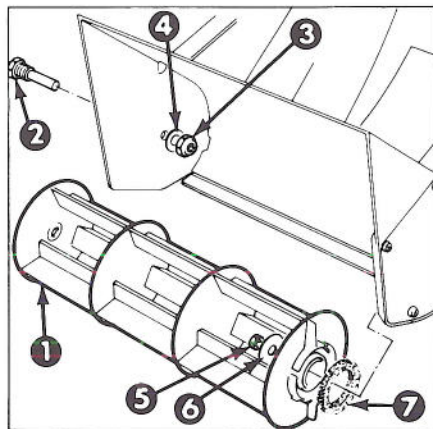

Figure 6

- | | |
|--------------|----------------|
| 1. Rotor | 5. Locknut |
| 2. Rotor Pin | 6. Washer |
| 3. Locknut | 7. Felt Washer |
| 4. Washer | |
4. Install new felt washer and rotor. Secure in place with the rotor pin, washers and locknuts. Tighten locknuts.

**THE TORO PROMISE
TORO POWER SHOVEL
A FULL ONE YEAR WARRANTY**

The Toro Company warrants your TORO Product against defects in material or workmanship. During the warranty period, Toro will, at its option, replace a defective product with a new or rebuilt unit, or will repair or replace any defective parts. The following time periods from the date of purchase apply:

Residential 1 Year
Residential Products Used Commercially 45 Days

The cost of replacement or repair is included, but the customer pays the transportation costs.

Should you feel your TORO Product is defective and wish to rely on The Toro Promise, you may return it to:

1. The original place of purchase
- OR
2. A TORO Electrical Service Dealer
- OR
3. The Toro Service Center
5300 Shoreline Blvd.
Mound, MN 55364
(Postage Prepaid)

Upon return of your unit to one of the above, it will be inspected and you will be advised whether the product is defective. If defective, arrangements will be made for repair or replacement without extra charge to you.

If for any reason you are dissatisfied with the analysis of the defect or the service performed, you may contact us.

Write: TORO Customer Service Department
Home Improvement Division
8111 Lyndale Avenue South
Minneapolis, MN 55420

THERE IS NO OTHER EXPRESS WARRANTY

THE TORO COMPANY IS NOT LIABLE FOR INDIRECT OR CONSEQUENTIAL DAMAGES IN CONNECTION WITH THE USE OF THE PRODUCT.

Some states do not allow the exclusion or limitation of incidental or consequential damages, so the above limitation or exclusion may not apply to you.

This Warranty applies only to parts or components which are defective and does not cover repairs necessary due to normal wear, misuse, accidents, or lack of proper maintenance. Regular, routine maintenance of the unit to keep it in proper operating condition is the responsibility of the owner.

All warranty repairs reimbursable under The Toro Promise must be performed by a TORO Electrical Service Dealer using Toro approved replacement parts.

Repairs or attempted repairs by anyone other than a TORO Electrical Service Dealer are not reimbursable under The Toro Promise. In addition, these unauthorized repair attempts may result in additional malfunctions, the correction of which is not covered by warranty.

This warranty gives you specific legal rights, and you may also have other rights which vary from state to state.

COUNTRIES OTHER THAN THE UNITED STATES OR CANADA

Customers who have purchased TORO products exported from the United States or Canada should contact their TORO Distributor (Dealer) to obtain guarantee policies for your country, province or state. If for any reason you are dissatisfied

with your Distributor's service or have difficulty obtaining guarantee information, contact the TORO importer. If all other remedies fail, you may contact us at The Toro Company.

Assembly Instructions

ASSEMBLE HANDLE

Tools Required: Phillips Screw Driver,
Plastic Rod (included
in loose parts bag)

INSPECT SUPPLY CORD FOR
DAMAGE. IF DAMAGED, DO NOT
ASSEMBLE. CONTACT YOUR TORO
DEALER.

1. Remove and discard the grommet from inside the upper handle (Fig.1).

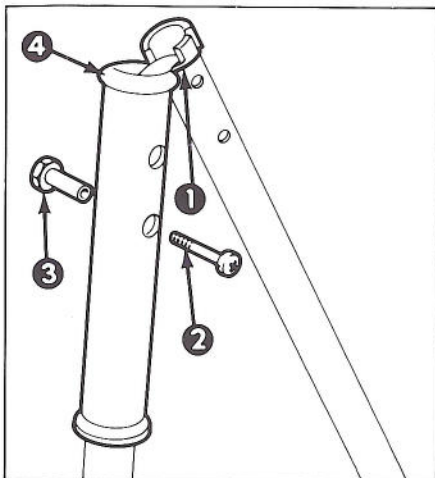

Figure 1

- | | |
|-----------------|-----------------------|
| 1. Grommet | 3. Plastic Handle Nut |
| 2. Handle Screw | 4. Center Handle Grip |

2. Remove the handle screws and plastic handle nuts from the center handle grip (Fig. 1).

3. Lay handle assembly onto flat surface. Slide center handle grip off lower handle and onto upper handle (Fig. 2A).

4. Align upper and lower handles. Hold handle connector with one hand and slide lower handle into mounting position in upper handle with other hand (Fig. 2A). Align holes. Slide plastic center handle into position and align with holes in handles.

NOTE: Be sure the power plug end of handle grip and slot in plastic center handle grip face towards the rear of unit.

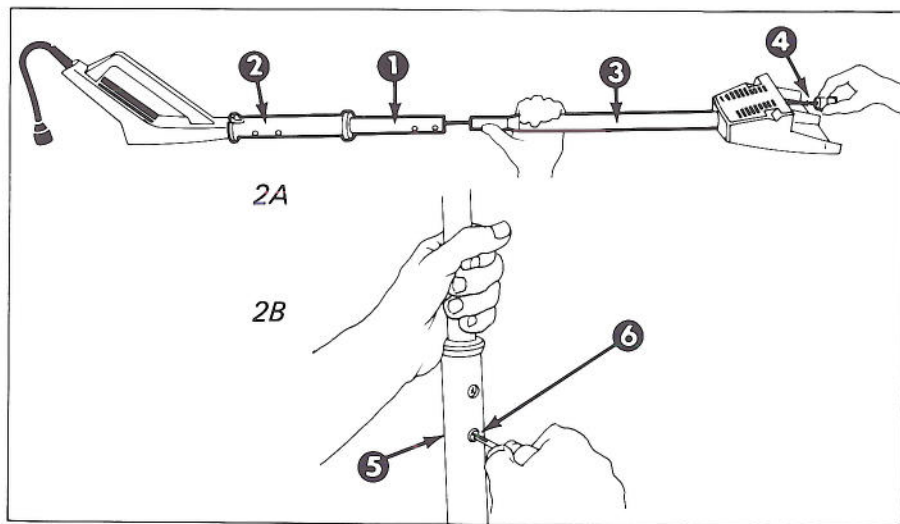

Figure 2

- | | | |
|-----------------------|---------------------|--------------------------------|
| 1. Upper Handle | 3. Lower Handle | 5. Special Hex Nut (not shown) |
| 2. Center Handle Grip | 4. Handle Connector | 6. Special Screw |

Assembly Instructions



WARNING

DO NOT INSERT HANDLE SCREW THROUGH HANDLE UNTIL PLASTIC HANDLE NUT HAS BEEN PROPERLY INSTALLED. IF HANDLE SCREW IS NOT PROPERLY INSTALLED, SUPPLY CORD COULD BECOME DAMAGED AND CAUSE SERIOUS ELECTRICAL SHOCK RESULTING IN PERSONAL INJURY DURING OPERATION.

5. Insert plastic rod (supplied in loose parts bag) through round center handle grip hole and gently move electric supply cord to one side.

6. Insert plastic handle nut into hex hole in center handle grip. Carefully push nut through handle and seat hex head in matching recessed center handle grip hole; hold in place.

7. Using fingers only, insert the handle screw into the plastic handle nut and rotate to start the threads. USE NO TOOLS UNTIL THE HANDLE SCREW IS PARTIALLY THREADED INTO THE PLASTIC HANDLE NUT.

8. Using a Phillips screw driver, tighten the handle screw while holding plastic handle nut in place (Fig. 2B).

9. Repeat steps 5 through 7 to install the second nut and screw.

10. Lay the power head and handle on a flat surface in the manner shown in Figure 3A.

11. Assemble the power head connector and the handle connector by sliding the connectors together (Fig. 3A).

12. Set power head as shown in Figure 3A, so that assembled handle may be inserted and pushed down. Turn handle 1-1/2 turns until the power head and handle are properly aligned.

NOTE: Twisting the handle in this

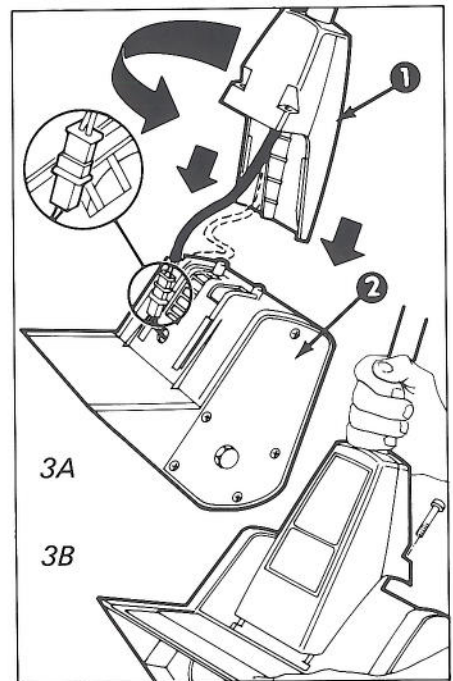

Figure 3

1. Handle Support
2. Power Head

manner coils the power cord such that it will lay properly between the handle support and power head.

13. Hold connectors down flat against power head and slide the handle support over the power head. Be sure the grooves in the handle support and power head are interlocked (Fig. 3B) and the power supply cord is properly positioned.

IMPORTANT: If the handle support does not slide completely into position, check the supply cord to be sure it is not interfering with assembly. If necessary, move the cord to eliminate interference and be sure it rests on the right side between the handle support and power head.

14. Insert a 1/4" x 1" screw in the threaded slot in the rear of the handle support (Fig. 3B) and screw into place. Repeat with second screw.

Maintenance

REPLACE SCRAPER

The scraper blade located on the bottom of the Power Shovel can be replaced if worn.

1. Remove the rotor; refer to Replacing Rotor, page 6, items 1 through 3.
2. Remove the three screws and locknuts used to hold the scraper blade in place. Remove scraper blade (Fig. 7).

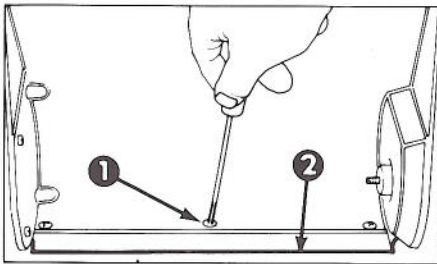

Figure 7

1. Screw
2. Scraper Blade

3. Attach new scraper blade taking care to hook scraper over front edge of housing. Secure with existing screws and locknuts, and tighten.

PREPARE POWER SHOVEL FOR STORAGE

1. Examine the Power Shovel thoroughly for worn, loose or damaged parts. If parts repair or replacement is necessary, contact your local Authorized TORO Service Dealer for assistance.
2. Examine extension cord thoroughly for signs of excess wear or damage. If worn or damaged, replace extension cord.
3. Store the Power Shovel in a clean, dry place and cover to provide protection.
4. Store the extension cord with the Power Shovel to prevent misplacement.