



Wireless Hour Meter Kit

GreensPro™ 1240 Greens Roller

Model No. 44922

Form No. 3380-722 Rev A

Installation Instructions

⚠ WARNING

CALIFORNIA Proposition 65 Warning

This product contains a chemical or chemicals known to the State of California to cause cancer, birth defects, or reproductive harm.

Loose Parts

Use the chart below to verify that all parts have been shipped.

Description	Qty.	Use
Wiring harness	1	Install the wiring harness.
Hour meter	1	Install the regulator and the hour meter.
Regulator	1	
Screw (M6 x 20 mm)	2	
Locknut (M6)	2	
Washer (M6 x 12 mm)	4	
Cable tie	4	

Installing the Wiring Harness

1. Ensure that the machine is off and the engine is cool.
2. Disconnect the existing hour-meter wiring harness from the lighting-coil wires and the existing hour meter (Figure 1).

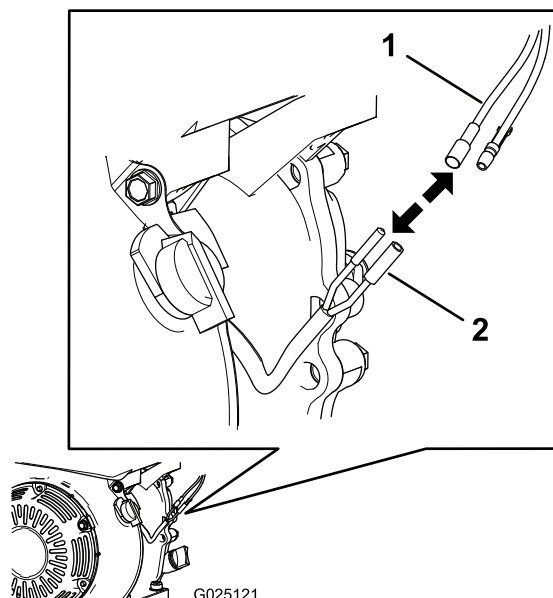

Figure 1

1. Existing hour-meter wiring harness
2. Lighting-coil wires



3. If the machine is equipped with a light kit, disconnect the existing hour-meter wiring harness from the light-kit wiring harness (Figure 2).

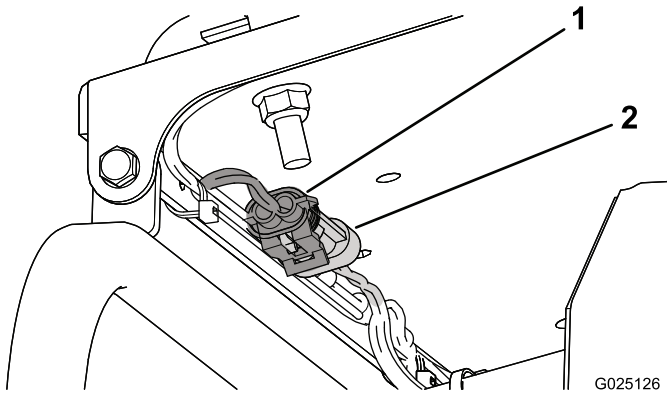

Figure 2

1. Light-kit wiring harness
2. Existing hour-meter wiring harness

4. Remove the existing hour-meter wiring harness.
5. Remove the existing hour meter (Figure 3).

Note: Retain the existing hour meter and hour-meter wiring harness for the option of installing them in the future.

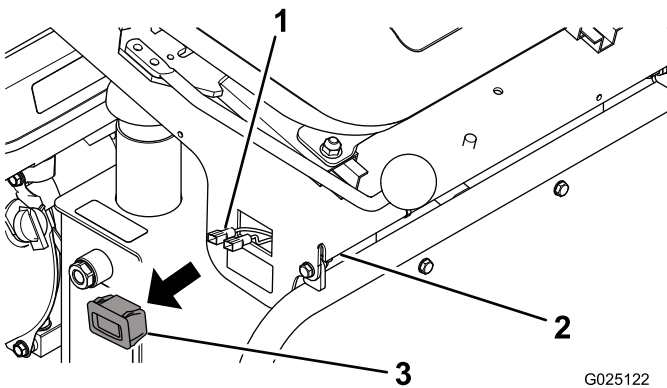

Figure 3

1. Existing hour-meter wiring harness
2. Seat pan
3. Existing hour meter

6. Remove the bolt from the lower-right corner of the engine shroud (Figure 4).

Note: Retain the bolt.

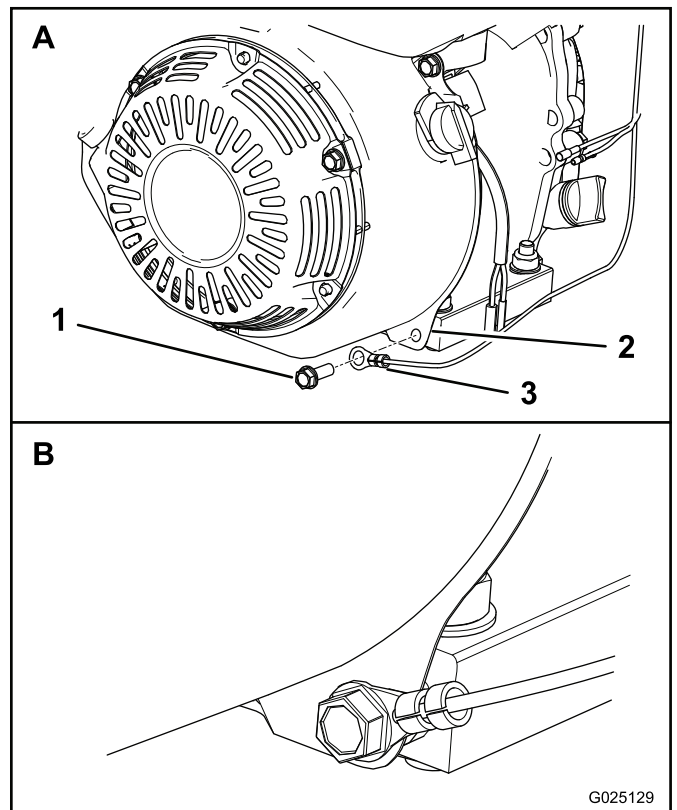

Figure 4

1. Bolt
2. Engine shroud
3. Grounding terminal

7. Align the grounding terminal of the wireless-hour-meter wiring harness over the bolt hole, and install the bolt (Figure 4).
8. Connect the wireless-hour-meter wiring harness to the lighting-coil wires (Figure 5).

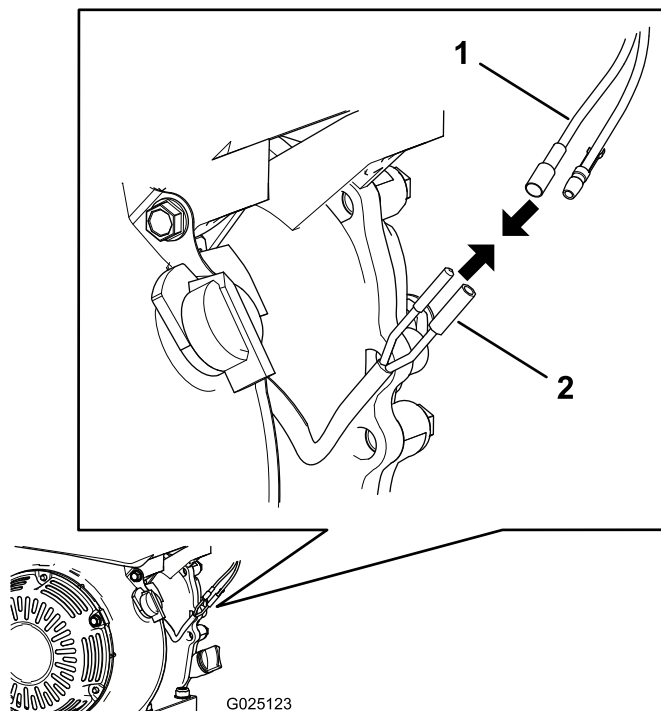

Figure 5

1. Wireless-hour-meter wiring harness
2. Lighting-coil wires

9. If the machine is equipped with a light kit, plug the light-kit wiring harness into the appropriate connector of the wireless-hour-meter wiring harness (Figure 2).

Installing the Regulator and the Hour Meter

1. If necessary, unlatch the seat and tip it forward.
2. Insert 2 screws (M6 x 20 mm) with 2 washers (M6) down through the holes in the top of the seat pan (Figure 6).

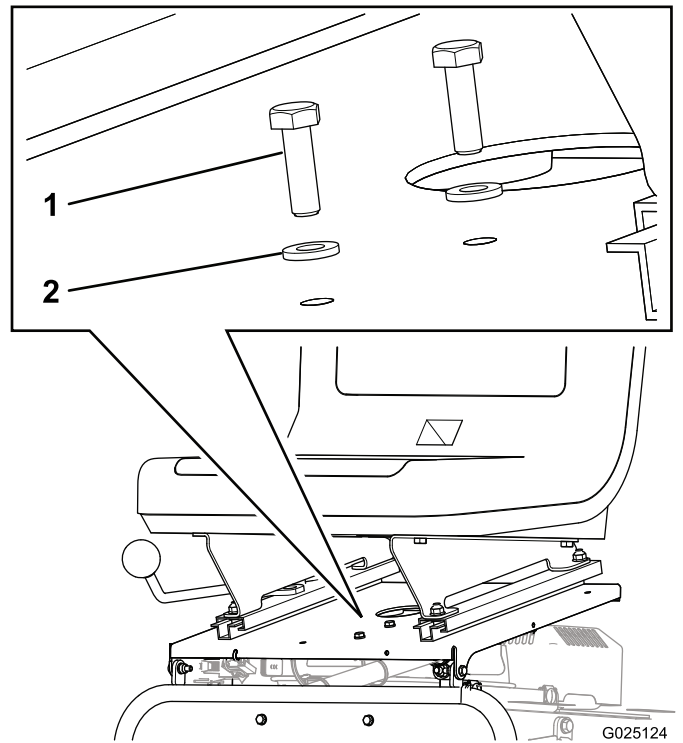

Figure 6

1. Screw (M6 x 20 mm), 2
2. Washer (M6), 2

3. On the underside of the seat pan, align the regulator to the screws (Figure 7).

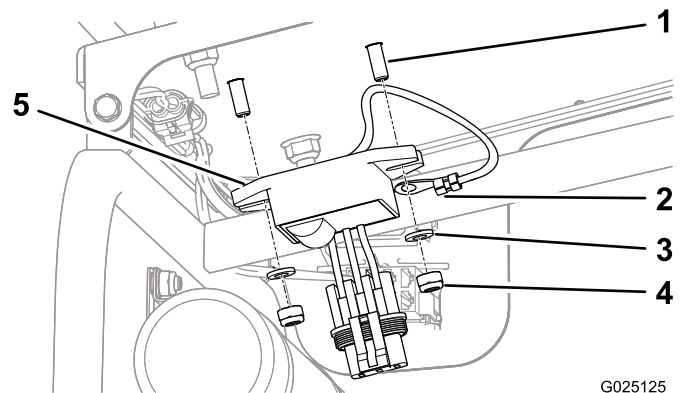

Figure 7

1. Screw (2)
2. Grounding lead
3. Washer (M6 x 12 mm), 2
4. Locknut (M6 x 12 mm), 2
5. Regulator

4. Align the grounding lead of the regulator over a mounting slot, and secure the lead and the regulator by

installing an M6 washer and an M6 locknut onto the appropriate M6 x 20 mm screw (Figure 7).

5. Secure the other side of the regulator by installing an M6 washer and an M6 locknut onto the other M6 x 20 mm screw (Figure 7).
6. Connect the plug on the regulator to the appropriate plug on the wireless-hour-meter wiring harness (Figure 8).

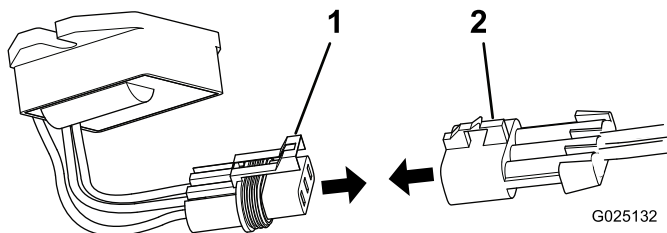

Figure 8

1. Regulator plug
2. Wireless-hour-meter wiring-harness plug

7. Install the wireless hour meter (Figure 9).

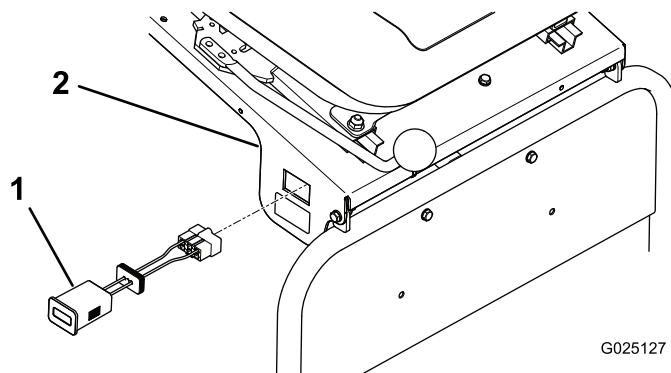

Figure 9

1. Hour meter
2. Seat pan

8. Insert the connector of the wireless-hour-meter wiring harness into the connector of the hour meter (Figure 10).

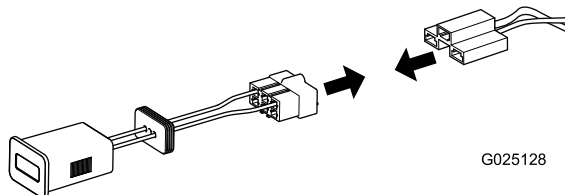

Figure 10

9. Install the push mount in the hole in the underside of the seat pan (Figure 11).

Note: The push mount is attached to the wireless-hour-meter wiring harness.

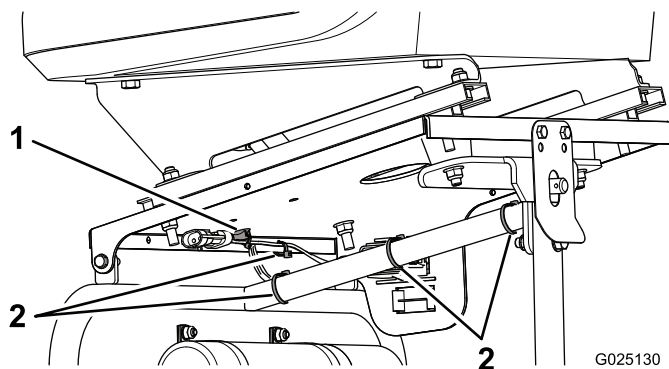

Figure 11
Regulator not shown

1. Push mount
2. Cable ties

10. Use the cable ties to secure the wires to the seat-support strut and the front of the seat pan (Figure 11).
11. Lower and latch the seat.