



MODEL NO. 22099

# INSTALLATION INSTRUCTIONS

## STEEL GRASS CATCHER

(21" COMMERCIAL REAR BAGGER)

Since this instruction sheet covers only a minimal amount of information necessary to maintain and operate your machine, we suggest that you keep this material with your Operator's Manual so that both may be referred to for instructions concerning safe operation and proper maintenance procedures.

1. **⚠** Assure engine has stopped running so that cutter blade is not moving.

2. Assure chute door handle is fully forward and lockout lever is released into latch (Fig. 1). The chute door is now closed.

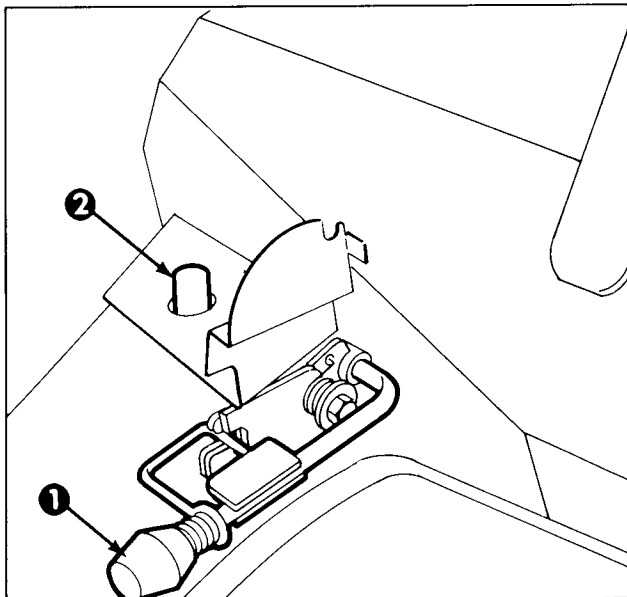

Figure 1

1. Chute door handle fully forward
2. Locating stud

3. Slide guide hole in grass catcher latch onto locating stud on mower housing (Fig. 1).

4. Squeeze lockout lever until it clears the housing latch. Then move handle rearward until it locks in the notch at rear of grass catcher latch (Fig. 2). The chute door in mower housing is now open and mower is ready to bag grass.

5. **⚠** When grass catcher must be emptied, stop the engine and wait for all parts to stop moving. Move chute door handle forward until it locks in the latch. Then lift grass catcher straight up so clippings stay in the grass catcher rather than falling out the opening.

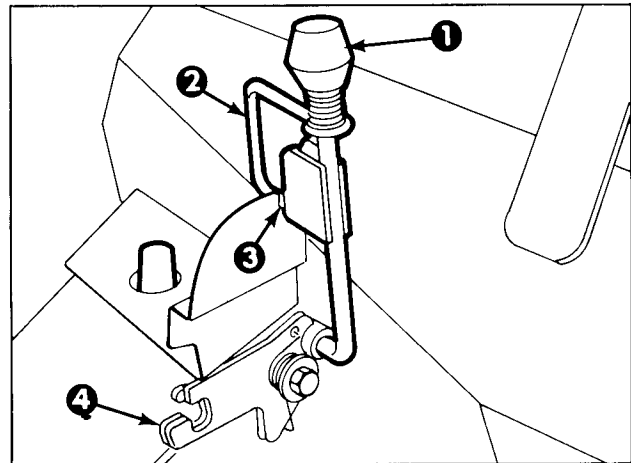

Figure 2

1. Chute door handle
2. Lockout lever
3. Notch
4. Housing latch



### CAUTION

Never open the chute door when grass catcher is removed from the mower and engine is running. Never open grass catcher door when mounted on mower and engine is running. Grass clippings and other debris will be discharged with enough force to cause personal injury. Do not operate mower unless complete grass catcher is attached and properly positioned or chute door is completely closed.

**IMPORTANT:** If chute door of mower cannot be closed because grass clippings clog the discharge area, move chute door gently, back and forth. Do this until clippings are pushed into the grass catcher and chute door can be closed completely. **DO NOT FORCE THE CHUTE DOOR CLOSED** because door or handle may be damaged.

6. To dump grass out of grass catcher, grasp handle at front of grass catcher and unlatch door at rear of bag.

7. Close and latch grass catcher door and reinstall on mower by repeating steps 3 and 4.