



Z Master® Professional Series Riding Mower

Model No. 74942—Serial No. 314000001 and Up

Model No. 74942TE—Serial No. 314000001 and Up

Model No. 74944—Serial No. 314000001 and Up

Addendum

Setup

Loose Parts

Use the chart below to verify that all parts have been shipped.

Procedure	Description	Qty.	Use
1	Skid	1	Install the right-hand skid.
	Carriage bolt (3/8-16 x 2-1/4 inches)	3	
	Nyloc nut (3/8 inch)	3	

1

Installing the Right-hand Skid

Parts needed for this procedure:

1	Skid
3	Carriage bolt (3/8-16 x 2-1/4 inches)
3	Nyloc nut (3/8 inch)

Procedure

Mount the skid in the lower position when operating in height of cuts higher than 64 mm (2-1/2 inches) and in the higher position when operating in height of cuts lower than 64 mm (2-1/2 inches).

1. Raise the deck to the 14 cm (5-1/2 inches) height-of-cut position (also known as the transport position).
2. Remove and discard the zip ties from the right-hand skid.
3. Move the skid to the desired position and secure it with 3 carriage bolts (3/8-16 x 2-1/4 inches) and 3 nyloc nuts (3/8 inch) as shown in Figure 1.
4. To prevent damaging the skid, torque the carriage bolts and nuts for the skid to 12.4 to 14.7 N-m (110 to 130 in-lb).

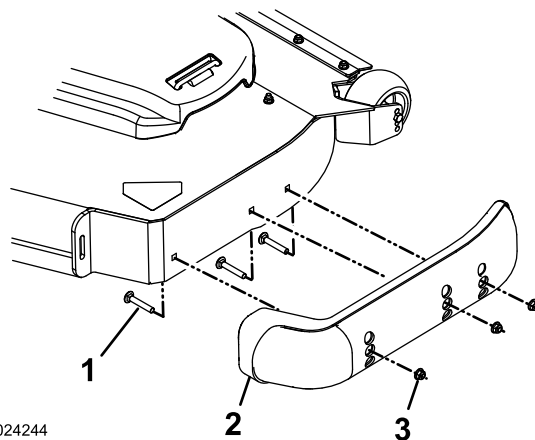

g024244

Figure 1

1. Carriage bolt
2. Skid
3. Nyloc nut

