



# ROPS Conversion Kit

## TITAN® Zero-Turn-Radius Riding Mower

Model No. 130-6850

Form No. 3383-520 Rev A

### Installation Instructions

#### ⚠ WARNING

##### CALIFORNIA Proposition 65 Warning

This product contains a chemical or chemicals known to the State of California to cause cancer, birth defects, or reproductive harm.

## Installation

### Loose Parts

Use the chart below to verify that all parts have been shipped.

Description	Qty.	Use
Pivot bracket	4	Install the ROPS Parts
Rubber bumper	2	
Spacer	4	
Round spacer	2	
Pin assembly	2	
Nut (5/16 inch)	2	

### Installing the ROPS Parts

1. Remove the existing side brackets on the ROPS. Save the nuts and bolts for installing the new brackets.
2. Install the rubber bumpers to the lower part of the ROPS with 2 nuts (5/16 inch) (Figure 1).
3. Install the pivot brackets and spacers to the upper part of the ROPS with the previously removed nuts and bolts (Figure 1).
4. Install the upper part of the ROPS, round spacer, and pin assembly to the lower part of the ROPS with the previously removed nuts and bolts (Figure 1).
5. Torque all nuts and bolts to 40.7 to 49.7 N-m (360 to 440 in-lb).



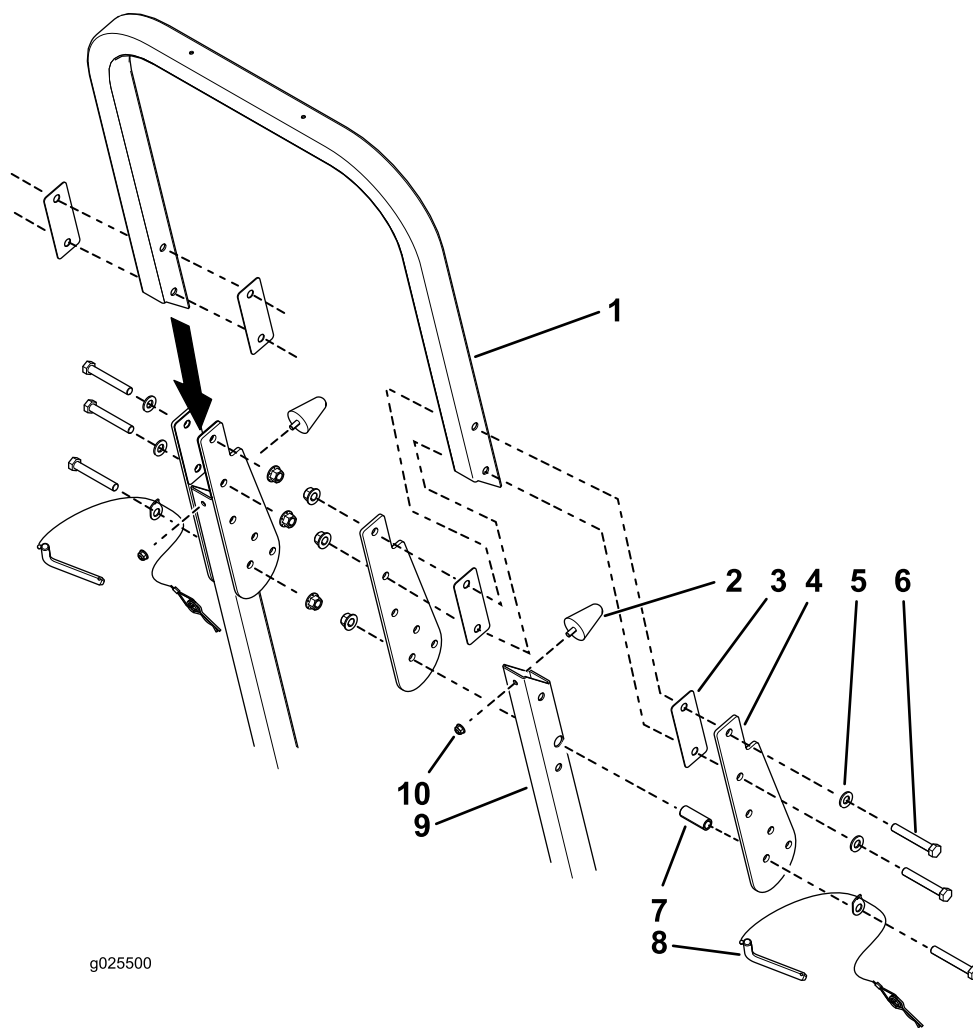

g025500

**Figure 1**

- |                           |                 |                           |
|---------------------------|-----------------|---------------------------|
| 1. Upper part of the ROPS | 5. Washer       | 9. Lower part of the ROPS |
| 2. Rubber bumper          | 6. Bolt         | 10. Nut (5/16 inch)       |
| 3. Spacer                 | 7. Round spacer |                           |
| 4. Pivot bracket          | 8. Pin assembly |                           |

# Operation

## Using the Rollover Protection System (ROPS)

### ⚠ WARNING

To avoid injury or death from rollover: keep the roll bar in the raised locked position and use the seat belt.

### ⚠ WARNING

There is no rollover protection when the roll bar is in the down position.

- Lower the roll bar only when absolutely necessary.
- Do not wear the seat belt when the roll bar is in the down position.
- Drive slowly and carefully.
- Raise the roll bar as soon as clearance permits.
- Check carefully for overhead clearances (i.e. branches, doorways, electrical wires) before driving under any objects and do not contact them.

**Important:** Lower the roll bar only when absolutely necessary.

1. To raise the roll bar, remove the hair cotter pin and remove the locking pins.
2. Raise the roll bar to the upright position (Figure 2).

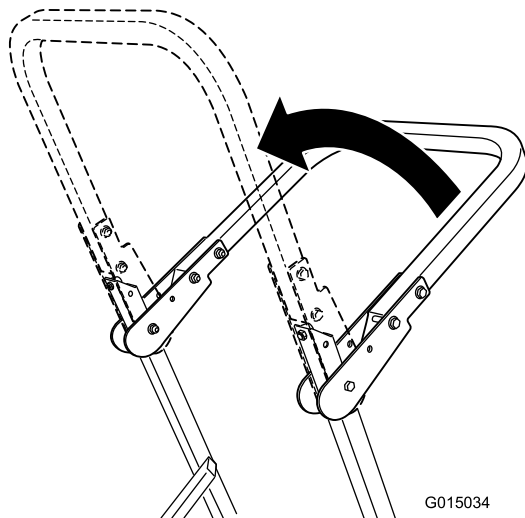

Figure 2

3. Install the locking pins. Secure the pins by installing the hair cotter pin (Figure 3).

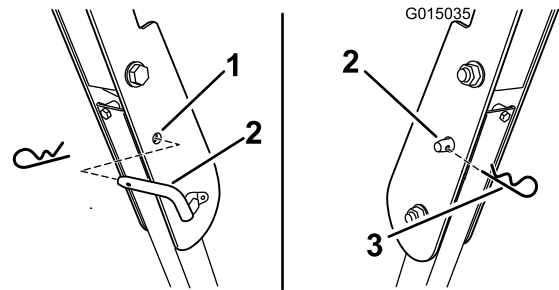

Figure 3

1. Hole in ROPS
  2. Locking pin
  3. Hair pin cotter
- 
4. To lower the roll bar, remove the hair cotter pin and remove the locking pins (Figure 3).
  5. Lower the roll bar to the down position.
  6. Use the 2 locking and cotter pins to secure the bar.

**Important:** Always use the seat belt with the roll bar in the raised position.



**Count on it.**