



# Master Boom Kit

## Multi Pro® 1750 and WM Turf Sprayer

Model No. 130-7117

### Installation Instructions

## Loose Parts

Use the chart below to verify that all parts have been shipped.

Description	Qty.	Use
Manifold	1	Install the kit.
Bypass assembly	1	
Hosebarb	1	
O-ring	1	

### ⚠ WARNING

#### CALIFORNIA Proposition 65 Warning

This product contains a chemical or chemicals known to the State of California to cause cancer, birth defects, or reproductive harm.

## Installing the Kit

1. Park the machine on a level surface, lower the booms, and support the ends with jack stands.
2. Set the parking brake, stop the engine, and remove the key.
3. Remove the electrical connections and all hose connections (Figure 1).

**Note:** Pull the hose pins and remove to remove the hoses.

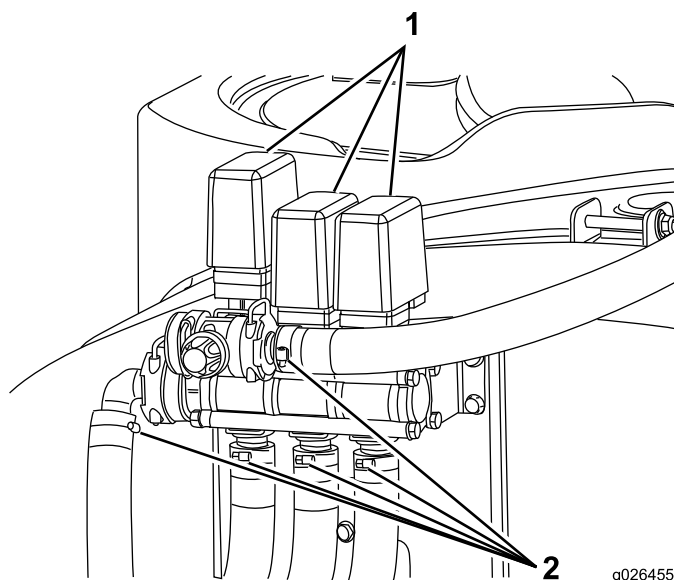
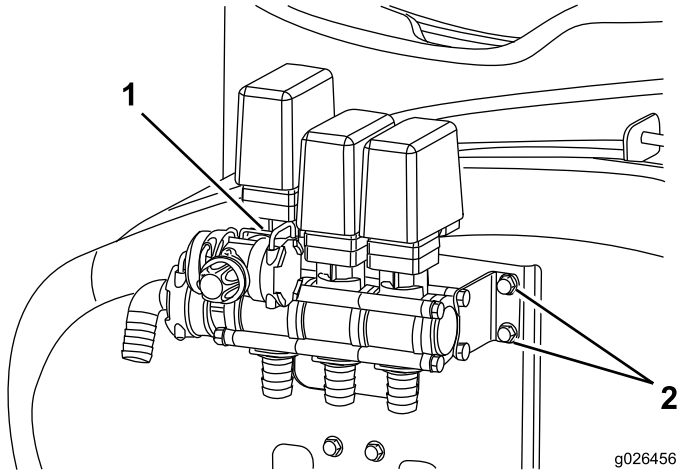

Figure 1

1. Electrical connections
2. Hose connections



- Remove the pin and pull off the bypass valve (Figure 2).



**Figure 2**

- Bypass valve pin
- Bolts

- Remove the bolts to remove the valve assembly from the machine (Figure 2).
- Carefully remove the thur bolts and disassemble the valve assembly (Figure 3).

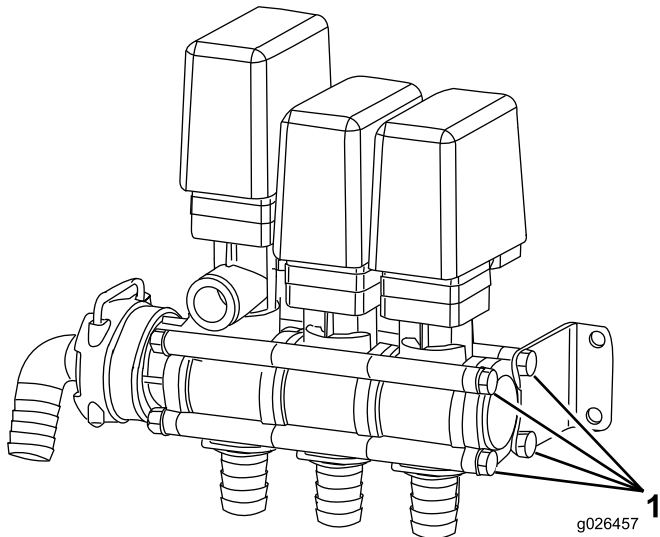
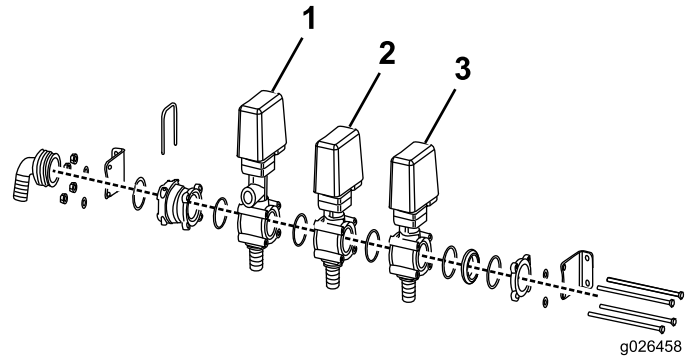

**Figure 3**

- Thur bolts

- With the thur bolts removed, disassemble the valve assembly

**Note:** The o-rings and spacers may fall out. Use Figure 4 to make sure they are kept in place (Figure 4).

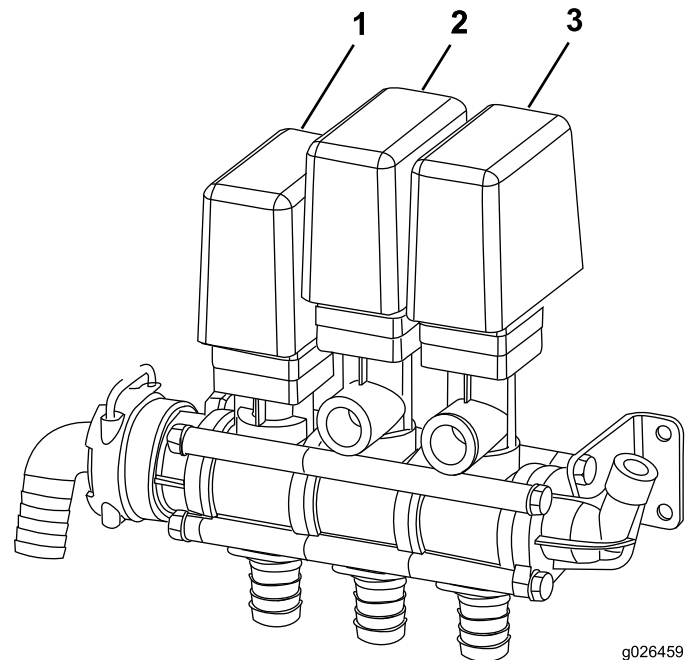

**Figure 4**

- Agitation valve (Keep)
- Rate valve (Keep)
- Master boom valve (replace with new manifold)

- Install the new manifold onto the sprayer.

**Note:** Switch the location of the agitation valve and the rate valve and replace the master boom valve with the one included in the kit (Figure 5).



**Figure 5**

- Rate valve
- Agitation valve
- Master boom valve

9. Install the original bypass assembly and the new one included in the kit (Figure 6).

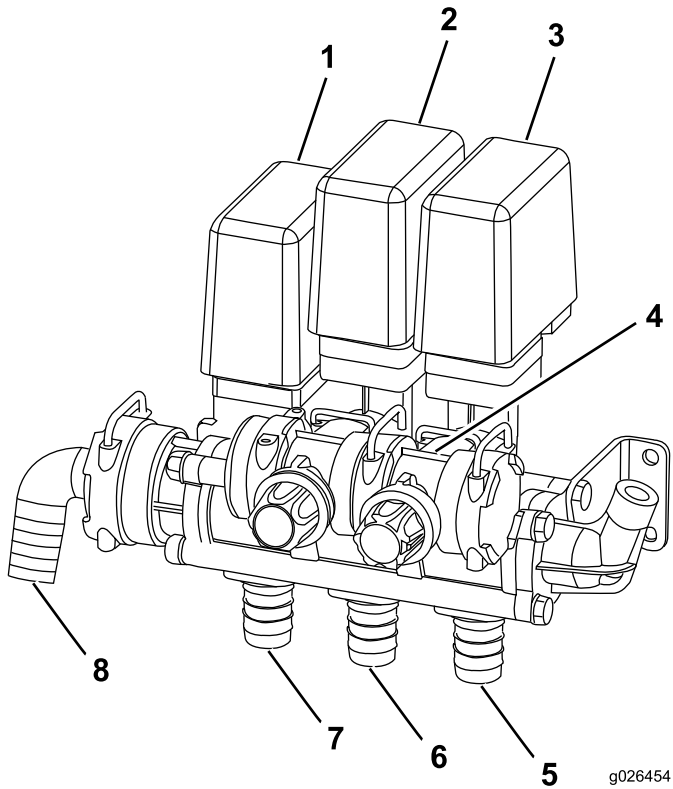

**Figure 6**

- |                                  |               |
|----------------------------------|---------------|
| 1. Rate valve                    | 5. Hosebarb C |
| 2. Agitation valve with bypass   | 6. Hosebarb A |
| 3. Master boom valve with bypass | 7. Hosebarb B |
| 4. Bypass assembly               | 8. Hosebarb E |

- 
10. Install the valve assembly back onto the machine.
  11. Install the hoses back onto the valve assembly (Figure 6).

**Note:** As the positions of manifold 1 and 2 have switched from their original position, the hose A and B will also be switched.

12. Connect the electrical connections.

**Note:** Connect the electrical connections to their original valves. Connect the electrical connection of the valve that was removed with the new valve. The electrical connections are labeled also



**Count on it.**