



MODEL NO. 08818 - 10001 &amp; UP

# INSTALLATION INSTRUCTIONS

## RENOVATION CULTIVATOR

(SAND PRO®)

**IMPORTANT:** To withstand the stress and strain of cultivating, the Frame Reinforcement Kit, Toro part no. 80-1940, must be installed on all model 08880 Sand Pro 14's built in the last several years, including units through 1990 serial number 01126. If the frame is not reinforced, it will bend when the cultivator is used and this will void your warranty.

## Loose Parts

Description	Qty	Where Used
Angle Support Brace	1	Mount to Rear of Machine
Lift Frame	1	Mount Lift Frame on Brace
L.H. Pivot Bracket	1	
R.H. Pivot Bracket	1	
Capscrew 3/8" x 1" lg.	4	
Locknut 3/8"	4	
Beam & Plow Assembly	1	Mount Beam to Lift Frame
Capscrew 1/2" x 3-3/4" lg.	2	
Lockwasher	2	

### INSTALL ANGLE SUPPORT BRACE

1. Remove attachment from rear of machine. Keep hydraulic cylinder retaining pin and hardware.
2. Remove existing (4) capscrews, lockwashers and flat washers from back of left and right wheel motor mounts (Fig. 1).

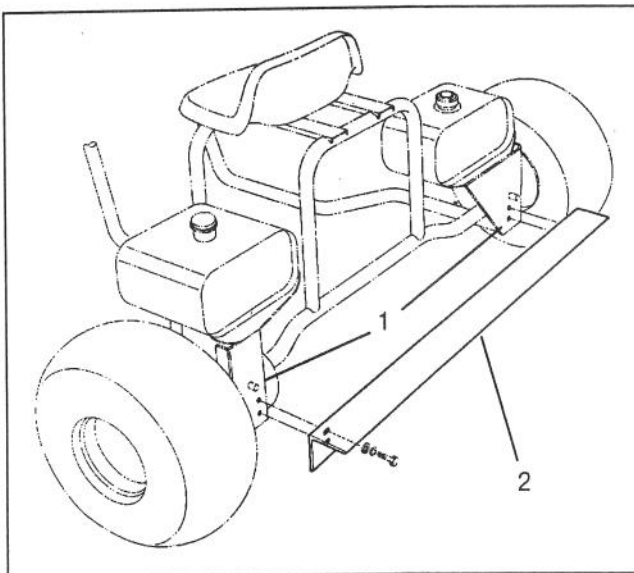

Figure 1

1. Wheel Motor Mounts
2. Angle Support Brace

3. Install angle support brace to motor mounts with fasteners removed (Fig. 1).

### INSTALL LIFT FRAME ON ANGLE SUPPORT BRACE

1. Mount lift frame onto angle support brace with left and right hand pivot brackets, (4) 3/8" x 1" lg. capscrews and 3/8" locknuts (Fig. 2).
2. Connect the hydraulic cylinder from machine to the cylinder bracket on the lift frame with existing large retaining pin, hair pin and cotter pin (Fig. 2).
3. Start the engine and raise the lift frame. This makes it easier to install the cultivator beam on the lift frame.

### INSTALL CULTIVATOR BEAM ASSEMBLY

The lift frame has four holes which correspond to various cultivating depths - 1", 2", 3" and 4". Be sure to mount the beam in the desired position.

1. Notice that the beam has (2) locating pins. Insert the pins into the desired holes and secure the beam to the lift frame with (2) 1/2" x 3-3/4" lg. capscrews and lockwashers (Fig. 2).
2. If the cultivator plows are not installed, slide plow bar through the hole in beam and retain in place with lynch pin (Fig. 2). Make sure to flip ring over end of lynch pin so the plow doesn't accidentally fall out. Install all remaining cultivator plows.

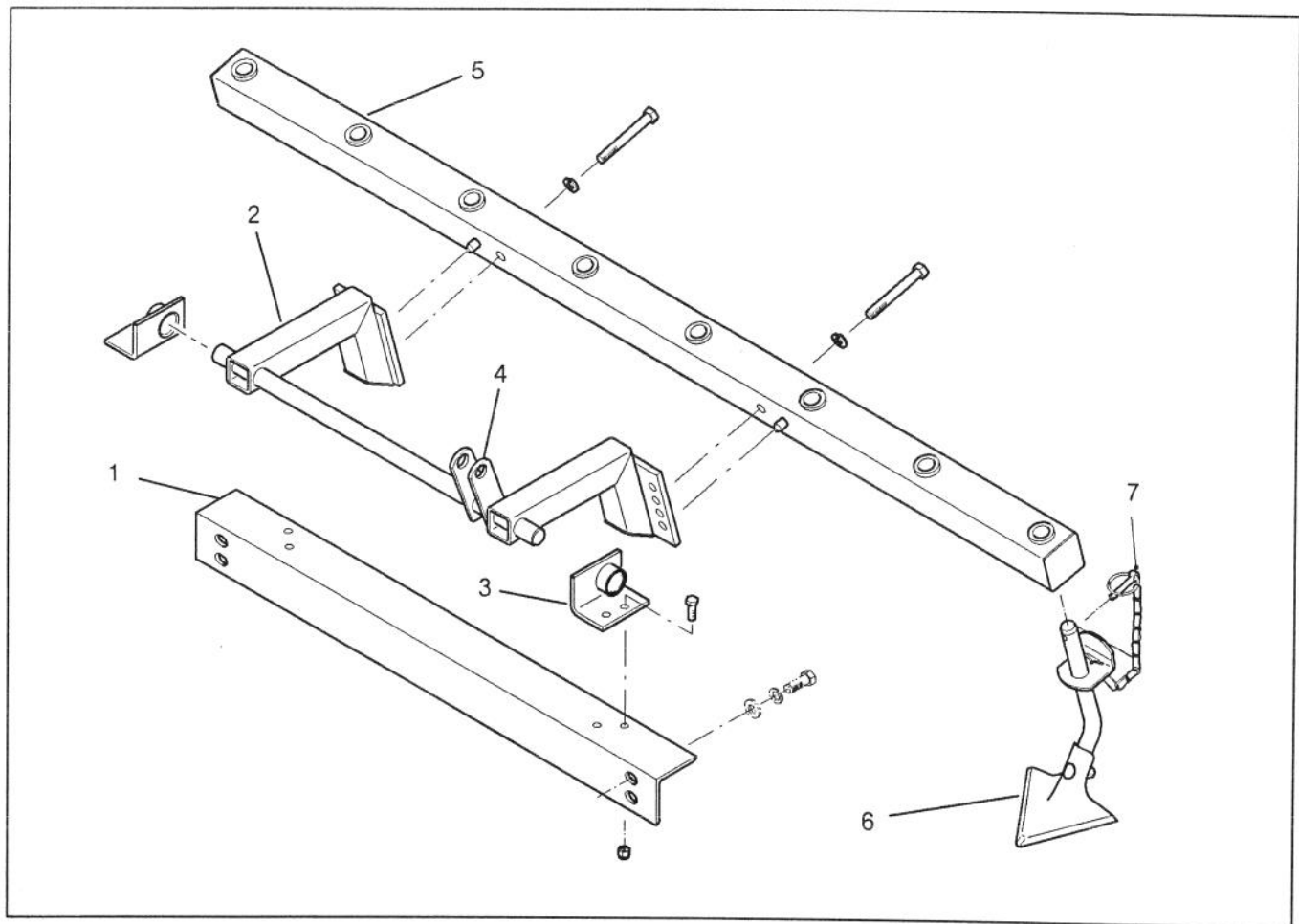

**Figure 2**

- |  |                    |
|--|--------------------|
| 1. Angle Support Brace                   | 5. Cultivator Beam |
| 2. Lift Frame                            | 6. Cultivator Plow |
| 3. Pivot Bracket                         | 7. Lynch Pin       |
| 4. Hydraulic Cylinder Connection Bracket |                    |

## OPERATING INSTRUCTIONS

1. For best cultivating performance, be sure the hand throttle is in FAST position. To get maximum pulling power, only depress traction pedal slightly.
2. Cultivating depth can be controlled with the lift lever. To raise the cultivator, pull the lift lever up. Push down on the lift lever to lower the cultivator. When cultivator is in the desired position, release the lever.

**Note:** The Sand Pro has a double-acting lift cylinder. Downward pressure can be applied to the cultivator for certain ground and sand conditions by pushing down on the lift lever. If the wheels spin while cultivating, raise the cultivator slightly. At times the engine may begin to overload. When it does, gradually release the traction pedal which will increase engine speed and power.