



PART NO. 85-7360

INSTALLATION INSTRUCTIONS

SPRING LOADED IDLER KIT (For Proline Mid Size Traction Units)



CAUTION

To prevent accidental starting of the engine while performing maintenance, shut engine off. Also, pull wire off spark plug. Make sure wire does not contact plug accidentally.

1. If traction unit and mower are going to be tipped to install kit, drain gasoline from fuel tank and oil from crankcase.
2. Loosen capscrew and flange locknut securing idler pulley to underside of frame. Slide pulley outward relieving belt tension.

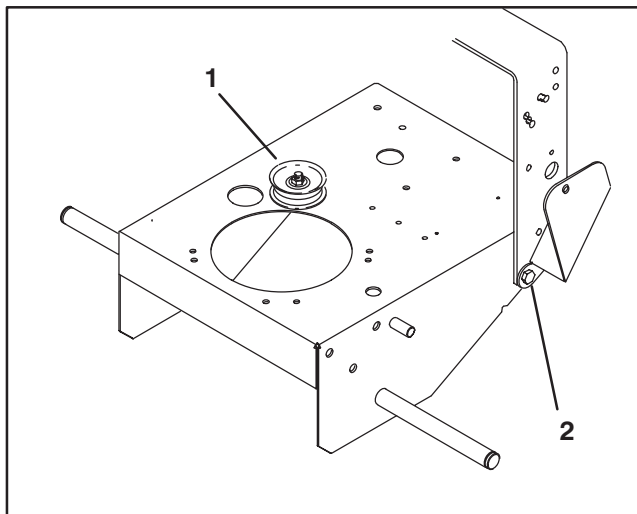

Figure 1

1. Idler pulley
2. L.H. support bracket mounting capscrew

3. Remove capscrew and flange locknut securing idler pulley to frame and remove pulley.
4. If serial number on machine is prior to 20001, the new idler pulley mounting hole must be drilled in frame. Proceed to next step. If mounting hole is present, proceed to step 6.
5. Using dimensions shown in fig. 2, locate, mark and drill a .391" dia. hole in frame.

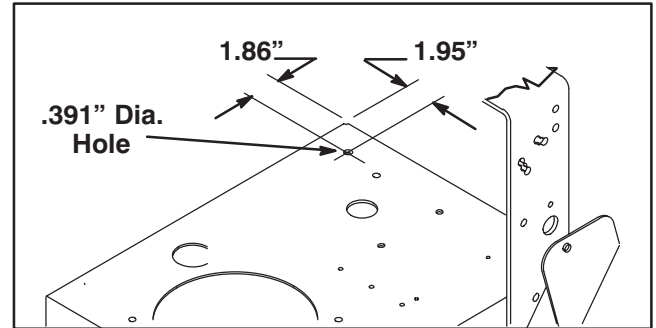

Figure 2

6. Mount idler assembly to underside of frame with a shoulder bolt and locknut (Fig. 3).

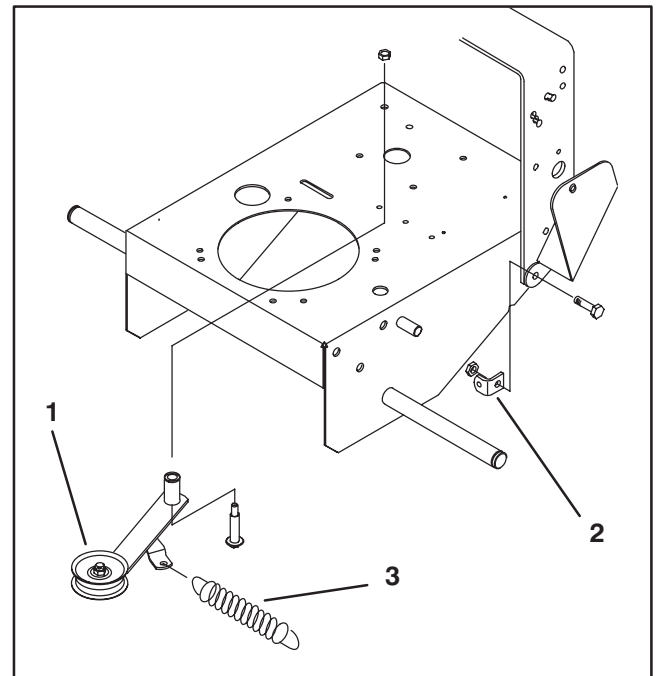

Figure 3

1. Idler assembly
2. Spring anchor
3. Extension spring

7. Remove capscrew and locknut securing front of L.H. Support Bracket to frame (Fig. 2).
8. Using new capscrew and locknut previously removed, mount spring anchor and support bracket to frame (Fig. 3).
9. Hook extension spring onto idler assembly tab and spring anchor. Make sure idler pulley is on belt.