



PART NO. 84-5010

**INSTALLATION
INSTRUCTIONS**
**2" - 5" HEIGHT-OF-CUT KIT
(For Proline Mid Size Mowers)**
**CAUTION**

To prevent accidental starting of the engine while performing maintenance, shut engine off. Also, pull wire off spark plug. Make sure wire does not contact plug accidentally.

1. If traction unit and mower are going to be tipped to install kit, first, drain gasoline from fuel tank and oil from crankcase.
2. Raise rear of traction unit until wheels are off floor and block it so it can not fall accidentally.
3. Remove retaining ring and washer(s) securing wheel to axle shaft.
4. Slide wheel, pulley and brake assembly off axle shaft, while rolling drive belt of pulleys. Make sure control bars are in relaxed position allowing drive belt removal from pulleys and brake drum to slide thru brake band assembly.
5. Remove tire from rim and install new tire. Inflate tire to specified pressure.
6. Slide wheel, pulley and brake assembly onto axle while rolling drive belt onto pulleys.
7. Repeat procedure on opposite side of machine, then remove blocks and lower traction unit to the floor.
8. Raise cutting unit so wheels are off floor and block it so it can not fall accidentally
9. Remove retaining ring and thrust washers from top of castor spindle.
10. Pull castor spindle out of carrier frame mounting tube. Remove remaining thrust washer(s) from castor spindle.
11. Remove locknut from capscrew holding castor wheel assembly between castor fork. Grasp castor wheel and slide capscrew out of fork. Account for all parts in wheel assembly.

12. Mount castor wheel assembly to new fork with capscrew and locknut previously removed. Tighten capscrew and locknut until spanner bushing bottoms against inside of castor fork.

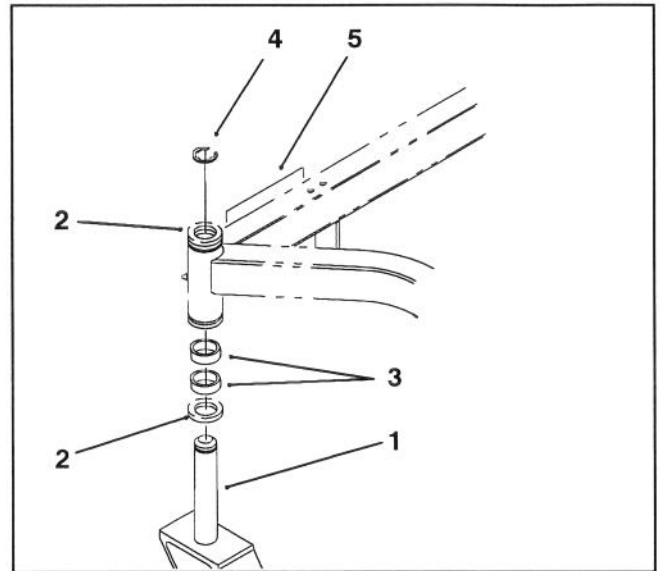
**Figure 1**

- | | |
|-------------------|-------------------|
| 1. Castor spindle | 4. Retaining ring |
| 2. Thrust washer | 5. Decal |
| 3. Spacer | |

13. Slide the thrust washer, removed from old spindle, and two new spacers onto new castor spindle.
14. Slide castor spindle into carrier frame mounting tube and secure with a thrust washer, removed from old spindle, and new retaining ring.
15. Apply appropriate height-of-cut decal over current decal on carrier frame. (R.H. - #85-7460 & L.H. - #85-7450).
16. Repeat procedure on opposite side of machine, then remove blocks and lower cutting unit to the floor.
17. Check castor wheel tire pressure and assure blade(s) are level from side to side.