



# Canopy Kit

Workman® HD/HDX/HDX-D Utility Vehicle

Model No. 07372

Form No. 3373-263 Rev B

## Installation Instructions

**Note:** Determine the left and right sides of the machine from the normal operating position.

# Installation

## Loose Parts

Use the chart below to verify that all parts have been shipped.

Description	Qty.	Use
Canopy assembly	1	Install the canopy.
Front support, left	1	
Front support, right	1	
Bolt (3/8 x 1 inch)	6	
Flange nut (3/8 inch)	4	
Bolt (5/16 x 2-3/4 inch)	4	
Flat washer (5/16 inch)	4	
Flange nut (5/16 inch)	4	
Clinch nuts	2	

1. Position the machine on a level surface. Set the parking brake, turn the ignition off, and remove the key.

### ⚠ CAUTION

**If you leave the key in the ignition switch, someone could accidentally start the engine and seriously injure you or other bystanders.**

**Remove the key from the ignition switch before you do any maintenance.**

2. Loosely attach the front supports to the vehicle floor (Figure 1). Secure the bottom of each tube to the outer edge of the vehicle floor with two bolts (3/8 x 1 inch) and flange nuts (3/8 inch).

**Note:** The hole through the bottom of each tube is not used for mounting.

3. Locate the canopy assembly in loose parts. Locate and remove the assembled clinch nuts, washers and bolts securing the rear cross bar of the internal canopy frame to the canopy. Retain these parts for installing the canopy to the ROPS later.
4. Mount the clinch nuts into the holes in the underside of the ROPS (Figure 3).

**Note:** A heavy duty clinch nut installation tool is required to properly install the clinch nuts to the

ROPS. Example: K-Line Industries tool part number TOR6030.

5. Lift the canopy up onto the front supports. Loosely attach the canopy to the front supports using four long screws (5/16 x 2-3/4 inch), four flat washers (5/16 inch), and four flange nuts (5/16 inch) (Figure 2).

**Note:** The canopy support is already loosely attached to the canopy (Figure 2).



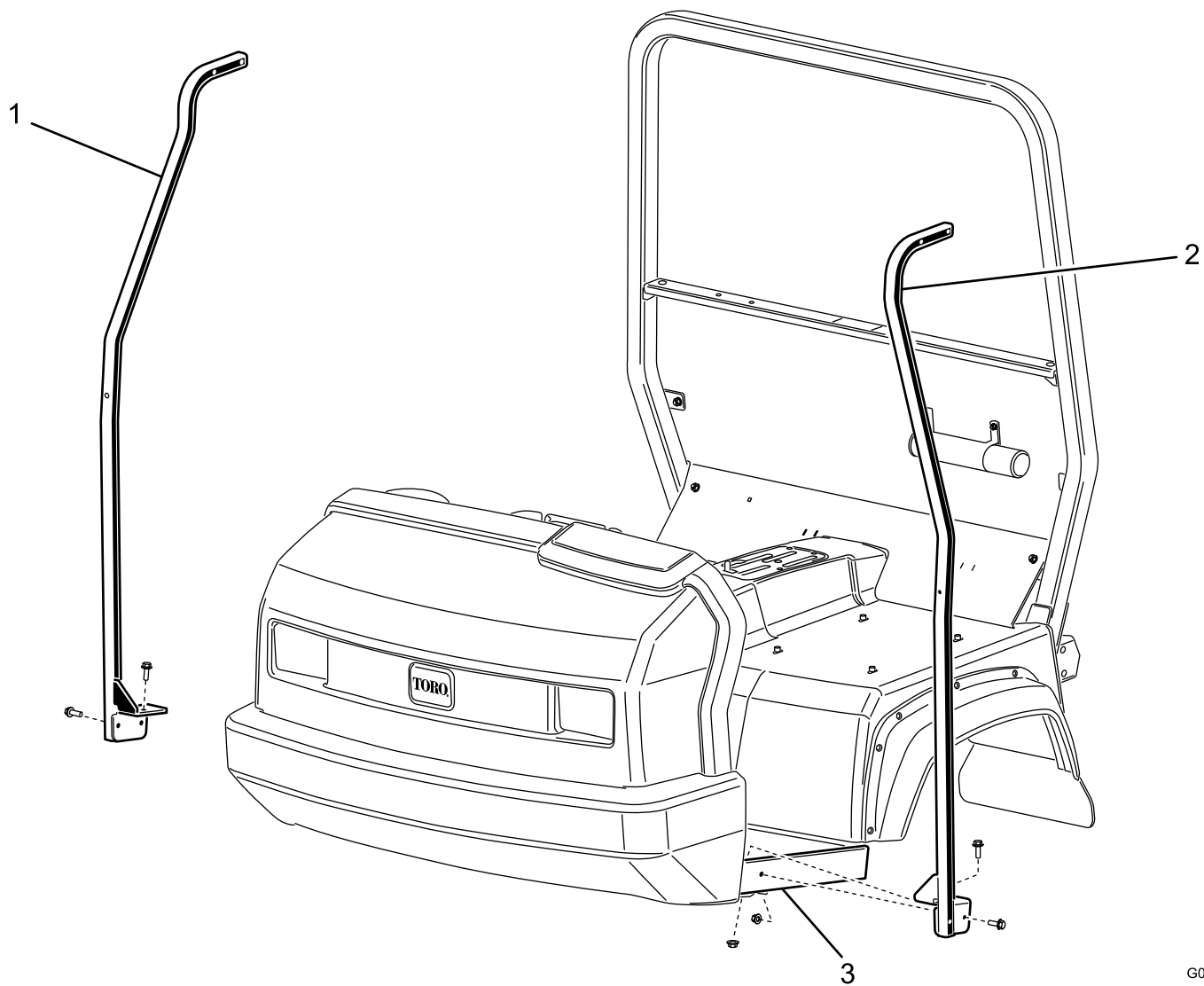

G010200

**Figure 1**

- 1. Front support, right
- 2. Front support, left

- 3. Outer edge of vehicle floor

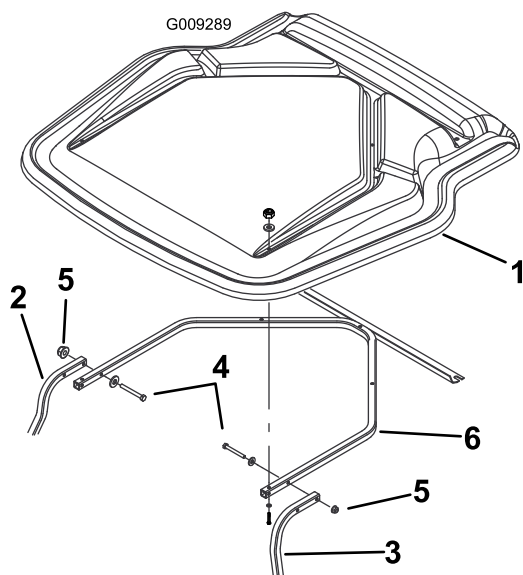

**Figure 2**

- |                             |   |
|-----------------------------|---|
| 1. Canopy                   | 4. Screw (5/16 x 2-3/4 inch) and washer (5/16 inch) |
| 2. Right-hand front support | 5. Flange nut (5/16 inch)                           |
| 3. Left-hand front support  | 6. Canopy support                                   |

- 
6. Secure the canopy to the ROPS frame with two bolts (3/8 x 1 inch) and two flat washers (3/8 inch) (Figure 3) in the clinch nuts installed previously.

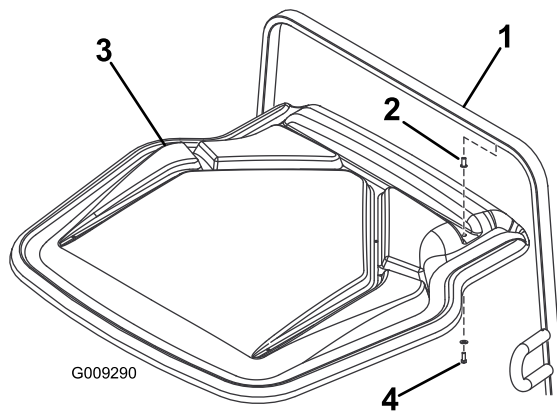

**Figure 3**

- |               |  |
|---------------|--|
| 1. ROPS       | 3. Canopy                                    |
| 2. Clinch nut | 4. Bolt (3/8 x 1 inch) and washer (3/8 inch) |

- 
7. Starting at the bottom of the vehicle and working your way to the top, tighten all of the fasteners.



**Count on it.**