



MODEL NO. 07301
MODEL NO. 07321

INSTALLATION
INSTRUCTIONS

2/3 & FULL SIZE FLAT BED For Workman 3000 Series

INSTALL RADIATOR COVER

(Required with Full Size Flat Bed only)

IMPORTANT: Before installing a full size flat bed to vehicle, a radiator cover (included with full size flat bed) must be installed to prevent sand, dirt, etc. from spilling over front of bed and getting into radiator.

1. Remove capscrew securing top left corner of the radiator to vehicle frame (as viewed from drivers position on seat).
2. Mount left hand cover bracket to frame with (2) 5/16-18 x 5/8" lg. capscrews and locknuts (supplied with kit).

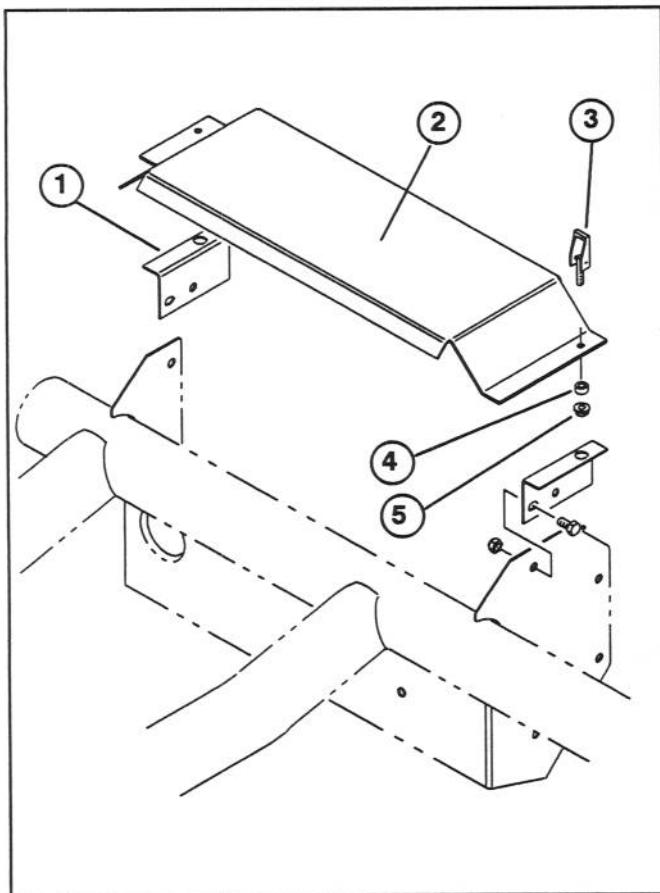

Figure 1

- | | |
|-----------------------|-------------------|
| 1. Left cover bracket | 4. Rubber grommet |
| 2. Radiator cover | 5. Plastic nut |
| 3. Swell latch | |

3. Repeat steps 1 and 2 on the right top side of the radiator.

4. Insert a swell latch into each mounting hole of radiator cover as shown in figure 1. Secure latches to each side with a rubber grommet and plastic nut.

5. Install radiator cover onto new brackets and secure latches.

INSTALL REAR PIVOT PLATES & BOX SPACERS

(Required only on Workman 3300-D)

WARNING: Lowering the bed on a Workman 3300-D will crush the fuel injector lines and cause serious damage to the engine unless the higher rear pivot plates and spacers (included with the Workman 3300-D) have been installed.

1. Remove clevis pins and lynch pins installed to bed pivot plates for shipping (Fig. 2).
2. Remove capscrews and locknuts securing rear pivot plates to right and left bed frame channels (Fig. 2).

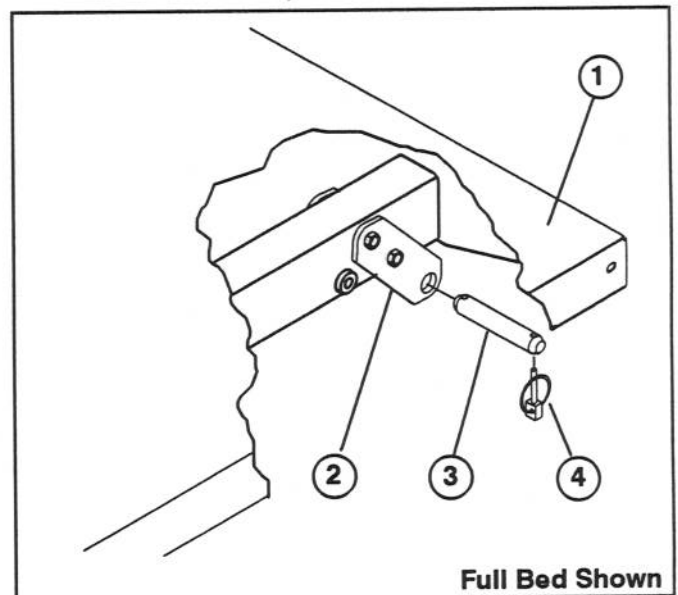

Figure 2

- | |
|----------------------------|
| 1. Left rear corner of bed |
| 2. Pivot plate |
| 3. Clevis pin |
| 4. Lynch pin |

3. Loosely assemble higher rear pivot plates together with a pivot tube, 3/8-16 x 3-3/4" lg. capscrew and locknut, using holes shown in figure 3.

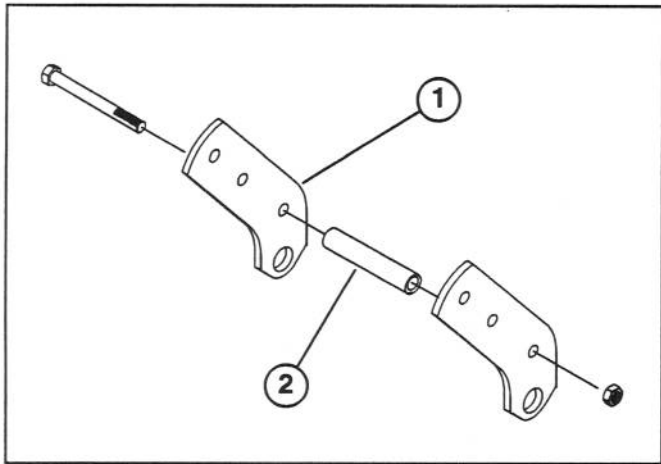

Figure 3
 1. Higher pivot brackets
 2. Pivot tube

4. Mount each set of rear pivot plates to right and left bed frame channels with capscrews and locknuts previously removed. Position brackets on full bed as shown in figure 4, and for 2/3 bed as shown in figure 5.

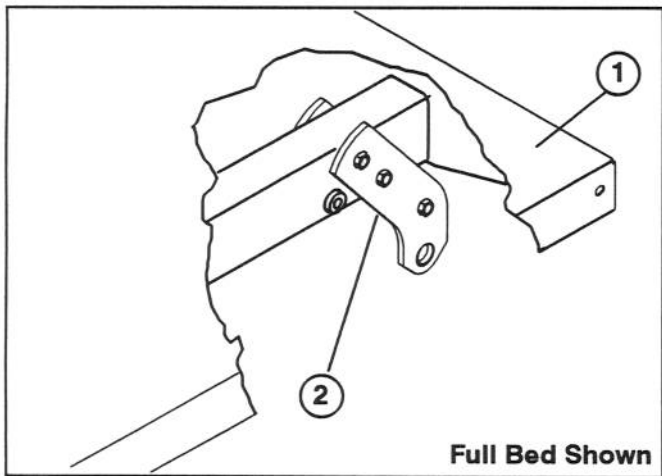

Figure 4
 1. Left rear corner of bed
 2. Higher pivot bracket

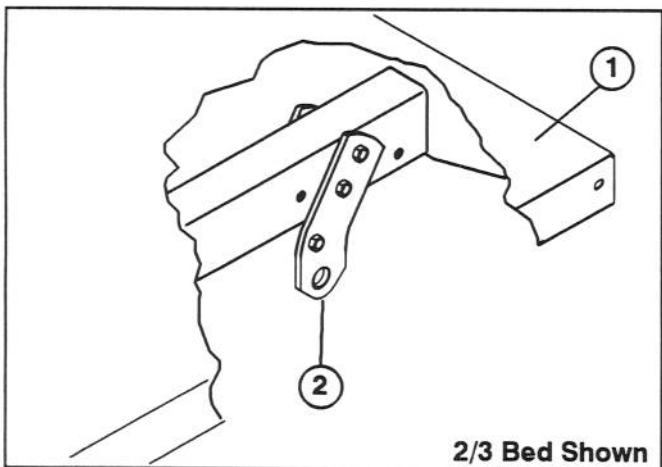

Figure 5
 1. Left rear corner of bed
 2. Higher pivot bracket

5. Remove machine screws and locknuts securing the (2) spacer blocks and shims to front, under side of bed (Fig. 6).

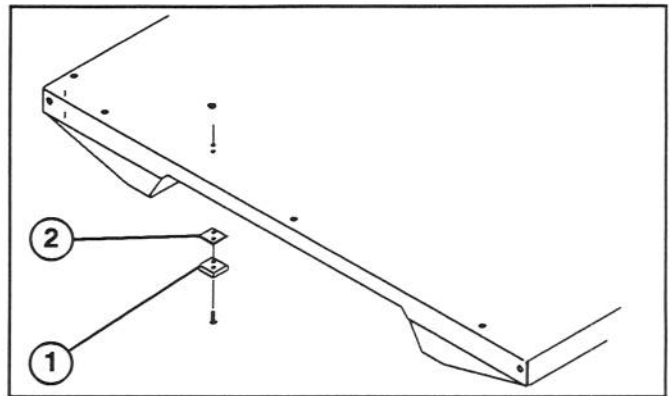

Figure 6
 1. Spacer block
 2. Shim

6. Remount the spacer blocks and new box spacers to underside of bed with new longer machine screws and locknuts (Fig. 7).

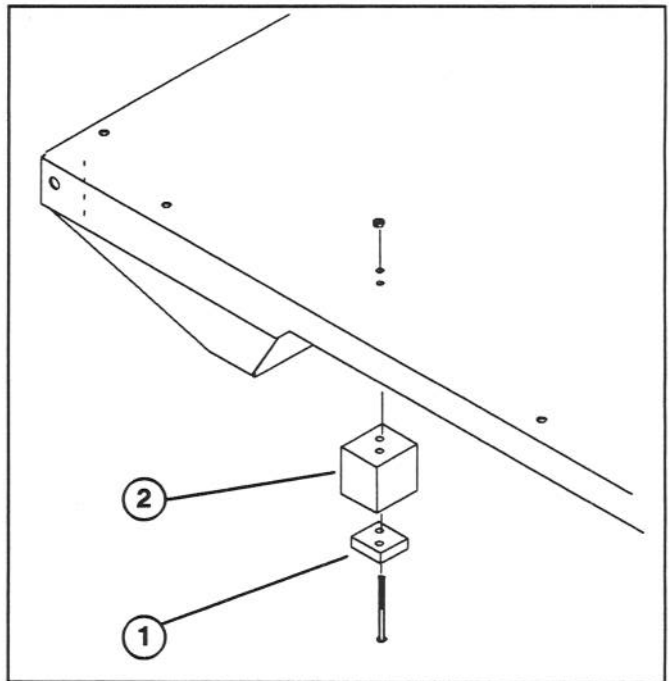

Figure 7
 1. Spacer block
 2. Box spacer

INSTALL FULL SIZE FLAT BED

NOTE: If bed sides will be installed on flat bed, it is easier to install them before bed is installed on vehicle.

NOTE: On a Workman 3000 with a full flat bed, assure rear pivot plates are bolted to the bed frame/channel so that lower end angles to the rear (Fig. 4).

1. Remove clevis pins and lynch pins installed to bed pivot brackets for shipping.
2. Assure lift cylinders are fully retracted.

CAUTION: The full bed weighs approximately 210 pounds, so do not try to install or remove it by yourself. Get the help of two or three other people.



3. Carefully set bed onto vehicle frame aligning rear bed pivot plate holes with holes in rear frame channel (Fig. 8).

Note: Loosen capscrews securing pivot plates to bed channel to ease alignment of holes, if required.

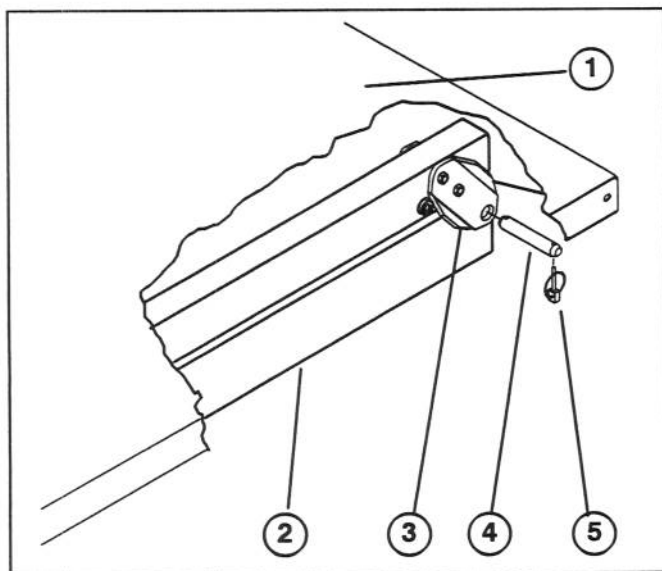

Figure 8

- | | |
|----------------------------|---------------|
| 1. Left rear corner of bed | 4. Clevis pin |
| 2. Vehicle frame channel | 5. Lynch pin |
| 3. Pivot plate | |

4. Secure each set of pivot plates to frame channels with a clevis pin and (2) lynch pins (Fig. 8). Tighten pivot plate mounting capscrews if previously loosened.

5. With bed lowered, secure each cylinder rod end, to appropriate slots in bed mounting plates with clevis pin and lynch pin. Insert clevis pin from outside of bed with lynch pin toward outside (Fig. 9). Rear slots are for full

bed installation and front slots are for 2/3 bed installation.

NOTE: Engine may need to be started to extend or retract cylinders for alignment with holes. **Keep fingers out!**

Note: Plug unused slot with a capscrew and nut to prevent assembly errors.

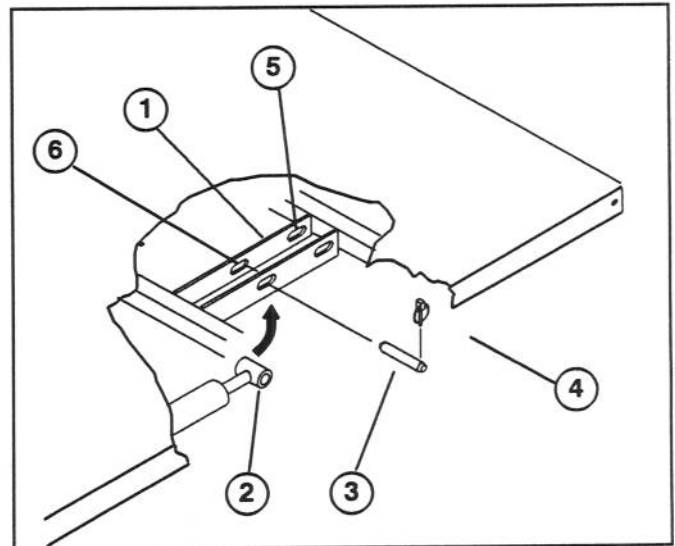

Figure 9

- | | |
|-----------------------|--------------------------|
| 1. Bed mounting plate | 4. Lynch pin |
| 2. Cylinder rod end | 5. Rear slots (Full bed) |
| 3. Clevis pin | 6. Front slots (2/3 bed) |

6. Start engine and engage hydraulic lift lever to raise bed. Release lift lever and turn off engine. Secure raised bed with a hoist or block it to prevent it from accidentally falling.

7. Install lynch pins to inside ends of clevis pins.

NOTE: If automatic tail gate release has been installed on bed, make sure front dump link rod has been placed on inside of left side clevis pin before lynch pin is installed.

8. Once cylinder installation has been completed, the bed safety support can be used to prevent accidental lowering of the bed.

9. To use bed safety support:

- A. Raise bed until cylinders are fully extended.
- B. Remove bed support from storage stud on top of back rest support channel on Workman (Fig. 10).
- C. Push bed support onto cylinder rod, making sure support end tabs rest on end of cylinder barrel and on cylinder rod end (Fig. 11).
- D. To store bed support, remove bed support from cylinder and insert on stud on top of back rest support channel.
- E. Always install or remove bed support from outside of bed.
- F. Do not try to lower bed with bed safety support on cylinder.

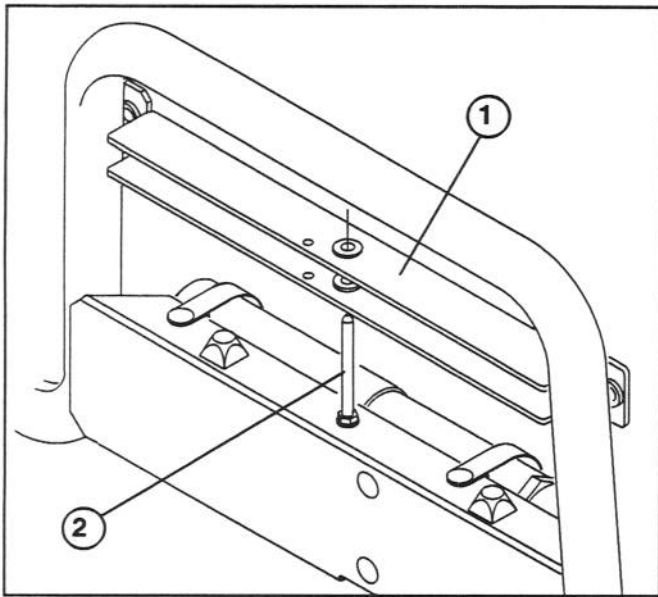

Figure 10

1. Bed support
2. Storage stud

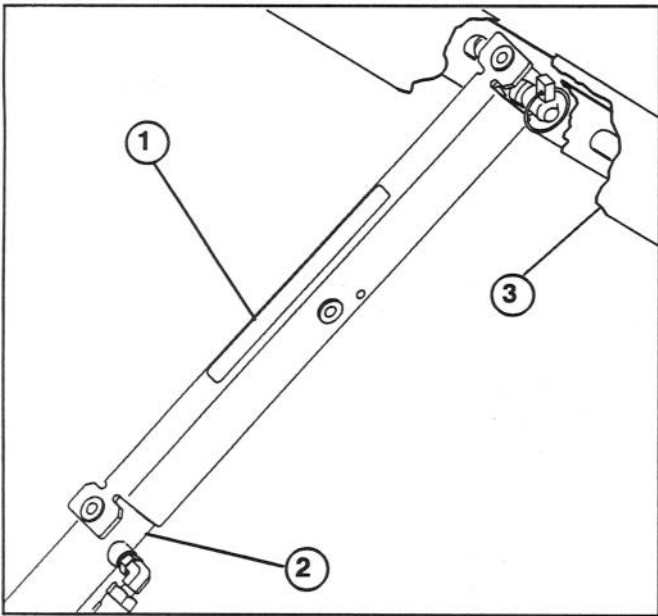

Figure 11

1. Bed support
2. Cylinder barrel
3. Bed

10. Remove bed safety support from cylinder and place on storage stud.

11. Start engine and engage hydraulic lift lever to lower bed. Release lift lever and turn off engine.

INSTALL 2/3 SIZE FLAT BED

Same as full bed installation except for the following:

1. Rear pivots plates are to be mounted so lower ends angle forward.
2. Rear slots are for full bed installation and front slots are for 2/3 bed installation.

WARNING: The 1/3 mid-area must be covered when the 2/3 bed is used on the Workman. This can be done by installing 1/3 bed, 1/3 tool box or 1/3 cover.

FULL & TWO-THIRDS BED REMOVAL

1. Start engine. Engage hydraulic lift lever and lower bed until cylinders are loose in slots. Release lift lever and turn off engine.

2. Remove lynch pins from outer ends of cylinder rod clevis pins.

3. Remove clevis pins securing cylinder rod ends to bed mounting plates by pushing pins towards inside.

4. Remove lynch pins and clevis pins securing pivot brackets to frame channels.

5. Lift bed off vehicle.

CAUTION: The full bed weighs approximately 210 pounds, so do not try to install or remove it by yourself. Get the help of two or three other people.

6. Store cylinders in storage clips. Engage hydraulic lift lock lever on vehicle to prevent accidental extension of lift cylinders.