



Door Kit with Sliding Window

Workman® MDX or HDX Utility Vehicle

Model No. 07356

Model No. 07393

Form No. 3385-461 Rev A

Installation Instructions

⚠ WARNING

CALIFORNIA Proposition 65 Warning

This product contains a chemical or chemicals known to the State of California to cause cancer, birth defects, or reproductive harm.

Installation

1

Preparing to Install the Door Kit

No Parts Required

Procedure

1. Move the machine to a level surface and set the parking brake.
2. Shut off the engine, set the parking brake, and remove the key from the ignition switch.

2

Installing the Doors

Parts needed for this procedure:

1	Right-hand door
1	Left-hand door
2	Ball stud
2	Locknut (5/16 inch)
2	Door strut
4	Washer

Procedure

1. Insert the ball stud through the rear hole in the bracket on the cab frame, and install the locknut (5/16 inch) onto the ball stud (Figure 1).

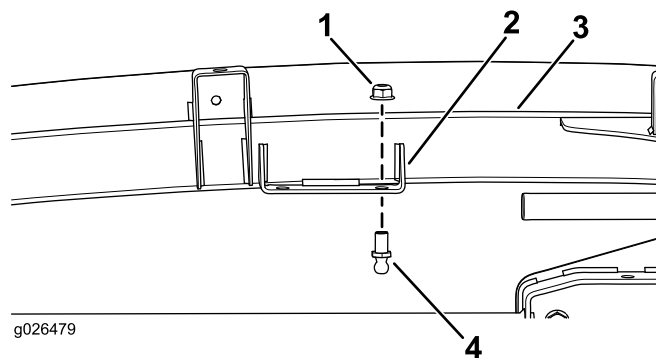

Figure 1

- | | |
|------------------------|--------------|
| 1. Locknut (5/16 inch) | 3. Frame |
| 2. Bracket | 4. Ball stud |



2. Install the 4 washers over the 4 hinge pins at the cab frame for the machine (Figure 2).
3. Install the door onto the hinge pins mounted on the cab frame (Figure 2).

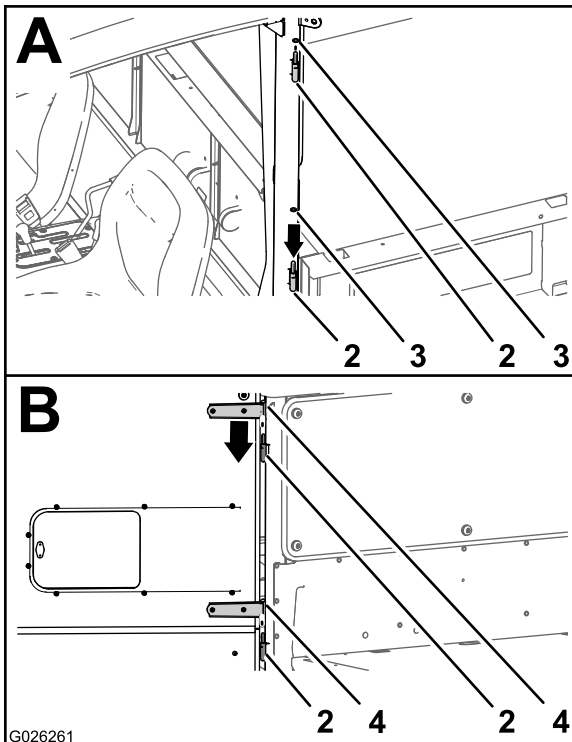
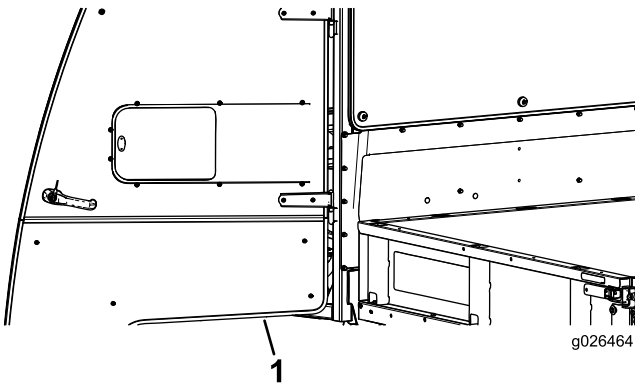

Figure 2

- | | |
|---------------|---------------------|
| 1. Door | 3. Washer |
| 2. Hinge pins | 4. Door-hinge mount |

4. Install the fitting at the rod end of the door strut onto the ball stud at the cab frame (Figure 3).

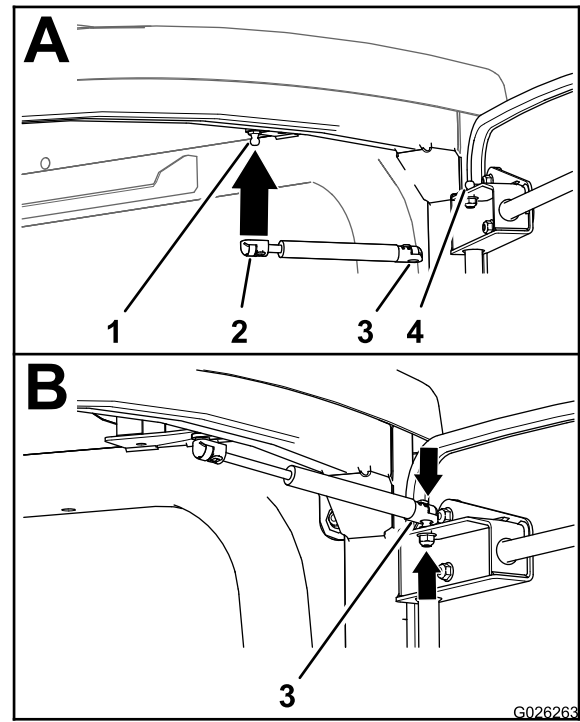

Figure 3

- | | |
|--------------------------|-----------------------------|
| 1. Ball stud (cab frame) | 3. Fitting (strut cylinder) |
| 2. Fitting (strut rod) | 4. Ball stud (door frame) |

Note: The door-fitting strut has a quick-release end. Flip the lever vertically for installation. Once installed, close the lever to capture the ball stud (Figure 4).

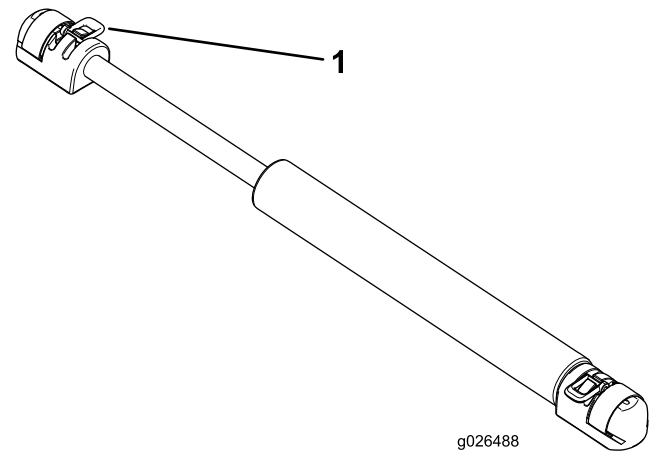

Figure 4

1. Lever

5. Install the fitting at the cylinder end of the strut onto the ball stud at the door frame (Figure 3).

3

Assembling the Latch Pins

Parts needed for this procedure:

2	Hex nut (7/16 inch)
2	Latch pin
2	Latch-pin cam
4	Thrust washer
2	Pin guard

Procedure

1. Align the latch-pin cam with the opening at the striker plate in the position shown in Figure 5.

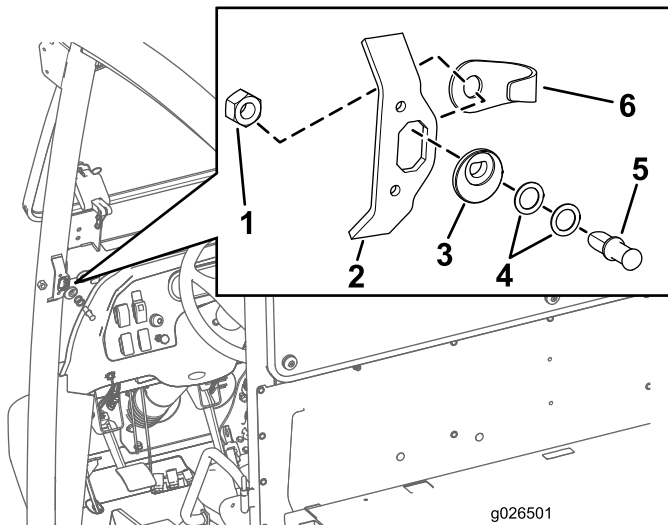

Figure 5

- | | |
|------------------------|------------------|
| 1. Hex nut (7/16 inch) | 4. Thrust washer |
| 2. Striker plate | 5. Latch pin |
| 3. Latch-pin cam | 6. Pin guard |

2. Insert the latch pin (without the washers at first) into the latch-pin cam (Figure 5).

Note: If the latch pin is not centered in the door latch, add 1 or 2 of the thrust washers.

3. Align the pin guard and the hex nut (7/16 inch) onto the back side of the opening at the strike plate (Figure 5).
4. Tighten the hex nut (7/16 inch) onto the latch pin, so it is finger tight (Figure 5).

4

Assembling the Door Lanyards

Parts needed for this procedure:

2	Lanyard
4	Shoulder bolt (5/16 x 1/2 inch)
4	Locknut (5/16 inch)

Procedure

1. Assemble the lanyard to the door-frame hinge with a shoulder bolt (5/16 x 1/2 inch) and a locknut (5/16 inch) as shown in Figure 6.

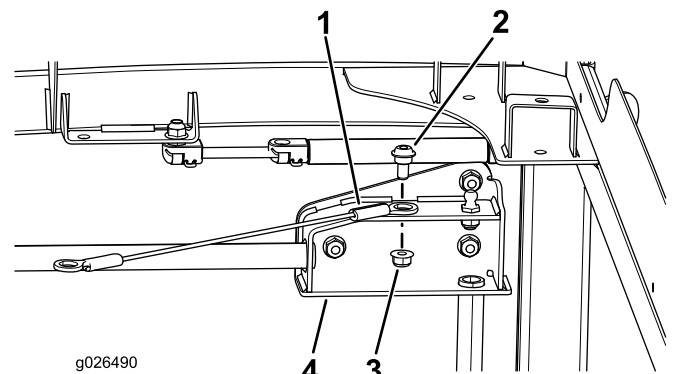

Figure 6

- | | |
|------------------------------------|------------------------|
| 1. Lanyard | 3. Locknut (5/16 inch) |
| 2. Shoulder bolt (5/16 x 1/2 inch) | 4. Door-frame hinge |

2. Assemble the other end of the lanyard to the cab frame forward-strut-bracket hole with a shoulder bolt (5/16 x 1/2 inch) and a locknut (5/16 inch) as shown in Figure 7.

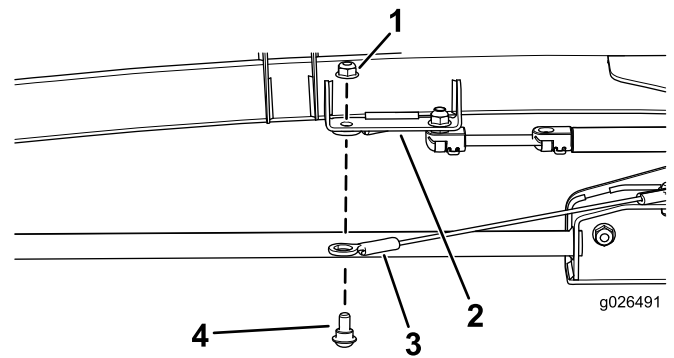

Figure 7

- | | |
|------------------------|------------------------------------|
| 1. Locknut (5/16 inch) | 3. Lanyard |
| 2. Bracket | 4. Shoulder bolt (5/16 x 1/2 inch) |

5

Adjusting the Door-latch Pin

No Parts Required

Procedure

1. Center the latch pin in the latch-pin-mount bracket on the rail (Figure 8).

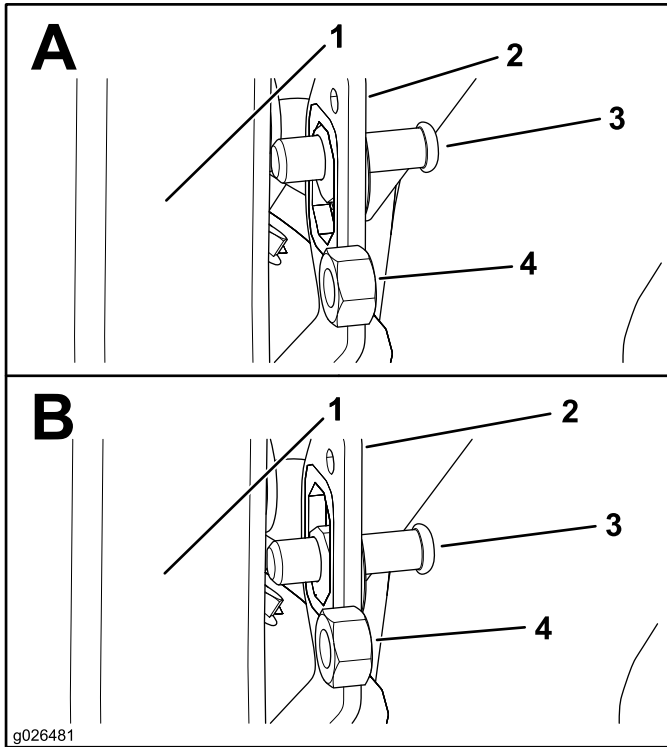

Figure 8

1. Cab frame
2. Latch-pin-mount bracket
3. Latch pin
4. Hex nut (7/16 inch)

2. Close the door completely and view where the latch pin comes into contact with the door latch.

Note: If the latch pin is not completely engage with the door latch, add 1 or 2 thrust washers between the latch-pin cam and the latch pin.

3. Close the door completely and measure the height of the bubble seal to the sealing surface of the cab rail, and ensure that the measurement is 1.9 to 2.2 cm (3/4 to 7/8 inch) as shown in Figure 9.

Note: If the height measured is more than the zone specification, rotate the latch-pin cam 45° toward the inside of the cab to achieve the specified measurement. If the height measured is less than the zone specification, perform the opposite of the above procedure.

Note: The latch pin will self center.

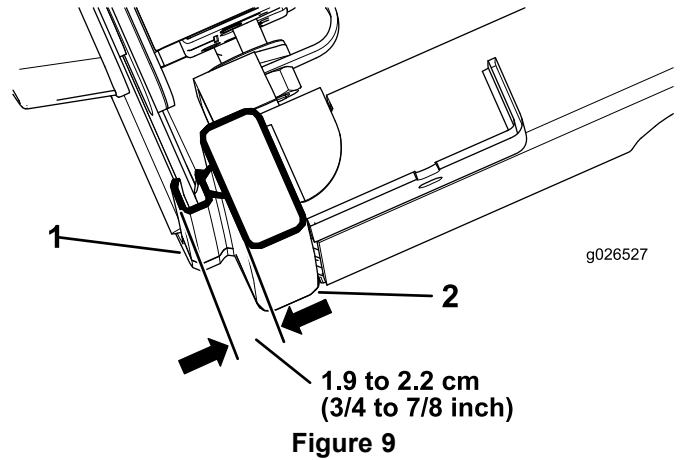

Figure 9

1. Bubble seal
2. Cab rail

4. Tighten the hex nut (7/16 inch) once the latch pin reaches 1.9 to 2.2 cm (3/4 to 7/8 inch) as shown in Figure 8.

Operation

Using the Door

1. Insert the key into the opening on the handle if the door is locked, and rotate the key to the open position (Figure 10).
2. Push the button on the handle and open the door (Figure 10).

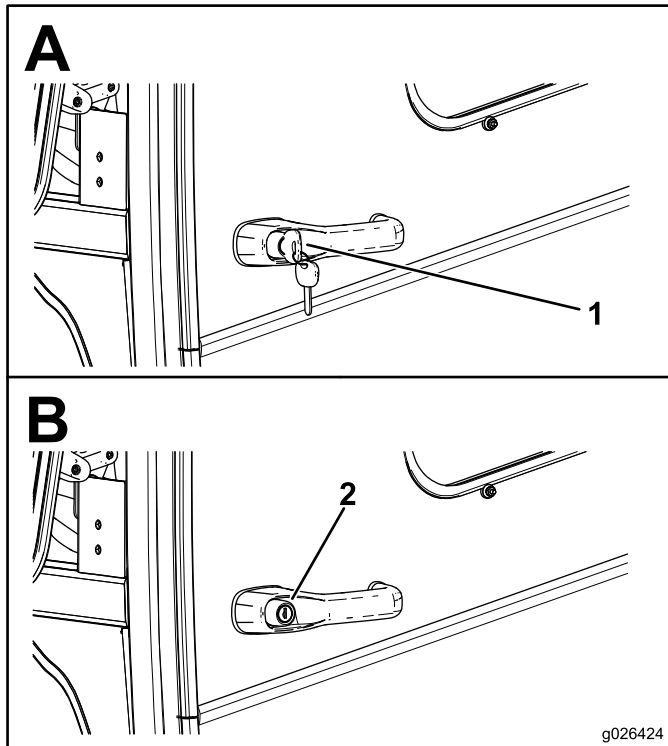

Figure 10

1. Key

2. Handle button

Operating the Sliding Window

Open the latch to open and close the sliding window (Figure 11).

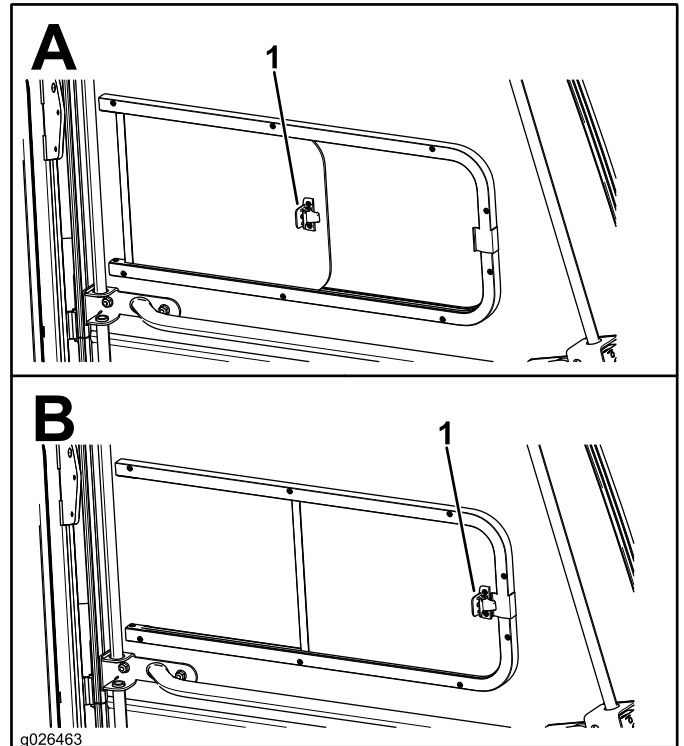

Figure 11

1. Window latch

Notes:

Notes:



Count on it.