



Cargo Bed Installation Kit with Manual Dump or Electric Lift

2011 to 2013 Workman® MD Series Utility Vehicle

Model No. 127-7385

Model No. 127-7386

Installation Instructions

Safety

⚠ WARNING

CALIFORNIA Proposition 65 Warning

This product contains a chemical or chemicals known to the State of California to cause cancer, birth defects, or reproductive harm.

Safety and Instructional Decals



Safety decals and instructions are easily visible to the operator and are located near any area of potential danger. Replace any decal that is damaged or lost.

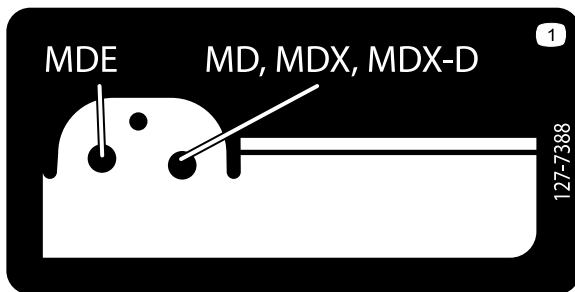

127-7388

1. Pin location



Installation

Loose Parts

Use the chart below to verify that all parts have been shipped.

Procedure	Description	Qty.	Use
1	No parts required	–	Prepare the machine.
2	No parts required	–	Remove the cargo box—machines with a manual cargo-box lift.
3	Pivot block Flanged-head bolts (3/8 x 1-1/2 inch)	2 4	Remove and install the pivot bracket assembly.
4	Latch assembly Flanged head bolt (5/16 x 3/4 inch) Hand grip	1 4 2	Install the latch assembly (machines with a manual cargo-box lift)
5	Prop rod Washer (1/2 inch) Hair pin	1 1 1	Install the prop rod.
6	Outboard-lift bracket Inboard-lift bracket Hex-head bolt (5/16 x 5-1/2 inch) Locknut (5/16 inch)	1 1 1 1	Prepare the new cargo box for installation.
7	No parts required	–	Install the cargo box.
8	No parts required	–	Adjust the cargo box latches.
9	Clevis pin (5 inch) Hairpin Hex-head bolt (1/2 x 5-1/2 inch) Locknut (1/2 inch)	1 1 1 1	Install the lift actuator.

Note: Determine the left and right sides of the machine from the normal operating position.

1

Preparing the to Remove the Box

No Parts Required

Procedure

1. Move the machine to a level surface, set the parking brake, turn the ignition off, and remove the key.
2. Completely unload the cargo box.
3. Ensure that the tailgate is closed.
4. Set the new cargo box upside down on the ground next to the machine.

Note: Protect the cargo box by placing cardboard or a tarp between the box and the ground.

⚠ WARNING

If you leave the key in the ignition switch, someone could accidentally start the machine and seriously injure you or other bystanders.

Remove the key from the ignition switch before you do any maintenance.

2

Removing the Cargo Box

No Parts Required

Machines with a Manual Cargo-box Lift

Cargo box weight: approximately 57 kg (126 lb)

1. Lift the latch lever that is at the either side near the forward corner of the cargo box, and fully raise the box up (Figure 1).

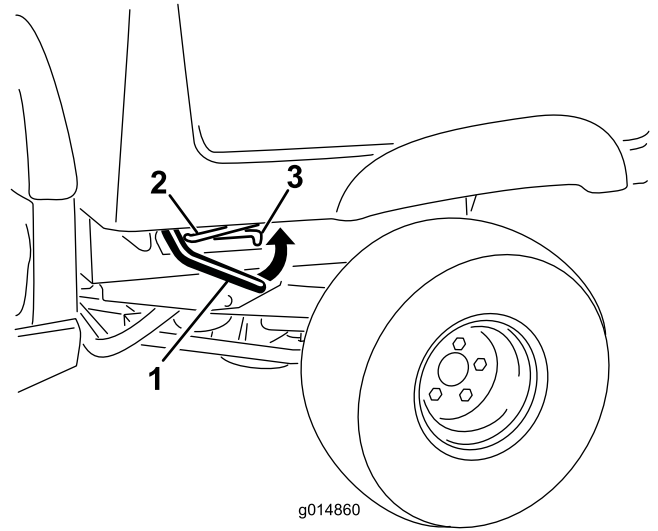

Figure 1

1. Latch lever
2. Prop rod
3. Detent slot

2. Secure the cargo box by pulling the prop rod into the rear detent at end of the slot that is in the left frame of the machine (Figure 1).

Note: For machines with a bolt on rod-support bracket, pull the prop rod into the rear detent at end of the slot in the bracket.

3. Attach lifting equipment to the front and back ends of the cargo box.

Note: Raise the lifting equipment at the front end of the box until the front of the box is supported.

4. Remove the 2 carriage bolts (5/16 x 5 inch) and 2 serrated nuts(5/16) that secure the saddle bracket and the upper end of the prop rod to the box (Figure 2).

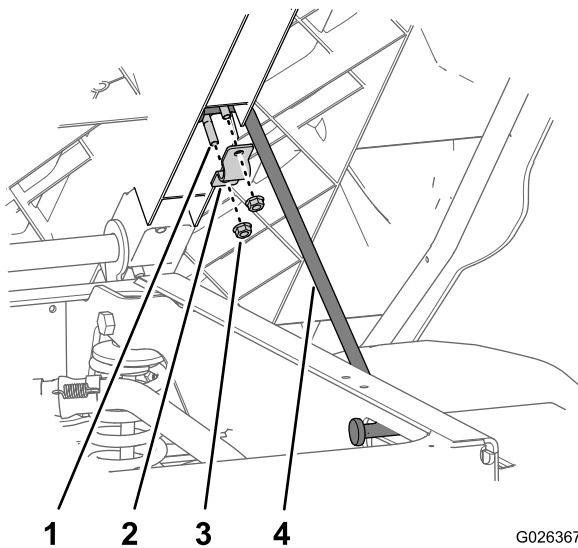

Figure 2

1. Carriage bolt (5/16 x 5 inch)
2. Saddle bracket
3. Serrated nut
4. Prop rod

5. Slide the lower end of the prop rod to the forward end of the prop-rod slot in the left-frame channel or rod-support bracket of the machine (Figure 3).

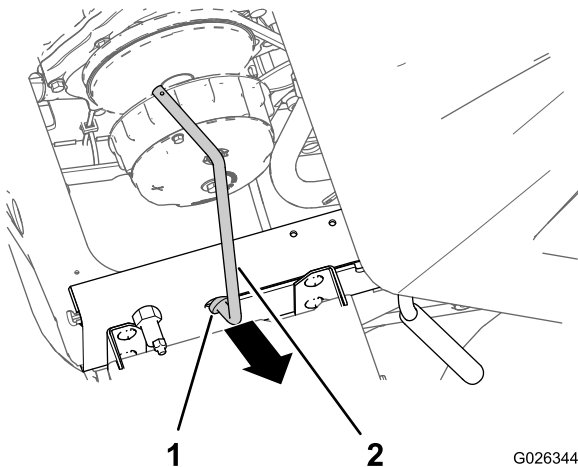

Figure 3

1. Key hole—end of the prop rod slot (machine with the prop-rod slot in the frame channel shown, machines with a rod-support bracket are similar)
2. Prop rod

6. Remove the prop rod through the key hole at the forward end of the slot for the prop rod (Figure 3).

Note: Discard the old prop rod, washer (1/2 inch), and hairpin.

7. Lower the front of the box.
8. Remove the 4 flanged-head bolts (3/8 x 1 inch) that secure the hinge brackets of the cargo box to the rear-frame channel of the machine (Figure 4).

Note: Retain the flanged-head bolts for installation of the new cargo box.

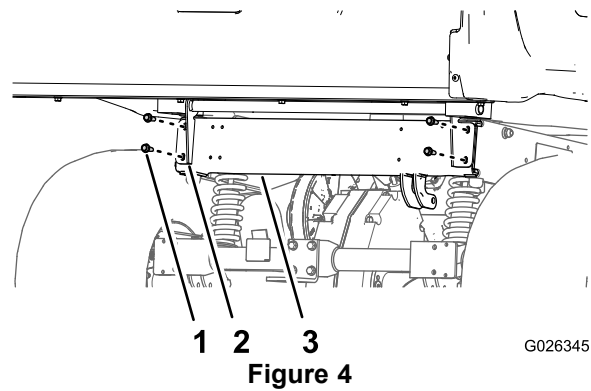

Figure 4

1. Flanged-head bolts (3/8 x 1 inch)
2. Hinge bracket
3. Rear-frame channel

9. Lift the latch lever that is at the either side near the forward corner of the cargo box (Figure 1).
10. Lift the cargo box up and off of the machine (Figure 5).

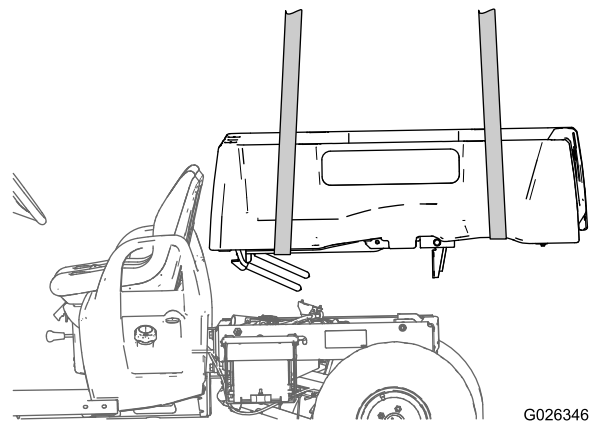

Figure 5

11. Rotate the cargo box upside down and set it on the ground.

Machines with a Electric Cargo-box Lift

Cargo box weight: approximately 57 kg (126 lb)

1. Rotate the key switch to the On position (Figure 6).

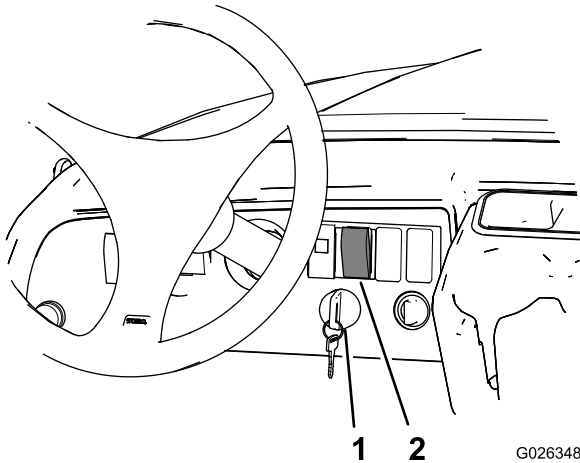

Figure 6

1. Key switch
2. Lift switch (cargo box)

2. Press the upper half of the cargo box lift switch until the cargo box is fully raised (Figure 6).
3. Rotate the key switch to the Off position (Figure 6).
4. Attach lifting equipment to the front and back ends of the cargo box.

Note: Raise the lifting equipment at the front end of the box until the front of the box is supported.

5. Remove the hair pin and clevis pin from the lift bracket (Figure 7).

Note: Discard the old hair pin and clevis pin.

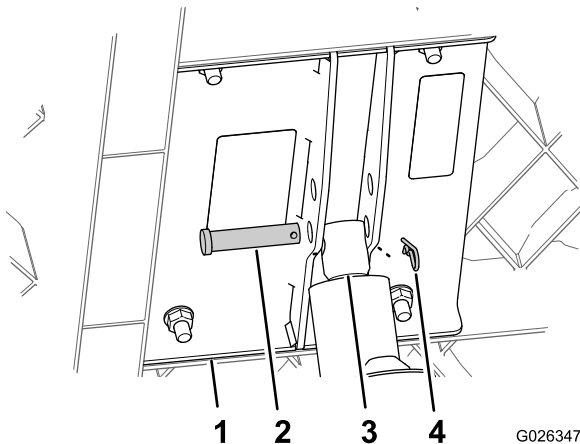

Figure 7

1. Lift bracket
2. Clevis pin
3. Lift-actuator rod
4. Hair pin

6. Separate the rod on the cargo-box actuator from the lift bracket(s) (Figure 7).
7. Rotate the key switch to the On position (Figure 6).

8. Press the lower half of the cargo box lift switch until the cargo-box actuator is fully retracted (Figure 6).
 9. Rotate the key switch to the Off position (Figure 6).
 10. Lower the cargo box onto the chassis.
 11. Remove the 4 flanged-head bolts (3/8 x 1 inch) that secure the hinge brackets of the cargo box to the rear-frame channel of the machine (Figure 4).
- Note:** Retain the flanged-head bolts for installation of the new cargo box.
12. Lift the cargo box up and off of the machine (Figure 5).
 13. Rotate the cargo box upside down and set it on the ground.

3

Removing and Installing the Pivot Bracket Assembly

Parts needed for this procedure:

2	Pivot block
4	Flanged-head bolts (3/8 x 1-1/2 inch)

Procedure

1. At the **old** cargo box, remove the 4 carriage bolts (3/8 x 5 inch) and 4 serrated nuts (3/8 inch) that secure the 2 pivot blocks and pivot-bracket assembly to the bottom box (Figure 8).

Note: Discard the old pivot blocks.

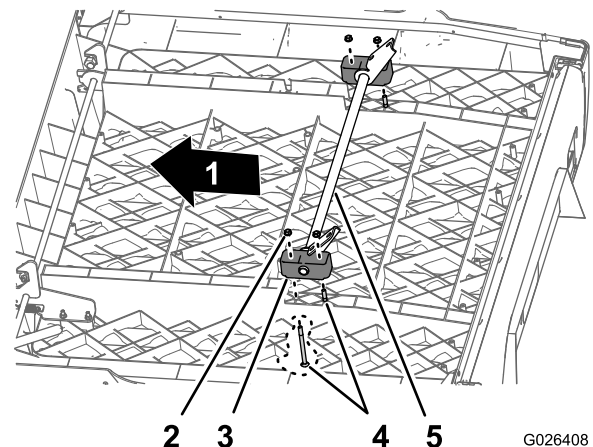
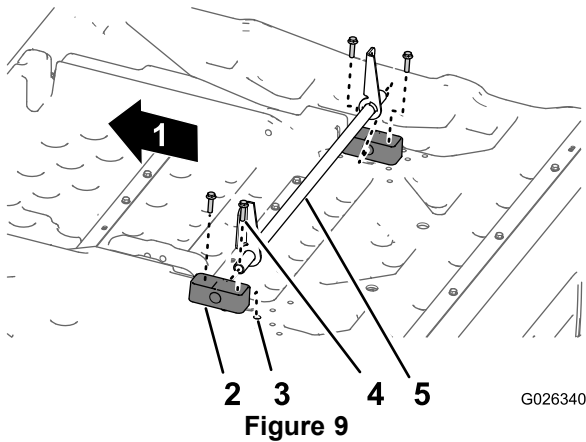

Figure 8

1. Forward
2. Flanged nuts
3. Pivot blocks
4. Carriage bolts
5. Pivot-bracket assembly

2. Insert the tube end of the pivot-bracket assembly into the pivot block (Figure 9).



1. Forward
2. Pivot blocks
3. Threaded inserts (cargo box)
4. Flanged-head bolts (3/8 x 1-1/2 inch)
5. Pivot-bracket assembly

3. Install the other pivot block over the other tube end of the pivot-bracket (Figure 9).
4. At the **new** cargo box, align the holes of a new pivot block to the threaded inserts in the cargo box, attach the block with the 4 flanged-head bolts (3/8 x 1-1/2 inch) and tighten the bolts hand tight (Figure 9).
5. Torque the flanged-head bolts to 37 to 45 N-m (27 to 33 ft-lb).

4

Installing the Latch Assembly (machines with a manual cargo-box lift)

Parts needed for this procedure:

1	Latch assembly
4	Flanged head bolt (5/16 x 3/4 inch)
2	Hand grip

Procedure

1. Align the holes in the latch assembly from the kit to the threaded insert in the new cargo box (Figure 10).

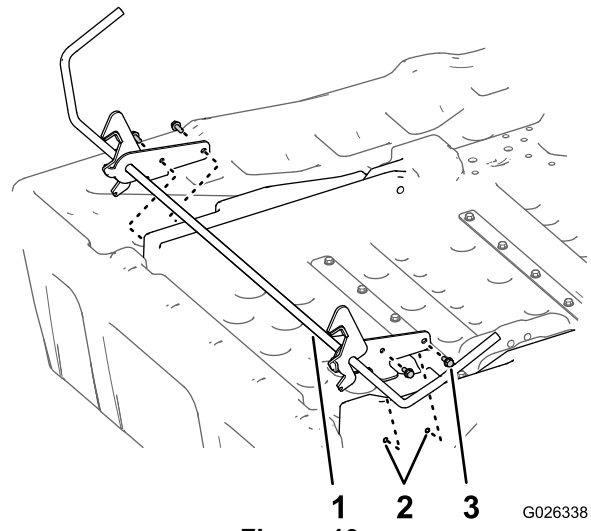

1. Latch assembly
2. Threaded inserts (cargo box)
3. Flanged head bolt (5/16 x 3/4 inch)

2. Attach the latch to the cargo box with 4 flanged head bolts (5/16 x 3/4 inch); refer to Figure 10.
3. Torque the bolts to 15 to 17 N-m (133 to 147 in-lb)
4. Slip the hand grips onto each end of the lever of the latch assembly (Figure 11).

Note: Use a solution of soapy water on the lever to ease assembly of hand grips.

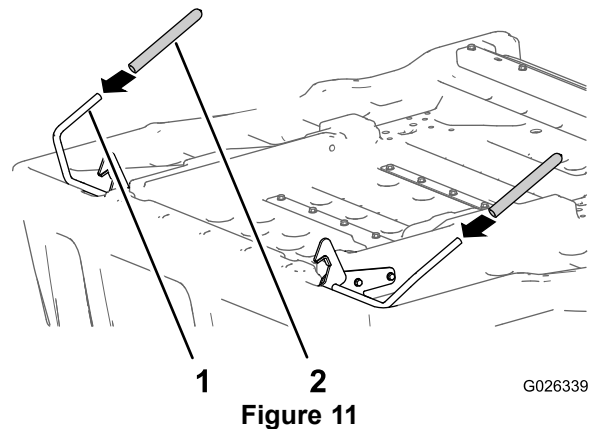

1. Handle lever (latch assembly)
2. Hand grip

5. Align the long tang of a spring to the spring saddle of the latch assembly (Figure 12).

5

Installing the Prop Rod (machines with a manual cargo-box lift)

Parts needed for this procedure:

1	Prop rod
1	Washer (1/2 inch)
1	Hair pin

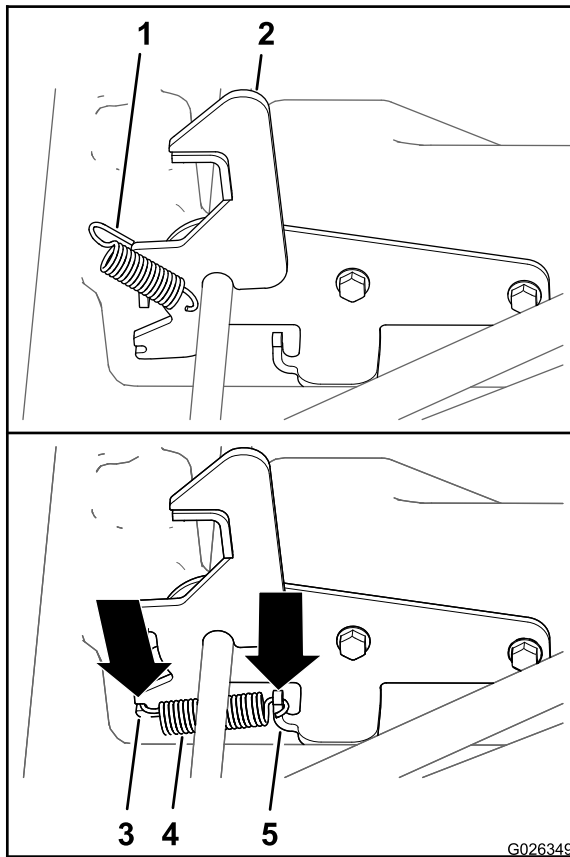

Figure 12

1. Long tang (spring)
2. Latch assembly
3. Spring saddle
4. Spring
5. Spring post

6. Connect the short tang of the spring to the spring post of the latch (Figure 12).
7. Repeat steps 5 and 6 for the other latch and spring (Figure 12).

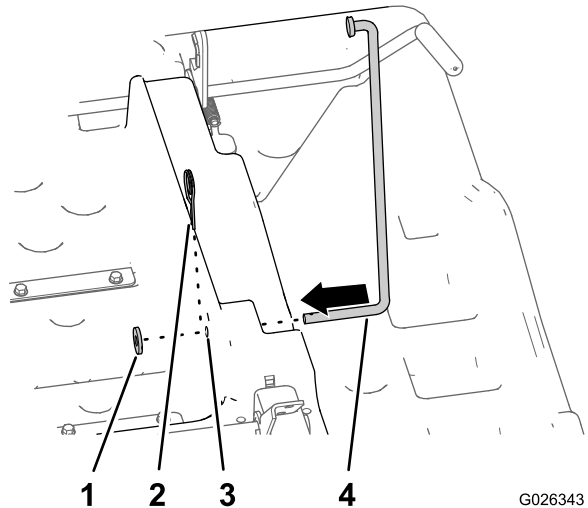

Figure 13

1. Washer (1/2 inch)
2. Hair pin
3. 12.7 mm (1/2 inch) hole (cargo box)
4. Prop rod (long leg)

2. Align a washer (1/2 inch) over the long leg of the prop rod and secure the rod to the cargo bed with a hair pin (Figure 13).
3. Secure the prop rod by taping it against the box

6

Installing the Lift Brackets (machines with a electric cargo-box lift)

Parts needed for this procedure:

1	Outboard-lift bracket
1	Inboard-lift bracket
1	Hex-head bolt (5/16 x 5-1/2 inch)
1	Locknut (5/16 inch)

Procedure

1. Remove the 2 left-most bolts (5/16 x 3/4 inch) that secure upper-bed brace to the bed (Figure 14).

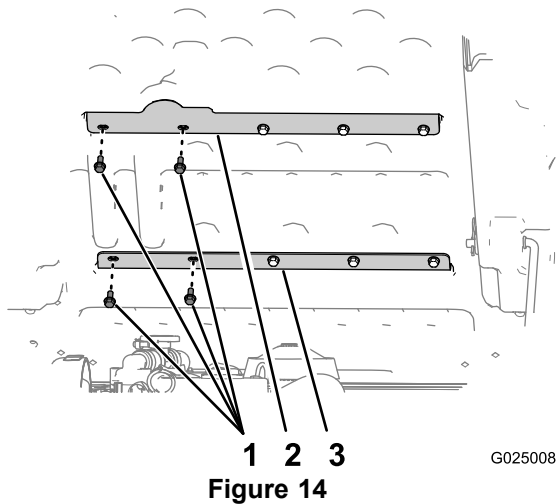

1. Bolts (5/16 x 3/4 inch)
2. Upper-bed brace
3. Lower-bed brace

2. Remove the 2 left-most bolts (5/16 x 3/4 inch) that secure lower-bed brace to the bed (Figure 14).

Note: Retain the 4 bolts for installation.

3. Align the left outboard-lift bracket (the bracket with the short flanges) to the outboard holes in the upper- and lower-bed braces (Figure 15).

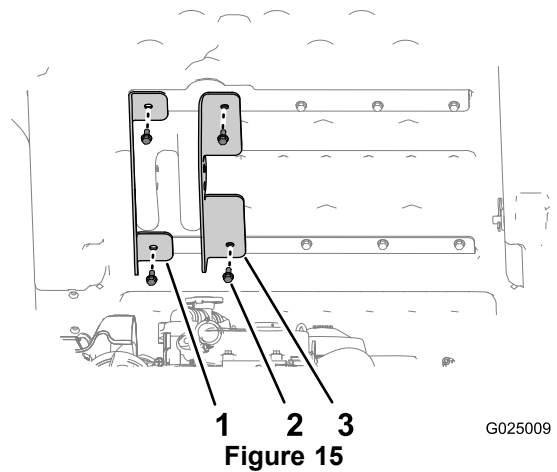

1. Outboard-lift bracket (short flanges)
2. Bolts (5/16 x 3/4 inch)
3. Inboard-lift bracket (long flanges)

4. Attach the outboard-lift bracket to the bed with the 2 bolts that you removed in step 1 and tighten the bolts hand tight (Figure 15).
5. Align the inboard-lift bracket (the bracket with the long flanges) to the inboard holes in the upper- and lower-bed braces (Figure 15).
6. Attach the inboard-lift bracket to the bed with the 2 bolts that you removed in step 2 and tighten the bolts hand tight (Figure 15).
7. Insert the hex-head bolt (5/16 x 5-1/2 inch) through 7.9 mm (5/16 inch) hole in the inboard-lift bracket (long flanges), bed structure, and the outboard bed-lift bracket (short flanges) as shown in Figure 16.

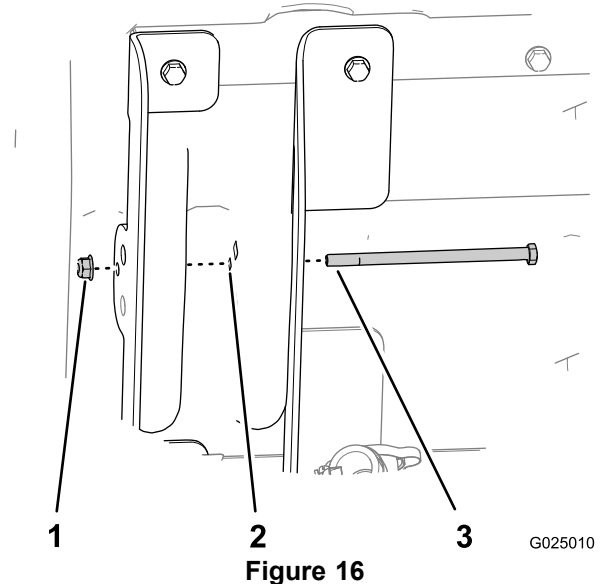

1. Locknuts (5/16 inch)
2. 7.9 mm (5/16 inch) hole
3. Hex-head bolt (5/16 x 5-1/2 inch)

8. Secure the bolt with the flange nut (5/16 inch) hand tight (Figure 16).

7

Installing the Cargo Box

No Parts Required

Machines with a Manual Cargo-box Lift

1. Rotate the cargo box so that the pivot-bracket assembly and prop rod are down.
2. Using lifting equipment at the front and back of the cargo box, raise the cargo box and align it over the frame of the machine with the pivot-bracket assembly rearward (Figure 17)

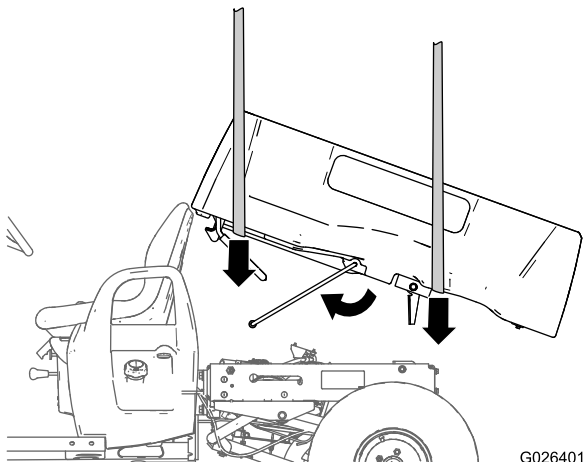

Figure 17

G026401

3. Remove the tape that is securing the prop rod to the cargo box that you installed in step 3 of 5 Installing the Prop Rod (machines with a manual cargo-box lift) (page 7).
4. Adjust the height and position of the lifting equipment so that the short leg of the prop rod is aligned with the key hole at the end of the prop-rod slot in the left-frame channel or prop rod bracket (Figure 17).

Note: You will have to angle the cargo box with the lifting equipment in order to align the prop rod to the key hole.

5. Swing the prop rod forward and insert the short leg of the rod through the key hole (Figure 17 and Figure 18).

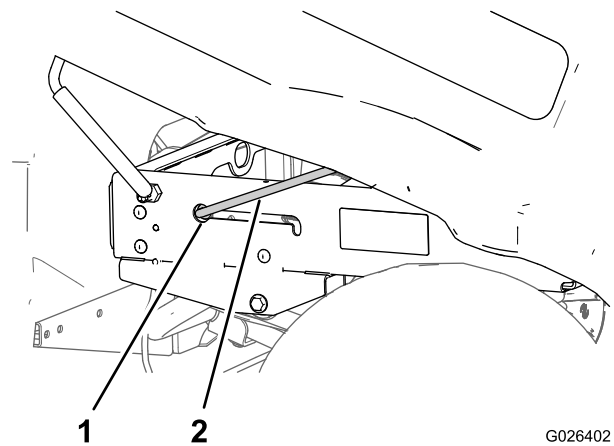

Figure 18

G026402

1. Key hole (prop-rod slot)
2. Prop rod

6. Move the cargo box and prop rod rearward until the pivot-bracket assembly is aligned over the rear-frame channel (Figure 18).
7. Carefully lower the cargo box until the holes in the pivot brackets align with the mounting holes for the cargo box in the rear-frame channel (Figure 19).

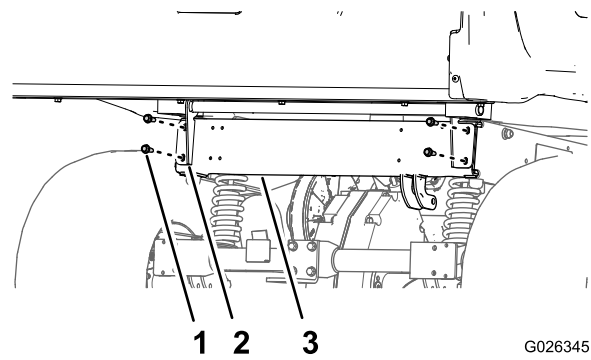

Figure 19

G026345

1. Flanged-head bolts (3/8 x 1 inch)
2. Hinge bracket
3. Rear-frame channel

8. Attach the pivot brackets to the rear-frame channel with the 4 flanged-head bolts (3/8 x 1 inch) that you removed in step 8 of Machines with a Manual Cargo-box Lift (page 3); refer to Figure 19.
9. Torque the flanged-head bolts to 37 to 45 N-m (27 to 33 ft-lb).

Machines with a Electric Cargo-box Lift

- 1. Rotate the new cargo box so that the pivot-bracket assembly is down.
- 2. Using lifting equipment, lift the cargo box and position it over the frame of the machine so that the pivot-bracket assembly is aligned over the rear-frame channel (Figure 20).

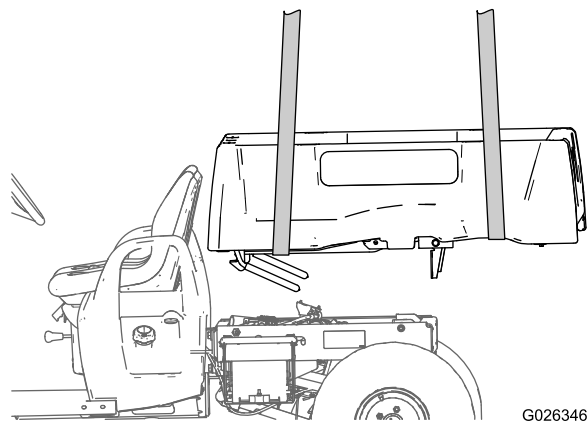

Figure 20

G026346

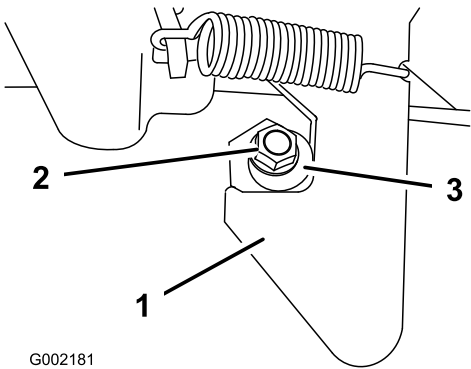

Figure 21

- 1. Latch
- 2. Locknut
- 3. Latch post

- 3. Pull up on the latch lever of the cargo-box latch, push down on the front of the cargo box until it is fully seated, and release the latch lever.

Note: If the cargo-box latch is out of adjustment, the cargo box vibrates up and down as you drive the vehicle. You can adjust the latch posts to make the latches hold the cargo box snugly to the chassis.

- 4. Loosen the locknut on the end of the latch post (Figure 21).
- 5. Rotate the latch post clockwise until it is snug against the hook portion of the latch (Figure 21).
- 6. Torque the locknut to 19.7 to 25.4 N-m (175 to 225 in-lb).
- 7. Repeat steps 1 through 3 for the latch on the other side of the vehicle.

8

Adjusting the Cargo-box Latches (machines with a manual cargo-box lift)

No Parts Required

Procedure

- 1. Release the prop rod for the cargo box by moving the short leg of the rod out of the rear detent.
- 2. Gently lower the front of the cargo box until the latch contacts the latch post (Figure 21).

Note: The latch post should align to the ramped portion of the latch.

9

Installing the Lift Actuator (machines with a electric cargo-box lift)

Parts needed for this procedure:

1	Clevis pin (5 inch)
1	Hairpin
1	Hex-head bolt (1/2 x 5-1/2 inch)
1	Locknut (1/2 inch)

Procedure

- 1. Remove the lifting equipment from the rear part of the cargo box.

Note: Do not remove the lifting equipment from the front part of the cargo box.

2. Raise the front of the cargo box until the box is approximately at a 45° angle to the chassis of the machine.
3. Rotate the key switch to the On position (Figure 22).

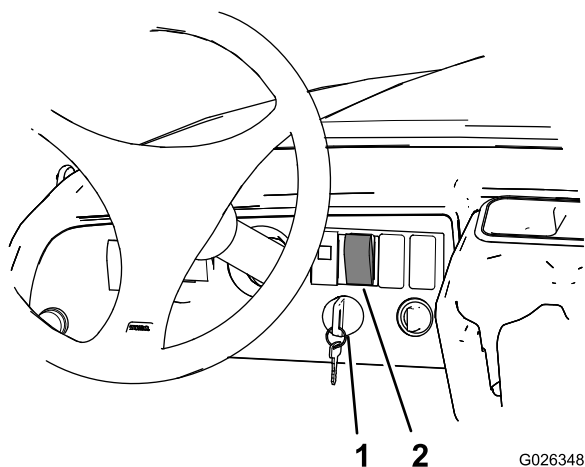

Figure 22

1. Key switch
2. Lift switch (cargo box)

4. Press the upper half of the cargo box lift switch until the cargo-box actuator is fully extended (Figure 22).
5. Rotate the key switch to the Off position (Figure 22).
6. Identify which hole of the outboard- and inboard-lift brackets the clevis pin for the lift-actuator rod is located for you machine type; refer to the decal in the inboard bracket (Figure 23).

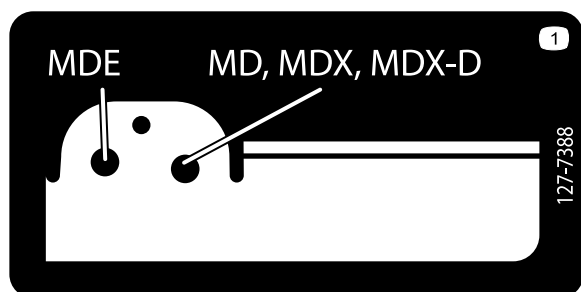

Figure 23

1. Pin location

7. Align the hole in the rod end of the cargo-box actuator to the lift bracket(s).

Note: Select the set of holes in the bracket for the gasoline and diesel machines, or electric vehicles; refer to Safety and Instructional Decals (page 1) for the hole locations for this machine.

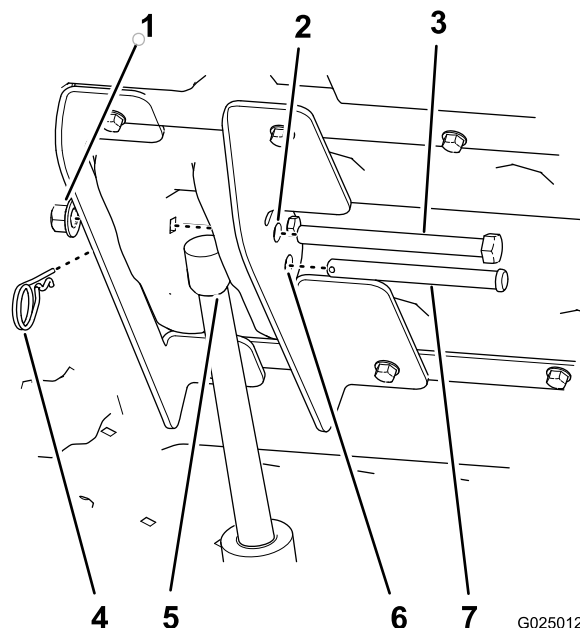

Figure 24

1. Lock nut (1/2 inch)
2. 12.7 mm (1/2 inch) hole for the hex-head bolt
3. Hex-head bolt (1/2 x 5-1/2 inch)
4. Hair pin
5. Lift-actuator rod
6. 12.7 mm (1/2 inch) hole for the clevis pin
7. Clevis pin (3-1/2 inch)

8. Secure the lift-actuator rod to the lift brackets with clevis pin (3-1/2 inch) and hairpin (Figure 24).

Note: Tighten the locknut and flange nut until they are snug.

9. Tighten the 4 bolts (5/16 x 3/4 inch) that secure the inboard and outboard-lift brackets to the bed (Figure 15) to 15 to 16.6 N-m (133 to 147 in-lb).
10. Align the hex-head bolt (1/2 x 5-1/2 inch) through the remaining 12.7 mm (1/2 inch) holes in the inboard and outboard-lift brackets (Figure 24) and secure it with a nut (1/2 inch) until the flange nut is snug.
11. Tighten the flange nut that secure the bolt (5/16 inch) it is snug (Figure 16).



Count on it.