



Trailer Brake Kit

Workman® HD/HDX/HDX-D Series Utility Vehicle

Model No. 125-0123

Installation Instructions

Loose Parts

Use the chart below to verify that all parts have been shipped.

Description	Qty.	Use
Brake-control harness	1	Install the brake kit.
Brake controller	1	
Wire harness	1	
Screw (10-24 x 7/8 inch)	2	
Locknut	2	
Cable tie	1	

Installing the Brake Kit

Note: The trailer brake kit designed to work directly with a Toro Pro Sweep, but can be used in custom applications. For any custom application, it is recommended that a standard trailer connector (not provided) be used. Also, the trailer connector must be grounded to the vehicle ground located near the battery.

Note: Make sure the machine is off and the key is removed.

1. Using the controller bracket as a template, locate, mark, and drill two 3/16 inch diameter holes in the center of the flat part of the dash to the left side of steering wheel as shown in (Figure 1).
2. Mount the brake controller to the dash panel with the 2 screws (10-24 x 7/8 inch) and locknuts provided (Figure 1).
3. Install the wire harness as follows:
 - A. Disconnect the battery.
 - B. Plug the wire harness into the brake-controller connector.
 - C. Plug the 4-terminal connector from the brake-control harness into the wire harness.
 - D. Attach the 2-terminal connector (one green, one black) to the mating open connector from the Workman vehicle's wire harness. This connector is located under the dash.
 - E. Attach the harness ring terminal to the ground bolt near the vehicle fuse block.
 - F. Plug the red harness wire into the red wire on the back of the fuse block.
 - G. Route the wire harness alongside the main vehicle wire harness to the rear of the vehicle.

- H. Secure the wire harness to the vehicle in several places with wire ties. Keep the harness away from any hot or rotating components.
- I. Connect the battery.

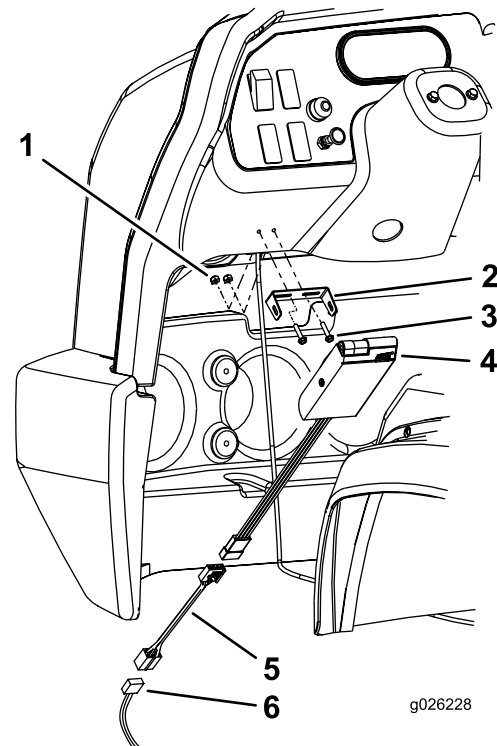

Figure 1

- | | |
|-----------------------|---|
| 1. Locknut | 4. Controller |
| 2. Controller bracket | 5. Wire harness |
| 3. Screw | 6. Brake-control harness (4-terminal connector) |



Operation

Using the Brakes

The electric trailer brakes are designed to actuate automatically whenever the brake pedal is depressed. To actuate the trailer brakes alone, depress the black manual override button on the front of the brake controller. Always ensure the trailer brakes are connected and functioning properly before using the equipment.

1. Before operating, check to see if the controller is functioning by setting the brake output control to maximum and depressing and holding down the brake pedal of the Workman. The indicator light should glow red.

Note: The red light will not glow unless the implement electric brake harness is connected.

2. Adjust the brake output control by initially setting at approximately 3/4 of the travel from minimum towards maximum. With this adjustment, make a few slow speed test stops on dry pavement. Slide the control towards maximum for firmer braking and towards minimum for lighter braking until the brakes are set just short of skidding on dry pavement.
3. Depressing the brake pedal of the Workman will cause simultaneous braking of all four Workman wheels and the trailer brakes. The trailer brakes alone can be actuated by pressing and holding the black button on the controller.

WARNING

The brake controller case may become hot and cause burns through frequent application of the trailer brakes.

- **Do not touch the brake controller when hot.**
 - **Allow the case to cool before performing any maintenance.**
4. Check brakes periodically and adjust when necessary.